

PLUMBING PLAN
 SCALE: 1/4" = 1'-0"

| | | | |
|--|------------------------|-------------------------|--------------------------------------|
| SHEET NO. A-4 | MODEL AVALON | SET NO. AVA00 | REVISIONS |
| DRAWING TITLE PLUMBING GROUNDWORKS | DRAWN BY RMS | VERSION 12 | DATE |
| OPTION DESCRIPTION FULL BSMT. | OPTION FBA | DATE | REMARKS |
| 59 | | 5/30/07 | NET - REVISED LOCATION OF SUMP |
| | | 10/24/07 | VERSION II / CONSOLIDATION |
| | | 8/27/08 | BSMT - VER. 12 / JCC REFORMAT ATTIC |
| | | 12/1/11 | A.H. - PAR # 9129 (DBL WALL AT MC) |
| | | 7/15/13 | A.H. - PAR #18934 (REV. NH LOCATION) |
| | | 2/22/17 | ELH - CREATED VERSION 10 / 2006 IRC |

WR, Inc., owner, expressly reserves its common law copyright and all other rights in this drawing. No part of this drawing may be reproduced, stored in a retrieval system, or transmitted in any form or by any means, electronic, mechanical, photocopying, recording, or otherwise, without the prior written consent of WR, Inc.

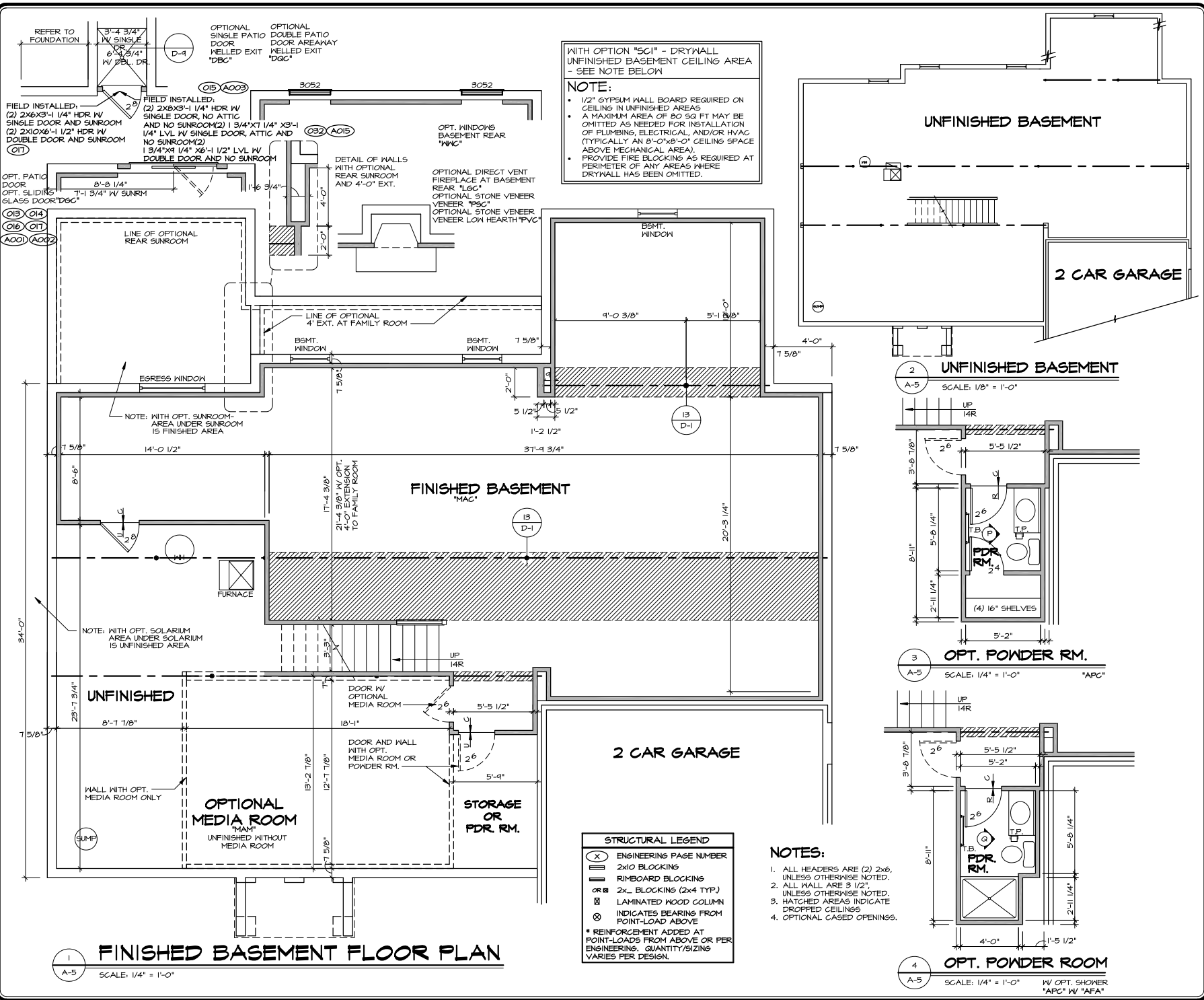



NOTE:

- 1/2" GYPSUM WALL BOARD REQUIRED ON CEILING IN UNFINISHED AREAS
- A MAXIMUM AREA OF 80 SQ FT MAY BE OMITTED AS NEEDED FOR INSTALLATION OF PLUMBING, ELECTRICAL, AND/OR HVAC (TYPICALLY AN 8'-0" X 8'-0" CEILING SPACE ABOVE MECHANICAL AREA).
- PROVIDE FIRE BLOCKING AS REQUIRED AT PERIMETER OF ANY AREAS WHERE DRYWALL HAS BEEN OMITTED.

WITH OPTION "SCI" - DRYWALL UNFINISHED BASEMENT CEILING AREA - SEE NOTE BELOW

STRUCTURAL LEGEND

- (X) ENGINEERING PAGE NUMBER
- 2x10 BLOCKING
- RIMBOARD BLOCKING
- OR 2x... BLOCKING (2x4 TYP)
- LAMINATED WOOD COLUMN
- INDICATES BEARING FROM POINT-LOAD ABOVE
- * REINFORCEMENT ADDED AT POINT-LOADS FROM ABOVE OR PER ENGINEERING. QUANTITY/SIZING VARIES PER DESIGN.

NOTES:

1. ALL HEADERS ARE (2) 2x6, UNLESS OTHERWISE NOTED.
2. ALL MALL ARE 3 1/2", UNLESS OTHERWISE NOTED.
3. HATCHED AREAS INDICATE DROPPED CEILING.
4. OPTIONAL CASSED OPENINGS.

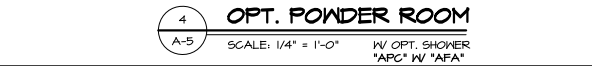
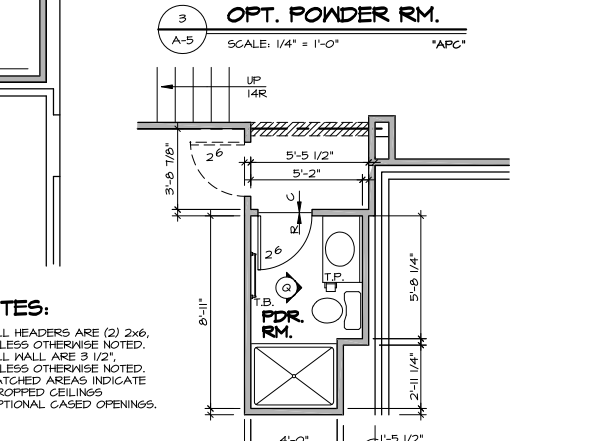
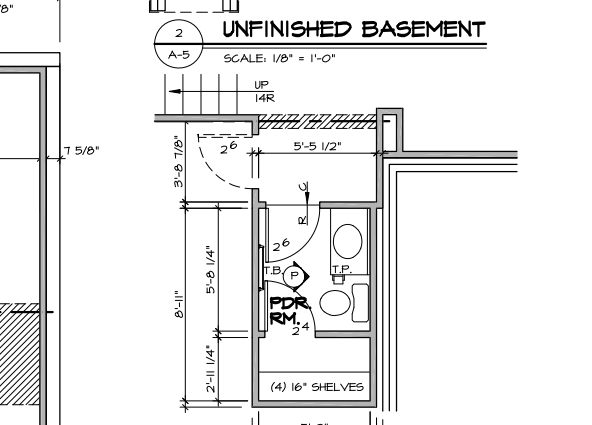
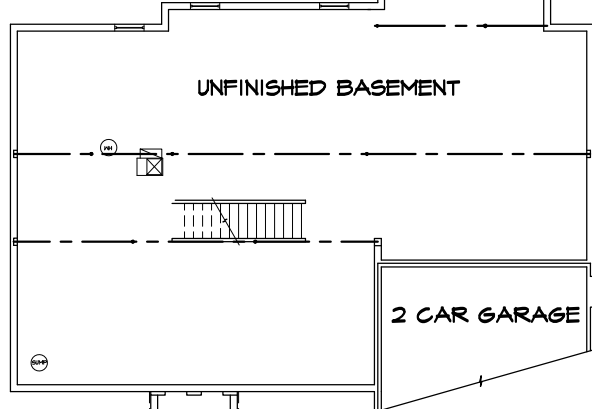

1 FINISHED BASEMENT FLOOR PLAN
SCALE: 1/4" = 1'-0"

| SHEET NO. | MODEL | SET NO. | DATE | REV. NO. | REMARKS |
|-----------|--------|---------|----------|----------|-------------------------------------|
| A-5 | AVALON | AVACO | 12/2/11 | 25 | A.J.H. - PAR #124 (DRL MALL AT PK) |
| A-5 | AVALON | AVACO | 12/14/11 | 26 | JAP - ENERGY STAR 3.0 REVISIONS |
| A-5 | AVALON | AVACO | 6/7/12 | 27 | SMR - 2012 CODE PROJECT CD-1 |
| A-5 | AVALON | AVACO | 8/6/12 | 28 | ATK - ALT. DOOR SWING PER PAR 14A55 |
| A-5 | AVALON | AVACO | 4/5/13 | 24 | CEL - ADDED LOW HEARTH FIREPLACE |
| A-5 | AVALON | AVACO | 12/07/13 | 24 | SL5 - 2008 PRODUCT UPDATE |



STRUCTURAL NOTES:

- BEARING WALL
- NON BEARING WALL
- 1. ALL HEADERS ARE (1) 2x6 W/ 2x4 WALLS OR (2) 2x6 W/ 2x6 WALLS, UNLESS OTHERWISE NOTED.
- 2. ALL HEADERS TO HAVE (1) 2x4 OR 2x6 JACK EACH END, UNLESS OTHERWISE NOTED.
- 3. ALL EXTERIOR WALLS TO 4" AND ALL INTERIOR WALLS TO BE 3 1/2", UNLESS OTHERWISE NOTED.
- 4. HATCHED AREAS INDICATE DROPPED CEILING.
- 5. SEE "BRACED WALL PANEL DETAIL SHEET" FOR SPECIAL WALL FRAMING LOCATIONS AND HEADER SIZES, IF APPLICABLE.

(X) ENGINEERING PAGE NUMBER

STEEL DETAILS

SCALE: 1/2" = 1'-0"

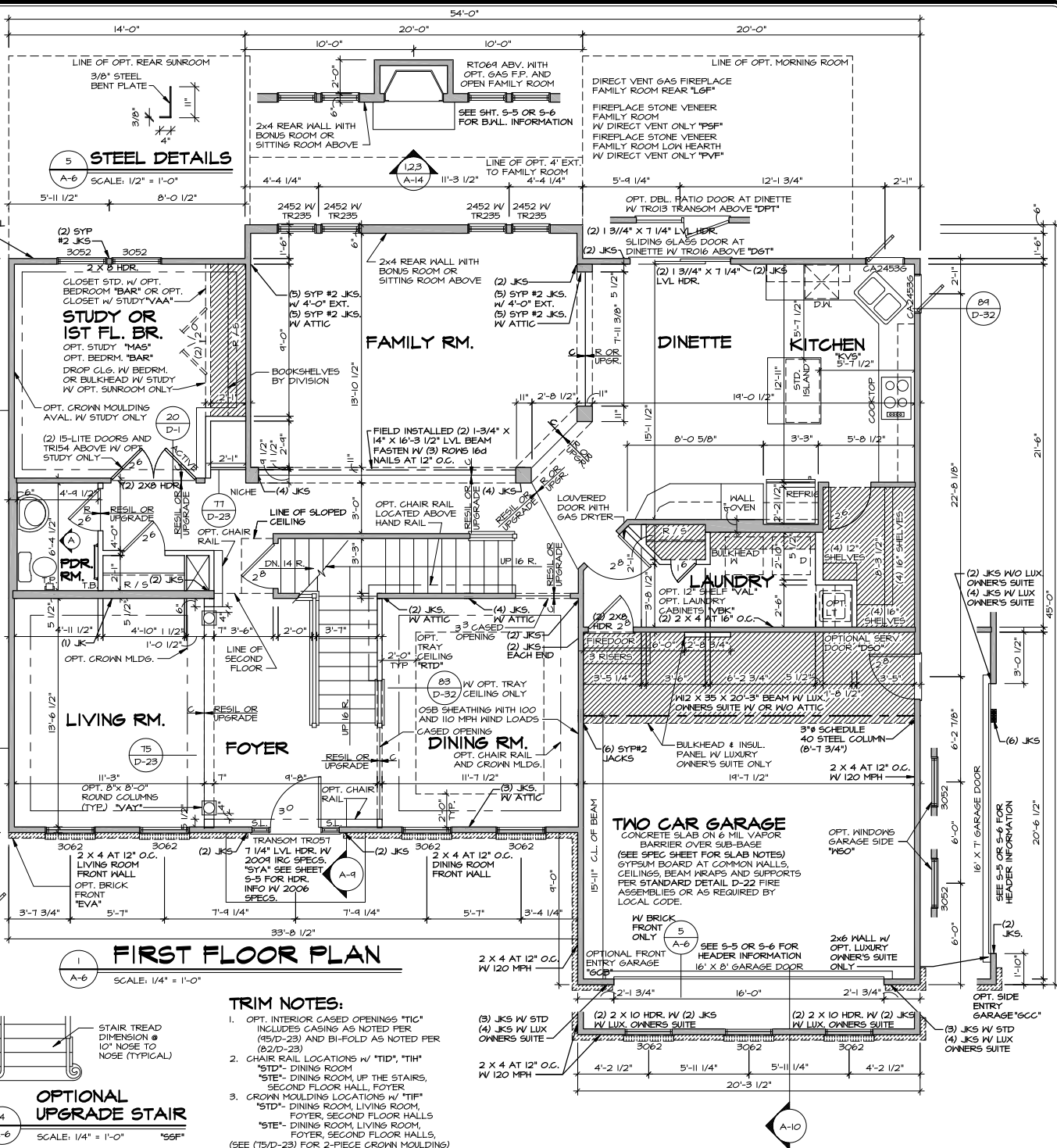
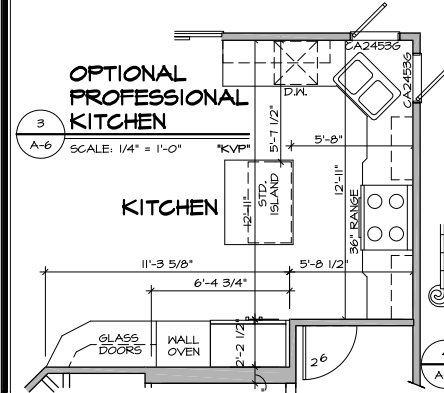
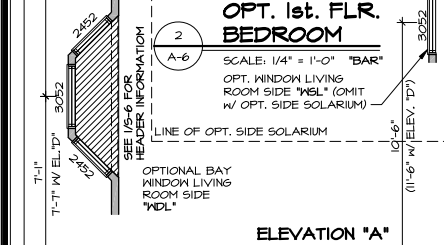
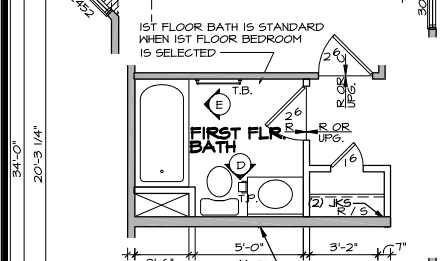
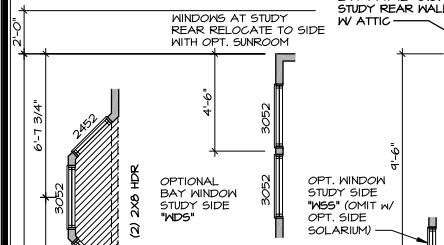
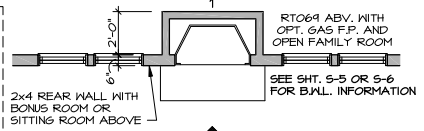

FIRST FLOOR PLAN

SCALE: 1/4" = 1'-0"

TRIM NOTES:

1. OPT. INTERIOR CASING OPENINGS, "TIC" INCLUDES CASING AS NOTED PER (95/D-23) AND BI-FOLD AS NOTED PER (82/D-23)
2. CHAIR RAIL LOCATIONS W/ "TID", "TIH", "STD", DINING ROOM, "STE", DINING ROOM, UP THE STAIRS, SECOND FLOOR HALL, FOYER
3. CROWN MOULDING LOCATIONS W/ "TIF", "STD", DINING ROOM, LIVING ROOM, FOYER, SECOND FLOOR HALLS, "STE", DINING ROOM, LIVING ROOMS, FOYER, SECOND FLOOR HALLS, (SEE (15/D-23) FOR 2-PIECE CROWN MOULDING)

| REV. NO. | DATE | REMARKS |
|----------|---------|---------------------------------------|
| 05 | 4/27/11 | BDH - ADDED OPTIONAL SIDE WINDOW |
| 06 | 4/29/11 | R.L.C. - ADD INSUL. PANEL TO GARAGE |
| 07 | 5/1/12 | G.L.S. - REV. NOTE FRONT DOOR (10/46) |
| 08 | 12/7/12 | DRA - ADDED BULKHEAD IN LAUNDRY |
| 09 | 4/5/13 | CEL - ADDED LOW HEARTH FIREPLACE |
| 04 | 4/21/11 | R.L.C. - EXTENDED BULKHEAD AT GARAGE |

WFL, Inc., owner, expressly reserves the common law copyright and all other intellectual property rights in this drawing. Any reproduction, distribution, or copying in any form or manner whatsoever, not one they are to be assigned to any third party, without first obtaining the expressed written consent of WFL, Inc.



WFL Inc. Architectural Services - Architects
21 1/2th Court, Suite 1, Franklin, MA 01702

| SHEET NO. | MODEL NO. | SET NO. | AVAOO |
|-----------|--------------------|------------|--------------------|
| A-6 | AVALON | 12 | 07/30/13 - 9:13 am |
| 64 | DRAWING TITLE | VERSION 12 | |
| | FIRST FLOOR PLAN | MHS | |
| | OPTION DESCRIPTION | OPTION | FEA |
| | FULL BASEMENT | | |

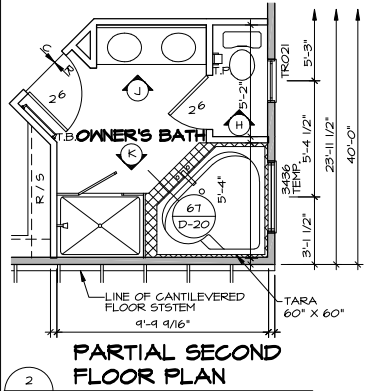

STRUCTURAL NOTES:

- BEARING WALL
 - NON BEARING WALL
 - 1. ALL HEADERS ARE (2) 2x6 W/ 2x4 WALLS OR (3) 2x6 W/ 2x6 WALLS, UNLESS OTHERWISE NOTED.
 - 2. ALL HEADERS TO HAVE (1) 2x4 OR 2x6 JACK EACH END, UNLESS OTHERWISE NOTED.
 - 3. ALL EXTERIOR WALLS TO 4" AND ALL INTERIOR WALLS TO BE 3 1/2", UNLESS OTHERWISE NOTED.
 - 4. HATCHED AREAS INDICATE DROPPED CEILING.
 - 5. SEE "BRACED WALL PANEL DETAIL SHEET" FOR SPECIAL WALL FRAMING LOCATIONS AND HEADER SIZES, IF APPLICABLE.
- X ENGINEERING PAGE NUMBER

TRIM NOTES:

1. OPT. INTERIOR CASED OPENINGS "TIC" INCLUDES CASING AS NOTED PER (R5/D-23) AND BI-FOLD AS NOTED PER (B2/D-23)
2. CHAIR RAIL LOCATIONS W/ "TID", "TIH" "STD"- DINING ROOM "STE"- DINING ROOM, UP THE STAIRS, SECOND FLOOR HALL, FOYER "TIF"- DINING ROOM, LIVING ROOM, FOYER, SECOND FLOOR HALLS "STE"- DINING ROOM, LIVING ROOM, FOYER, SECOND FLOOR HALLS (SEE (T5/D-23) FOR 2-PIECE CROWN MOULDING)

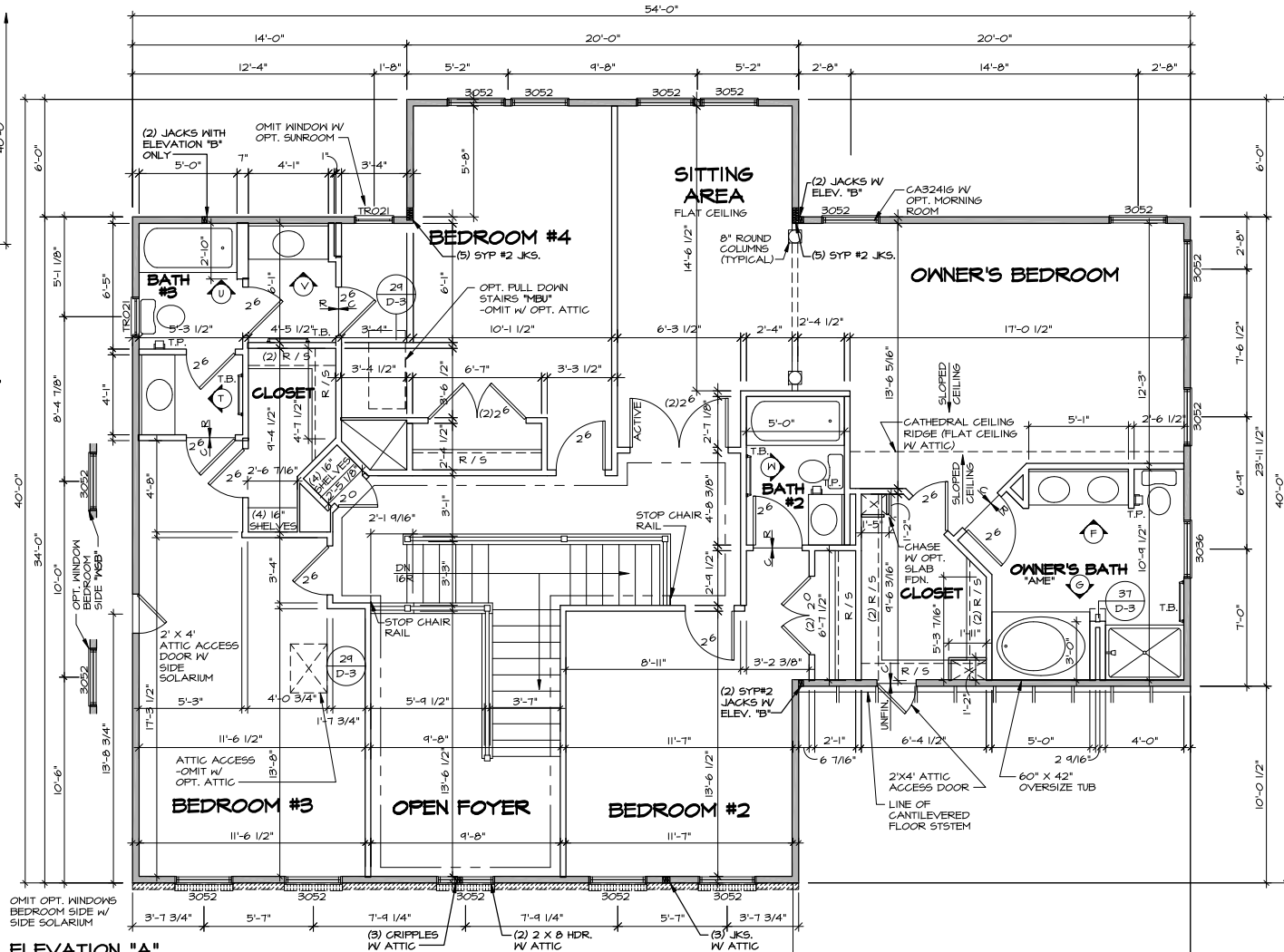

3 SECOND FLOOR PLAN
SCALE: 1/4" = 1'-0" SHOWN W/ OPT. ATTIC

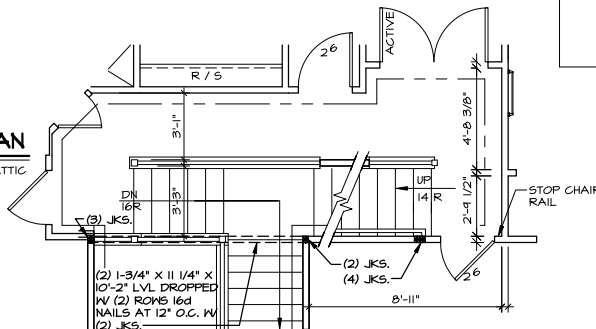

| REV. NO. | DATE | REMARKS |
|----------|----------|------------------------------------|
| 31 | 8/30/12 | ATK - CHANGED SHELVING - 19384 |
| 26 | 11/27/10 | SL5 - 2004 PRODUCT UPDATE |
| 27 | 11/08/10 | ALH - REV. ATTIC ACCESS LOCATION |
| 28 | 2/7/11 | ZDK - REVISED TRIM NOTES |
| 24 | 4/27/11 | BDH - ADDED OPTIONAL SIDE WINDOWS |
| 30 | 8/30/12 | SJC - REV. LOG, BODY/SIT. RAY KIDS |

NRK, Inc., owner, expressly reserves the common law copyright and other property rights in these plans. These plans are not to be used, copied, reproduced, or otherwise transmitted in any form or by any means, electronic or mechanical, including photocopying, recording, or by any information storage and retrieval system, without first obtaining the express written consent of NRK, Inc.



| | | | |
|-----------|-----------------------|--------------|----------|
| SHEET NO. | MODEL | SET NO. | DATE |
| A-7 | AVALON | AVA00 | 12/13/12 |
| 78 | DRAWING TITLE | VERSION 12 | |
| | SECOND FLOOR PLAN | DRAWN BY | RWS |
| | SUITE W/ SITTING AREA | DATE: | 9/27/10 |
| | OPTION DESCRIPTION | STP. OWNER'S | |
| | | BDC, BLA | |

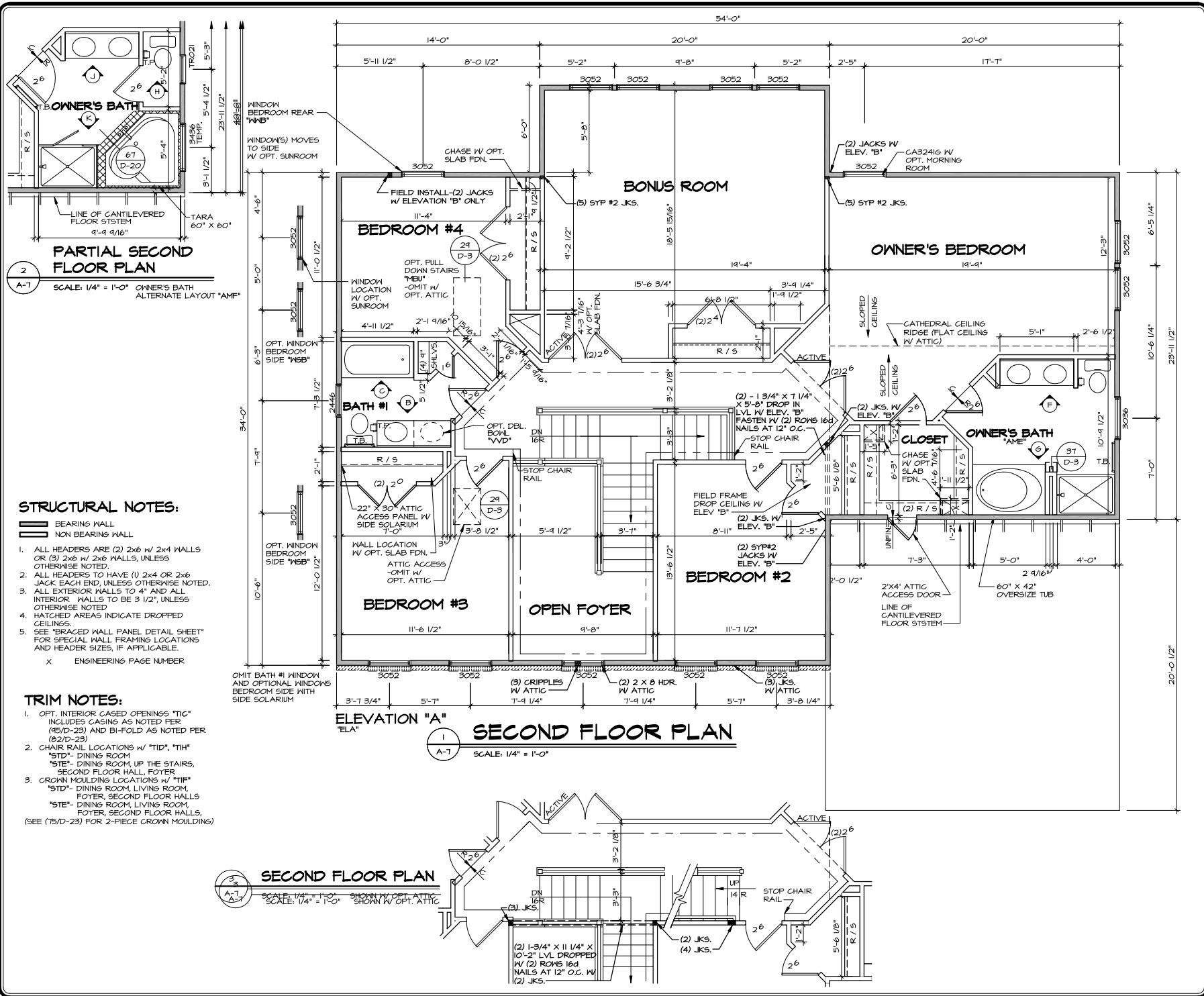

RYAN HOMES
 21 1st Court, Suite 2, Franklin, NJ 07024
 978.646.8888

MODEL
AVALON

SET NO. AVA00
VERSION 12
DRAWN BY RWS

DRAWING TITLE
 SECOND FLOOR PLAN/ MIT ENG.
 OPTION DESCRIPTION: STD. OWNER'S SUITE OPTION
 4 B.R. OPEN FOYER, BONUS RM., B.L.A. B.D.Y., MAY

SHEET NO.
A-7
80

DATE
 12/13/12

SCALE
 1/4" = 1'-0"

FILE NAME
 J:\Dwg\VA\DETACHED\AVALON_AVA00_12\FLOOR2-BR.dwg

PRINTED
 12/13/12 1:34 pm

STRUCTURAL NOTES:

- BEARING WALL
 - NON BEARING WALL
1. ALL HEADERS ARE (2) 2x6 W/ 2x4 WALLS OR (3) 2x6 W/ 2x6 WALLS, UNLESS OTHERWISE NOTED.
 2. ALL HEADERS TO HAVE (1) 2x4 OR 2x6 JACK EACH END, UNLESS OTHERWISE NOTED.
 3. ALL EXTERIOR WALLS TO 4" AND ALL INTERIOR WALLS TO BE 3 1/2", UNLESS OTHERWISE NOTED.
 4. HATCHED AREAS INDICATE DROPPED CEILING.
 5. SEE "BRACED WALL PANEL DETAIL SHEET" FOR SPECIAL WALL FRAMING LOCATIONS AND HEADER SIZES, IF APPLICABLE.
- (X) ENGINEERING PAGE NUMBER

TRIM NOTES:

1. OPT. INTERIOR CASING OPENINGS "TIC" INCLUDES CASING AS NOTED PER (95/D-23) AND BI-FOLD AS NOTED PER (82/D-23)
2. CHAIR RAIL LOCATIONS W/ "TID", "TIH" "STD"- DINING ROOM "STE"- DINING ROOM, UP THE STAIRS, SECOND FLOOR HALL, FOYER
3. CROWN MOULDING LOCATIONS W/ "TIF" "STD"- DINING ROOM, LIVING ROOM, FOYER SECOND FLOOR HALLS "STE"- DINING ROOM, LIVING ROOM, FOYER, SECOND FLOOR HALLS, (SEE (75/D-23) FOR 2-PIECE CROWN MOULDING)

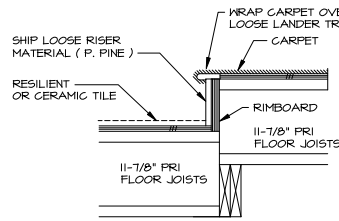

2 TRIM AT STEPDOWN
SCALE: 1" = 1'-0"

| STRUCTURAL LEGEND | |
|--|---|
| [Symbol] | 2x10 BLOCKING |
| [Symbol] | RIMBOARD BLOCKING |
| [Symbol] | 2x BLOCKING (2x4 TYP.) |
| [Symbol] | LAMINATED WOOD COLUMN |
| [Symbol] | INDICATES BEARING FROM POINT-LOAD ABOVE |
| * REINFORCEMENT ADDED AT POINT-LOADS FROM ABOVE OR PER ENGINEERING. QUANTITY/SIZING VARIES PER DESIGN. | |

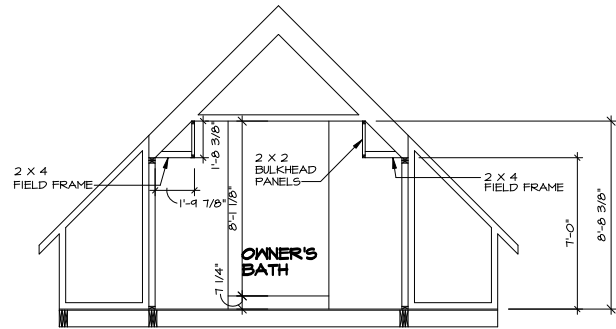

4 SECTION AT BULKHEAD
SCALE: 1/4" = 1'-0"

OPEN FAMILY ROOM OR BONUS ROOM
(BONUS ROOM ONLY AVAILABLE W/ 4'-0" FAMILY ROOM EXT.)

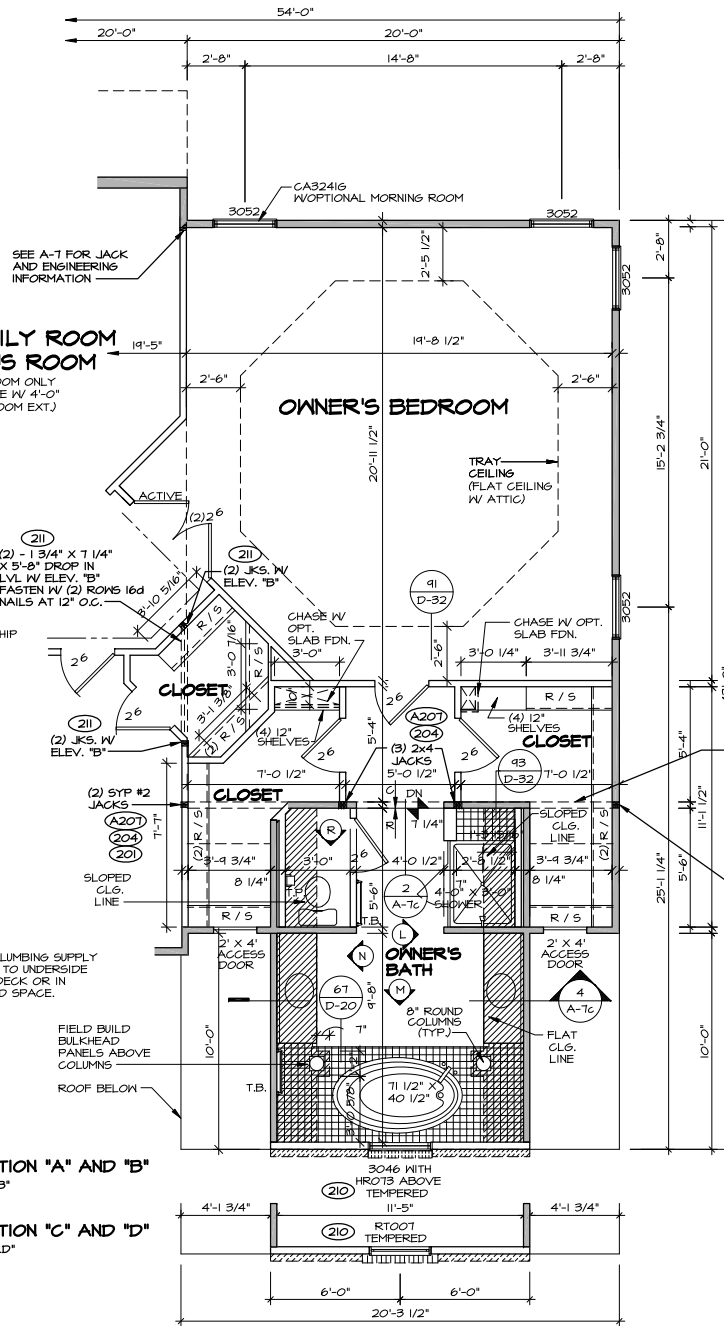

ELEVATION "A" AND "B"
"ELA", "ELB"

ELEVATION "C" AND "D"
"ELC", "ELD"

1 PARTIAL SECOND FLOOR PLAN
SCALE: 1/4" = 1'-0"

W/ 4 B.R. OPEN FOYER "BDY*" "MAV"
W/ 4 B.R. W/ OPEN FOYER AND BONUS ROOM "BDY", "MAV"

REFER TO SHEET A-7 FOR REMAINDER OF FLOOR PLAN

| SHEET NO. | MODEL | SET NO. | DATE | REMARKS |
|-----------|---|-------------|----------|-------------------------------------|
| A-7c | AVALON | AVAO0 | 5/30/12 | RJC - ADDED "ELD" TO LVL BEAM NOTE |
| | DRAWING TITLE | VERSION 1.2 | 6/14/12 | RJC - ADDED STEPDOWN TRIM DETAIL |
| | SECOND FLOOR PLAN | | 8/31/12 | ATK - CHANGED SHELVING - PAR 19394 |
| | OPTION DESCRIPTION 2 CAR GARAGE LUX. OWNERS SUITE | | 12/16/04 | SL5 - 2004 PRODUCT UPDATE |
| 83 | | | 2/7/11 | ZDM - REVISED TRIM NOTES |
| | | | 4/3/12 | CHB - REV. JK/ENG. AT OWN. BR./F.R. |

W/4, Inc., owner, expressly reserves the common law copyright and all other intellectual property rights in the drawings, specifications, and any other documents prepared, designed, or copied in any form or manner whatsoever, and no part of them are to be reproduced, stored in a retrieval system, or transmitted in any form or by any means, without first obtaining the expressed written consent of W/4, Inc.

Ryan Homes
21 W. Conant, Suite 1, Franklin, MA 01702

| | | | |
|---|-------------------------------|----------|-----|
| SET NO. AVAO0 | VERSION 1.2 | DRAWN BY | RWS |
| OPTION DESCRIPTION 2 CAR GARAGE LUX. OWNERS SUITE | OPTION GCB, GCC BLE, BDT, MAY | | |

STRUCTURAL NOTES:

- BEARINGS WALL
 NON BEARING WALL

1. ALL HEADERS ARE (2) 2x6 W/ 2x4 WALLS OR (3) 2x6 W/ 2x6 WALLS, UNLESS OTHERWISE NOTED.
2. ALL HEADERS TO HAVE (1) 2x4 OR 2x6 JACK EACH END, UNLESS OTHERWISE NOTED.
3. ALL EXTERIOR WALLS TO 4" AND ALL INTERIOR WALLS TO BE 3 1/2", UNLESS OTHERWISE NOTED.
4. HATCHED AREAS INDICATE DROPPED CEILINGS.
5. SEE BRACED WALL PANEL DETAIL SHEET FOR SPECIAL WALL FRAMING LOCATIONS AND HEADER SIZES, IF APPLICABLE.

(X) ENGINEERING PAGE NUMBER

TRIM NOTES:

1. OPT. INTERIOR CASED OPENINGS "TIC" INCLUDES CASING AS NOTED PER (45/D-23) AND BI-FOLD AS NOTED PER (82/D-23).
2. CHAIR RAIL LOCATIONS W/ "TID", "TIH", "STD"- DINING ROOM, UP THE STAIRS, SECOND FLOOR HALL, FOYER.
3. CROWN MOULDING LOCATIONS W/ "TIF", "STD"- DINING ROOM, LIVING ROOM, FOYER, SECOND FLOOR HALLS "STE"- DINING ROOM, LIVING ROOM, FOYER, SECOND FLOOR HALLS, (SEE (75/D-23) FOR 2-PIECE CROWN MOULDING).

STRUCTURAL LEGEND

- 2x10 BLOCKING
- RIMBOARD BLOCKING
- 2x_ BLOCKING (2x4 TYP.)
- LAMINATED WOOD COLUMN
- INDICATES BEARING FROM POINT-LOAD ABOVE
- * REINFORCEMENT ADDED AT POINT-LOADS FROM ABOVE OR PER ENGINEERING. QUANTITY/SIZING VARIES PER DESIGN.

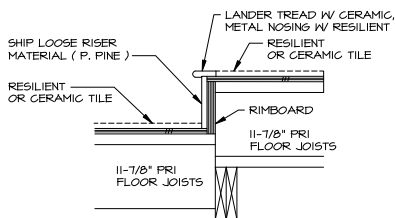

2
A-Tc SCALE: 1" = 1'-0"

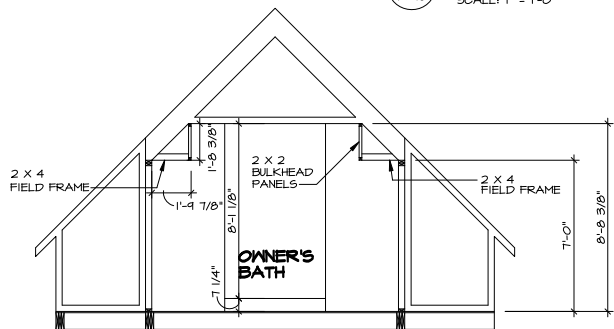

4
A-Tc SCALE: 1/4" = 1'-0"

ELEVATION "A" AND "B"
"ELA", "ELB"

ELEVATION "C" AND "D"
"ELC", "ELD"

PARTIAL SECOND FLOOR PLAN

1
A-Tc SCALE: 1/4" = 1'-0"

W/ 4 B.R. OPEN FOYER "BDY"
W/ 4 B.R. W/ OPEN FOYER AND BONUS ROOM "BDY", "MAY"

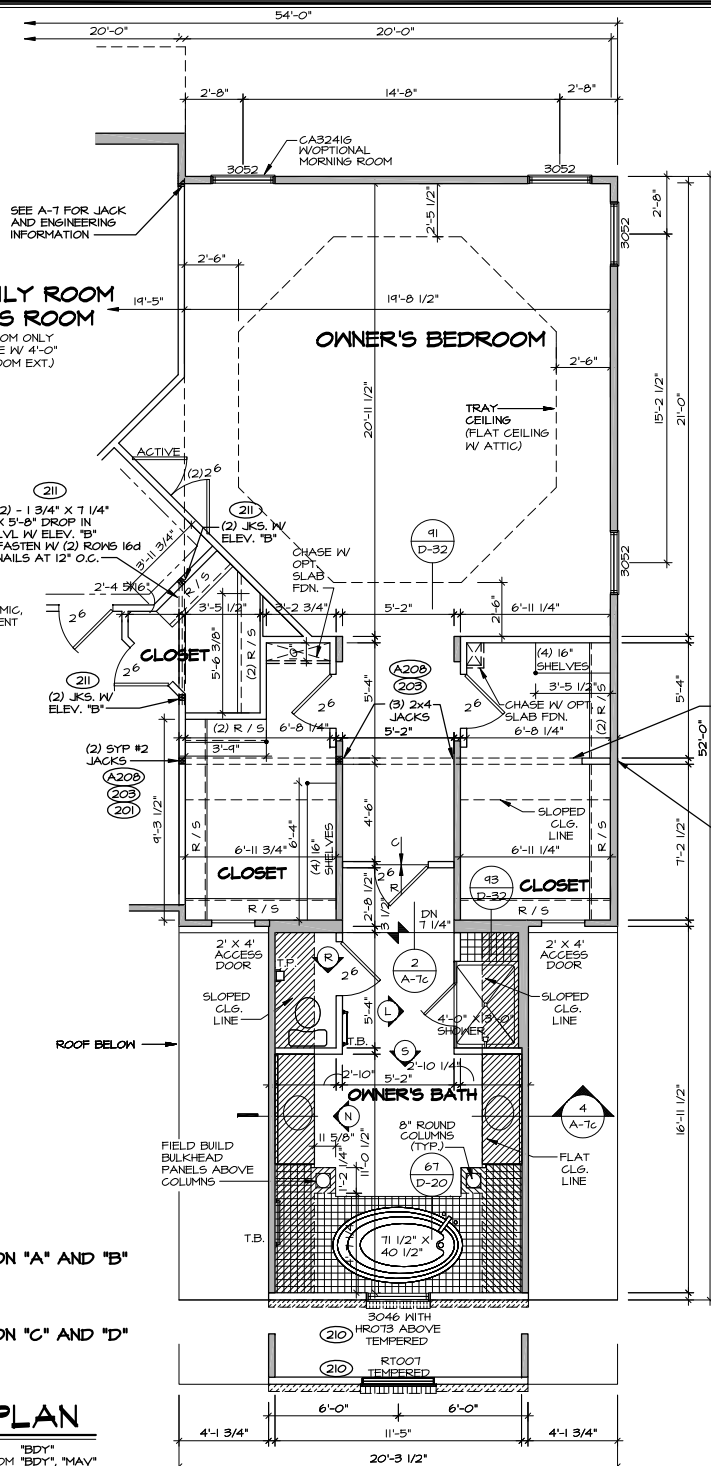

REFER TO SHEET A-1 FOR REMAINDER OF FLOOR PLAN

| REV. NO. | DATE | REMARKS |
|----------|----------|---------------------------------------|
| 31 | 12/11/04 | SLS - 2004 PRODUCT UPDATE |
| 32 | 2/7/11 | ZDM - REVISED TRIM NOTES |
| 33 | 4/9/12 | CHB - REV. JK/ENG. AT OWN. BR./FR. |
| 34 | 5/12/20 | R.L.C. - ADDED "ELD" TO LVL BEAM NOTE |
| 35 | 6/14/12 | R.L.C. - ADDED STEPDOWN TRIM DETAIL |
| 36 | 10/25/09 | MBY - REVISED NOTES |

NWR, Inc., owner, expressly reserves the common law copyright and proprietary right in this drawing. No part of this drawing or its reproduction, storage, transmission, or use in any form or by any means, nor are they to be assigned to any third party, without first obtaining the express written consent of NWR, Inc.



| | |
|-------------|-------------------|
| MODEL | AVALON |
| SHEET NO. | A-7c |
| SET NO. | AVA00 |
| VERSION | 12 |
| DRAWN BY | MAC |
| OPTION | GCE |
| DESCRIPTION | 3 CAR GARAGE |
| | LUX. OWNERS SUITE |
| | BLB, BDY, MAY |

STRUCTURAL NOTES:

- BEARING WALL
 - NON BEARING WALL
1. ALL HEADERS ARE (2) 2x6 W/ 2x4 WALLS OR (3) 2x6 W/ 2x6 WALLS, UNLESS OTHERWISE NOTED.
 2. ALL HEADERS TO HAVE (1) 2x4 OR 2x6 JACK EACH END, UNLESS OTHERWISE NOTED.
 3. ALL EXTERIOR WALLS TO 4" AND ALL INTERIOR WALLS TO BE 3 1/2", UNLESS OTHERWISE NOTED
 4. HATCHED AREAS INDICATE DROPPED CEILINGS.
 5. SEE "BRACED WALL PANEL DETAIL SHEET" FOR SPECIAL WALL FRAMING LOCATIONS AND HEADER SIZES, IF APPLICABLE.
- (X) ENGINEERING PAGE NUMBER

TRIM NOTES:

1. OPT. INTERIOR CASED OPENINGS "TIC" INCLUDES CASING AS NOTED PER (R5/D-23) AND BI-FOLD AS NOTED PER (R2/D-23)
2. CHAIR RAIL LOCATIONS W/ "TID", "TIH" "STD"- DINING ROOM "STE"- DINING ROOM, UP THE STAIRS, SECOND FLOOR HALL, FOYER
3. CROWN MOULDING LOCATIONS W/ "TIF" "STD"- DINING ROOM, LIVING ROOM, FOYER, SECOND FLOOR HALLS "STE"- DINING ROOM, LIVING ROOM, FOYER, SECOND FLOOR HALLS. (SEE (R5/D-23) FOR 2-PIECE CROWN MOULDING)

| STRUCTURAL LEGEND | |
|-------------------|--|
| | 2x10 BLOCKING |
| | RIMBOARD BLOCKING |
| | 2x2 BLOCKING (2x4 TYP.) |
| | LAMINATED WOOD COLUMN |
| | INDICATES BEARING FROM POINT-LOAD ABOVE |
| | * REINFORCEMENT ADDED AT POINT-LOADS FROM ABOVE OR PER ENGINEERING. QUANTITY/SIZING VARIES PER DESIGN. |

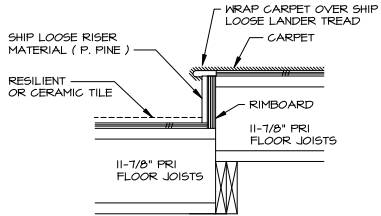

2 TRIM AT STEPDOWN
SCALE: 1" = 1'-0"

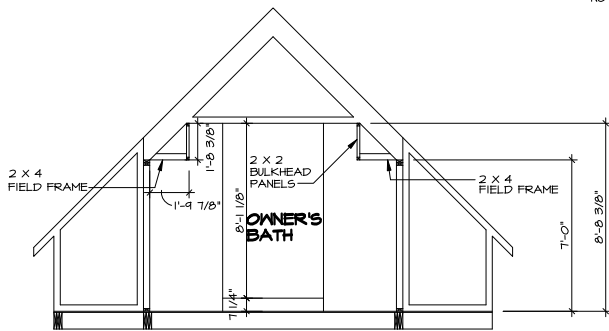

4 SECTION AT BULKHEAD
SCALE: 1/4" = 1'-0"

NOTE: HOLD ALL PLUMBING SUPPLY LINES TIGHT TO UNDERSIDE OF FLOOR DECK OR IN CONDITIONED SPACE.

ELEVATION "A" AND "B"
'ELA', 'ELB'

ELEVATION "C" AND "D"
'ELC', 'ELD'

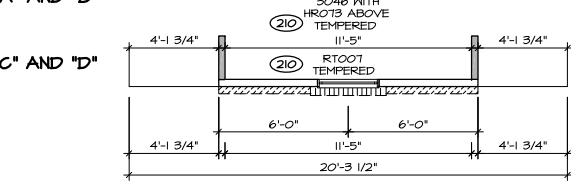
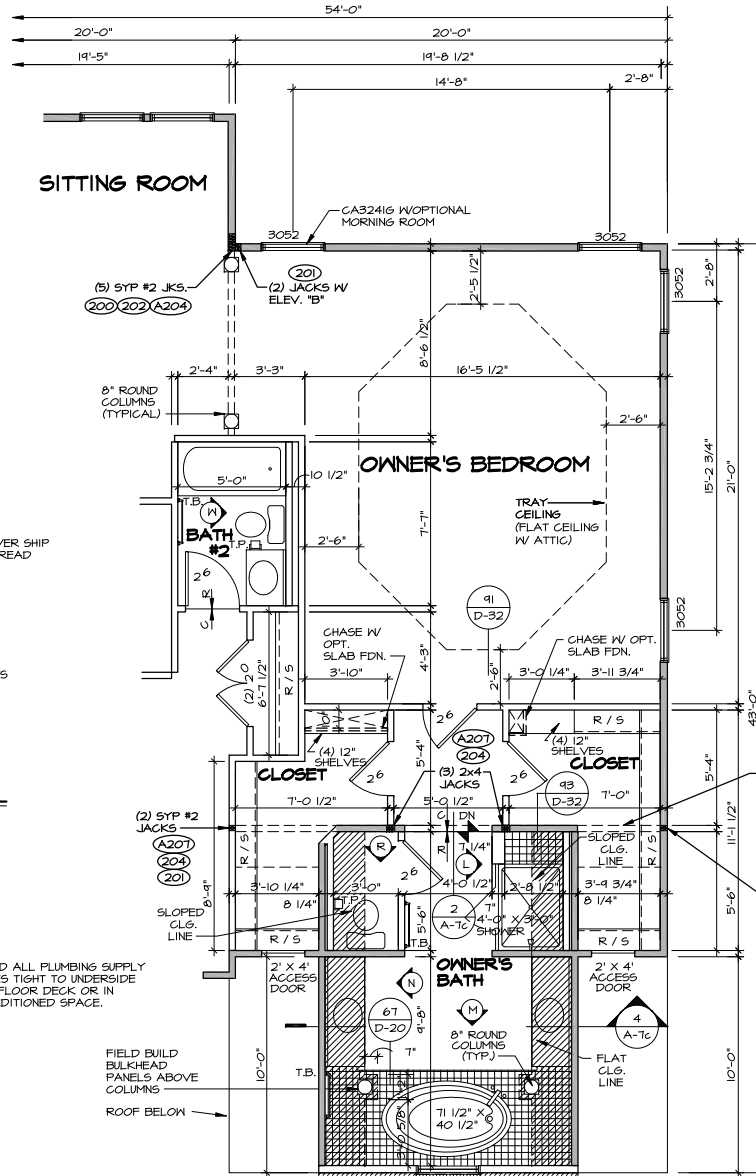

1 PARTIAL SECOND FLOOR PLAN
SCALE: 1/4" = 1'-0"
W/ 4 B.R. SITTING AREA W/ OPEN FOYER "BDC"

(FIELD INSTALLED)
(2) 1 3/4" X 16" X 20'-0" LVL BEAM (WITH 'ELA', 'ELC' AND 'ELD')
(2) 1 3/4" X 16" X 20'-3 1/2" LVL BEAM (WITH 'ELB')
FASTEN PLYS WITH (3) ROWS OF 16d NAILS AT 12" O.C. (203) (A208)
(2) 2x4 JACKS

REFER TO SHEET A-7 FOR REMAINDER OF FLOOR PLAN

| REV. NO. | DATE | REMARKS |
|----------|----------|--------------------------------------|
| 31 | 6/19/12 | R/C - ADDED STEPDOWN TRIM DETAIL |
| 26 | 10/24/07 | R/S - VERSION II / CONSOLIDATION |
| 27 | 8/27/08 | SMM - VER. 12 / JCC. REFORMAT, ATTIC |
| 28 | 6/25/04 | MET - REVISED NOTES |
| 29 | 12/17/04 | SLS - 2004 PRODUCT UPDATE |
| 30 | 2/7/11 | Z/D4 - REVISED TRIM NOTES |

NWR, Inc., owner, expressly reserves the common law copyright and all other intellectual property rights in and to the drawings, specifications, and other documents prepared or prepared to be prepared by NWR, Inc. or its subcontractors, and no part of them are to be assigned to any third party, without first obtaining the express written consent of NWR, Inc.

1975 W. Philadelphia, Suite 100, Phoenix, AZ 85027
21 Bth Cove, Suite 1, Fremont, CA 94538

| | |
|--------------------|--|
| MODEL | AVALON |
| DRAWING TITLE | SECOND FLOOR PLAN |
| OPTION DESCRIPTION | 2 CAR GARAGE LUX. OWNERS STE. W/ SITTING |
| SHEET NO. | A-7c |
| SET NO. | AVA00 |
| VERSION | 12 |
| DRAWN BY | RWS |
| OPTION | GCB, GCC, BLB, BDC |
| DATE | 07/02/12 |

STRUCTURAL NOTES:

- BEARING WALL
 - NON BEARING WALL
 - 1. ALL HEADERS ARE (2) 2x6 W/ 2x4 WALLS OR (3) 2x6 W/ 2x6 WALLS, UNLESS OTHERWISE NOTED.
 - 2. ALL HEADERS TO HAVE (1) 2x4 OR 2x6 JACK EACH END, UNLESS OTHERWISE NOTED.
 - 3. ALL EXTERIOR WALLS TO 4" AND ALL INTERIOR WALLS TO BE 3 1/2", UNLESS OTHERWISE NOTED.
 - 4. HATCHED AREAS INDICATE DROPPED CEILING.
 - 5. SEE "BRACED WALL PANEL DETAIL SHEET" FOR SPECIAL WALL FRAMING LOCATIONS AND HEADER SIZES, IF APPLICABLE.
- (X) ENGINEERING PAGE NUMBER

TRIM NOTES:

1. OPT. INTERIOR CASED OPENINGS "TIC" INCLUDES CASING AS NOTED PER (85/D-23) AND BI-FOLD AS NOTED PER (82/D-23)
2. CHAIR RAIL LOCATIONS W/ "TID", "TIH", "STD"- DINING ROOM, "SITE"- DINING ROOM, UP THE STAIRS, SECOND FLOOR HALL, FOYER
3. CROWN MOULDING LOCATIONS W/ "TIF", "STD"- DINING ROOM, LIVING ROOM, FOYER, SECOND FLOOR HALLS, "SITE"- DINING ROOM, LIVING ROOM, FOYER, SECOND FLOOR HALLS, (SEE (15/D-23) FOR 2-PIECE CROWN MOULDING)

STRUCTURAL LEGEND

- 2x10 BLOCKING
- RIMBOARD BLOCKING
- OR 2x_ BLOCKING (2x4 TYP)
- LAMINATED WOOD COLUMN
- INDICATES BEARING FROM POINT-LOAD ABOVE
- * REINFORCEMENT ADDED AT POINT-LOADS FROM ABOVE OR PER ENGINEERING. QUANTITY/SIZING VARIES PER DESIGN.

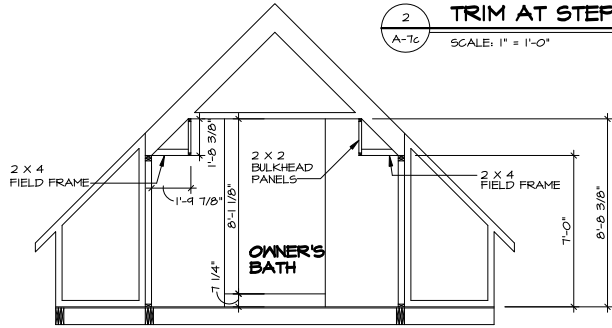
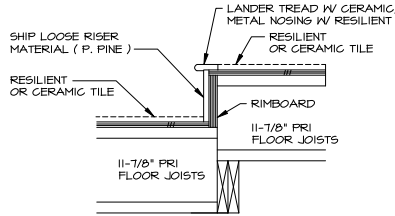

SECTION AT BULKHEAD
SCALE: 1/4" = 1'-0"

PARTIAL SECOND FLOOR PLAN
SCALE: 1/4" = 1'-0"

ELEVATION "A" AND "B"
"ELA", "ELB"

ELEVATION "C" AND "D"
"ELC", "ELD"

W/ 4 B.R. SITTING AREA W/ OPEN FOYER "BDC"

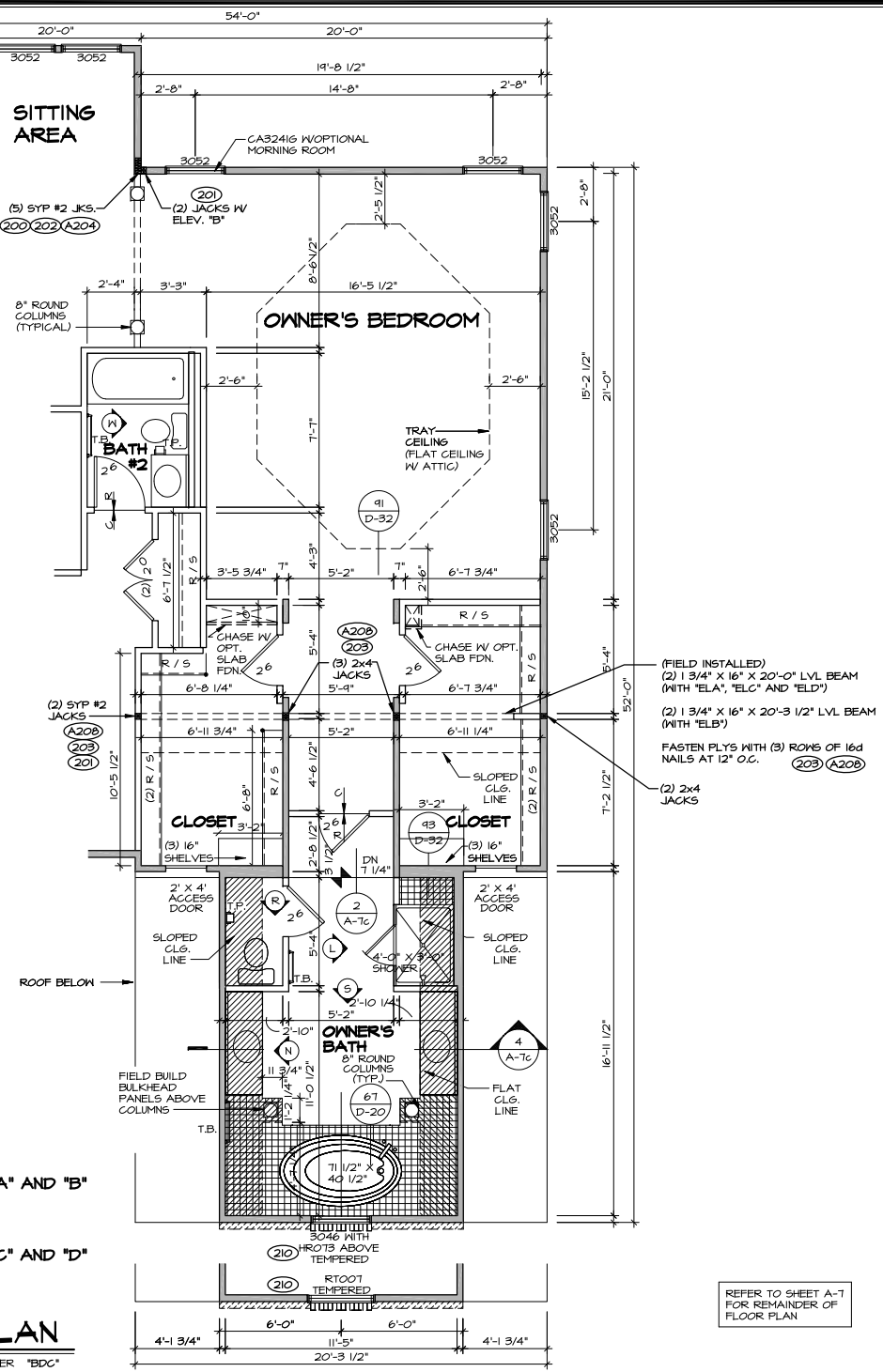

REFER TO SHEET A-1 FOR REMAINDER OF FLOOR PLAN

| REV. NO. | DATE | REMARKS |
|----------|----------|--|
| 31 | 2/7/11 | ZDK - REVISED TRIM NOTES |
| 32 | 5/30/12 | R.L.C. - ADDED "ELD" TO LVL. BEAM NOTE |
| 33 | 6/19/12 | R.L.C. - ADDED STEPDOWN TRIM DETAIL |
| 28 | 8/21/08 | SMH - VER. 12 / J.C.C. REFORMAT, ATTIC |
| 29 | 6/25/04 | MBT - REVISED NOTES |
| 30 | 12/18/04 | SL.S. - 2004 PRODUCT UPDATE |

NWR, Inc., owner, expressly reserves the common law copyright and all other intellectual property rights in this drawing and all information contained herein. No part of this drawing may be reproduced, stored in a retrieval system, or transmitted in any form or by any means, electronic, mechanical, photocopying, recording, or otherwise, without the prior written consent of NWR, Inc.



| | | |
|--------------------------|--|---------------------------------------|
| SHEET NO. A-7c | MODEL AVALON | SET NO. AVAOO |
| | DRAWING TITLE SECOND FLOOR PLAN | VERSION 12 |
| 86 | OPTION DESCRIPTION LUX. OWNERS SUITE, W/ SITTING AREA, GARAGE | DRAWN BY MAC |
| | | OPTION 3 CAR GARAGE, GCE, BLE, BDC |

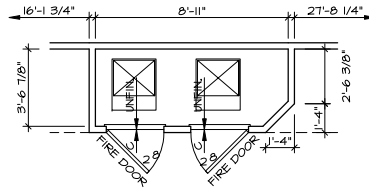

2 ATTIC FLOOR PLAN
 SCALE: 1/4" = 1'-0" W/ OPT. SLAB FDN.
 FSA

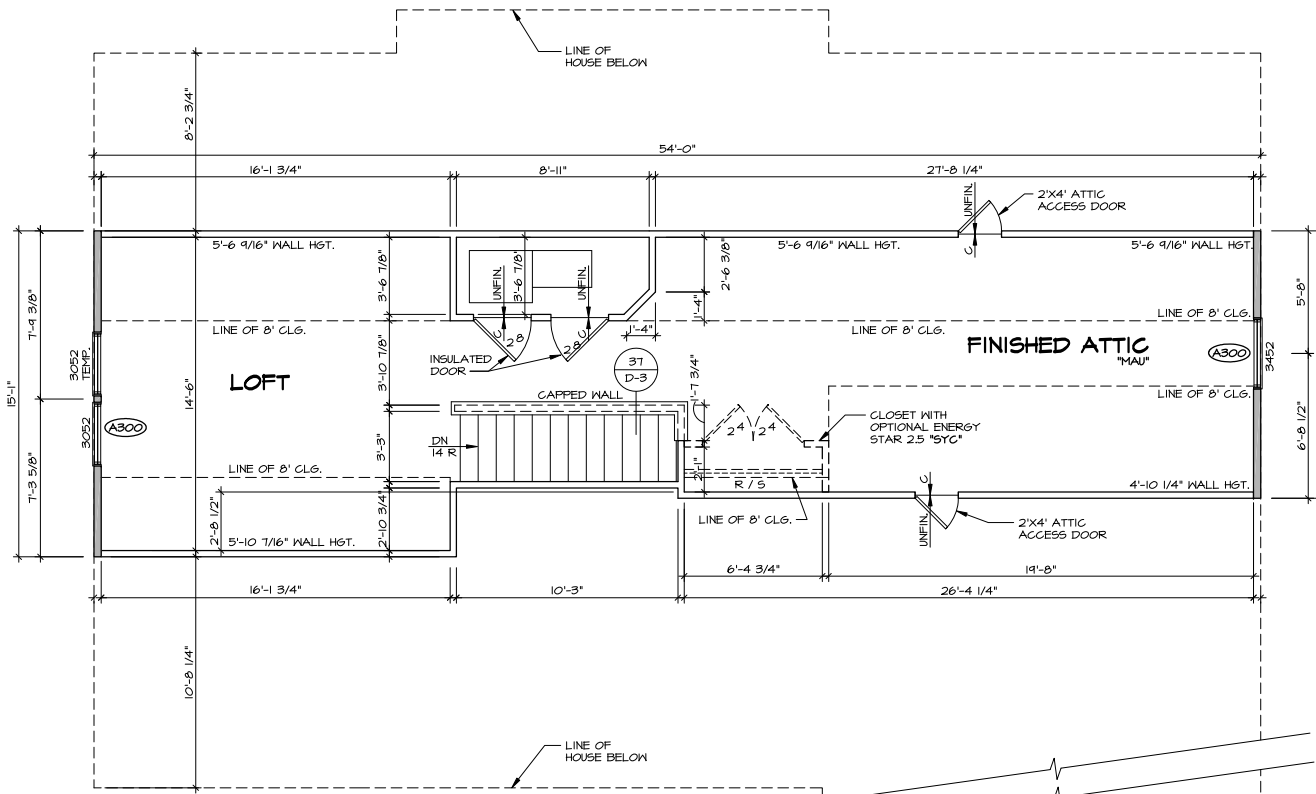

1 ATTIC FLOOR PLAN
 SCALE: 1/4" = 1'-0" W/ FINISHED ATTIC
 MAU

STRUCTURAL LEGEND

| | |
|--|---|
| | 2x10 BLOCKING |
| | RYMBOARD BLOCKING |
| | OR 2x BLOCKING (2x4 TYP.) |
| | LAMINATED HOOD COLUMN |
| | INDICATES BEARING FROM POINT-LOAD ABOVE |

* REINFORCEMENT ADDED AT POINT-LOADS FROM ABOVE OR PER ENGINEERING. QUANTITY/SIZING VARIES PER DESIGN.

- STRUCTURAL NOTES:**
- BEARING WALL
 - NON BEARING WALL
1. ALL HEADERS ARE (2) 2x6 w/ 2x4 WALLS OR (3) 2x6 w/ 2x6 WALLS, UNLESS OTHERWISE NOTED.
 2. ALL HEADERS TO HAVE (1) 2x4 OR 2x6 JACK EACH END, UNLESS OTHERWISE NOTED.
 3. ALL EXTERIOR WALLS TO 4" AND ALL INTERIOR WALLS TO BE 3 1/2", UNLESS OTHERWISE NOTED.
 4. HATCHED AREAS INDICATE DROPPED CEILINGS.
 5. SEE BRACED WALL PANEL DETAIL SHEET* FOR SPECIAL WALL FRAMING LOCATIONS AND HEADER SIZES, IF APPLICABLE.
- (X) ENGINEERING PAGE NUMBER

| REV. | NO. | DATE | REMARKS |
|------|-----|----------|--------------------------------------|
| 1 | T | 2/10/12 | ZDM - REVISED 2-2/6 IV 2/6 FIRE/DOOR |
| 2 | Ø | 8/27/12 | CSB - ADDED DOUBLE DR. AT MECH RM |
| 3 | Ø | 10/18/12 | CEL - PARH4566 - REV. STAIRS NOTE |
| 4 | 4 | 4/5/10 | SMW - REV. MECH DOORS (PAR 1841) |
| 5 | Ø | 8/3/11 | BDH - ADDED CLOSET AND REV. HVAC |
| 6 | Ø | 4/28/11 | DCM - REV. ACCESS DR. LCG (PAR 6719) |

NVR, Inc. owns, expressly reserves its common law copyright and other property rights in these plans. These plans are not to be copied, reproduced, distributed, or otherwise used in any way, nor are they to be assigned to any third party, without first obtaining the expressed written consent of NVR, Inc.



| | | | |
|--------------------|------------------|----------|-------|
| SHEET NO. | A-8 | MODEL | AVA00 |
| DRAWING TITLE | ATTIC FLOOR PLAN | VERSION | 12 |
| DRAWN BY | SMW | DRAWN BY | SMW |
| OPTION DESCRIPTION | FINISHED ATTIC | OPTION | MAU |

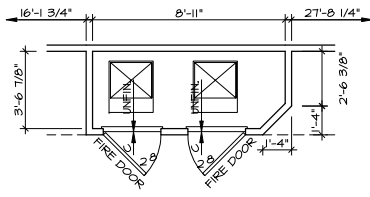

2 ATTIC FLOOR PLAN
SCALE: 1/4" = 1'-0" W/ OPT. SLAB FDN.
"FSA"

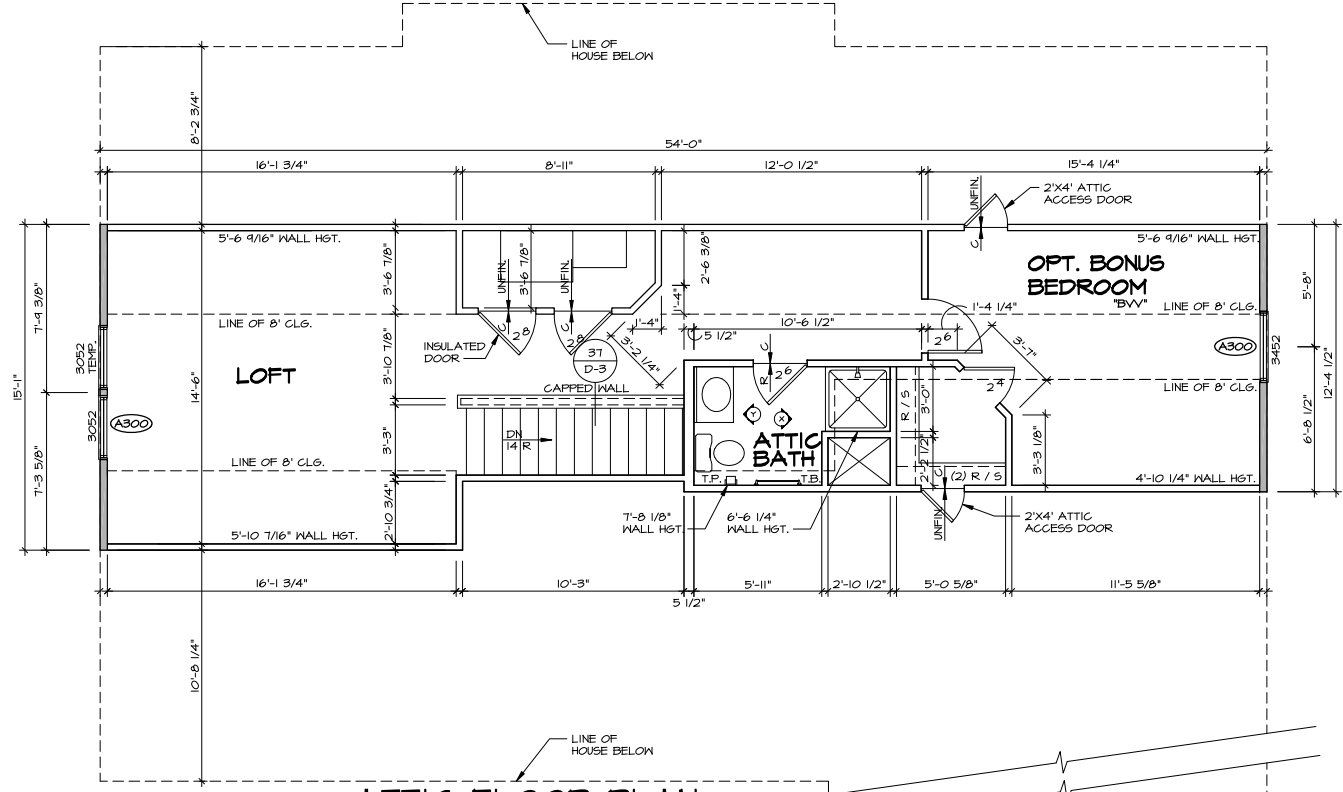

1 ATTIC FLOOR PLAN
SCALE: 1/4" = 1'-0" FINISHED ATTIC
W/ BONUS BEDROOM "BV"

| STRUCTURAL LEGEND | |
|-------------------|--|
| | 2x10 BLOCKING |
| | RIMBOARD BLOCKING |
| | 2x BLOCKING (2x4 TYP.) |
| | LAMINATED WOOD COLUMN |
| | INDICATES BEARING FROM POINT-LOAD ABOVE |
| | * REINFORCEMENT ADDED AT POINT-LOADS FROM ABOVE OR PER ENGINEERING. QUANTITY/SIZING VARIES PER DESIGN. |

STRUCTURAL NOTES:

- ALL HEADERS ARE (2) 2x6 W/ 2x4 WALLS OR (3) 2x6 W/ 2x6 WALLS, UNLESS OTHERWISE NOTED.
 - ALL HEADERS TO HAVE (1) 2x4 OR 2x6 JACK EACH END, UNLESS OTHERWISE NOTED.
 - ALL EXTERIOR WALLS TO 4" AND ALL INTERIOR WALLS TO BE 3 1/2", UNLESS OTHERWISE NOTED.
 - HATCHED AREAS INDICATE DROPPED CEILING.
 - SEE "BRACED WALL PANEL DETAIL SHEET" FOR SPECIAL WALL FRAMING LOCATIONS AND HEADER SIZES, IF APPLICABLE.
- (X) ENGINEERING PAGE NUMBER

| REV. NO. | DATE | REMARKS |
|----------|----------|---------------------------------------|
| 1 | 2/10/12 | ZDM - REVISED 2-2/6 W/ 2/6 FIRE DOOR |
| 2 | 8/27/12 | CSEB - ADDED DOUBLE DR. AT MECH RM |
| 3 | 10/18/12 | CEL - PARH4566 - REV. STAIR NOTE |
| 4 | 4/5/10 | SMW - REV. MECH DOORS (PAR 184) |
| 5 | 8/9/11 | BDH - REV. HVAC LOCATION |
| 6 | 4/28/11 | DCM - REV. ACCESS DR. LOC. (PAR 6735) |

NVR, Inc., owner, expressly reserves its common law copyright and other property rights in these plans. These plans are not to be used, copied, or reproduced in any way without the prior written consent of NVR, Inc. nor are they to be assigned to any third party, without first obtaining the expressed written consent of NVR, Inc.



| | | | |
|------------|---------------|------------------|--------------------|
| SHEET NO. | MODEL | SET NO. | AVACO |
| A-8 | AVALON | VERSION | 12 |
| | | DRAWN BY | SMW |
| | | OPTION | BV |
| | | ATTIC FLOOR PLAN | |
| | | FINISHED ATTIC | |
| | | W/ BONUS BEDROOM | |
| | | DATE | 10/18/12 - 8:42 am |

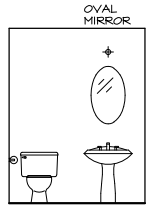

A POWDER ROOM
SCALE: 1/4" = 1'-0"

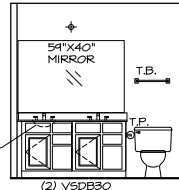

B BATH #1
SCALE: 1/4" = 1'-0"

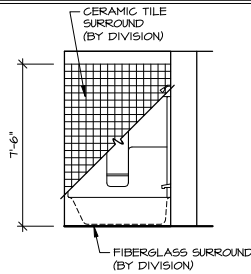

C BATH #1
SCALE: 1/4" = 1'-0"

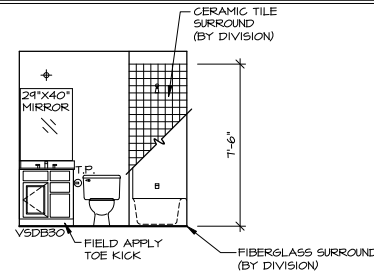

D FIRST FLOOR BATH
SCALE: 1/4" = 1'-0"

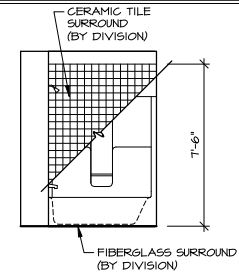

E FIRST FLOOR BATH
SCALE: 1/4" = 1'-0"

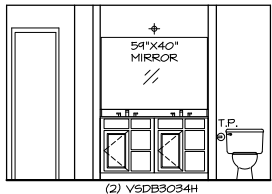

F OWNER'S BATH
SCALE: 1/4" = 1'-0" *AME*

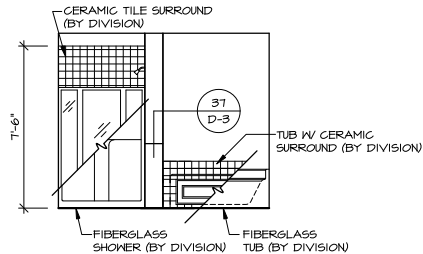

G OWNER'S BATH
SCALE: 1/4" = 1'-0" *AME*



H OWNER'S BATH
SCALE: 1/4" = 1'-0" *AME*

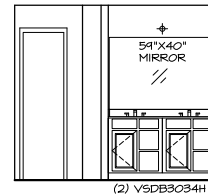

J OWNER'S BATH
SCALE: 1/4" = 1'-0" *AME*

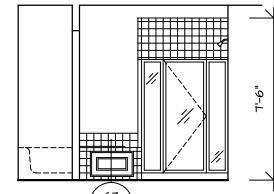

K OWNER'S BATH
SCALE: 1/4" = 1'-0" *AME*



R LUXURY OWNERS BATH
SCALE: 1/4" = 1'-0"

NOTES:
TEMPERED GLASS SHOWER ENCLOSURE WITH SWING DOOR OR OPTIONAL SLIDING DOOR BY DIVISION

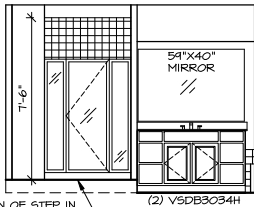

L LUXURY OWNERS BATH
SCALE: 1/4" = 1'-0"

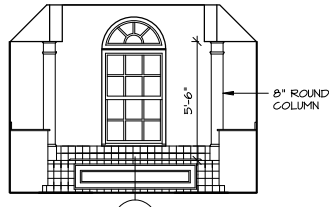

M LUXURY OWNERS BATH
SCALE: 1/4" = 1'-0" W/2 CAR GARAGE

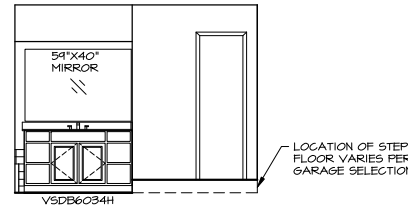

N LUXURY OWNERS BATH
SCALE: 1/4" = 1'-0"

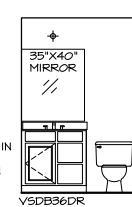

P POWDER ROOM
SCALE: 1/4" = 1'-0" BSMT.

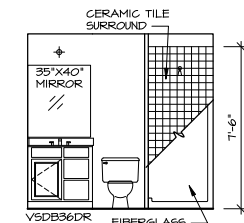

Q POWDER ROOM
SCALE: 1/4" = 1'-0" BSMT.

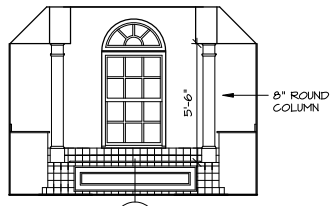

S LUXURY OWNERS BATH
SCALE: 1/4" = 1'-0" W/3 CAR GARAGE



T BATH #3
SCALE: 1/4" = 1'-0"

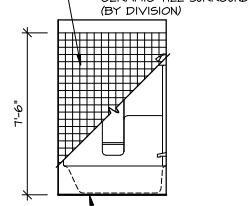

U BATH #3
SCALE: 1/4" = 1'-0"



V BATH #3
SCALE: 1/4" = 1'-0"

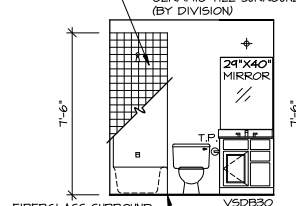

W BATH #2
SCALE: 1/4" = 1'-0"

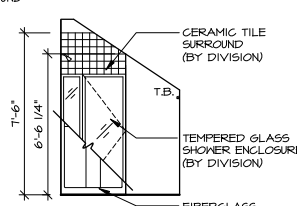

X ATTIC BATH
SCALE: 1/4" = 1'-0"

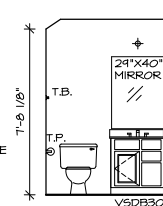

Y ATTIC BATH
SCALE: 1/4" = 1'-0"

I BATH ELEVATIONS
SCALE: 1/4" = 1'-0"

NOTES:
TEMPERED GLASS SHOWER ENCLOSURE WITH SWING DOOR OR OPTIONAL SLIDING DOOR BY DIVISION

| REV. NO. | DATE | REMARKS |
|----------|----------|--------------------------------------|
| 25 | 3/28/13 | CSB - REV. OWNER'S BATH SHR TILE HT. |
| 26 | 4/14/13 | T65 - SHOWER TILE CHANGE |
| 21 | 10/30/07 | T65 - VERSION II / CONSOLIDATION |
| 22 | 10/21/08 | SM4 - VER. 12 / J.C. REFORMAT, ATTIC |
| 23 | 1/24/04 | CALB - REV. BATH VANITY NOTATION |
| 24 | 1/07/10 | SL5 - 2004 PRODUCT UPDATE |

| | |
|---------------|------------|
| SET NO. AVA00 | VERSION 12 |
| DRAWN BY | R/S |
| OPTION | |

| | | |
|--------------------------------------|---------------------------------|----------------------|
| SHEET NO. A-13 | MODEL AVALON | SET NO. AVA00 |
| DRAWING TITLE BATH ELEVATIONS | DRAWING TITLE VERSION 12 | VERSION 12 |
| OPTION 116 | OPTION R/S | OPTION |



1818 W. Philadelphia, Suite 100, Phoenix, AZ 85027