

# Redwood Miamisburg North Springboro Pike OH P1 Construction Site Plan

Building Order

- J
- A
- GG
- FF
- H
- B
- G
- C
- F
- D
- E
- EE

31 Buildings-141 Units

- Forestwood (37)
- Meadowood (24)
- Capewood (5)
- Willowood (12)
- Breezewood (59)
- Breezewood SR (4)
- High Profile Side
- Building Step

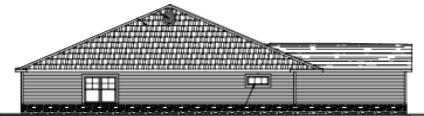

# BUILDING CC

- 1 - Capewood Left
- 1 - Forestwood Right
- 1 - Forestwood Left
- 1 - Meadowood Right

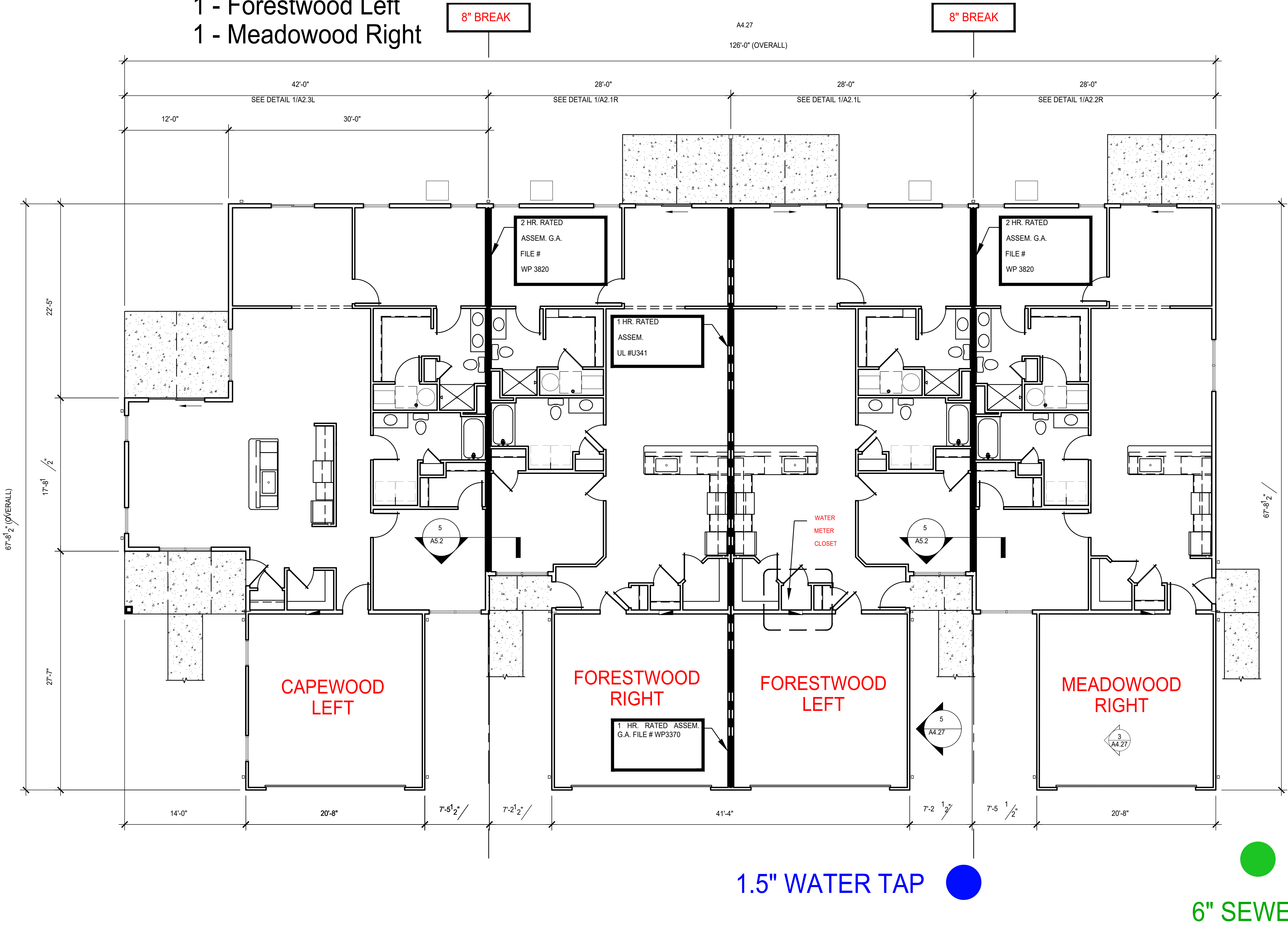

1.5" WATER TAP ●

6" SEWER TAP ●

OVERALL FLOOR PLAN

SCALE : 3/32" = 1'-0"

BUILDING: CC



REVISIONS

phone 330.666.5770  
 fax 330.666.8812  
**MPG**  
 MANN • PARSONS • GRAY  
 ARCHITECTS  
 3660 Embassy Parkway  
 Fairlawn, OH 44333  
 mpg-architects.com

OVERALL FLOOR PLANS - BLDGS.; CC, DD

PROJECT #: 33521 DATE: JULY 27, 2022

REDWOOD MIAMISBURG

MIAMISBURG OH, 45449



**A2.36**

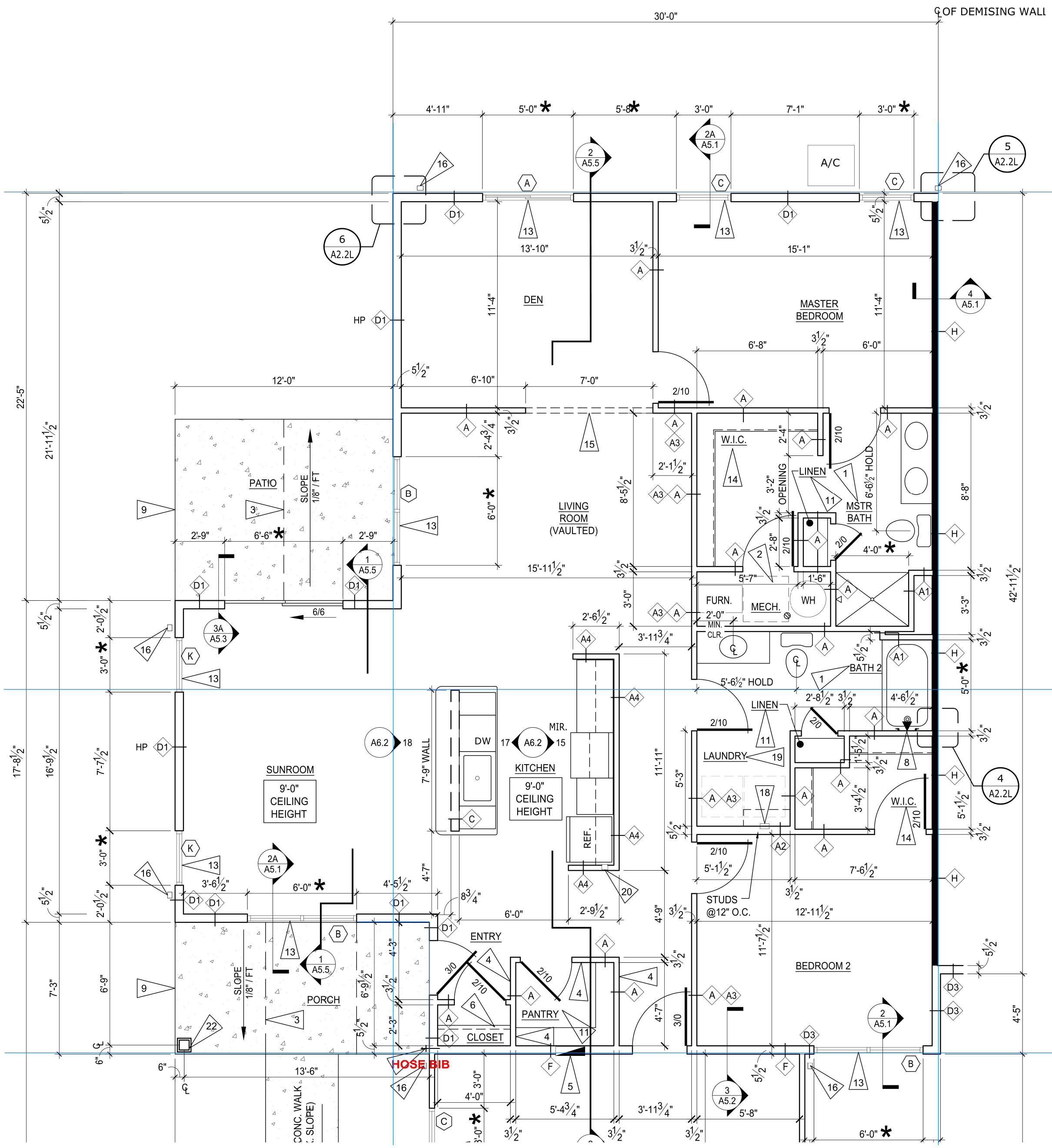

**GARAGE ON THIS SIDE OF BUILDING**

**NOTES:**

**MUST install tub boxes for tub and shower traps !! Wait until gravel prepped**

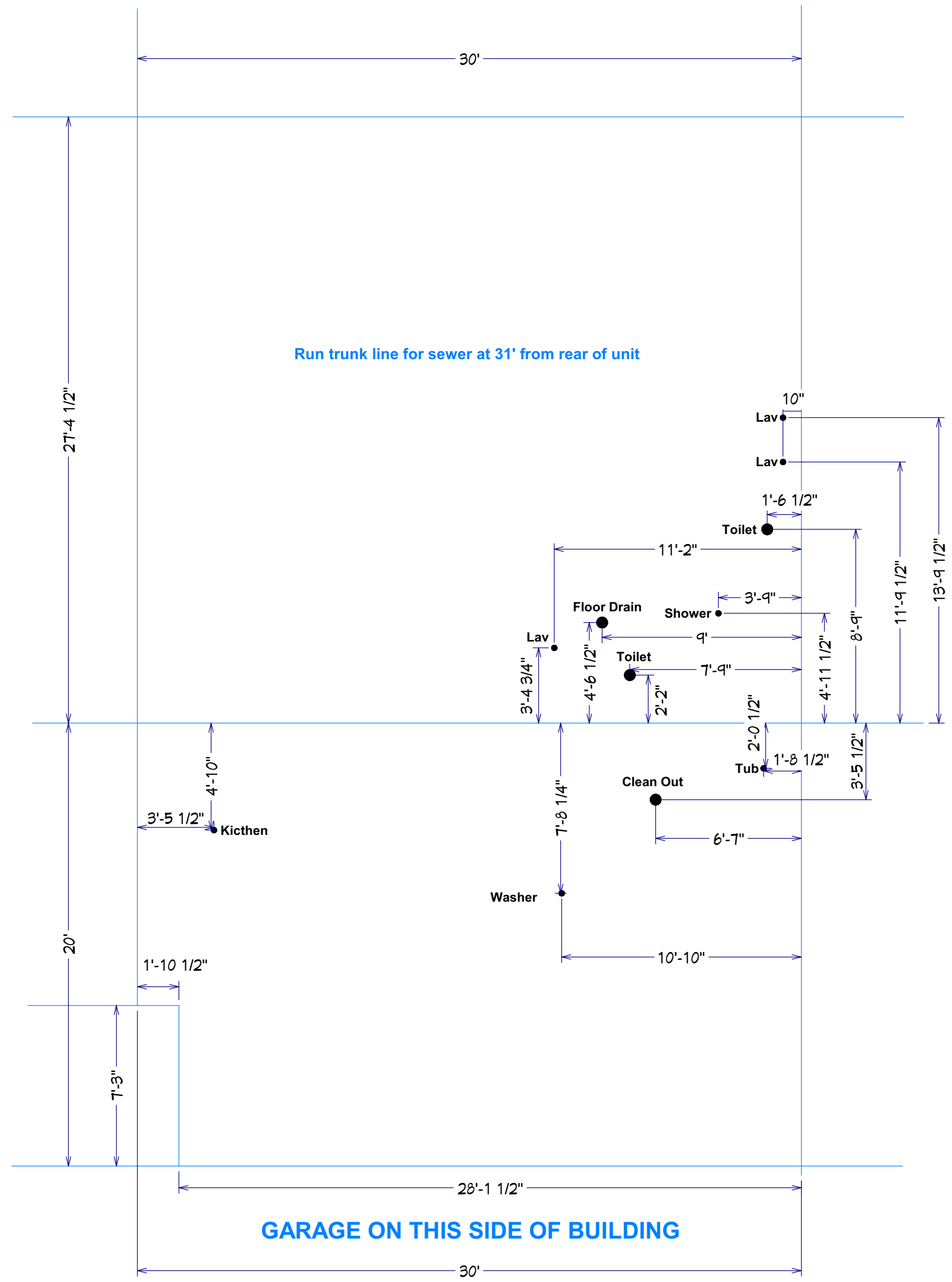

**GARAGE ON THIS SIDE OF BUILDING**

**Capewood Left PVC**

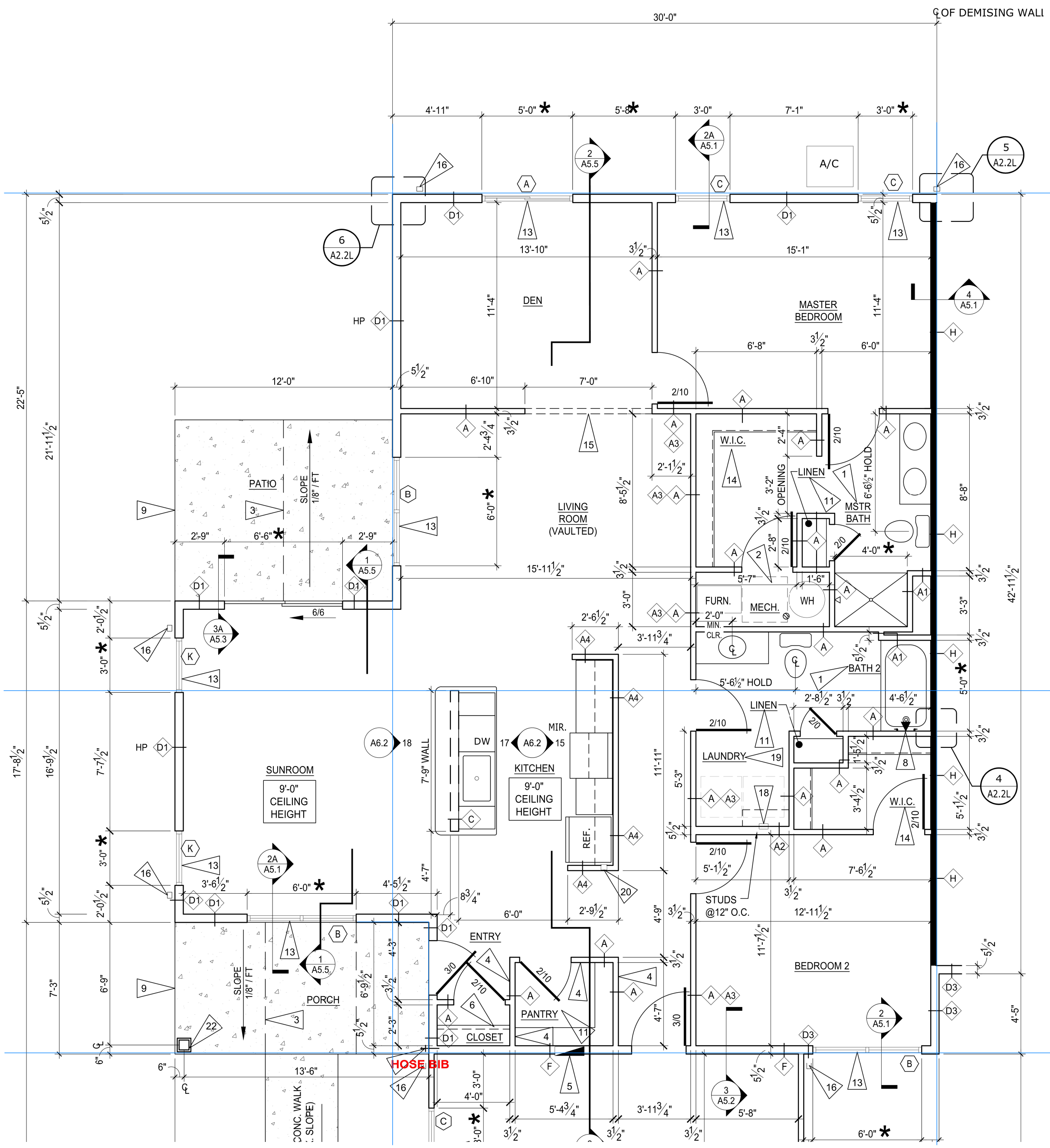

**GARAGE ON THIS SIDE OF BUILDING**

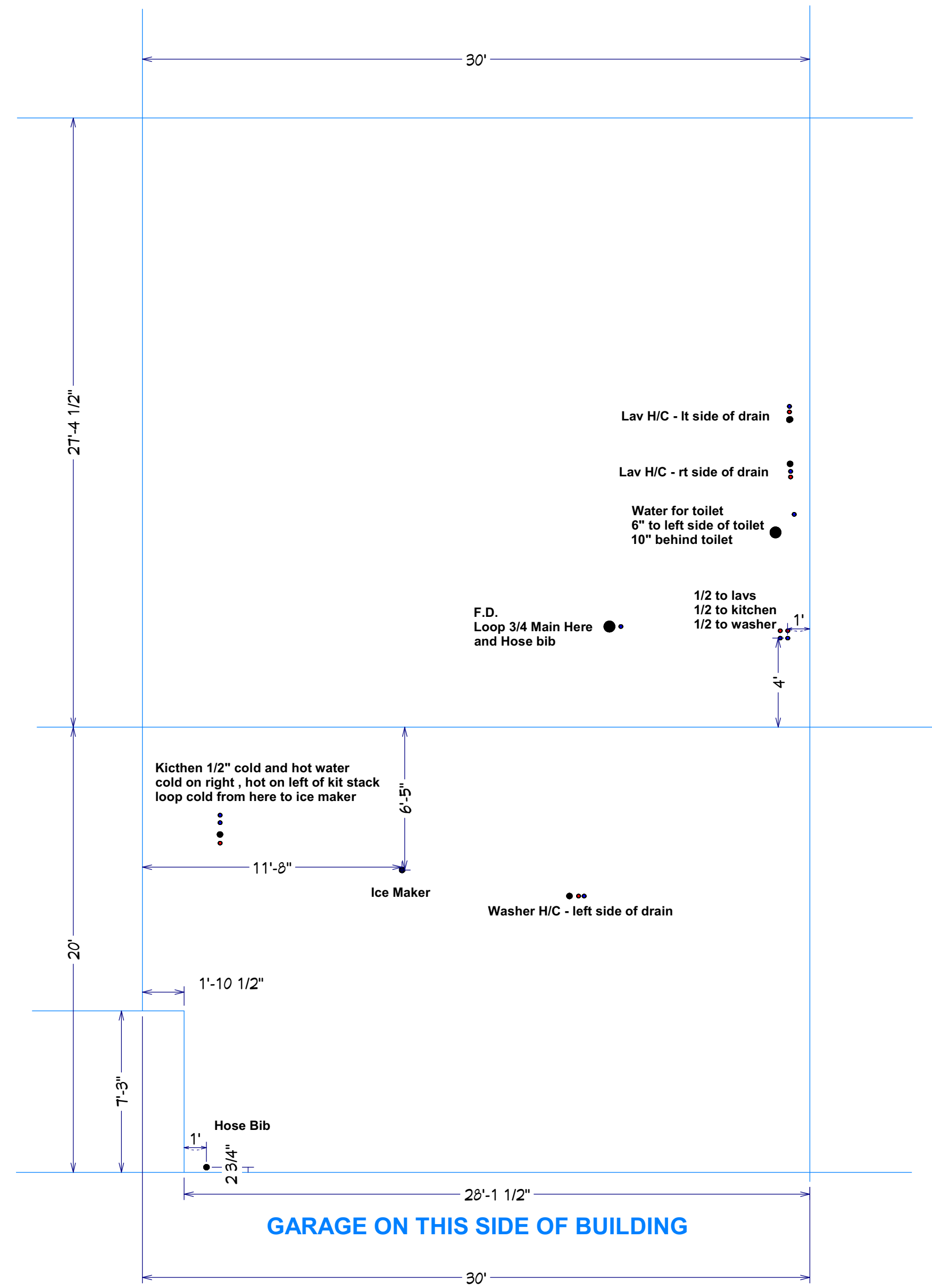

**Capewood Left WATER**

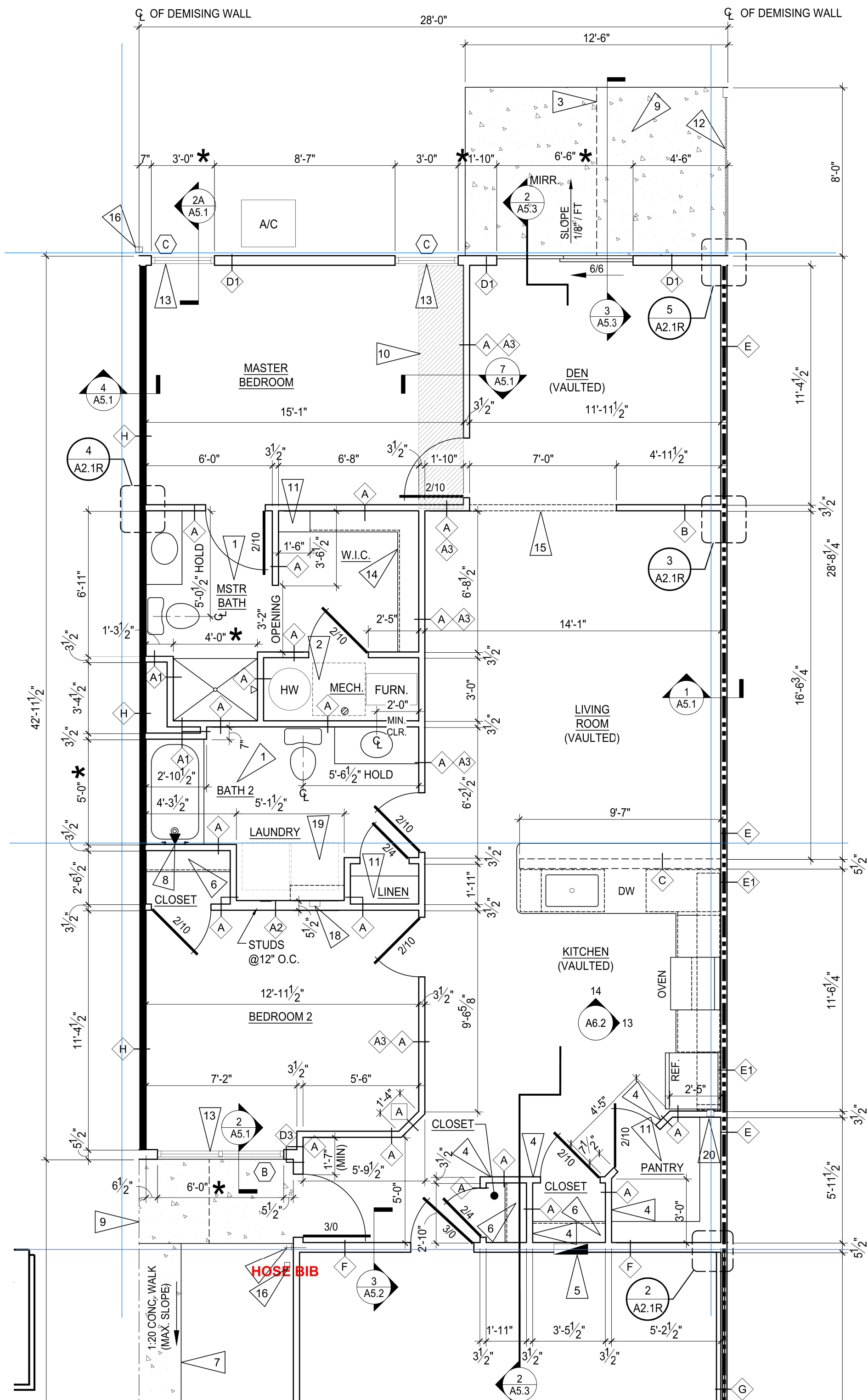

**GARAGE ON THIS SIDE OF BUILDING**

**NOTES:**

**MUST install tub boxes for tub and shower traps !! Wait until gravel prepped**

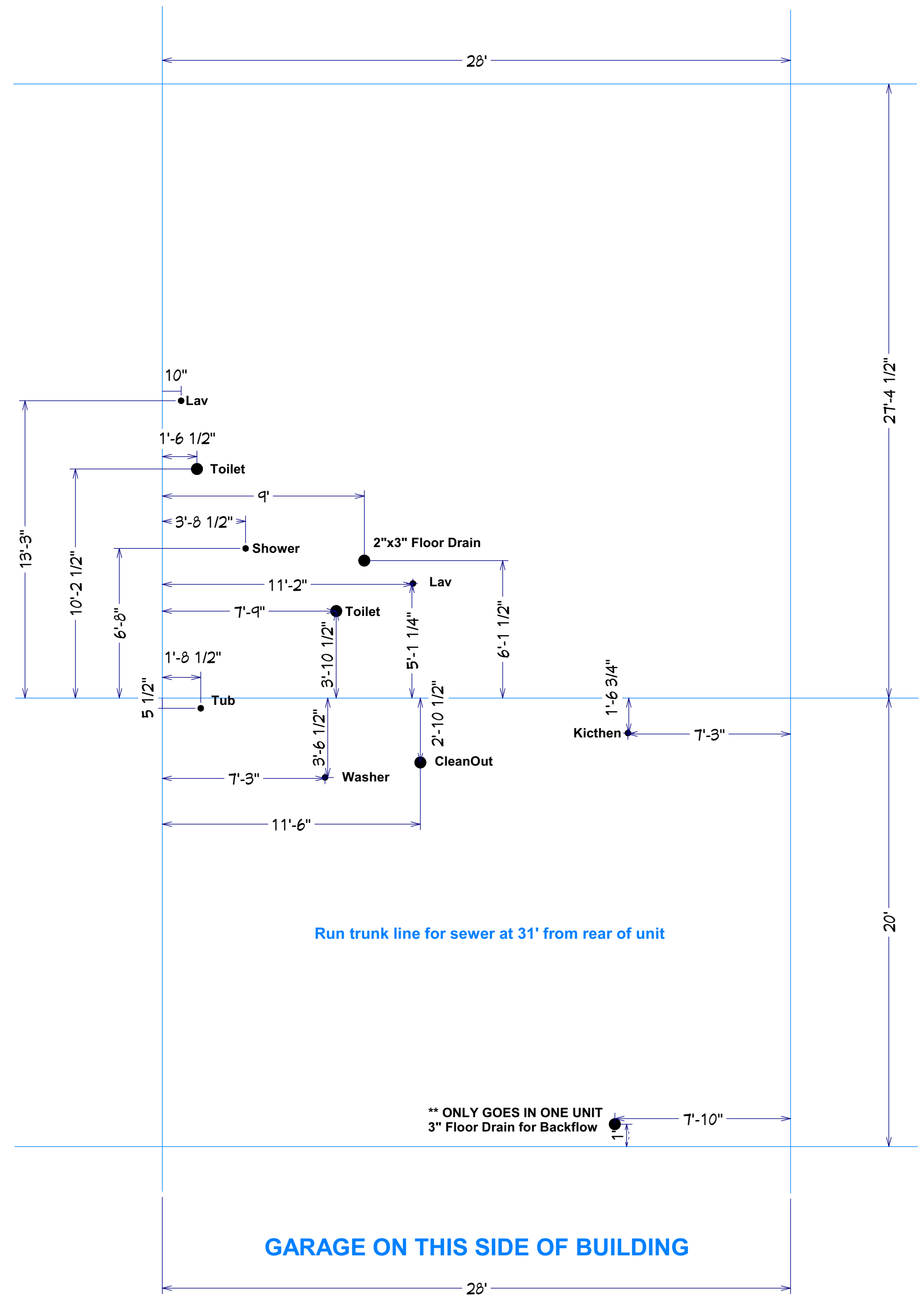

**Forestwood Right PVC**

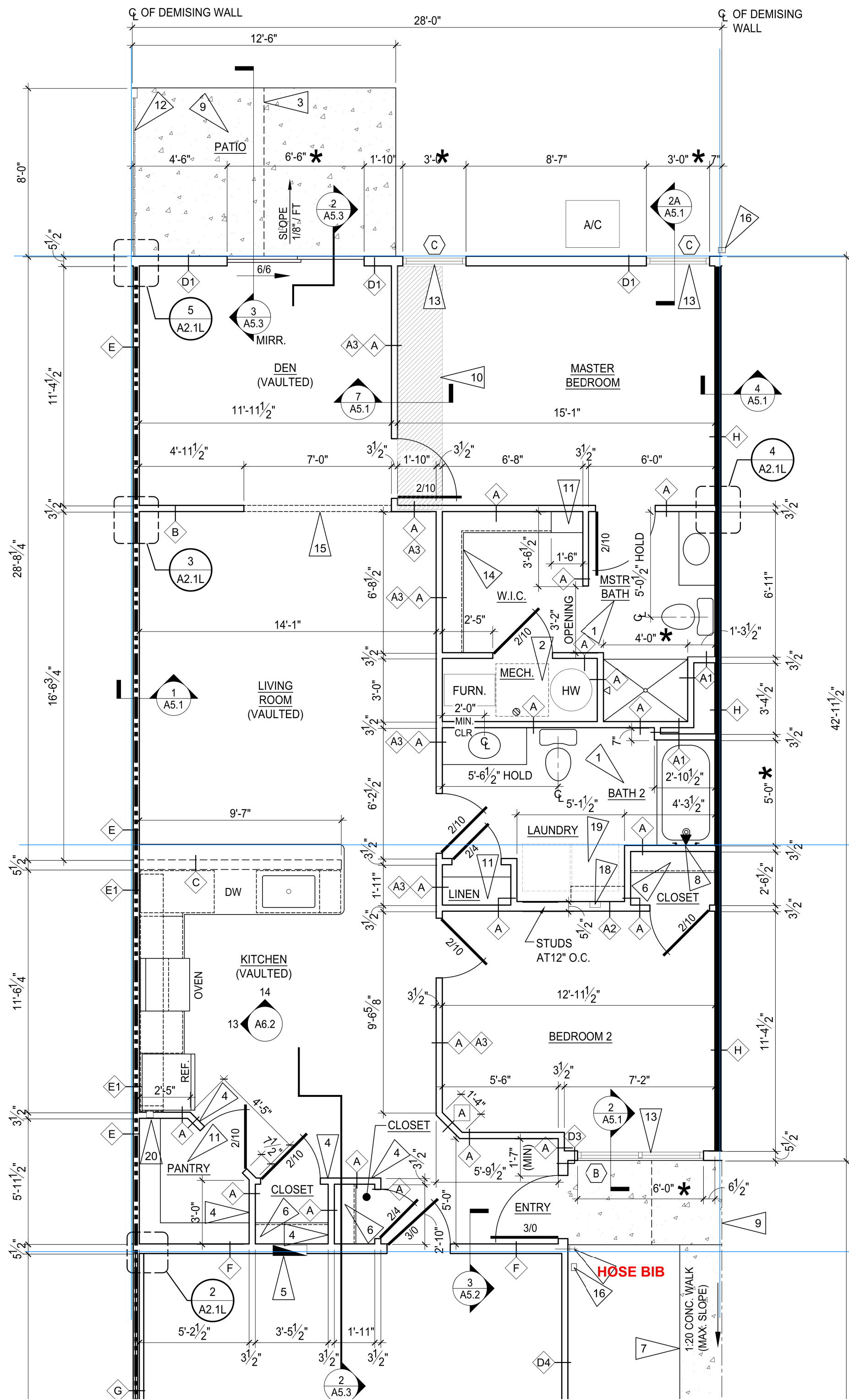

**GARAGE ON THIS SIDE OF BUILDING**

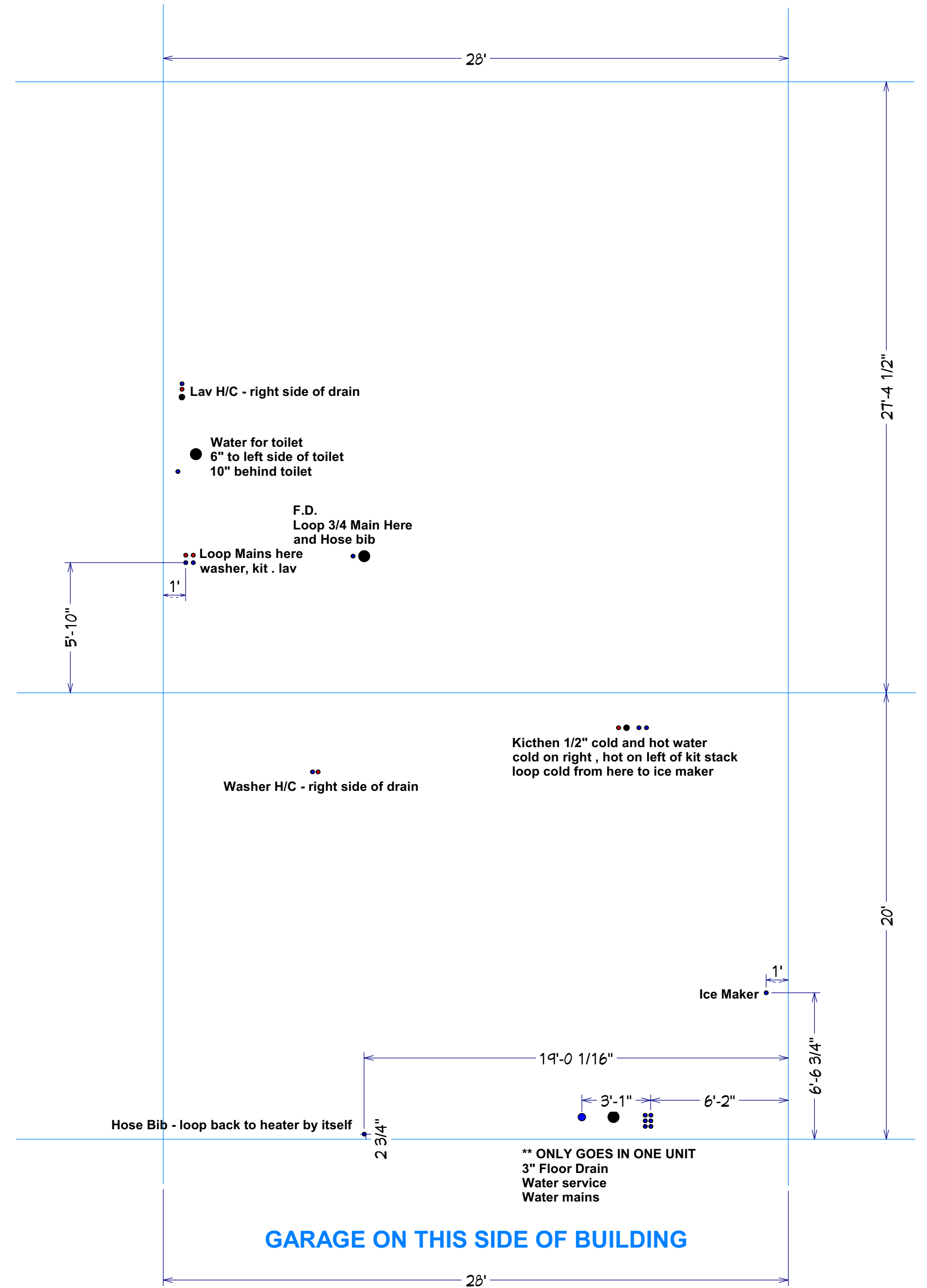

**Forestwood Right WATER**

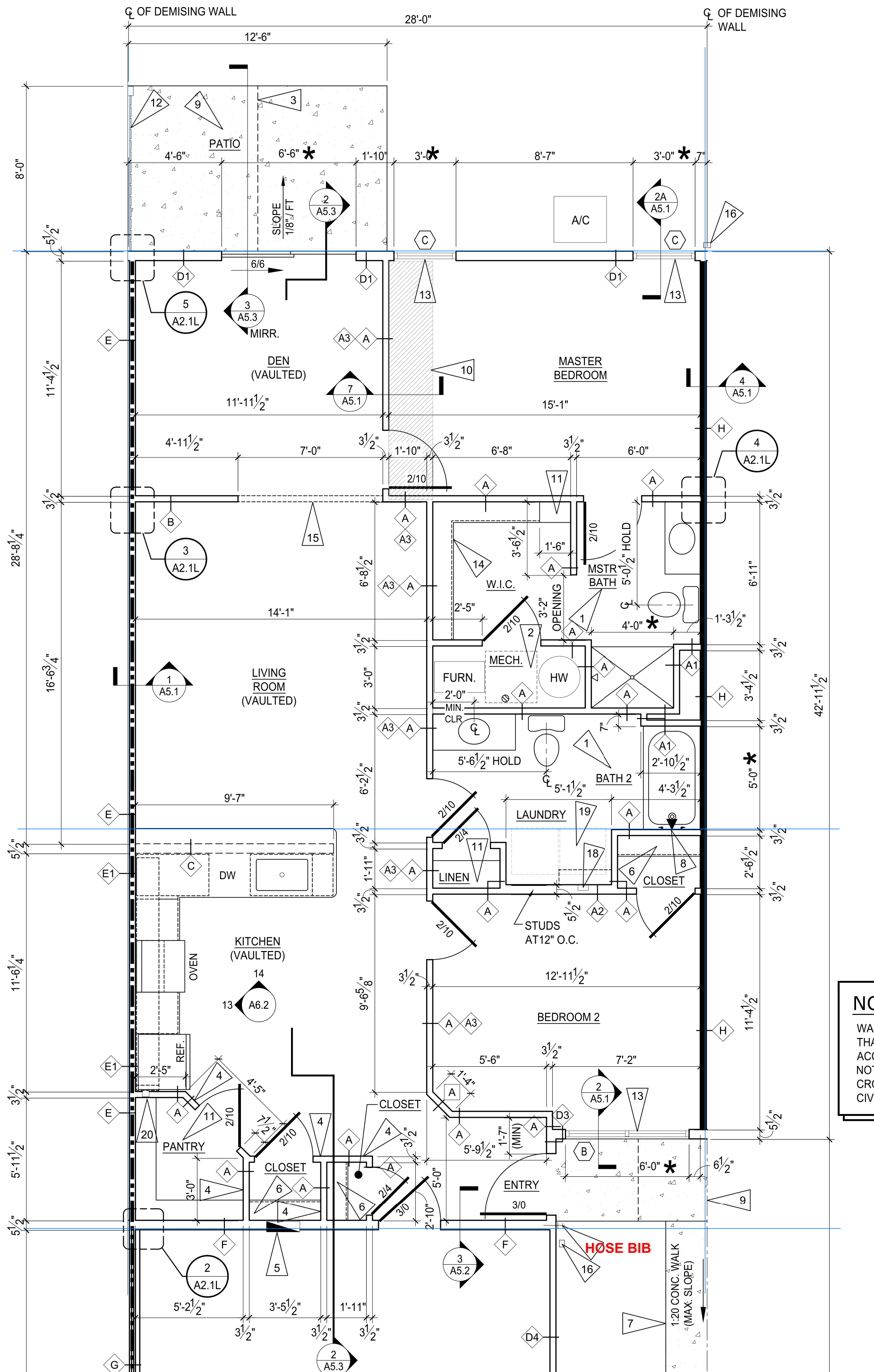

**GARAGE ON THIS SIDE OF BUILDING**

**NOTES:**

**MUST install tub boxes for tub and shower traps !! Wait until gravel prepped**

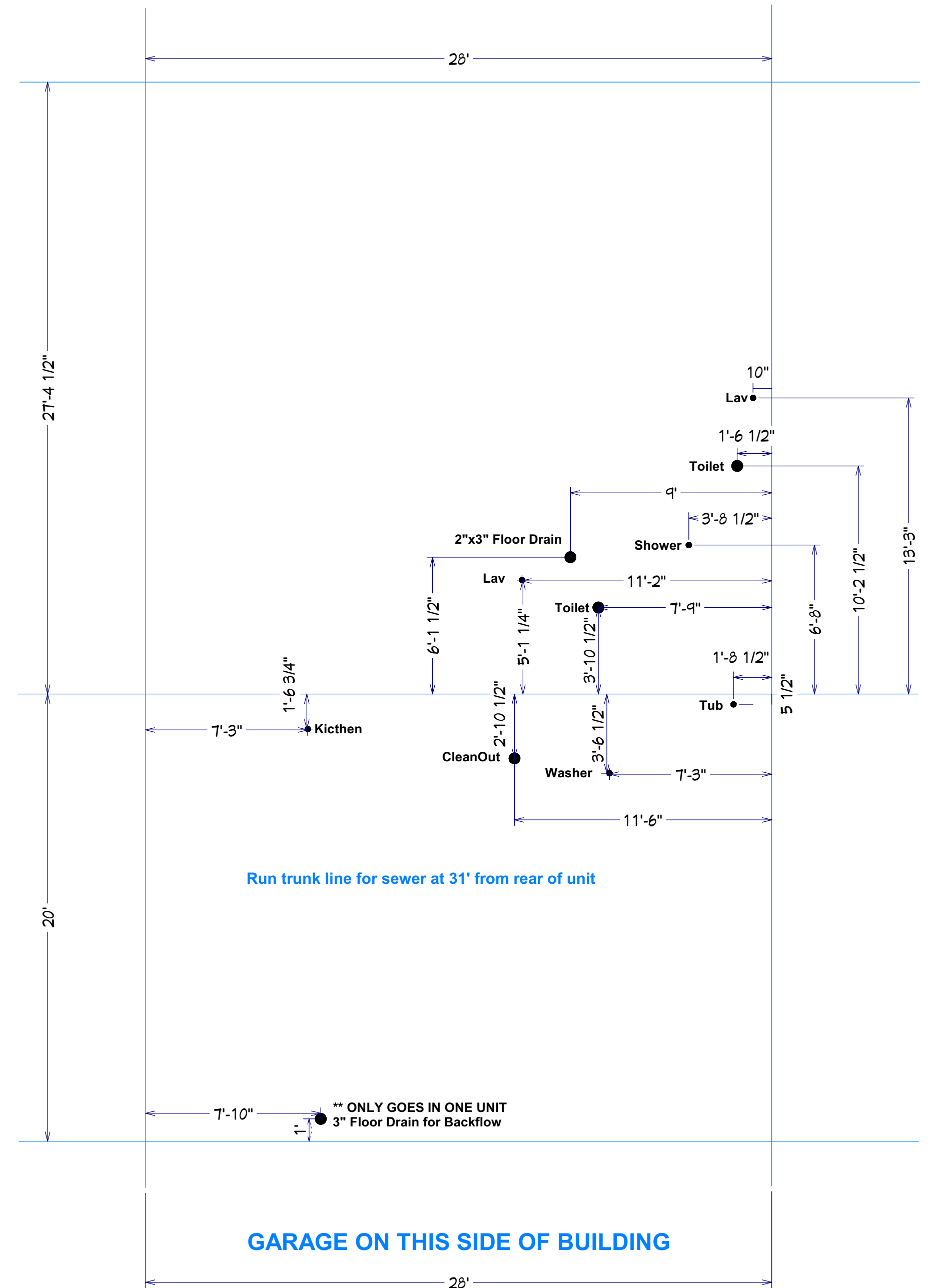

**Run trunk line for sewer at 31' from rear of unit**

**GARAGE ON THIS SIDE OF BUILDING**

**Forestwood Left PVC**

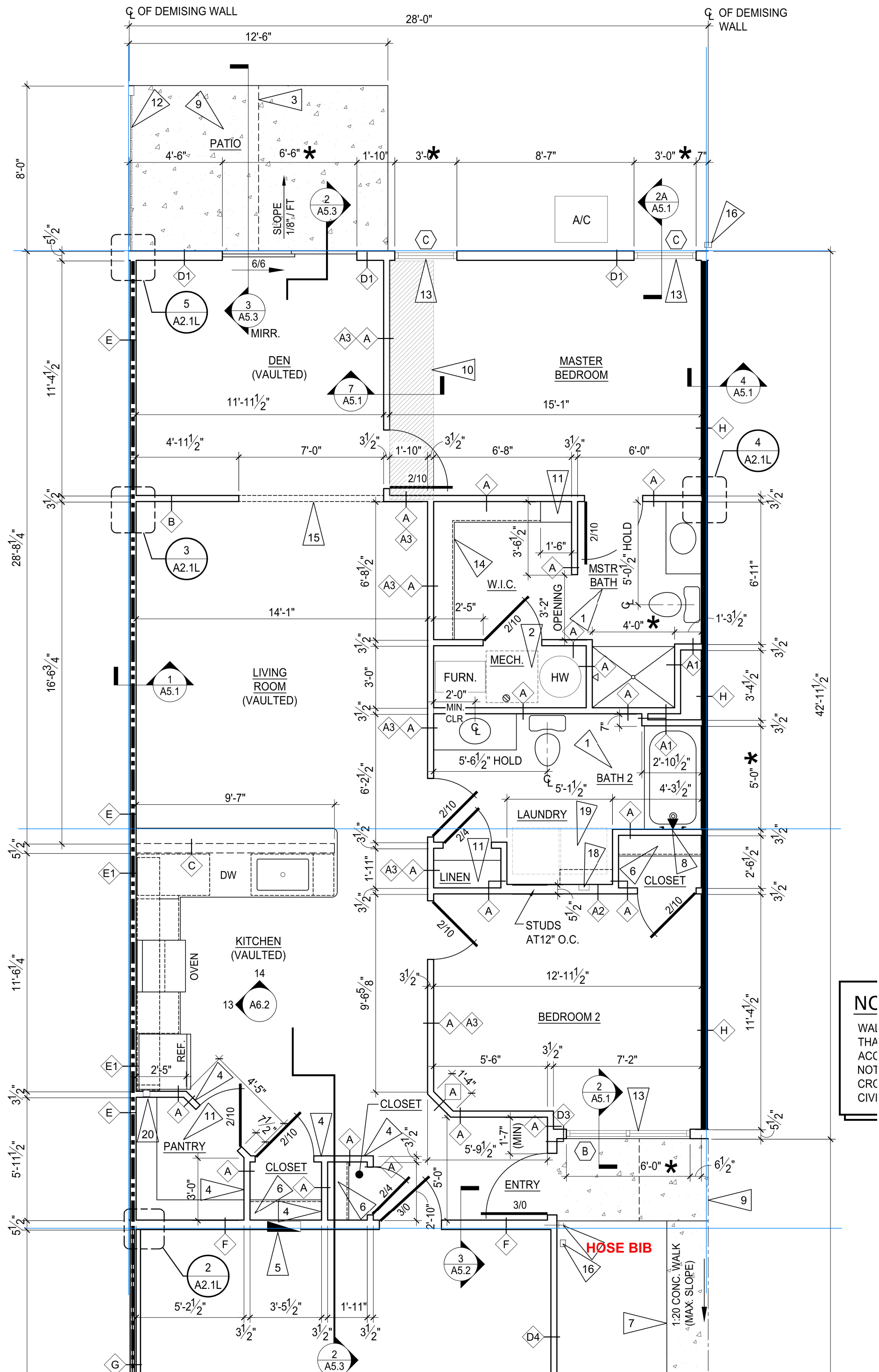

**GARAGE ON THIS SIDE OF BUILDING**

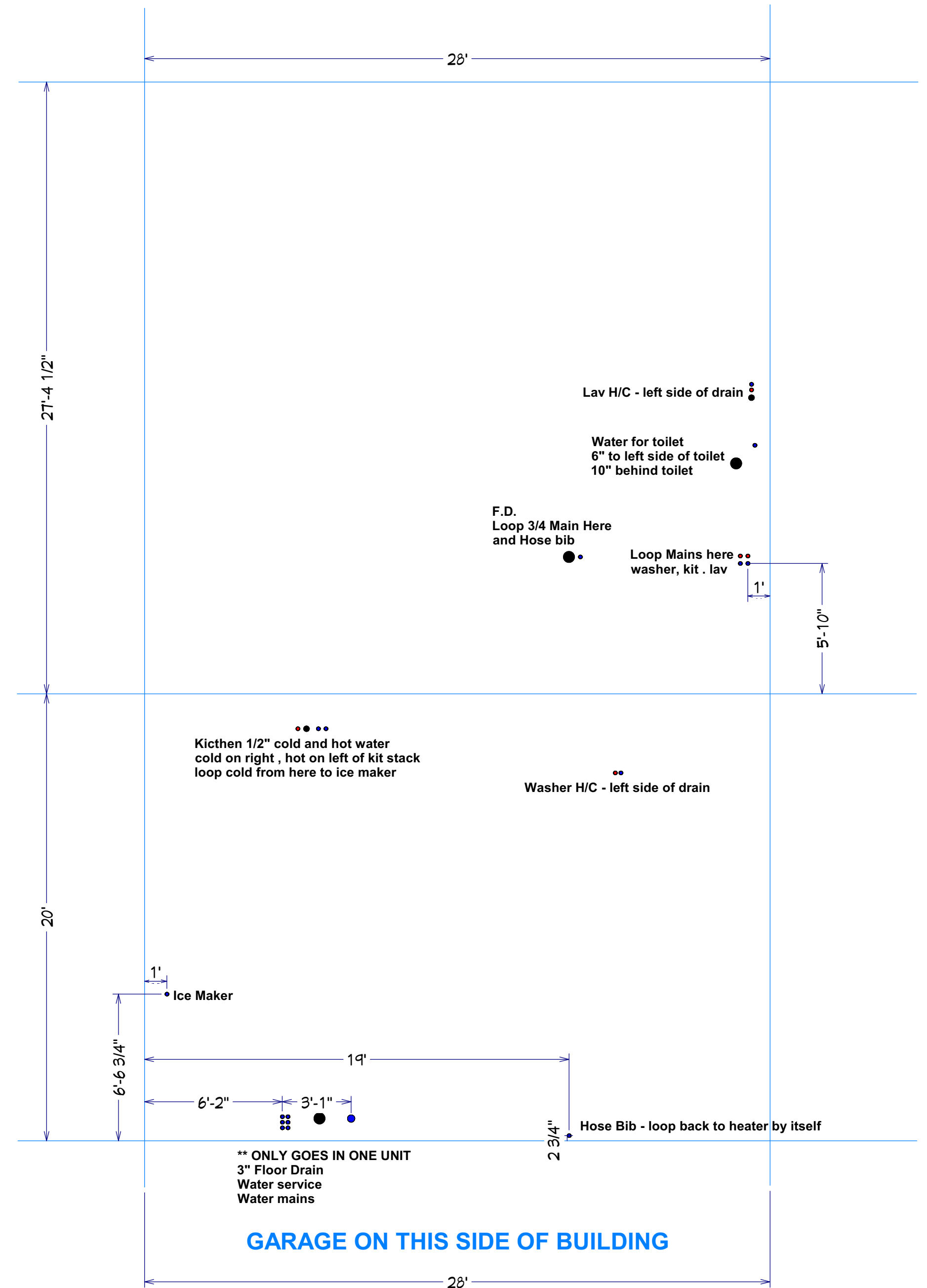

**GARAGE ON THIS SIDE OF BUILDING**

**Forestwood Left WATER**

NC  
WAI  
THA  
ACC  
NOT  
CRC  
CIVI

\*\* ONLY GOES IN ONE UNIT  
3" Floor Drain  
Water service  
Water mains



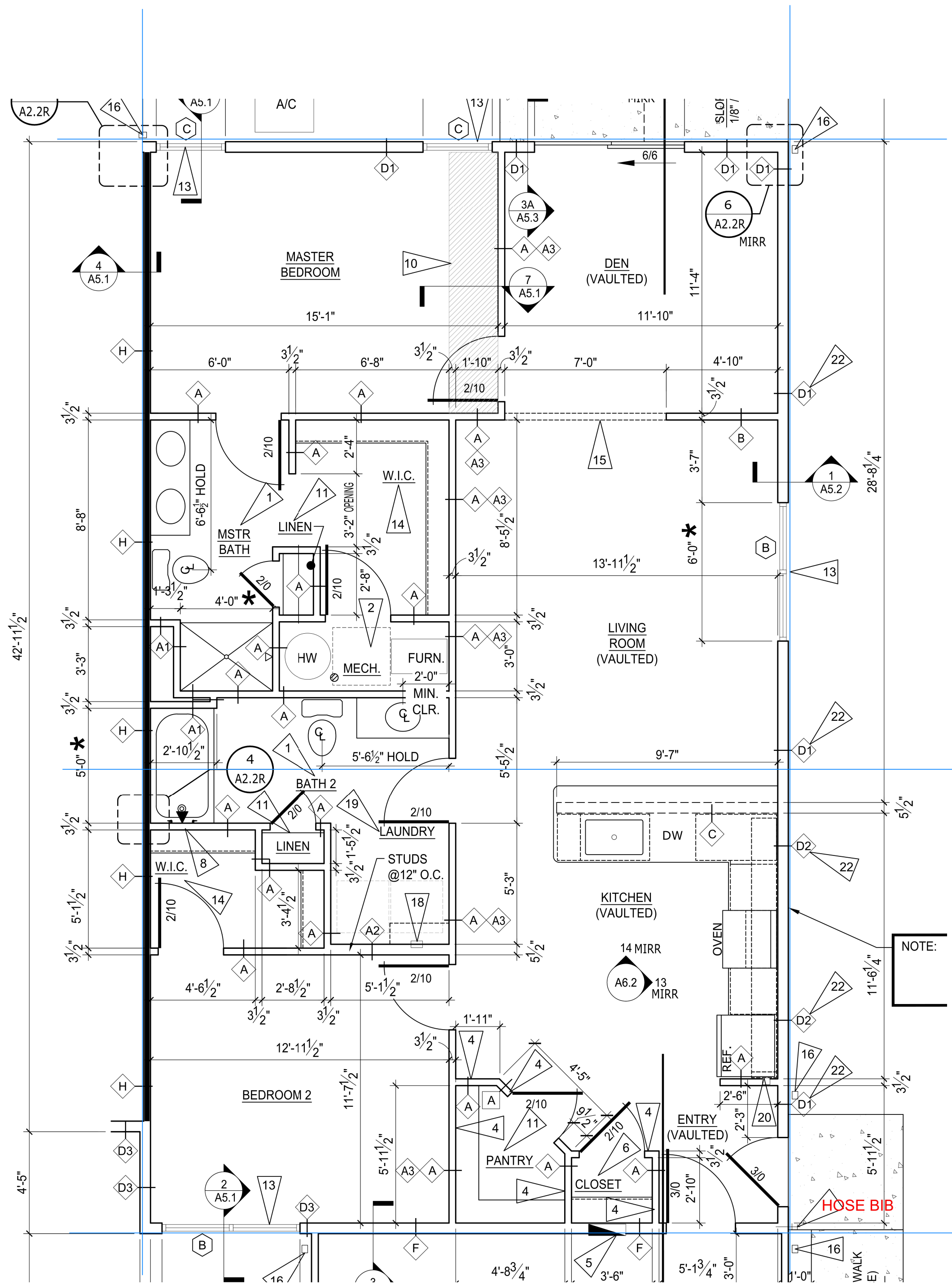

**NOTES:**

**MUST install tub boxes for tub and shower traps !! Wait until gravel prepped**

**Run trunk line for sewer at 31' from rear of unit**

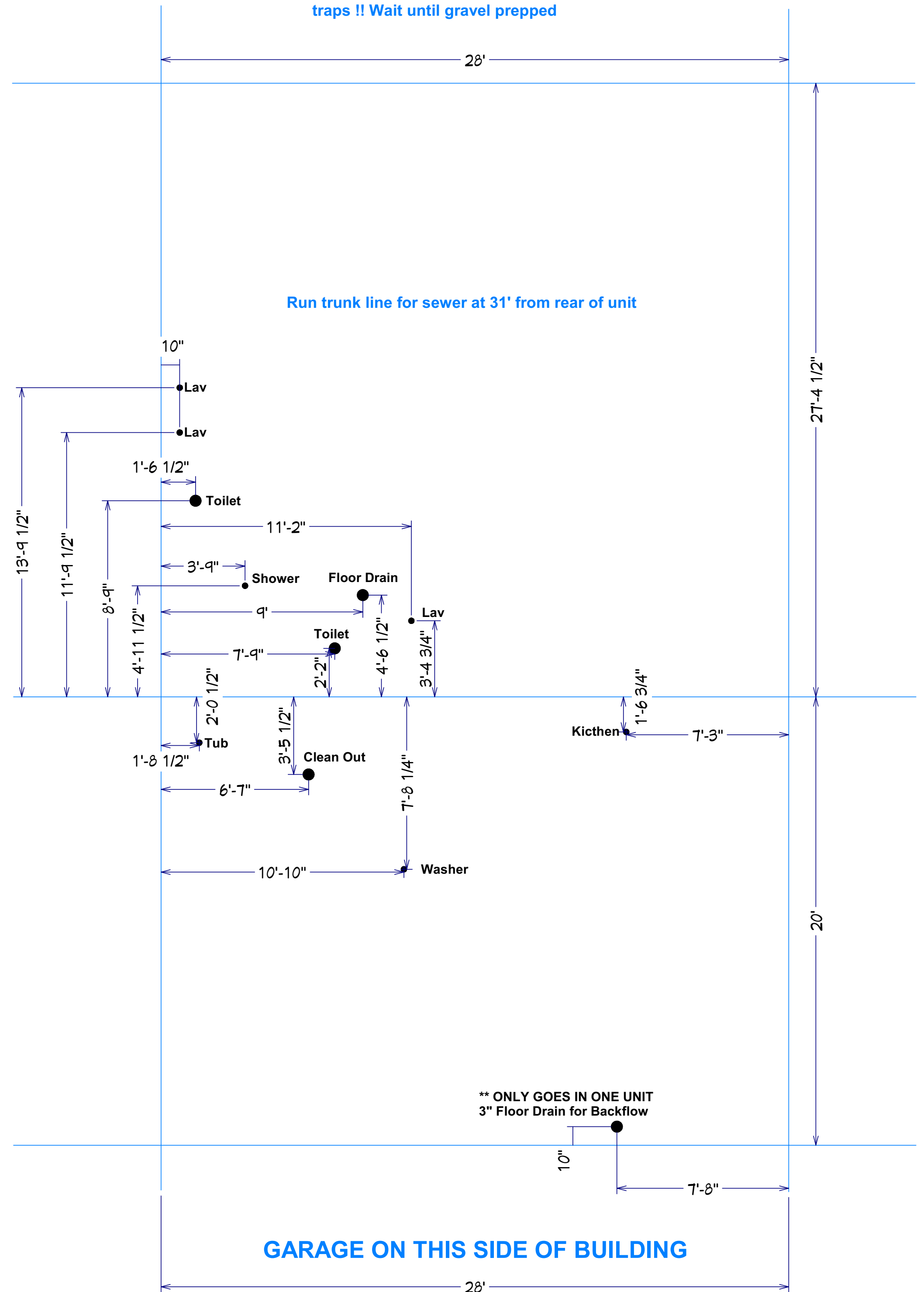

**GARAGE ON THIS SIDE OF BUILDING**

**Meadowood Right PVC**

**GARAGE ON THIS SIDE OF BUILDING**

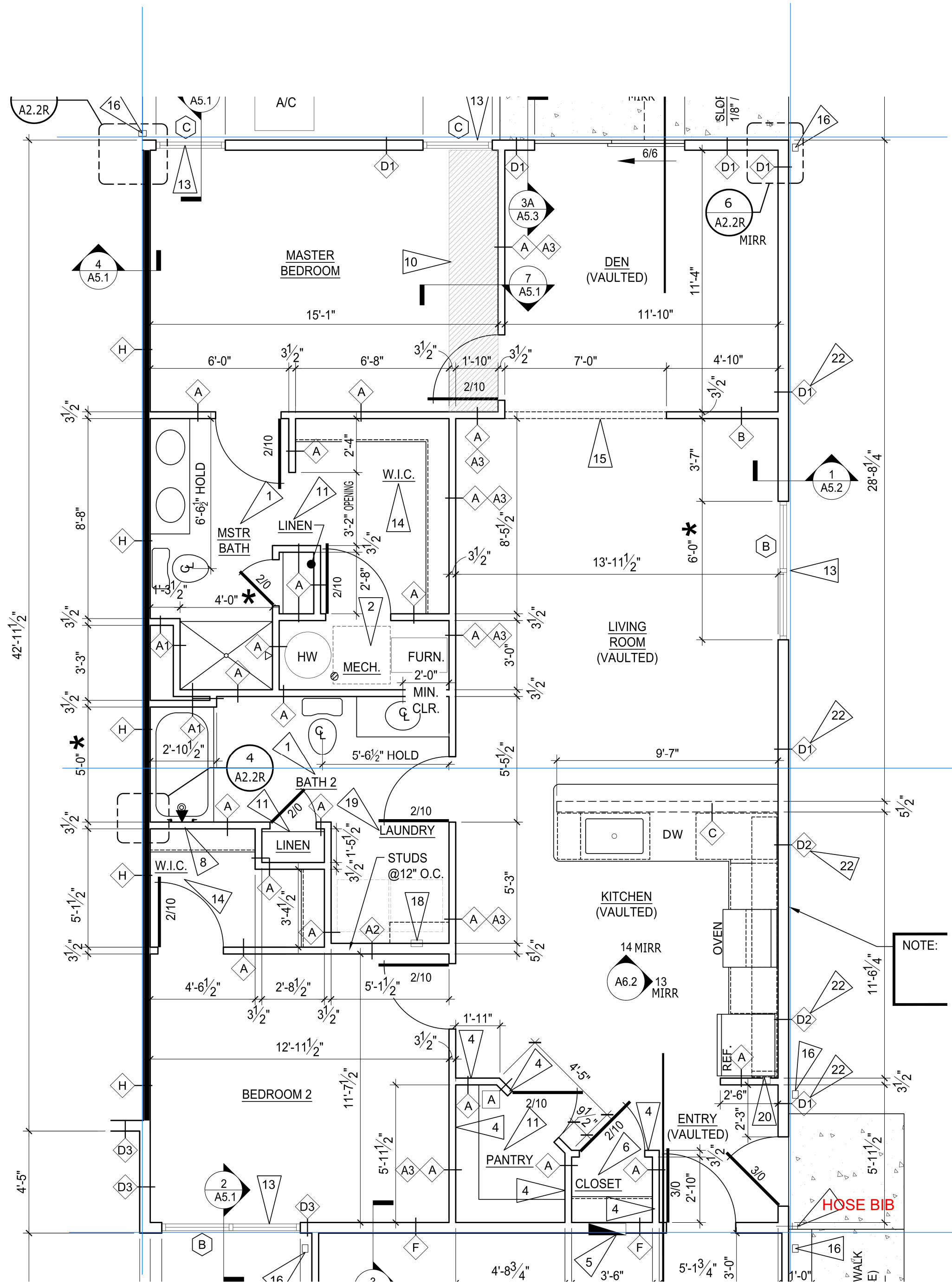

**GARAGE ON THIS SIDE OF BUILDING**

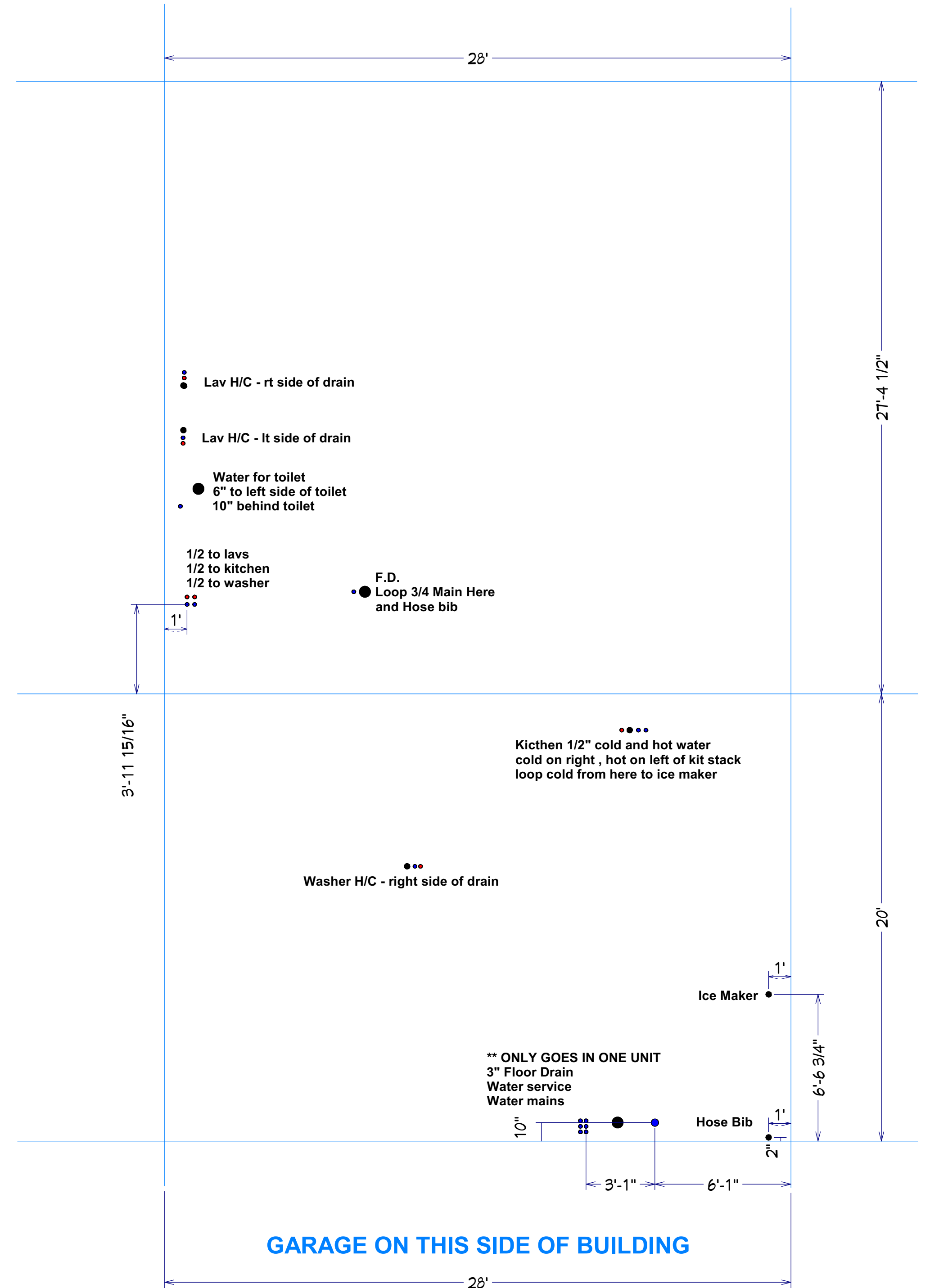

**Meadowood Right WATER**