

# Redwood Miamisburg North Springboro Pike OH P1 Construction Site Plan

Building Order

- J
- A
- GG
- FF
- H
- B
- G
- C
- F
- D
- E
- EE

31 Buildings-141 Units

- Forestwood (37)
- Meadowood (24)
- Capewood (5)
- Willowood (12)
- Breezewood (59)
- Breezewood SR (4)
- High Profile Side
- Building Step

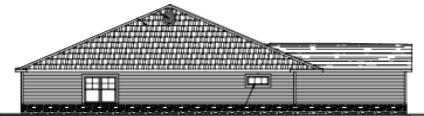

# BUILDING EE

- 1 - Meadowood Left
- 2 - Forestwood Right
- 2 - Forestwood Left
- 1 - Meadowood Right

8" BREAK  
168'-0" (OVERALL)

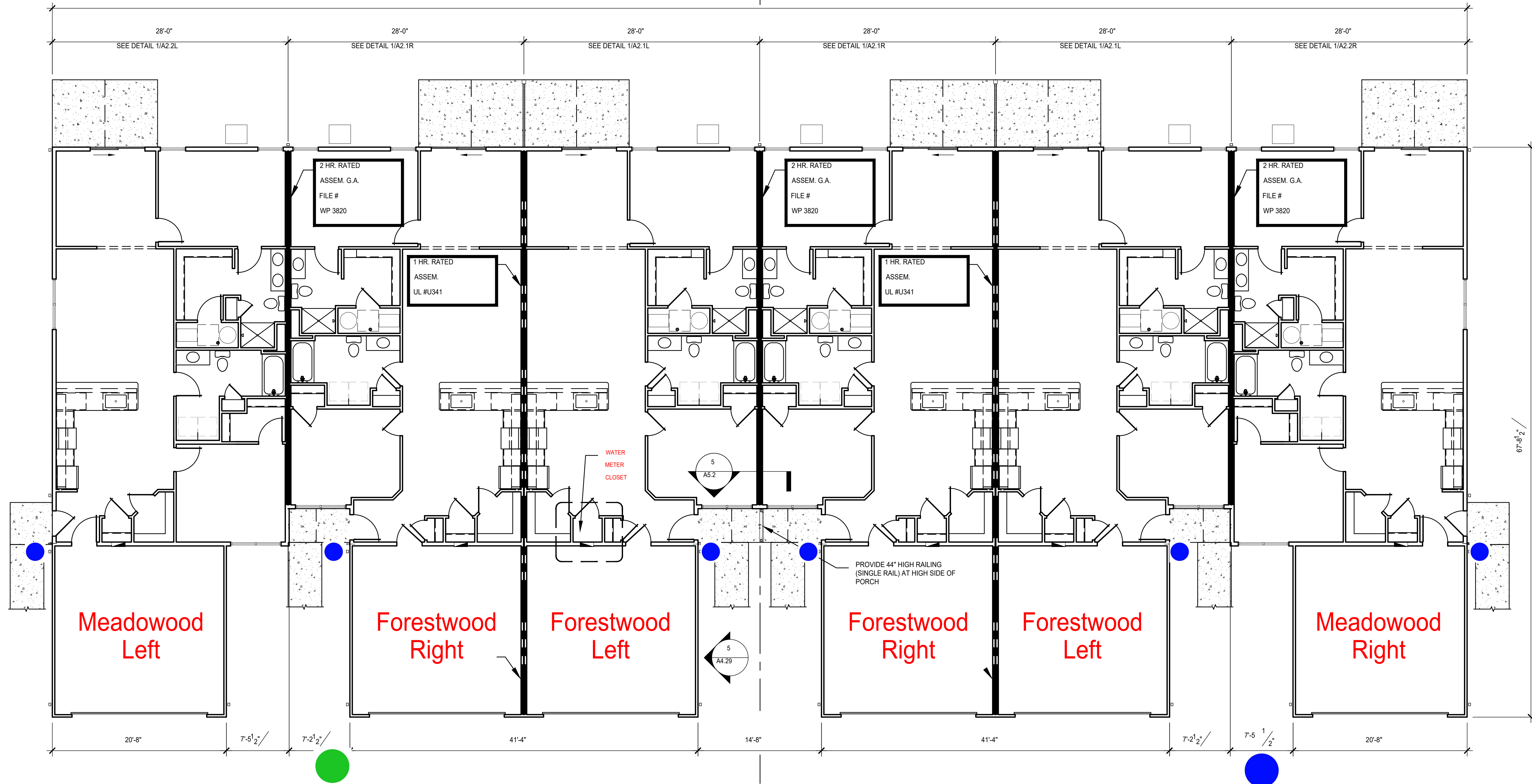

6" SEWER TAP

1.5" WATER TAP



REVISIONS

phone 330.666.5770  
fax 330.666.8812  
3660 Embassy Parkway  
Fairlawn, OH 44333

**MPG**  
MANN • PARSONS • GRAY  
ARCHITECTS  
mpg-architects.com

OVERALL FLOOR PLANS - BLDGS.; EE, FF

DATE: JULY 27, 2022

PROJECT #: 33521

REDWOOD MIAMISBURG

MIAMISBURG OH, 45449



**A2.37**

68 OF 137

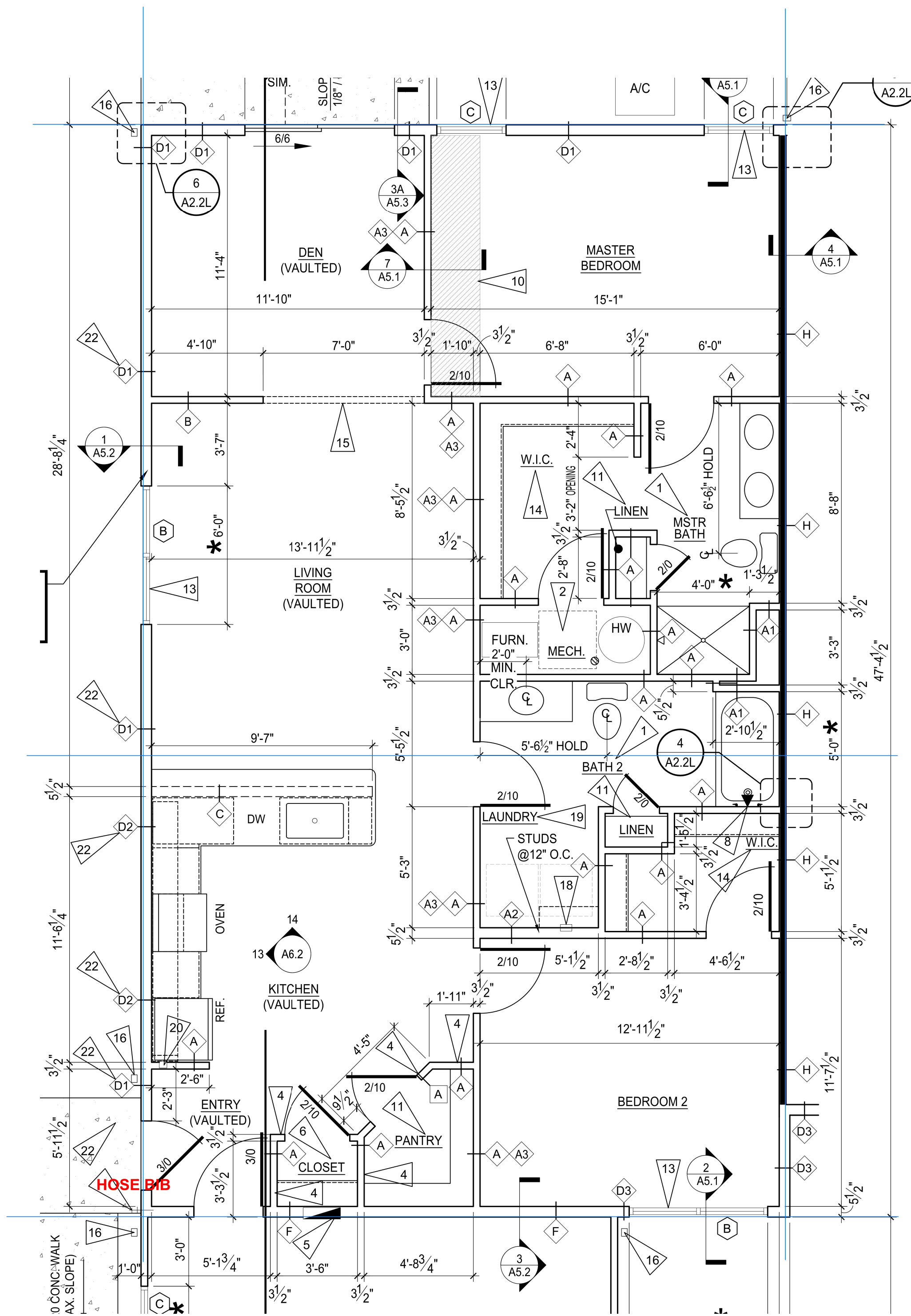

**GARAGE ON THIS SIDE OF BUILDING**

**NOTES:**

**MUST install tub boxes for tub and shower traps !! Wait until gravel prepped**

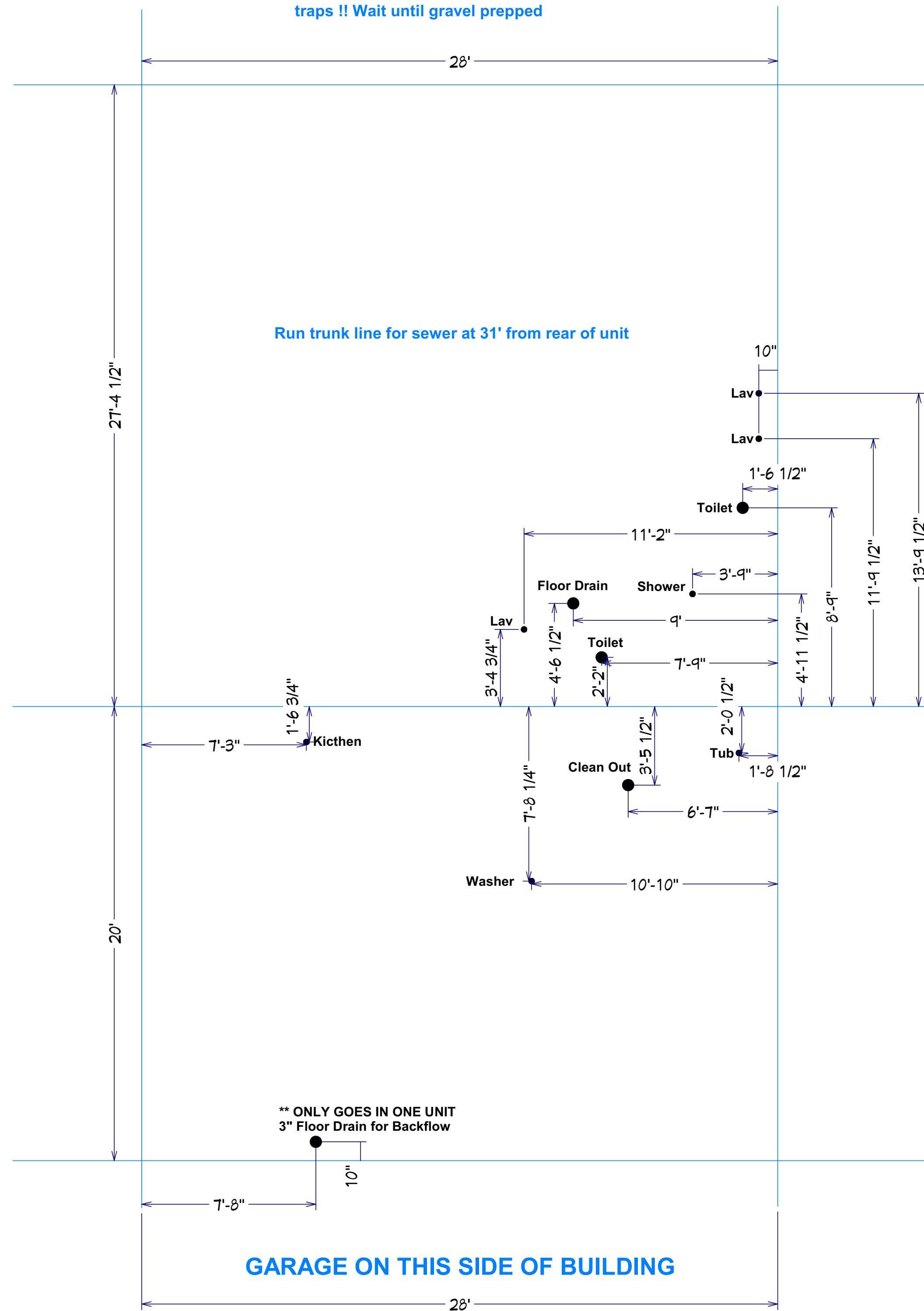

**GARAGE ON THIS SIDE OF BUILDING**

**Meadowood Left PVC**

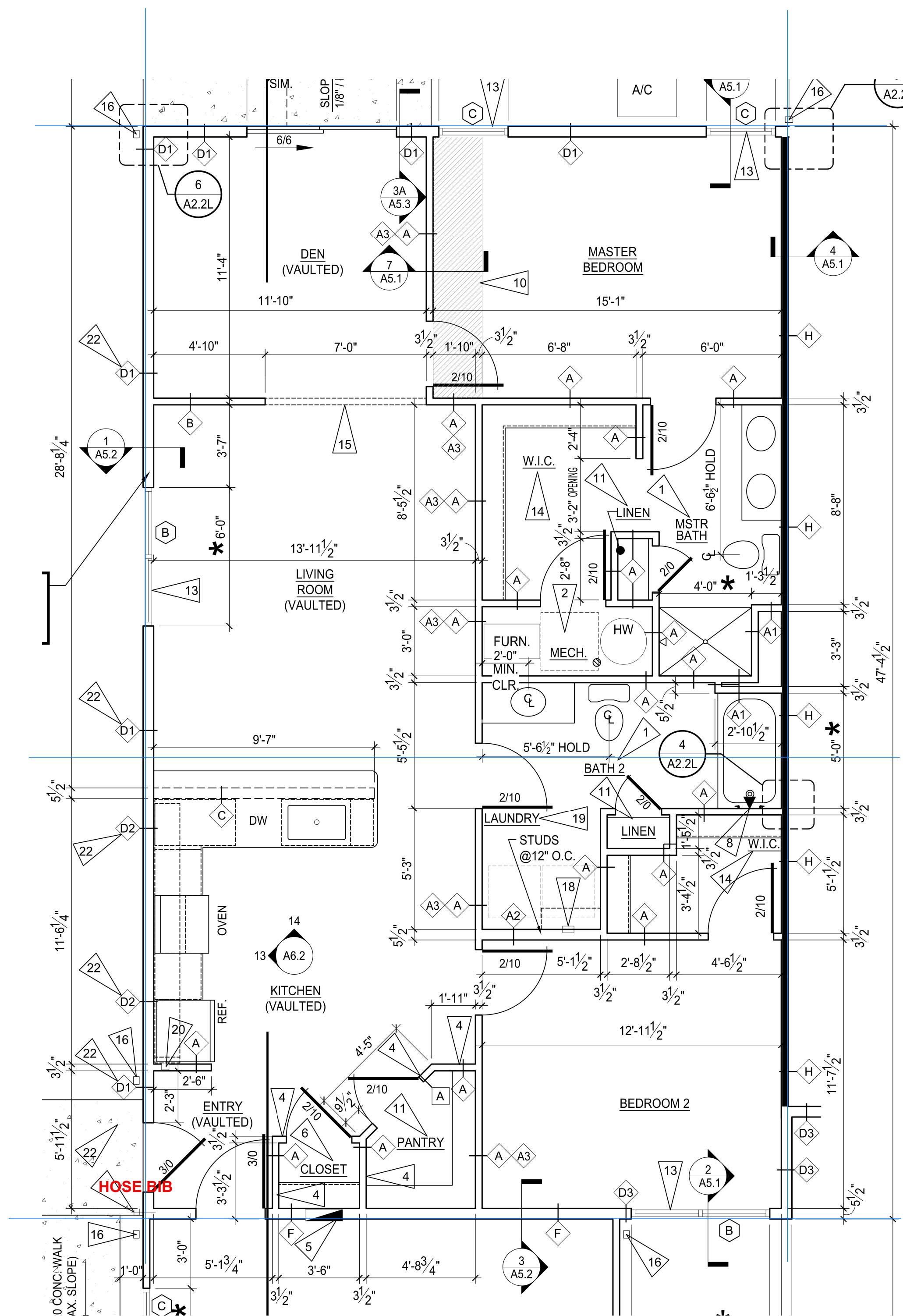

**GARAGE ON THIS SIDE OF BUILDING**

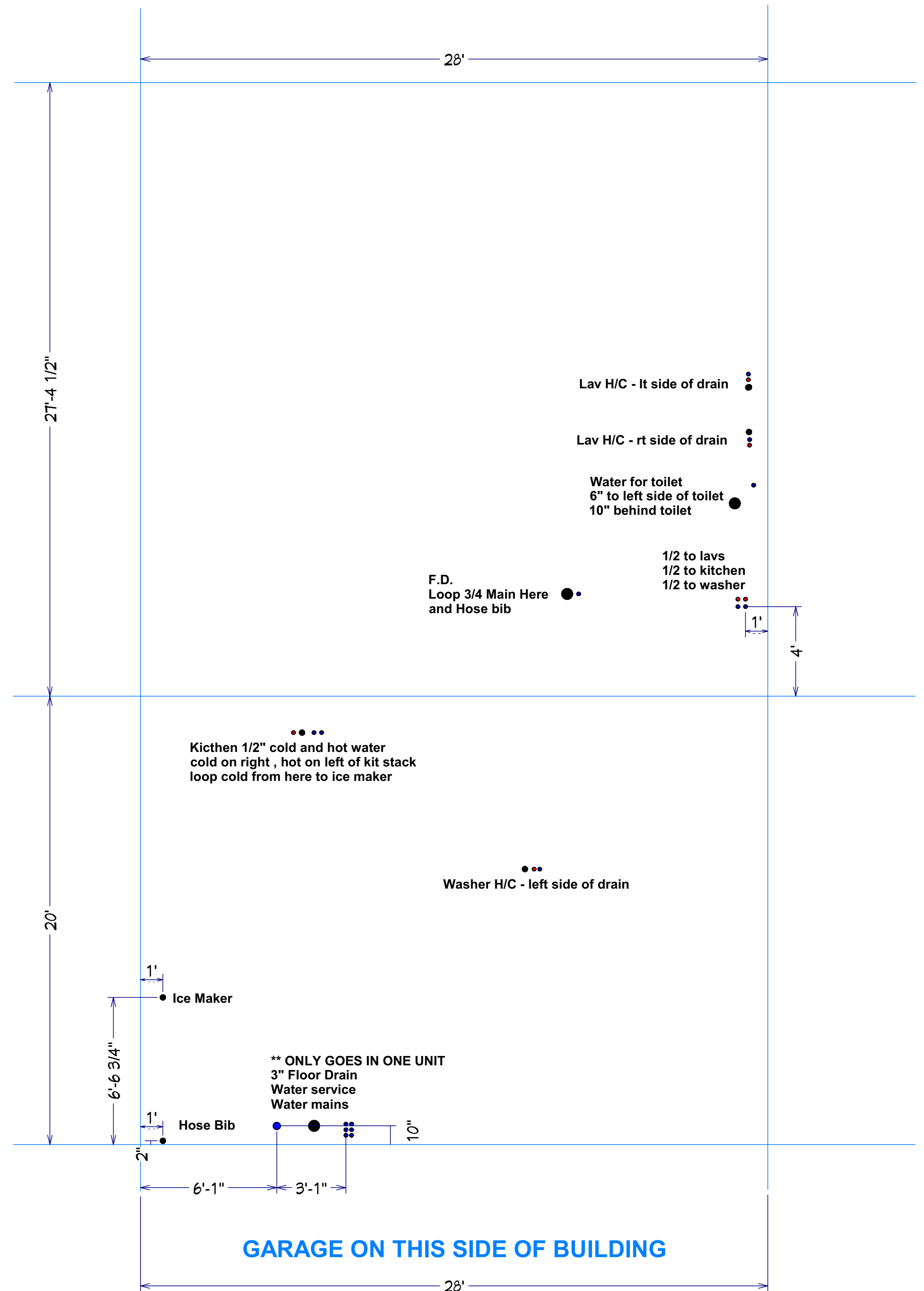

**GARAGE ON THIS SIDE OF BUILDING**

**Meadowood Left WATER**

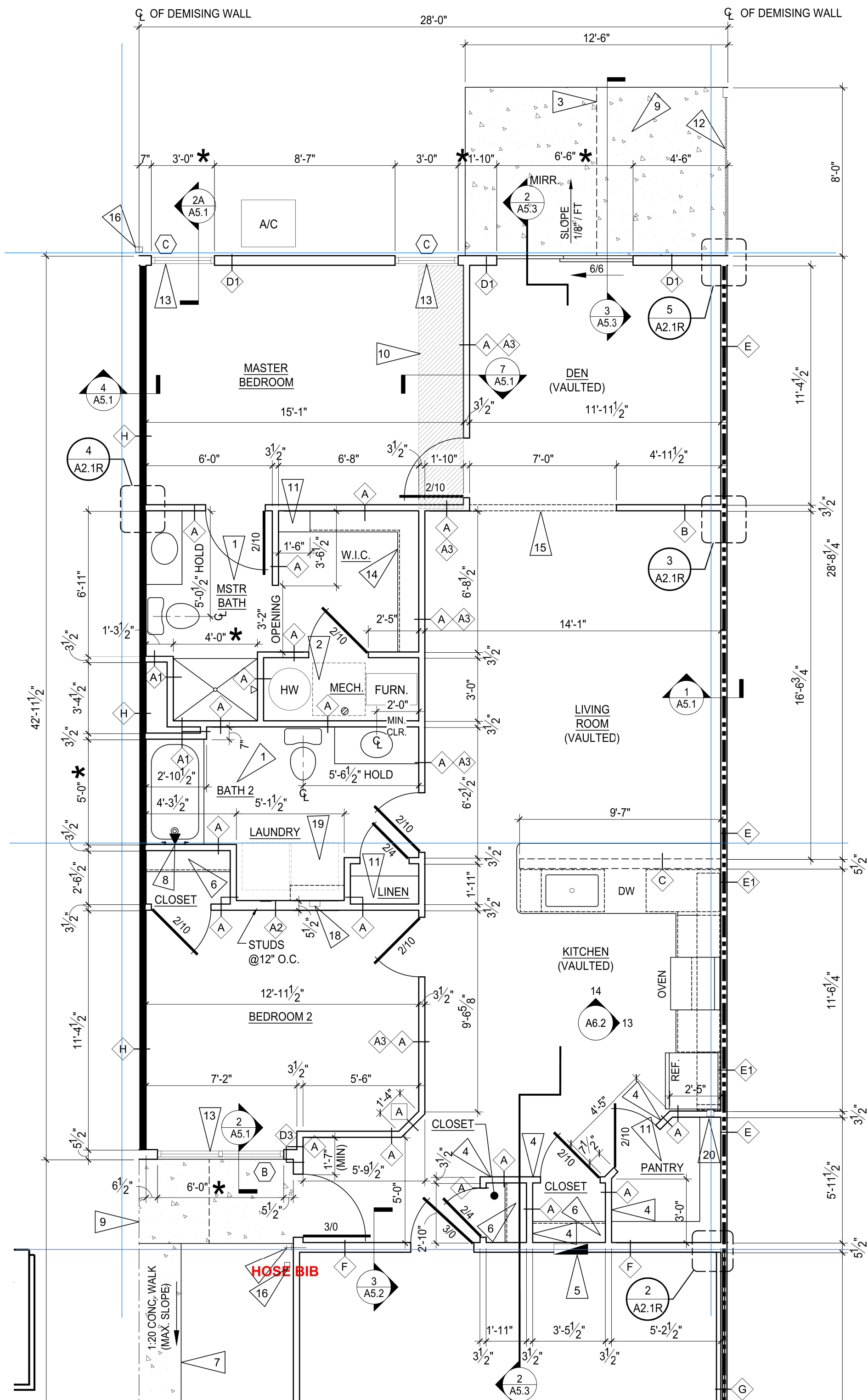

**GARAGE ON THIS SIDE OF BUILDING**

**NOTES:**

**MUST install tub boxes for tub and shower traps !! Wait until gravel prepped**

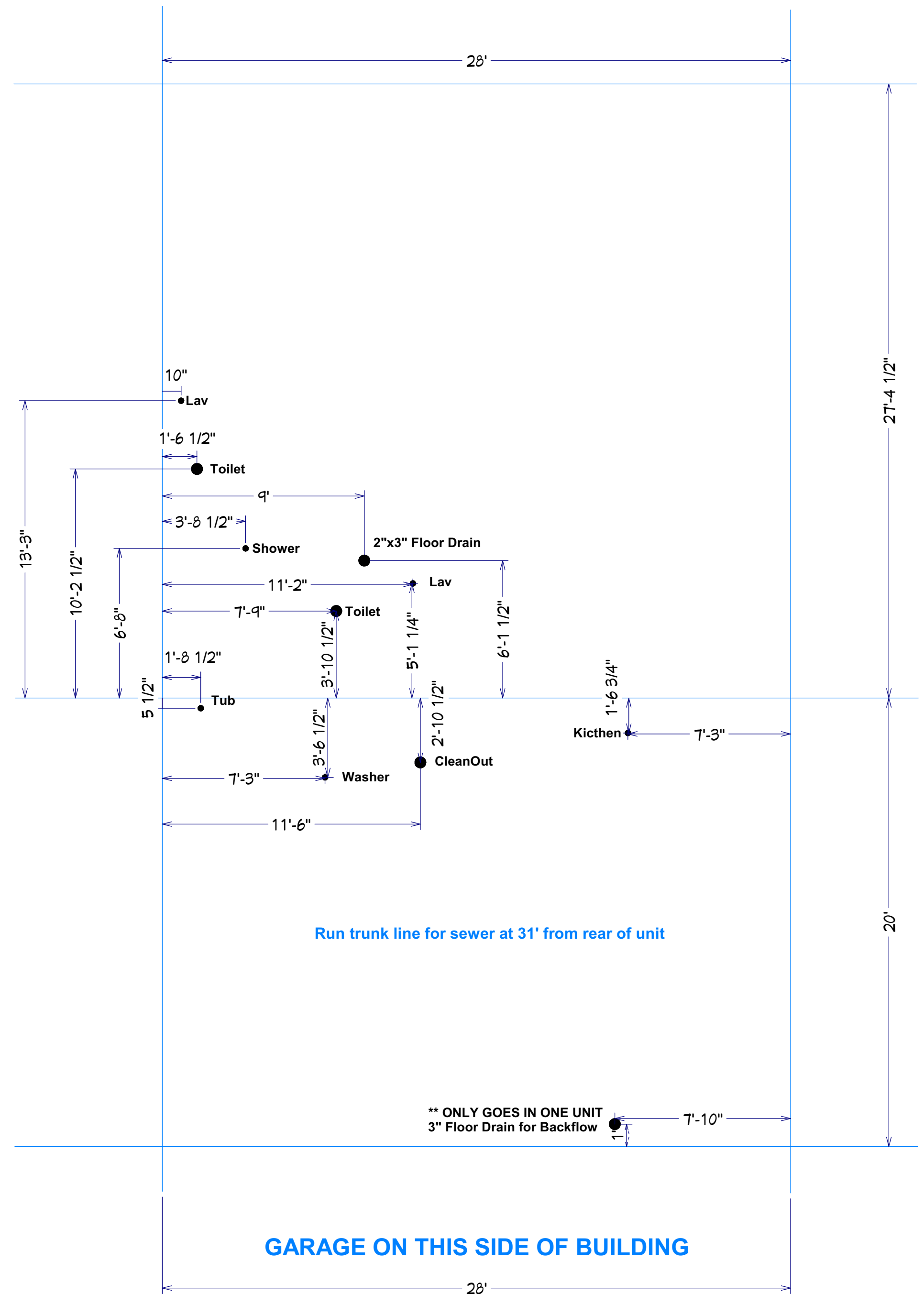

**Run trunk line for sewer at 31' from rear of unit**

**\*\* ONLY GOES IN ONE UNIT  
3" Floor Drain for Backflow**

**GARAGE ON THIS SIDE OF BUILDING**

**Forestwood Right PVC**

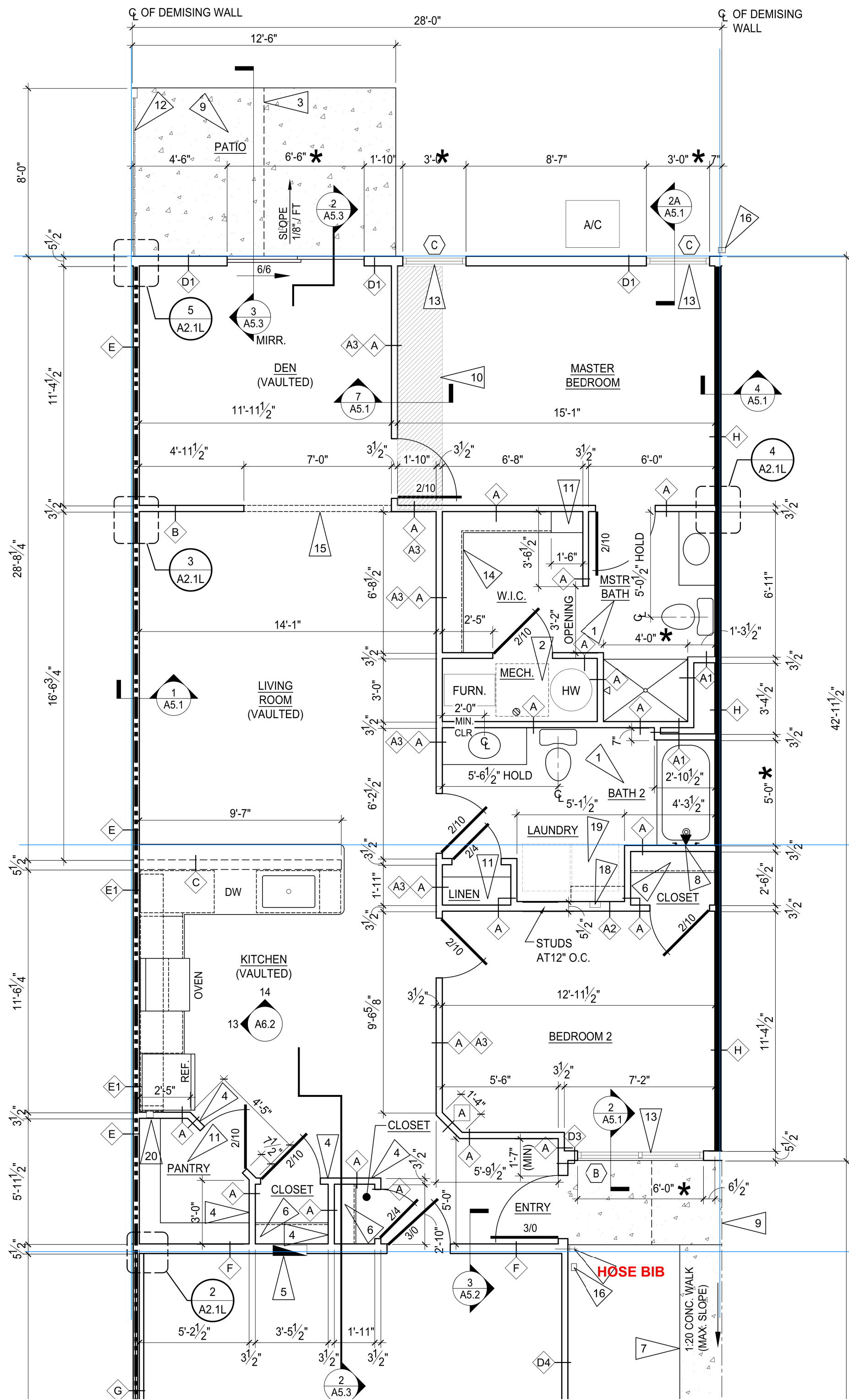

**GARAGE ON THIS SIDE OF BUILDING**

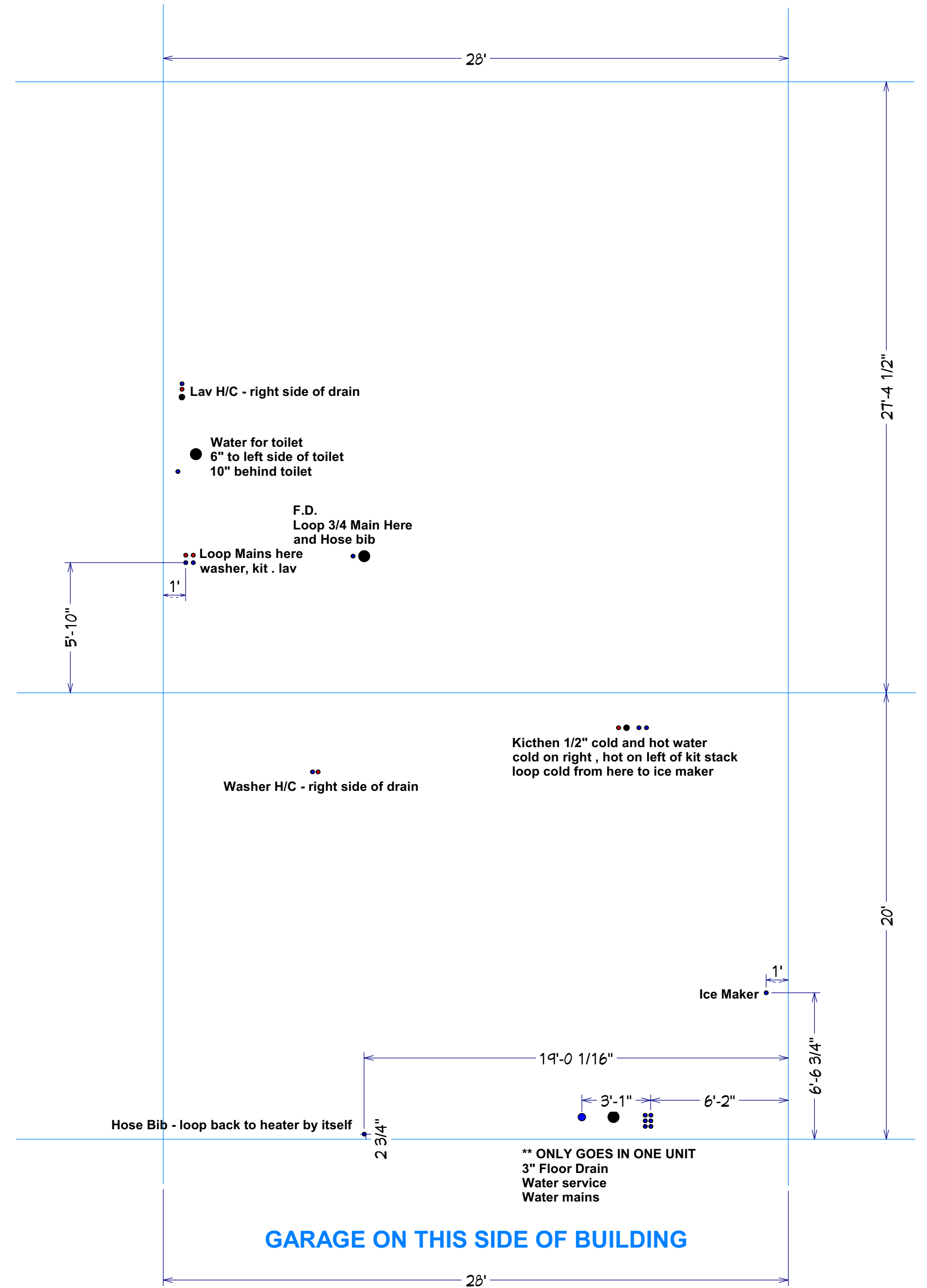

**Forestwood Right WATER**

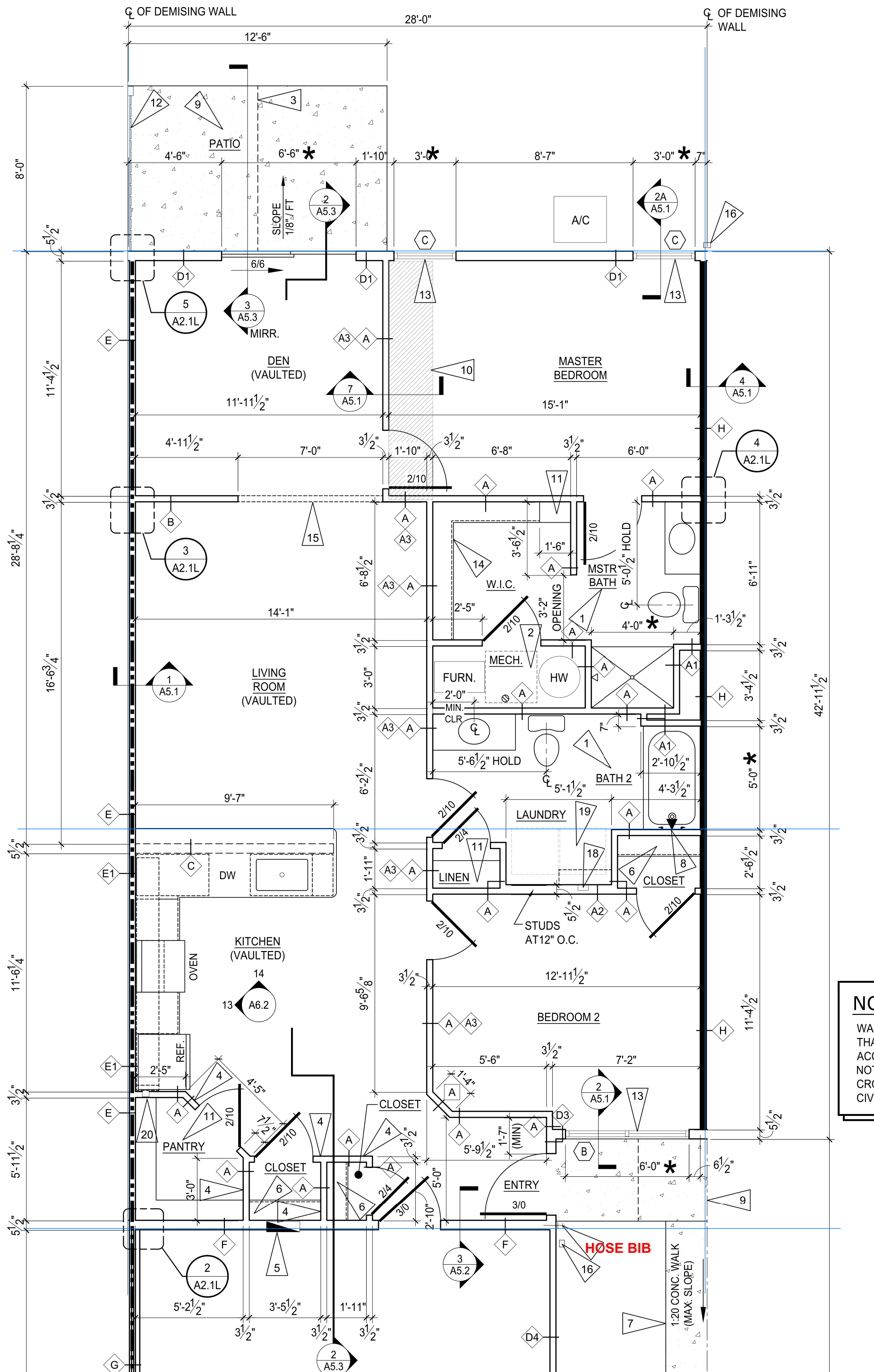

**GARAGE ON THIS SIDE OF BUILDING**

**NOTES:**

**MUST install tub boxes for tub and shower traps !! Wait until gravel prepped**

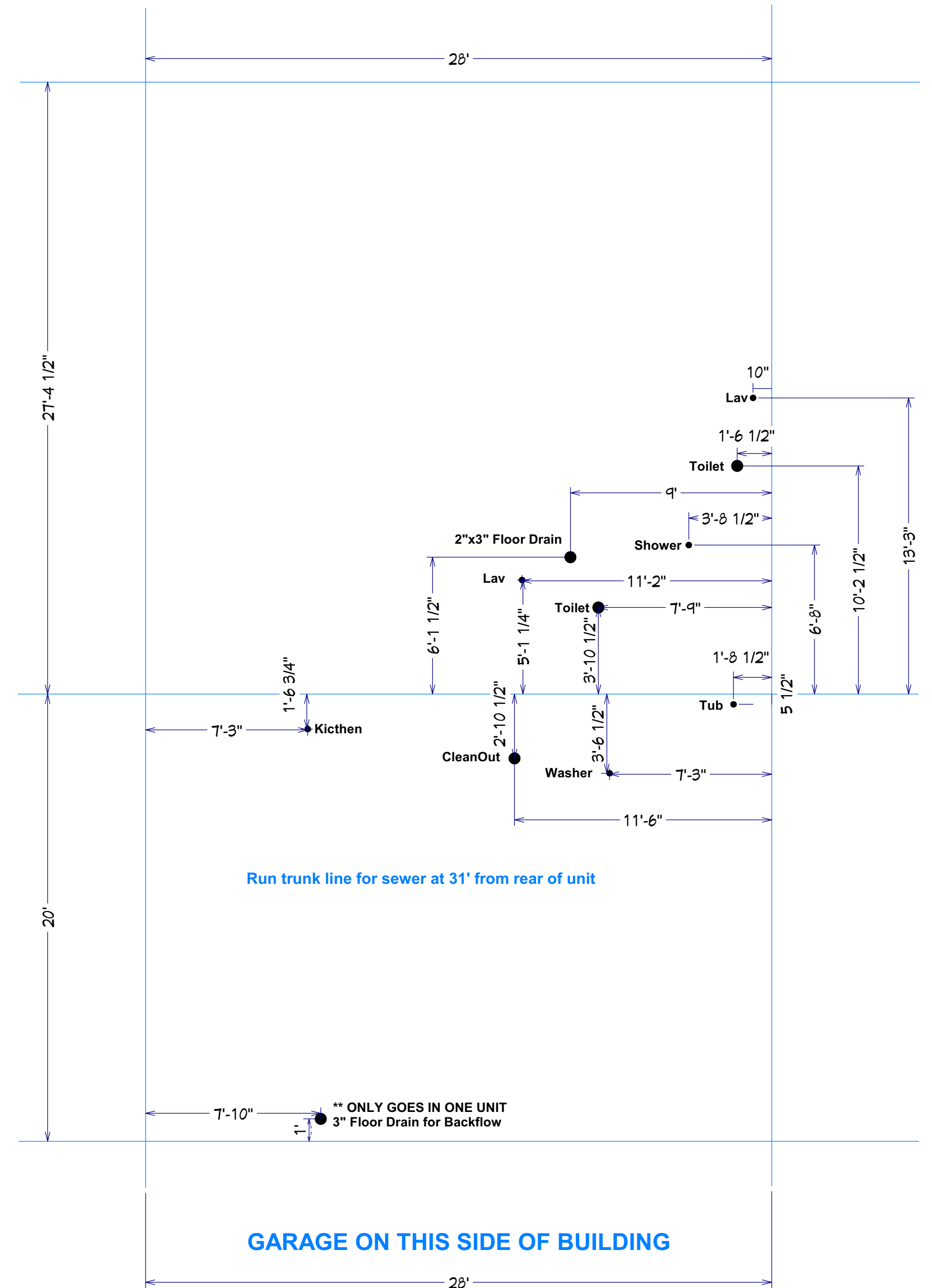

**GARAGE ON THIS SIDE OF BUILDING**

**Forestwood Left PVC**





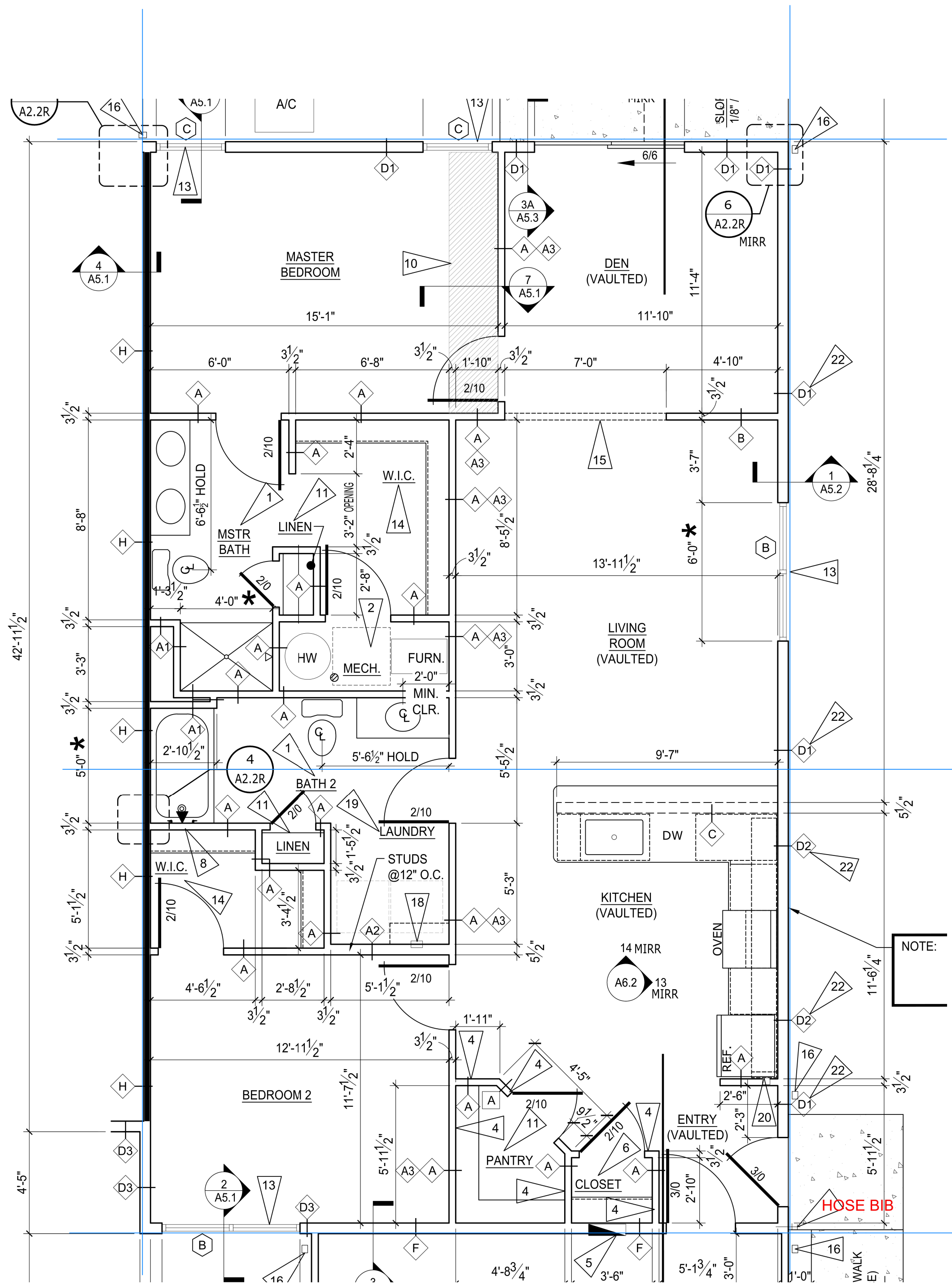

**NOTES:**

**MUST install tub boxes for tub and shower traps !! Wait until gravel prepped**

**Run trunk line for sewer at 31' from rear of unit**

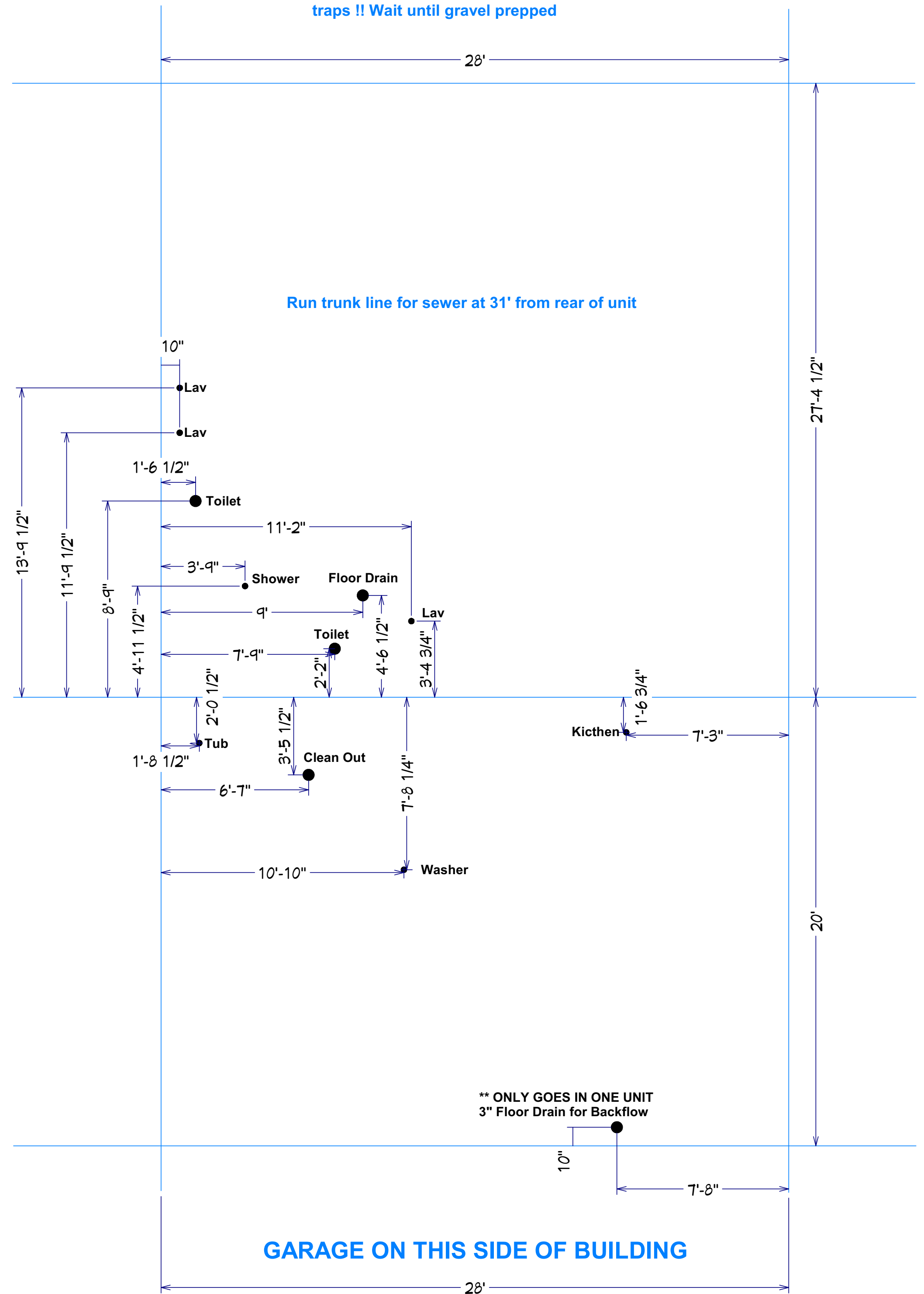

**\*\* ONLY GOES IN ONE UNIT  
3\" Floor Drain for Backflow**

**GARAGE ON THIS SIDE OF BUILDING**

**Meadowood Right PVC**

**GARAGE ON THIS SIDE OF BUILDING**

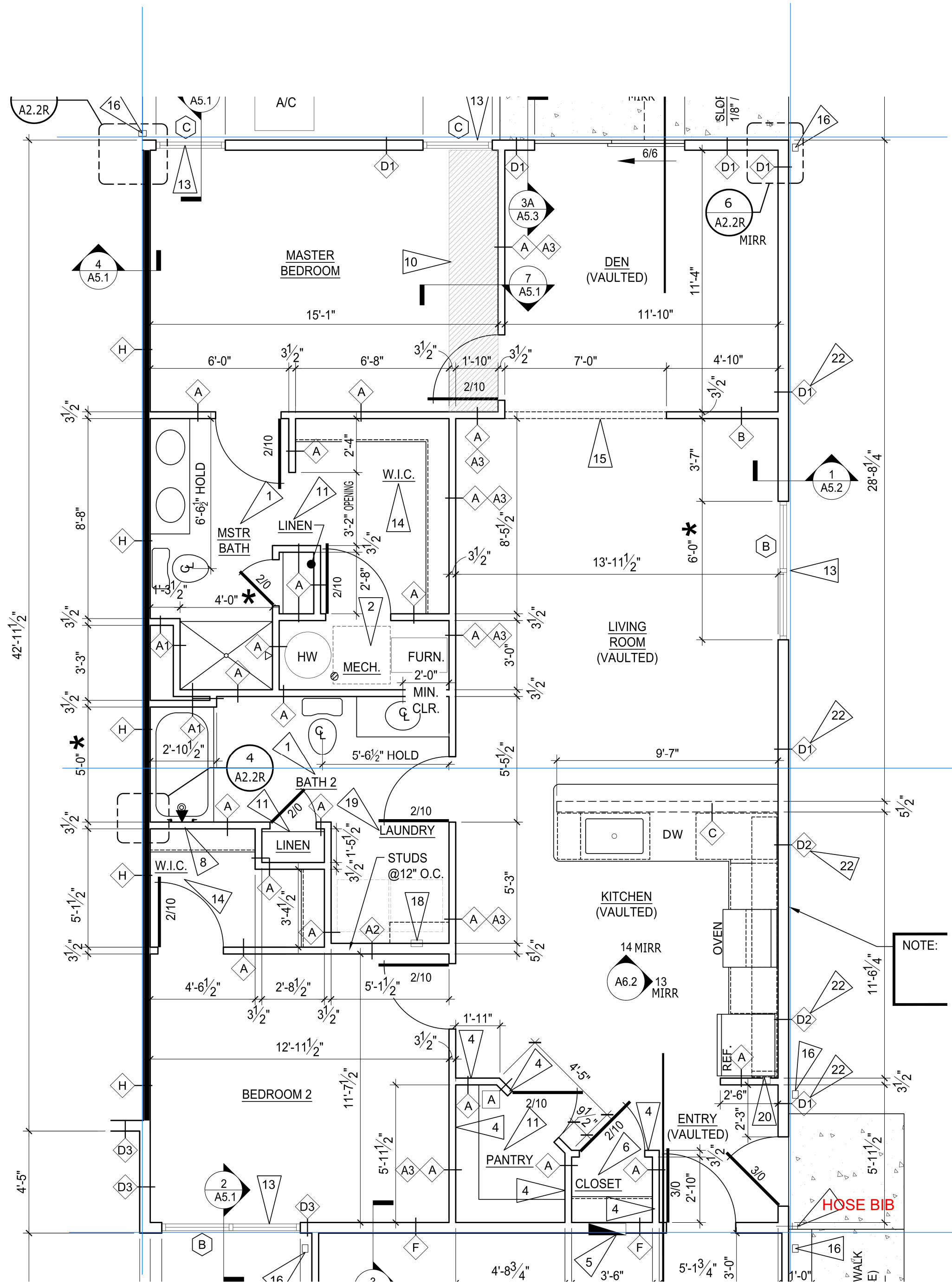

**GARAGE ON THIS SIDE OF BUILDING**

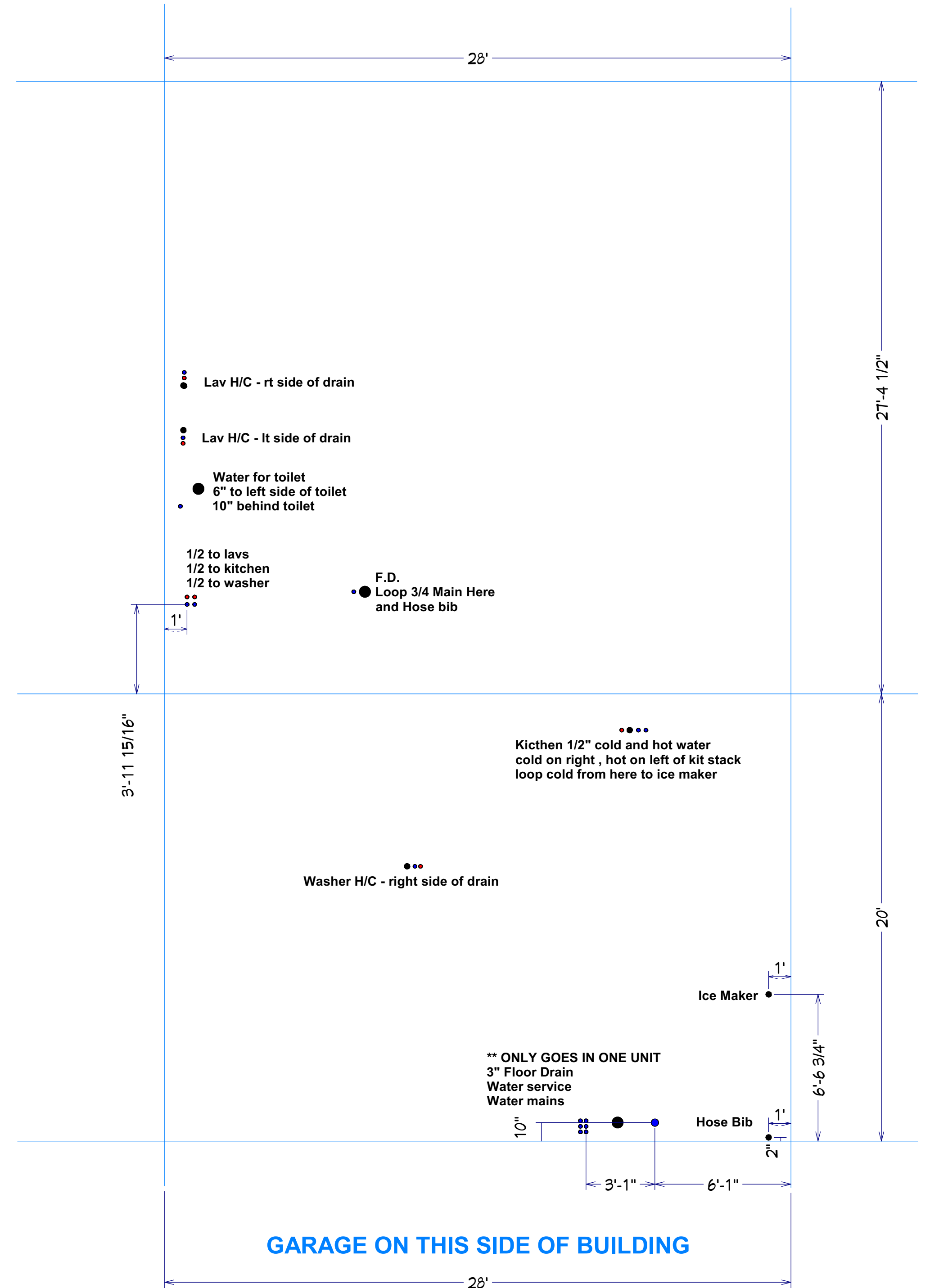

**Meadowood Right WATER**