

# Redwood Miamisburg North Springboro Pike OH P1 Construction Site Plan

Building Order

- J
- A
- GG
- FF
- H
- B
- G
- C
- F
- D
- E
- EE

31 Buildings-141 Units

- Forestwood (37)
- Meadowood (24)
- Capewood (5)
- Willowood (12)
- Breezewood (59)
- Breezewood SR (4)
- High Profile Side
- Building Step

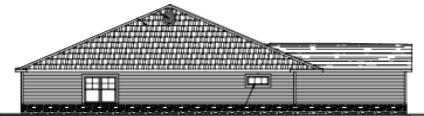

# BUILDING S

2 - Breezewood Left

2 - Breezewood Right

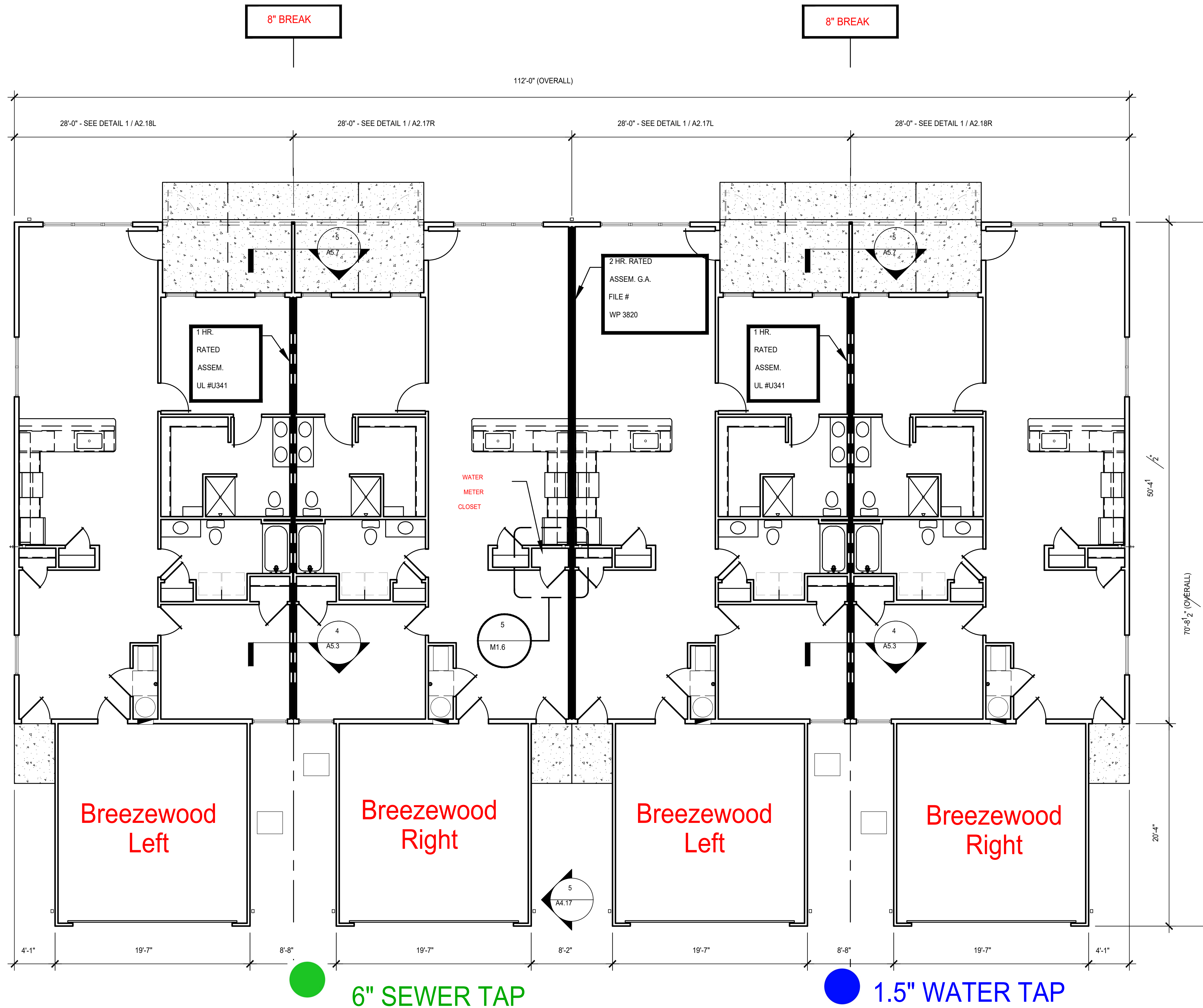

### GENERAL NOTES:

- REFER TO ENLARGED FLOOR PLANS FOR INTERIOR ROOM DIMENSIONS AND OTHER SPECIFIC INFORMATION.
- SEE SHEET SERIES A6.X FOR DOOR AND WINDOW SCHEDULES.
- CONTRACTOR SHALL PROVIDE ALL WALL BOXES, ETC. AS REQUIRED FOR ROUGH-IN CONDITIONS. TELEPHONE AND T.V. PREWIRE TO BE COMPLETED BEFORE INSTALLATION OF GYPSUM WALLBOARD.
- ALL GRAB BAR BLOCKING FOR FUTURE GRAB BARS AT HANDICAP BATHS MUST BE ABLE TO RESIST A FULL FORCE OF 250 LBS. EXERTED AT ANY POINT IN ANY DIRECTION ON FUTURE GRAB BARS. BLOCKING AT TUBS AND SHOWERS IS TO BE FACTORY INSTALLED.
- ALL DIMENSIONS ARE TO FACE OF STUD UNLESS OTHERWISE NOTED.
- FOR INTERIOR FINISHES FOR WALLS AND CEILINGS REFER TO FLAME AND SMOKE INDEX RATING ON SHEET SERIES A6.X.
- PRIMARY ENTRY DOORS SHALL HAVE "0" CLEARANCE THRESHOLDS TO MEET ALL ANSI REQUIREMENTS
- ALL EXPOSED EXTERIOR WOOD SHALL BE PRESSURE TREATED. SEE FRAMING PLANS & WALL SECTIONS FOR MORE INFORMATION.

### NOTES:

- ALL SINGLE STORY UNITS MUST MEET FAIR HOUSING ACT ACCESSIBILITY GUIDELINES FOR ADAPTABILITY.
- ALL UNITS ARE TYPE 'B' DWELLING UNITS AS PER ANSI A117.1-2009, SECTION 1004.

### NOTES:

REFER TO ENLARGED FLOOR PLAN SHEETS TO SEE CORRESPONDING PLANS FOR LABELED UNITS.

### NOTE:

STAGGER ADJACENT A/C UNITS TO PROVIDE FOR SUFFICIENT ACCESS AROUND EACH.

HP

HP - HIGH PROFILE SIDE ELEVATION. SEE EXTERIOR ELEVATION SHEETS FOR MORE INFORMATION.

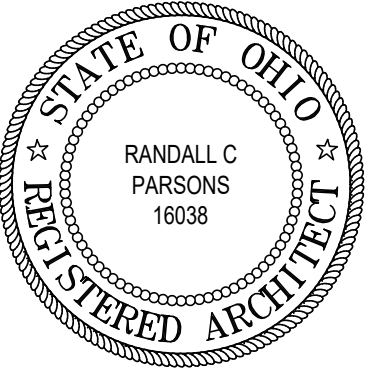

### REVISIONS

phone 330.666.5770  
fax 330.666.8812  
3660 Embassy Parkway  
Fairlawn, OH 44333

**MPG**  
MANN • PARSONS • GRAY  
ARCHITECTS  
mpg-architects.com

OVERALL FLOOR PLANS - BLDGS.; S, T

PROJECT #: 33521 DATE: JULY 27, 2022

REDWOOD MIAMISBURG

MIAMISBURG OH, 45449



**A2.31**

62 OF 137

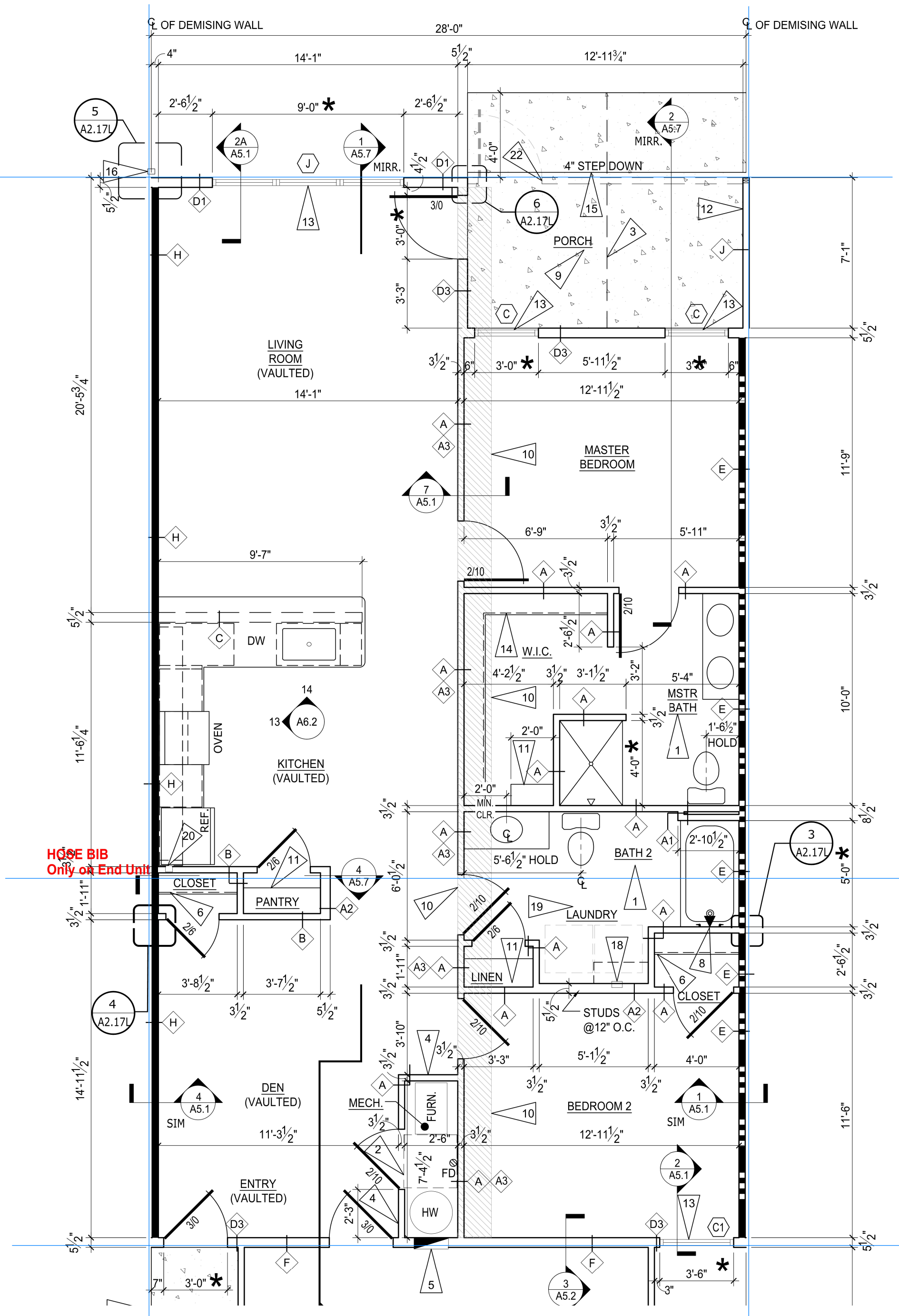

**NOTES:**  
**MUST install tub boxes for tub and shower traps !! Wait until gravel prepped**

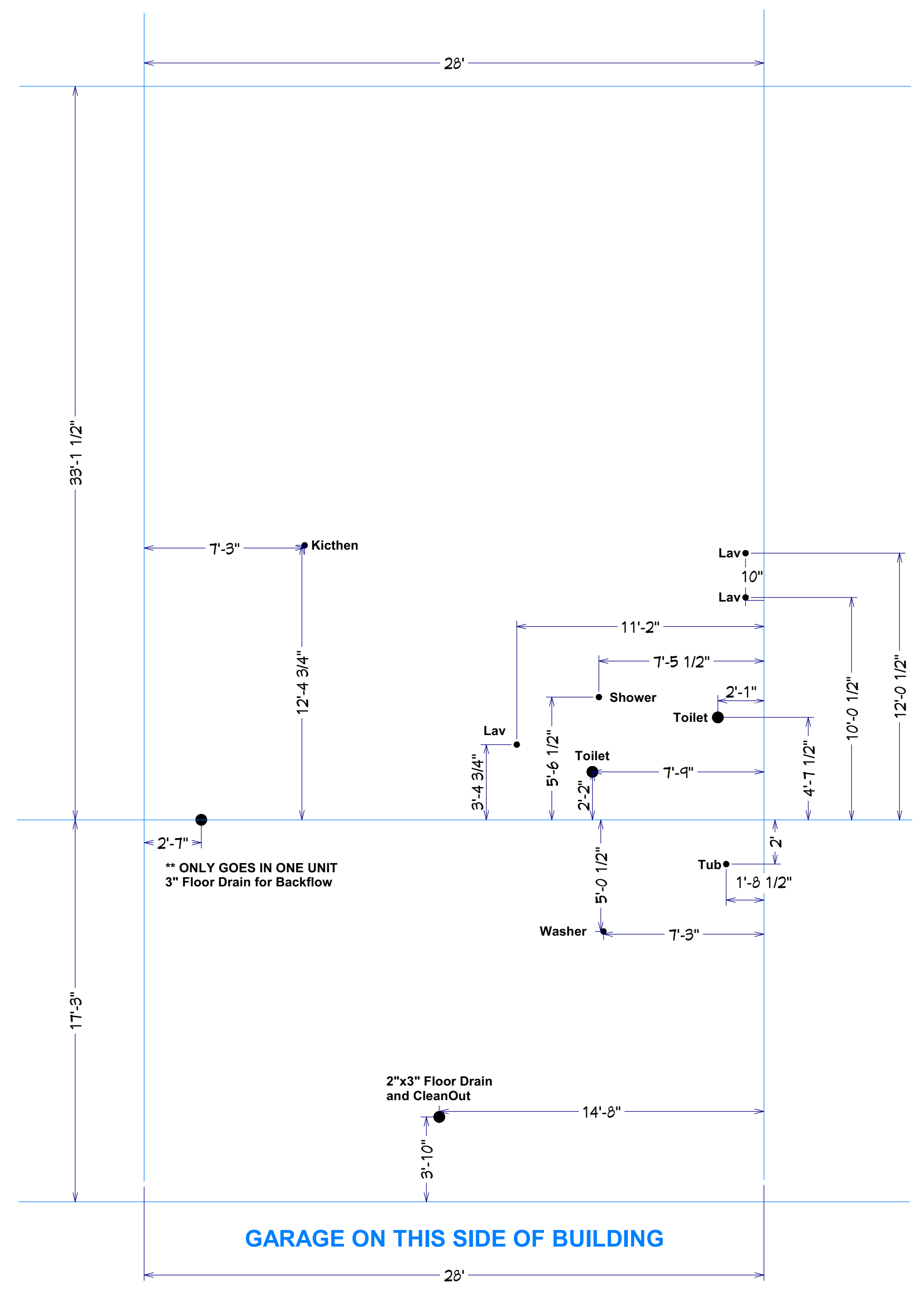

**GARAGE ON THIS SIDE OF BUILDING**

**Breezewood Left PVC**

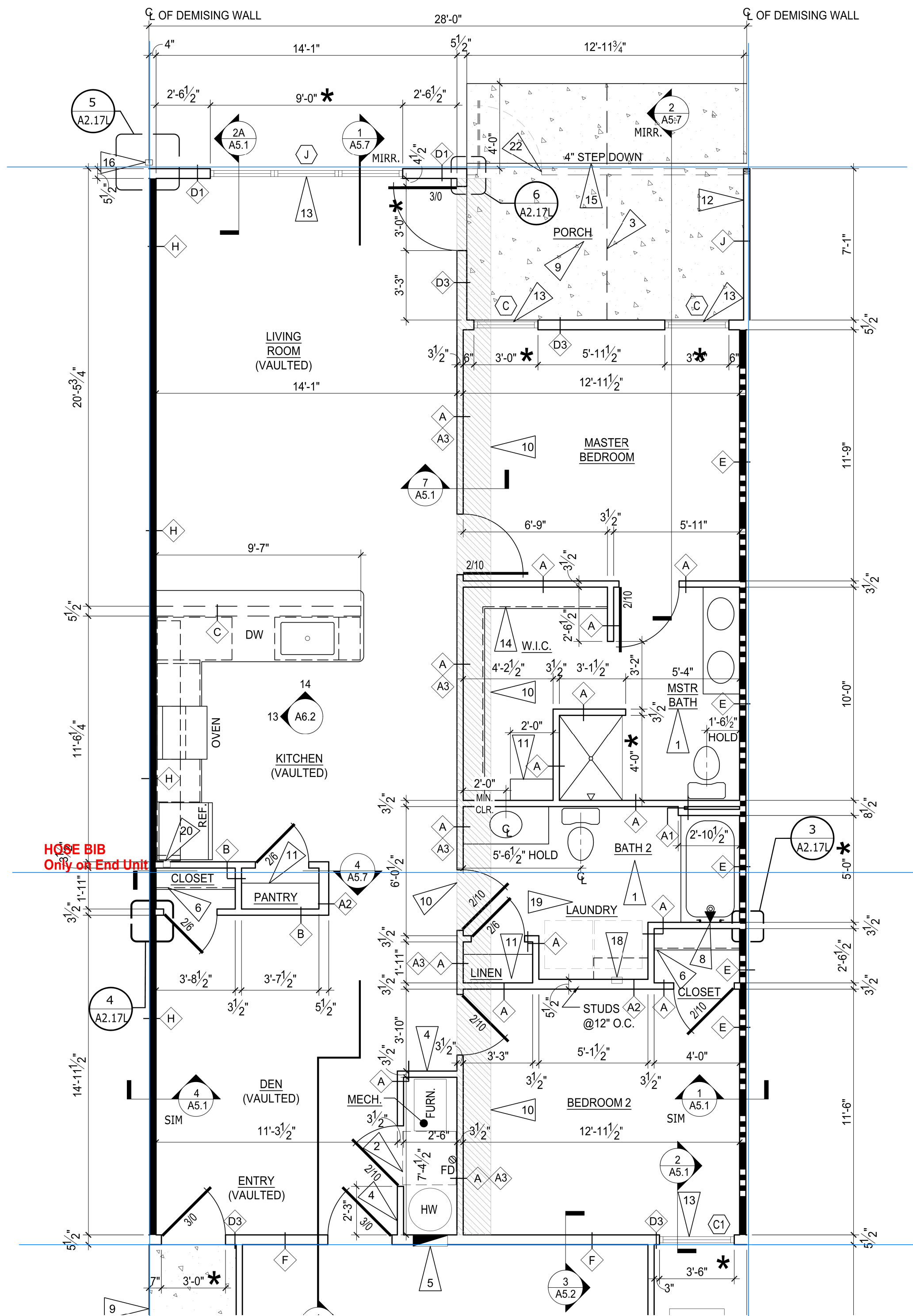

**GARAGE ON THIS SIDE OF BUILDING**

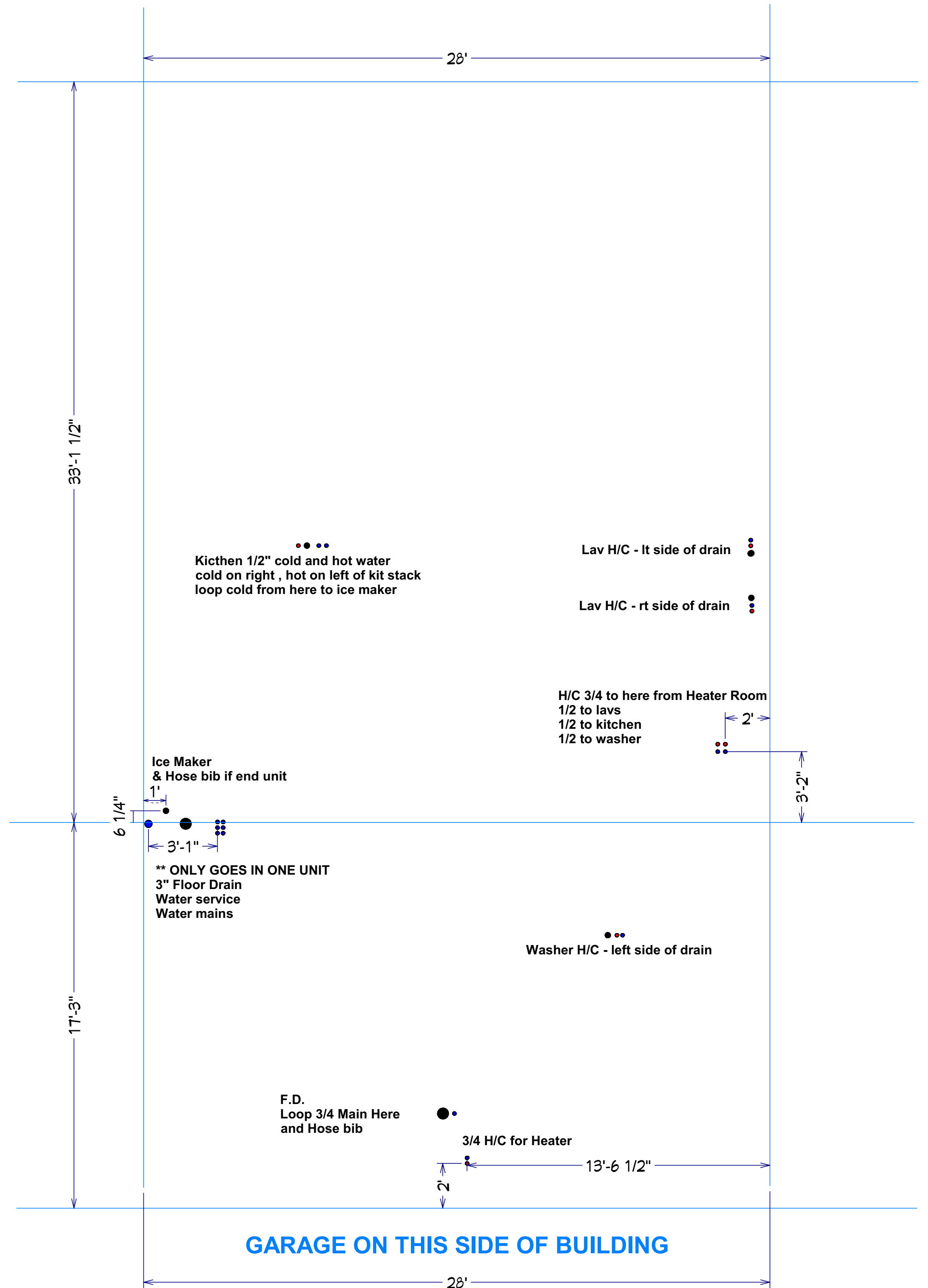

**GARAGE ON THIS SIDE OF BUILDING**

**Breezewood Left WATER**

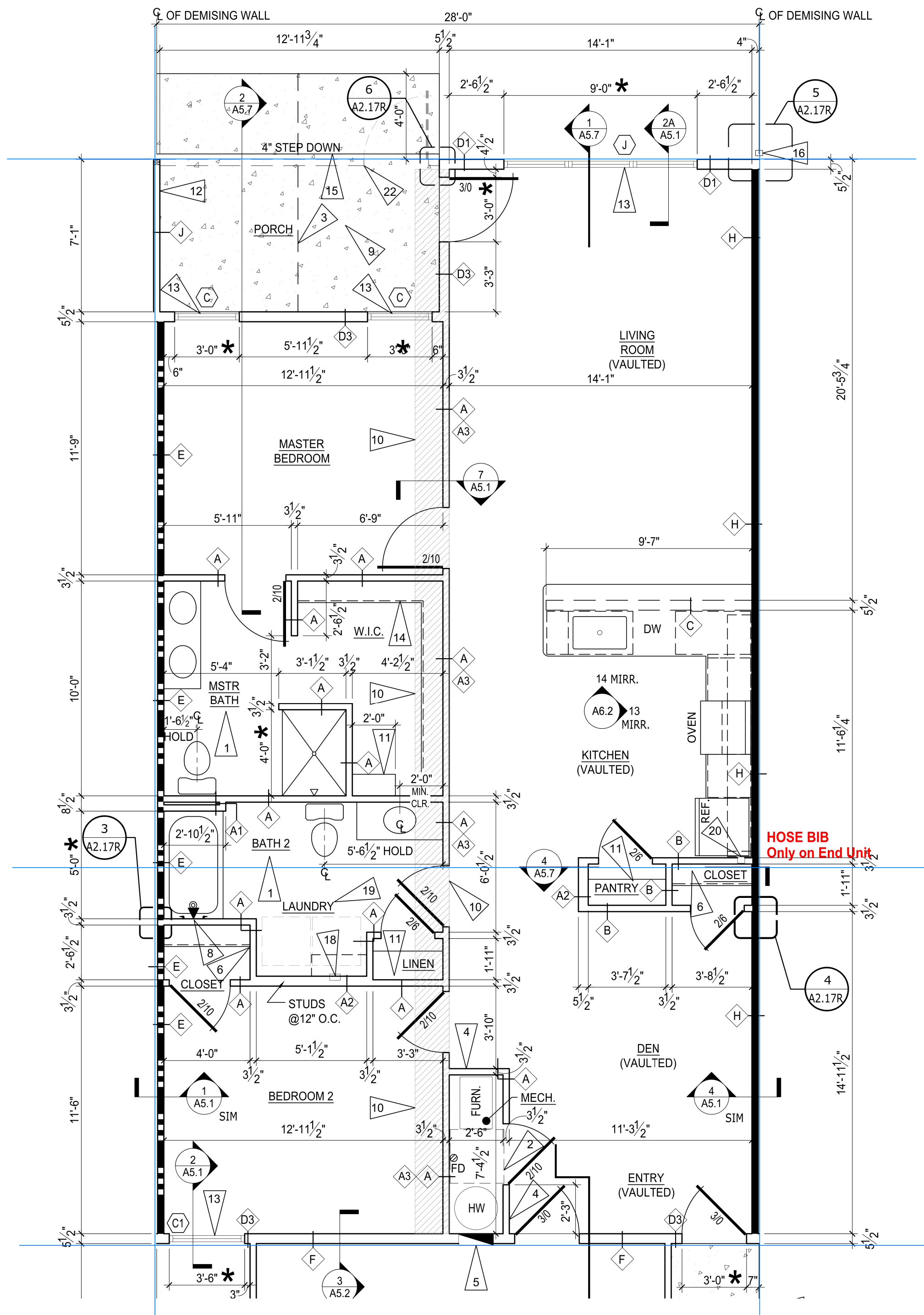

**GARAGE ON THIS SIDE OF BUILDING**

**NOTES:**

**MUST install tub boxes for tub and shower traps !! Wait until gravel prepped**

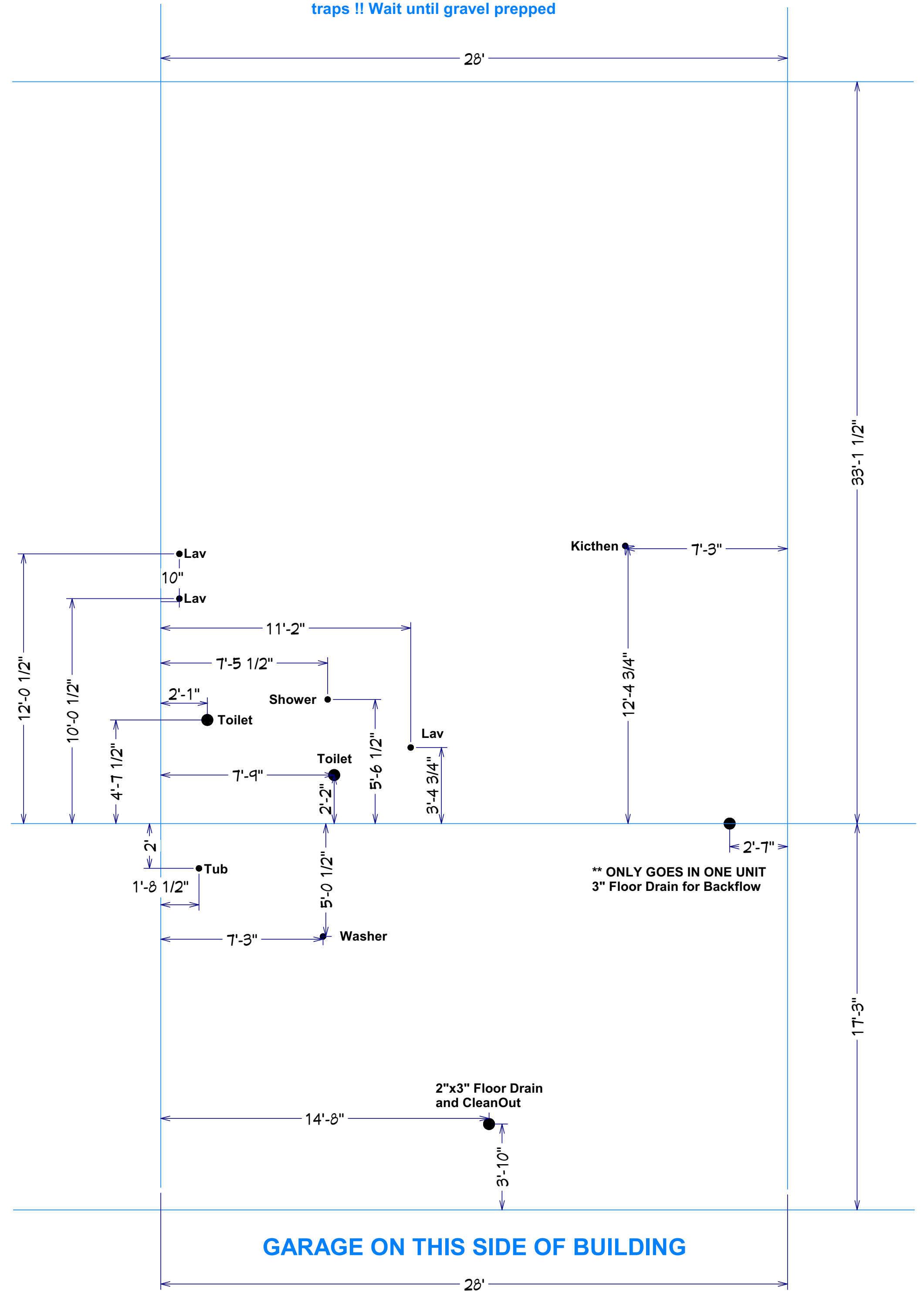

**GARAGE ON THIS SIDE OF BUILDING**

**Breezewood Right PVC**

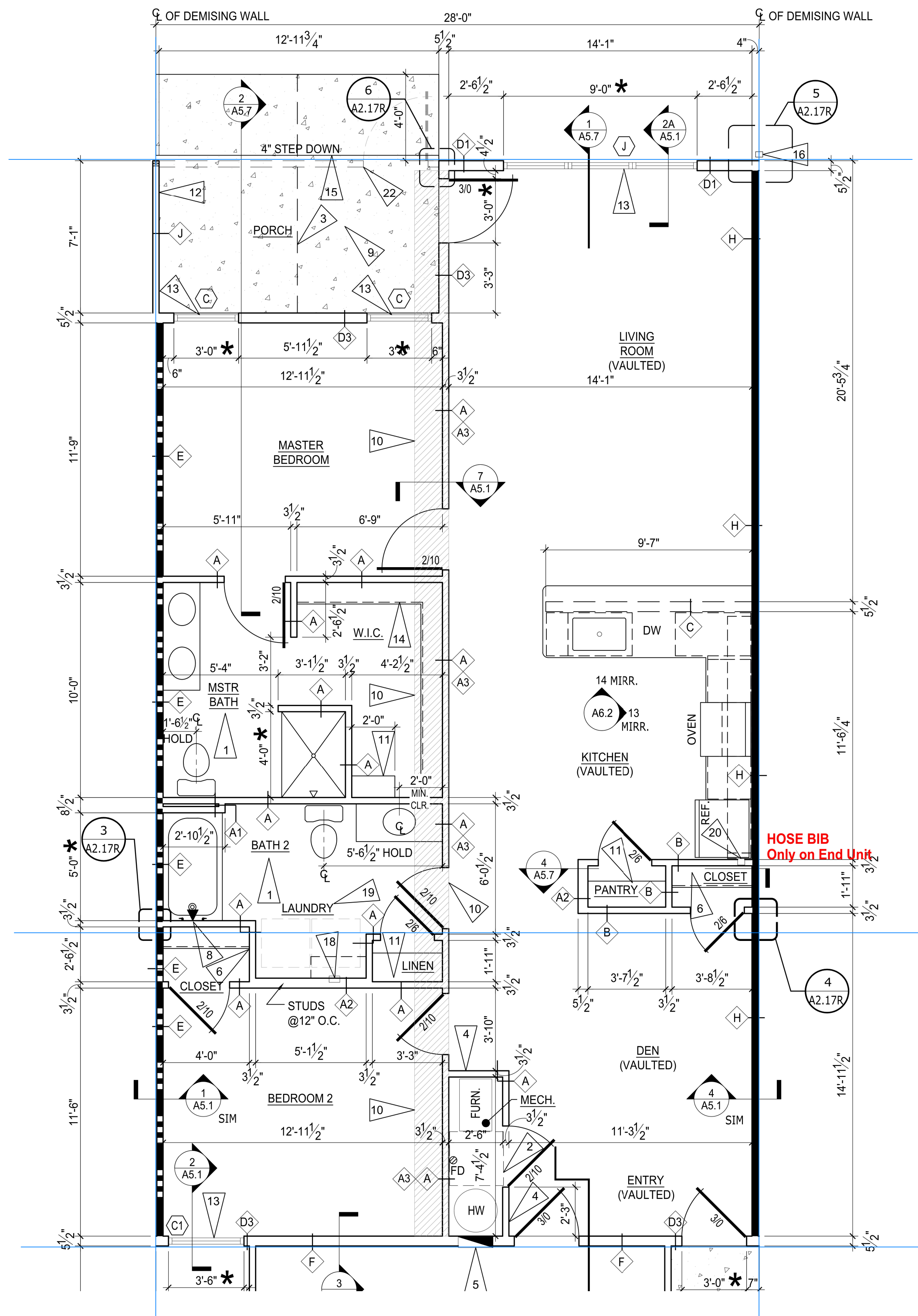

**GARAGE ON THIS SIDE OF BUILDING**

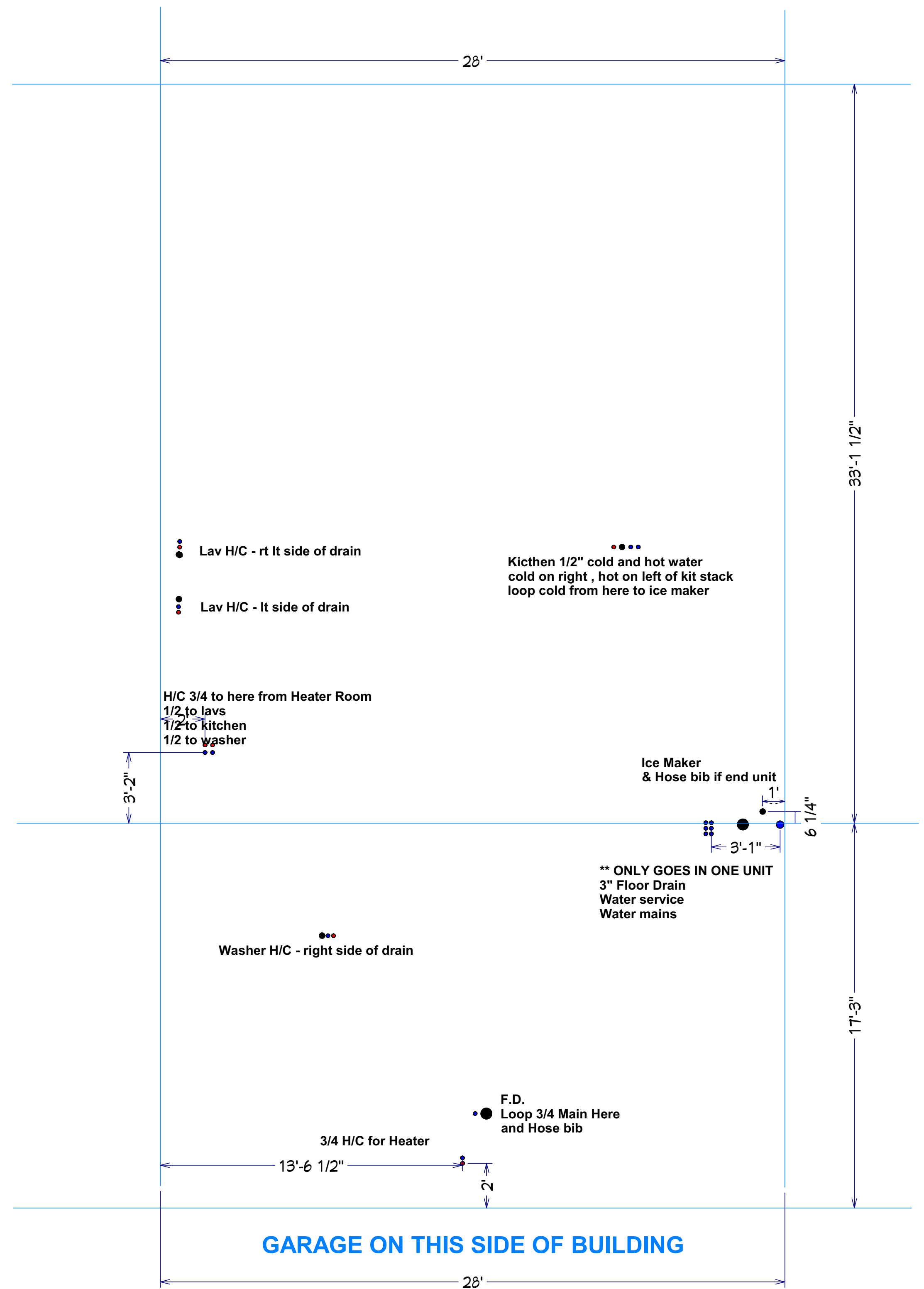

**Breezewood Right WATER**