

PLUMBING PLAN
SCALE: 1/4" = 1'-0"

NOTE
RADON REMEDIATION
RADON LOOP:
- (4") PERFORATED HDPE "LOOP"
- MUST BE PLACED IN STONE BED SLIGHTLY HIGHER THAN ANY INTERIOR DRAINTILE
- LOOP TO BE SEPARATE FROM ANY DRAINTILE ELEMENTS
- TO BE CORRUGATED HDPE PIPE
- SCREENS TO BE INSTALLED THROUGH LOOP AT TEE UP INTO STACK
STACK REQUIREMENTS:
- 3" PVC STACK (4" IF BASEMENT IS GREATER THAN 2200 SQFT.)
- NO PART OF STACK IS TO BE HORIZONTAL
- PIPE TO BE PHYSICALLY LABELED IN THE FIELD AS "RADON VENT" OR OTHER JURISDICTIONALLY REQUIRED LANGUAGE (ON EVERY LEVEL OF HOUSE)
- ROOF TERMINATION TO BE IN TOP 1/3 OF ROOF
- SCREEN INSTALLED TO KEEP PESTS OUT OF RADON VENT AT ROOF TERMINATION

SHEET NO. A-5	MODEL ALLEGHENY	SET NO. ALGOO	REV. NO. DATE	REMARKS
	DRAWING TITLE PLUMBING PLAN	VERSION 01 DRAWN BY TN		
OPTION DESCRIPTION 22	DATE: 08/04/2017			
<p>NVR, Inc., owner, expressly reserves its copyright in these plans. These plans are not to be reproduced, changed, copied, or otherwise used in any way without the prior written consent of NVR, Inc.</p>				
<p>NVR Architectural Services 5285 Westpark Drive, Suite 100 Frederick, MD 21703</p>				
<p>C:\NVR\Solves\ALLEGHENY_ALGOO_01\DCY-CH-X418\136972\Sheets\Lot_Specific\22_A-5_PLUMB_LS.dwg 03/04/19 10:59 am</p>				

LEGEND	
	BEARING WALL
	NON BEARING WALL
	INDICATES BEARING FROM POINT-LOAD ABOVE
	JACKS
	BEAM/HEADER
	PAD FOOTING
	STEEL COLUMN
	PORTAL FRAME
	JOIST/TRUSS
	LVL
	ENGINEERING PAGE NUMBER

SEE FC DETAILS FOR FRAMING CONNECTORS

FLOOR PLAN NOTES

- ALL HEADERS ARE (2) 2x6 w/ 2x4 WALLS OR (3) 2x6 w/ 2x6 WALLS, UNLESS OTHERWISE NOTED.
- ALL HEADERS TO HAVE (1) 2x4 OR 2x6 JACK AND KING STUD EACH END, UNLESS OTHERWISE NOTED.
- ALL EXTERIOR WALLS TO BE 4" w/ OSB OR 3 1/2" w/ T-PLY, ALL INTERIOR WALLS TO BE 3 1/2", UNLESS OTHERWISE NOTED.
- HATCHED AREAS INDICATE DROPPED CEILINGS. ALL DROPPED CEILINGS ARE 12" UNLESS OTHERWISE NOTED.
- SEE "BRACED WALL PANEL DETAIL SHEET" FOR SPECIAL WALL FRAMING LOCATIONS AND HEADER SIZES, IF APPLICABLE.
- SEE STANDARD DETAIL CATEGORY "IT" SHEET(S) FOR INTERIOR TRIM DETAILS.
- SEE ARCHITECTURAL DETAIL SHEET "AD" FOR HOUSE SPECIFIC INTERIOR TRIM OPTION TABLE.
- ALL WINDOWS HAVE 1"-0 1/2" HEADER HEIGHT UNLESS OTHERWISE NOTED.
- ALL HEADERS IN NON-BEARING WALLS SHALL BE A SINGLE FLAT 2X4 OR 2X6 ATTACHED TO CRIPPLES ABOVE, UNLESS OTHERWISE NOTED.
- TANKED WATER HEATER SHOWN AS BASE CONDITION, OPTIONAL TANKLESS WATER HEATER IS AVAILABLE IN LIEU OF TANKED WATER HEATER.

GYPSUM NOTES

AT GARAGE:
 GYPSUM BOARD AT COMMON WALLS, CEILINGS, BEAM WRAPS AND SUPPORTS PER STANDARD DETAIL FA-1(b) FIRE ASSEMBLIES OR AS REQUIRED BY LOCAL CODE.

AT STAIRS:
 1/2" GYPSUM BOARD AT UNDERSIDE OF STAIRS AND WALLS IN CLOSET

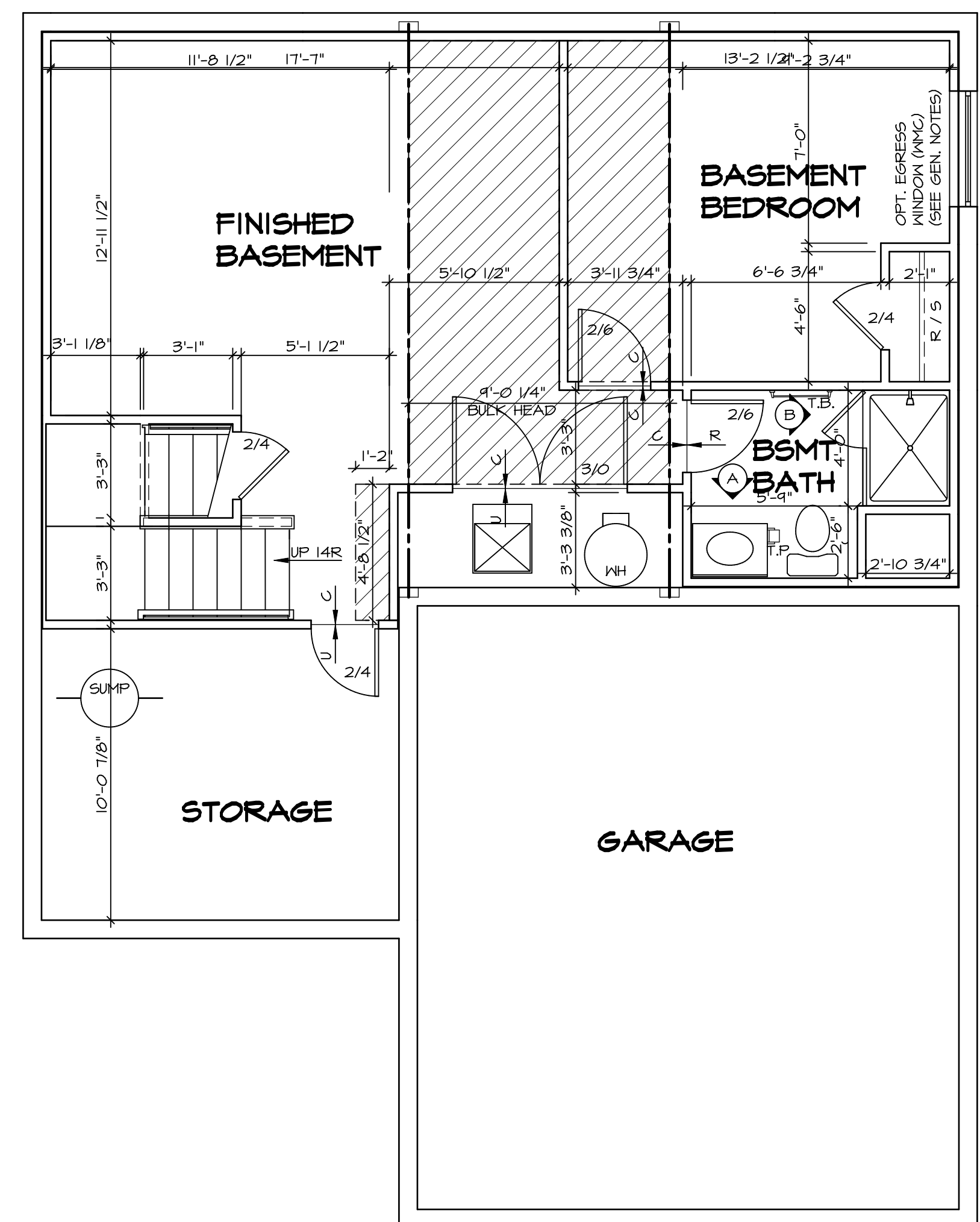

BASEMENT FLOOR PLAN
 SCALE: 1/4" = 1'-0"

SHEET NO.	MODEL	SET NO.	VERSION	DRAWN BY	DATE	OPTION	REMARKS
A-6	ALLEGHENY	ALGOO	01	TN	08/04/2017		
26							

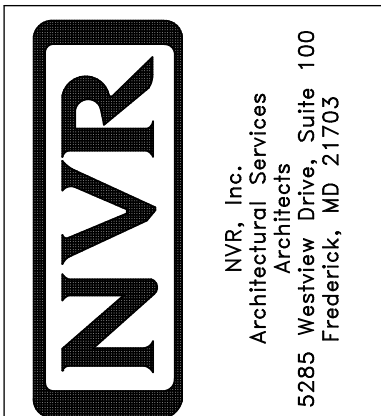

ALLEGHENY
 DRAWING TITLE
 BASEMENT FLOOR PLAN

OPTION DESCRIPTION

OPTION

5285 Westover Lane
 Frederick, MD 21703

03/04/19 10:59 am

FIRST FLOOR JACK SCHEDULE				
IDENTIFIER	DESCRIPTION	OPTIONS	ENG. NUM.	REMARKS
J101	JACK - (2) 2X4 SFF STUD GRADE		1004	
J102	JACK - (2) 2X6 SFF STUD GRADE		1004	
J103	JACK - (3) 2X4 SFF		1008	
J104	JACK - (3) 2X4 SFF		1008	
J105	JACK - (3) 2X6 SFF	ELA, ELB, ELK, ELL	1010	
J106	JACK - (3) 2X4 SFF	ELA, ELB, ELK, ELL	1010	
J111	JACK - (2) 2X4 SFF STUD GRADE		1025	
J112	JACK - (2) 2X4 SFF STUD GRADE		1025	
J113	JACK - (2) 2X4 SFF STUD GRADE		1039	
J115	JACK - (2) 2X4 SFF STUD GRADE		1006	
J120	JACK - (2) 2X4 SFF STUD GRADE		1027	
J121	JACK - (2) 2X4 SFF STUD GRADE		1027	
J122	JACK - (2) 2X4 SFF STUD GRADE		1027	
J124	JACK - (2) 2X4 SFF STUD GRADE		1027	

FIELD INSTALLED FIRST FLOOR BEAM/HEADER SCHEDULE					
IDENTIFIER	DESCRIPTION	LENGTH	OPTIONS	ENG. NUM.	REMARKS
B101	BEAM STEEL - W10X30	20'-6"		1008	

STEEL COLUMN SCHEDULE					
IDENTIFIER	STYLE	HEIGHT	OPTIONS	ENG. NUM.	REMARKS

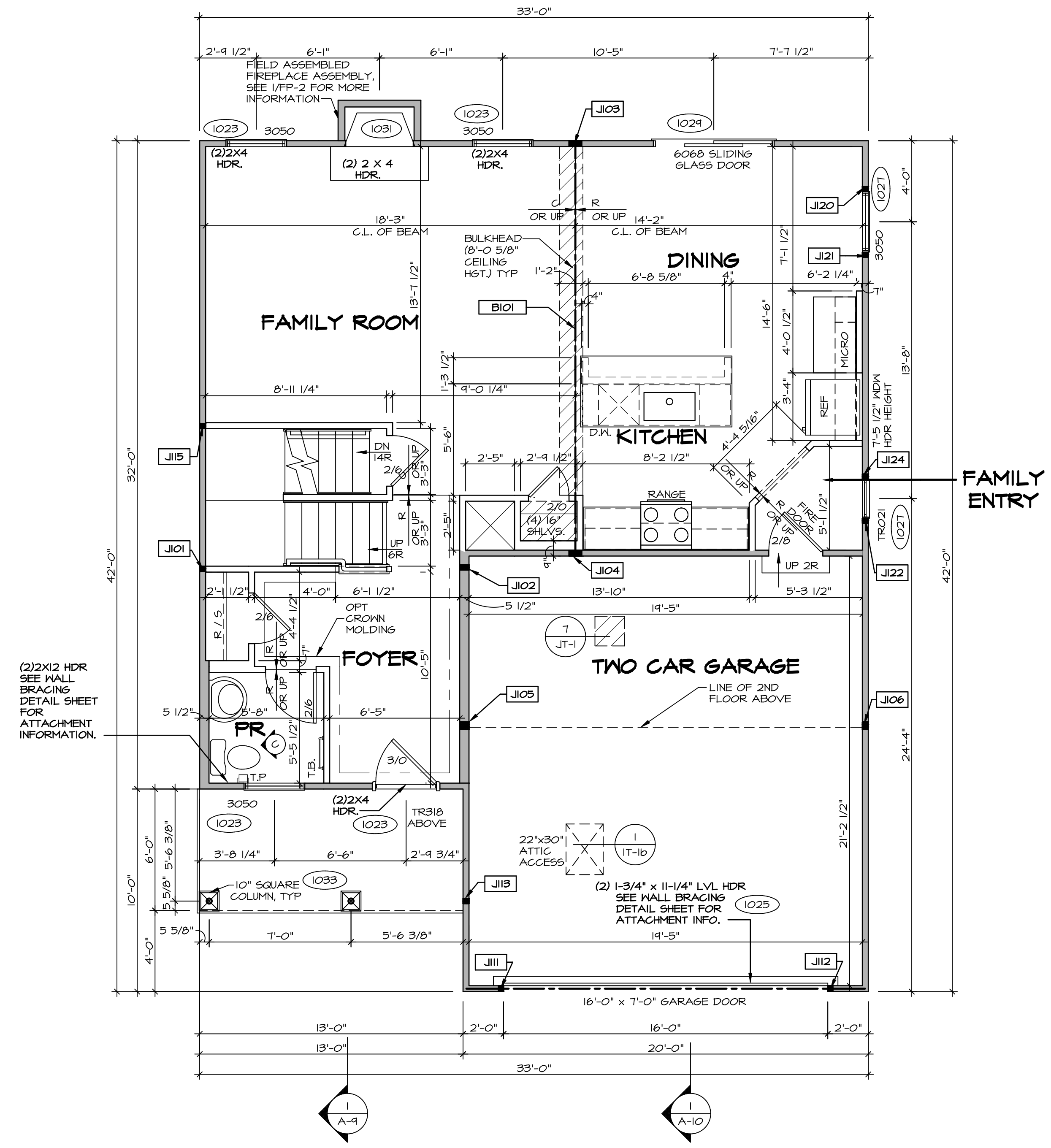

FIRST FLOOR PLAN
SCALE: 1/4" = 1'-0"

LEGEND	
	BEARING WALL
	NON BEARING WALL
	INDICATES BEARING FROM POINT-LOAD ABOVE
	JACKS
	BEAM/HEADER
	PAD FOOTING
	STEEL COLUMN
	PORTAL FRAME
	JOIST/TRUSS
	LVL
	ENGINEERING PAGE NUMBER

SEE FC DETAILS FOR FRAMING CONNECTORS

- FLOOR PLAN NOTES** RYAN
- ALL HEADERS ARE (2) 2x6 w/ 2x4 WALLS OR (3) 2x6 w/ 2x6 WALLS, UNLESS OTHERWISE NOTED.
 - ALL HEADERS TO HAVE (1) 2x4 OR 2x6 JACK AND KING STUD EACH END, UNLESS OTHERWISE NOTED.
 - ALL EXTERIOR WALLS TO BE 4" w/ OSB OR 3 1/2" w/ LAMINATED FIBROUS STRUCTURAL SHEATHING, ALL INTERIOR WALLS TO BE 3 1/2", UNLESS OTHERWISE NOTED.
 - HATCHED AREAS INDICATE DROPPED CEILINGS. ALL DROPPED CEILINGS ARE 12" UNLESS OTHERWISE NOTED.
 - SEE "BRACED WALL PANEL DETAIL SHEET" FOR SPECIAL WALL FRAMING LOCATIONS AND HEADER SIZES, IF APPLICABLE.
 - SEE STANDARD DETAIL CATEGORY "11" SHEET(S) FOR INTERIOR TRIM DETAILS.
 - SEE ARCHITECTURAL DETAIL SHEET "AD" FOR HOUSE SPECIFIC INTERIOR TRIM OPTION TABLE.
 - ALL WINDOWS HAVE 7'-0 1/2" HEADER HEIGHT UNLESS OTHERWISE NOTED.
 - ALL HEADERS IN NON-BEARING WALLS SHALL BE A SINGLE FLAT 2X4 OR 2X6 ATTACHED TO GRIPPLIES ABOVE, UNLESS OTHERWISE NOTED.
 - TANKED WATER HEATER SHOWN AS BASE CONDITION, OPTIONAL TANKLESS WATER HEATER IS AVAILABLE IN LIEU OF TANKED WATER HEATER.

- GYPSUM NOTES**
- AT GARAGE:
GYPSUM BOARD AT COMMON WALLS, CEILING, BEAM WRAPS AND SUPPORTS PER STANDARD DETAIL FA-1(b) FIRE ASSEMBLIES OR AS REQUIRED BY LOCAL CODE.
- AT STAIRS:
1/2" GYPSUM BOARD AT UNDERSIDE OF STAIRS AND WALLS IN CLOSET

REV. NO.	DATE	REMARKS
----------	------	---------

NVR, Inc., owner, expressly reserves its copyright in these plans. These plans are not to be reproduced, changed, copied, or otherwise used in any way without the written consent of NVR, Inc.

NVR
NVR, Inc.
Architectural Services
5285 Washington Blvd
Frederick, MD 21703

SET NO. ALGOO	VERSION 01
DRAWN BY YON	DATE: 08/10/2017
OPTION	

MODEL ALLEGHENY	DRAWING TITLE FIRST FLOOR PLAN
SHEET NO. A-7	OPTION DESCRIPTION
	28

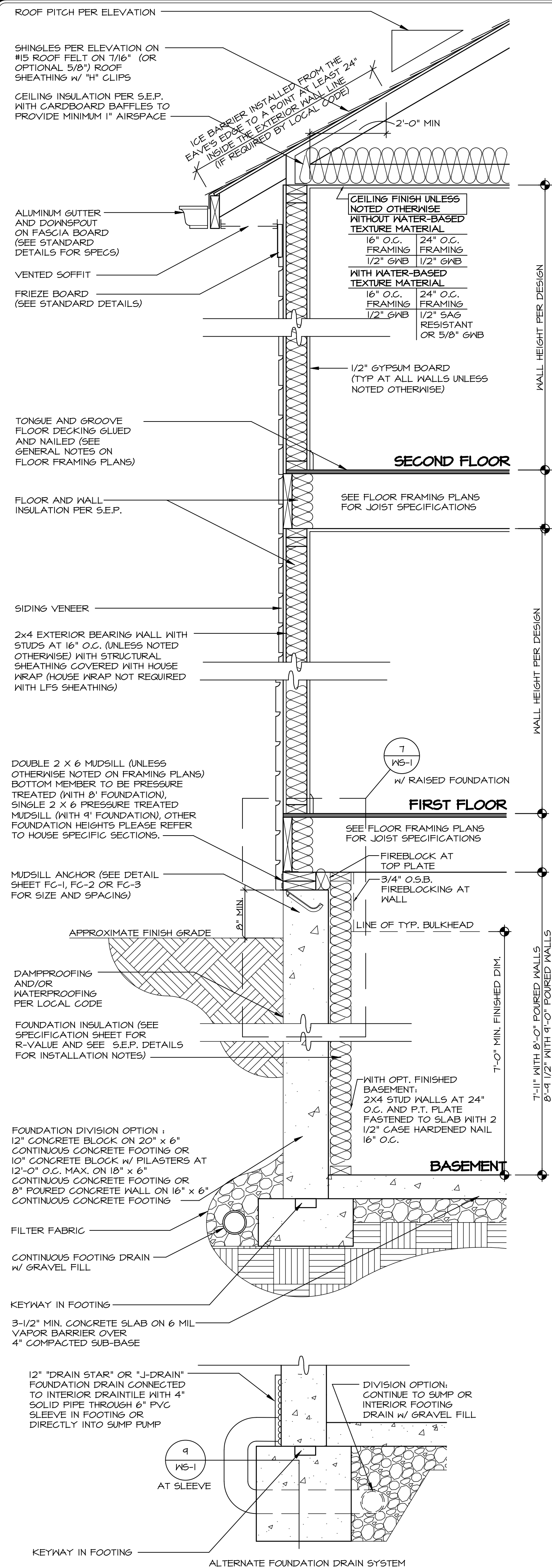

1 TYPICAL WALL SECTION

WS-1 SCALE: 1" = 1'-0" w/ SIDING

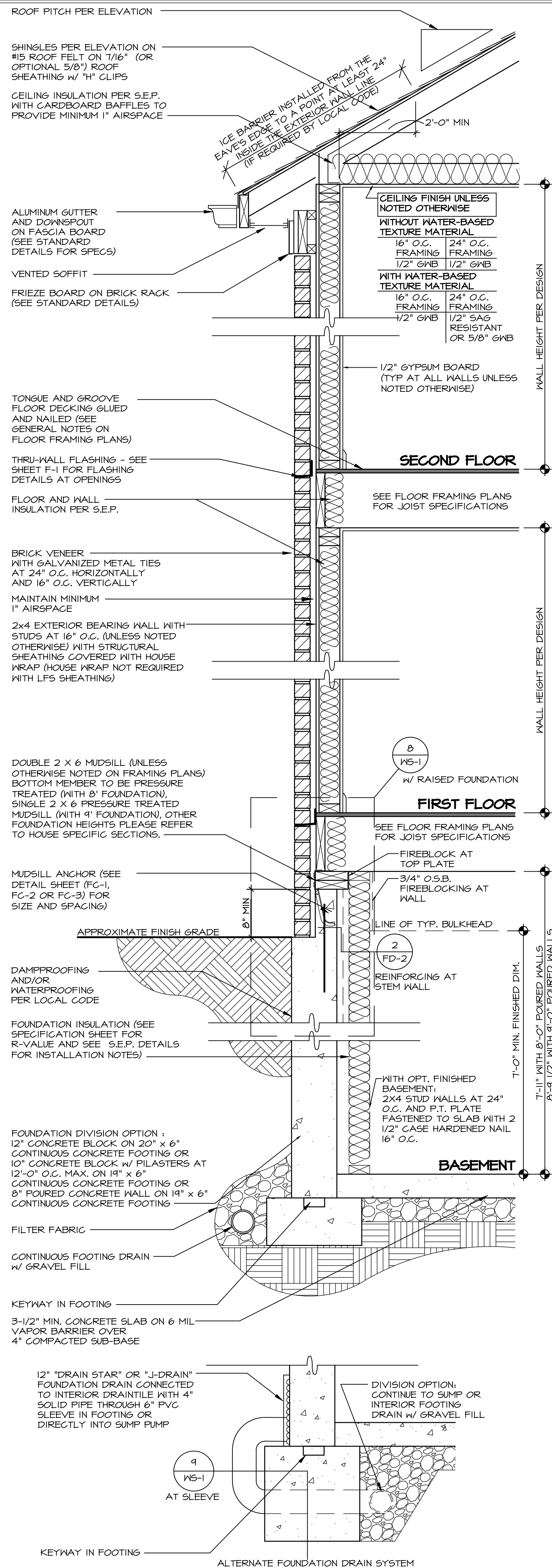

2 TYPICAL WALL SECTION

WS-1 SCALE: 1" = 1'-0" w/ BRICK

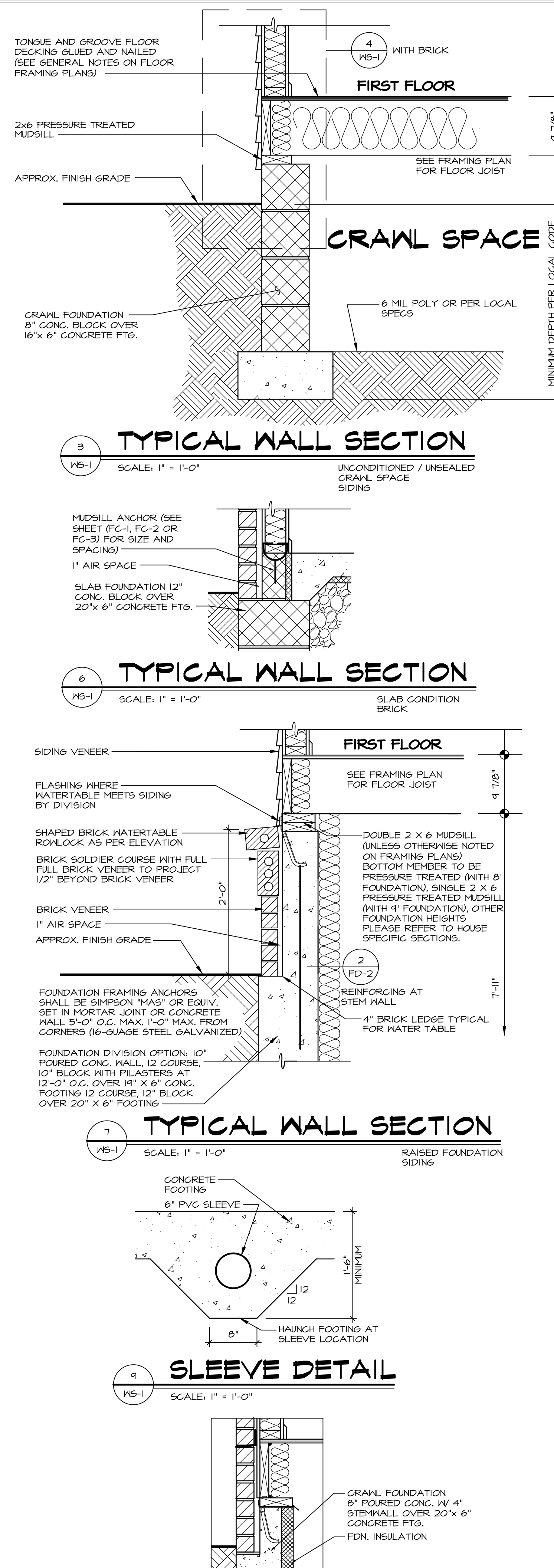

3 TYPICAL WALL SECTION

WS-1 SCALE: 1" = 1'-0" CONDITIONED CRAWL SPACE BRICK

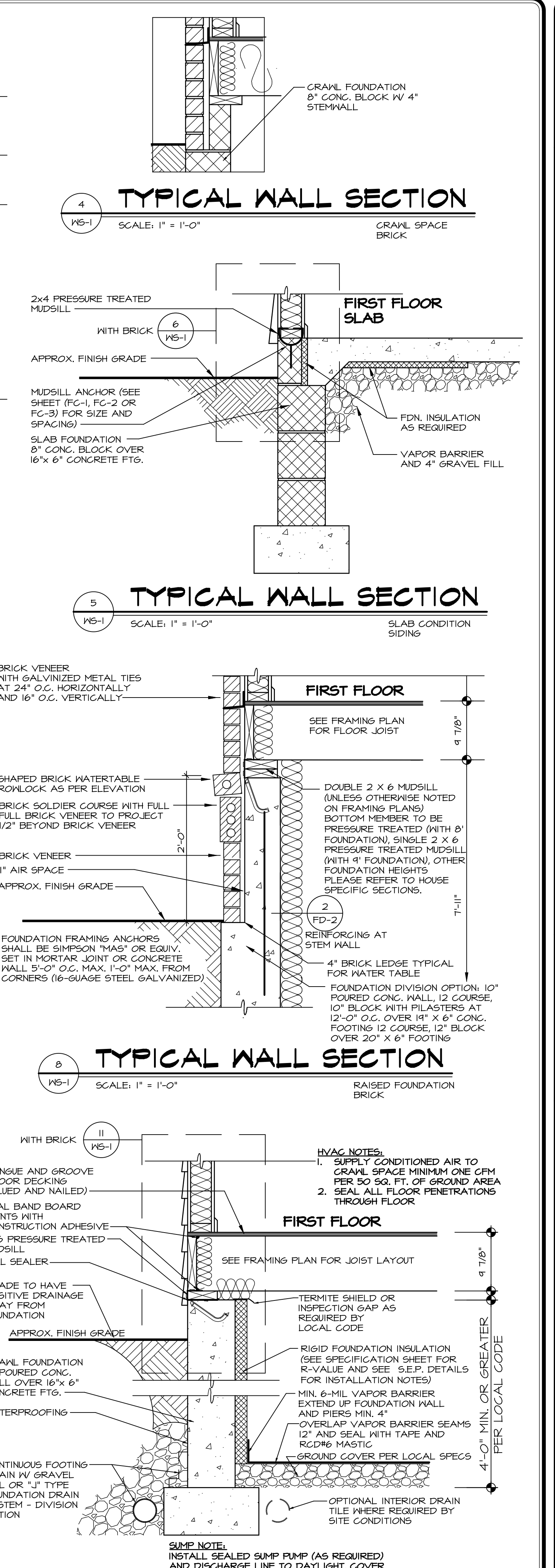

4 TYPICAL WALL SECTION

WS-1 SCALE: 1" = 1'-0" CONDITIONED / SEALED CRAWL SPACE SIDING

REV. NO.	DATE	REMARKS
1	5/18/2011	ADD "J-DRAIN" TO ALT. DRAIN DETAILS 1 AND 2 PER REQUEST #24174
2	7/11/11	ELB - MISC. DRAWING CORRECTIONS
3	9/5/11	G70 - REMOVED "PERFORATED" FROM TILE NOTE ON DTL 1 & 2 (REQUEST #4214)
4	9/5/11	G70 - REMOVED "PERFORATED" FROM TILE NOTE DTL 10 PER REQUEST #4222
5	2/16/18	G70 - ADDED "AS REQUIRED" TO SUMP NOTE DTL 10 PER REQUEST #4222
6	10/16/18	E1M - REVISED LFS SHEATHING NOTE FOR WS-1 AND 2 (REQUEST 5193)
7	2/26/19	M81 - REVISED FIREBLOCKING NOTE IN BASEMENTS TO USE 3/4" OSB

MODEL	SHEET NO.	VERSION	DRAWN BY	DATE:	OPTION
STANDARD DETAILS	WS-1				

MODEL	SHEET NO.	VERSION	DRAWN BY	DATE:	OPTION
WALL SECTION DETAILS	WS-1				

MODEL	SHEET NO.	VERSION	DRAWN BY	DATE:	OPTION
DETACHED PRODUCT	WS-1				

MODEL	SHEET NO.	VERSION	DRAWN BY	DATE:	OPTION
OPTION DESCRIPTION	WS-1				

NVR, Inc. owner, expressly reserves its common law copyright and other property rights in these plans. These plans are not to be reproduced, stored in a retrieval system, or transmitted in any form or by any means, without the prior written consent of NVR, Inc.



NVR, Inc. Services
Architects
5285 Westview Drive, Suite 100
Frederick, MD 21703