

**STRUCTURAL LEGEND**

(X) ENGINEERING PAGE NUMBER INDICATES BEARING FROM POINT-LOAD ABOVE

(R) REINFORCEMENT ADDED AT POINT-LOADS FROM ABOVE OR PER ENGINEERING. QUANTITY/SIZING VARIES PER DESIGN.

**DIAGONALS ELEVATION A**

SIZING OR PART	FULL BRICK FRONT
AC	65'-10 1/8"
AE	64'-5 1/8"
AG	65'-8 3/8"
BD	10'-4 3/8"
FD	65'-2 7/8"

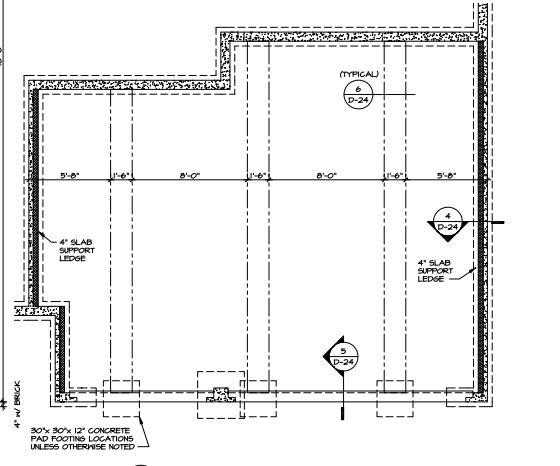

**REVISIONS**

REV.	NO.	DATE	DESCRIPTION
1	1/18/14	1/18/14	ISSUED FOR PERMITS
2	1/22/14	1/22/14	ISSUED FOR PERMITS
3	1/22/14	1/22/14	ISSUED FOR PERMITS
4	1/22/14	1/22/14	ISSUED FOR PERMITS

**PROJECT INFORMATION**

SET NO. 0-500  
DESIGN TITLE: FOUNDATION PLAN  
DRAWN BY: DAG  
DATE: 9/25/2013  
OPTION: FEA

**CLIENT INFORMATION**

OWNER: OLSEN  
FOUNDATION PLAN  
FULL BASEMENT FOUNDATION  
OPTION: FEA

**DESIGNER INFORMATION**

NVR  
NVR INC.  
4141 W. 13TH AVE.  
DENVER, CO 80202  
TEL: 303.733.1100  
WWW.NVR.COM

SHEET NO. A-2  
OF 14

DIAGONALS ELEVATION L	
AC	68'-1 1/8"
AE	10'-4 5/8"
AG	6'-3 5/8"
BD	7'-5 5/8"
FD	66'-1 9/16"

DIAGONALS ELEVATION K	
AC	67'-0 5/8"
AE	64'-1 3/4"
AG	65'-11 3/8"
BD	7'-8 1/8"
FD	66'-5 1/8"

SIDING OR PART. STONE FRONT	FULL BRICK FRONT
AC	68'-1 7/8"
AE	10'-4 5/8"
AG	6'-3 5/8"
BD	7'-5 5/8"
FD	66'-1 9/16"

SIDING OR PART. STONE FRONT	FULL BRICK FRONT
AC	66'-10 1/8"
AE	64'-5 1/8"
AG	65'-0 3/8"
BD	7'-5 3/8"
FD	66'-1 9/16"

DIAGONALS ELEVATION B	
AC	66'-10 1/8"
AE	64'-5 1/8"
AG	65'-0 3/8"
BD	7'-5 3/8"
FD	66'-1 9/16"

STRUCTURAL LEGEND	
(X)	ENGINEERING PAGE NUMBER
(O)	INDICATES BEARING FROM POINTLOAD ABOVE
*	REINFORCEMENT ADDED AT POINTLOADS FROM ABOVE OR PER ENGINEERING. QUANTITY/SIZING VARIES PER DESIGN.

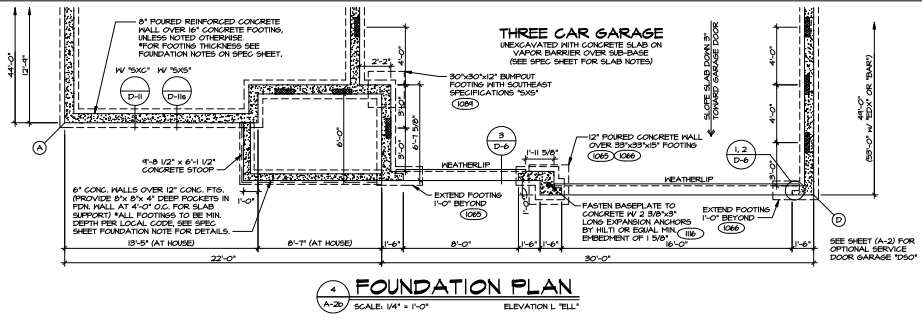

FOUNDATION PLAN  
ELEVATION L 'ELL'  
SCALE: 1/4" = 1'-0"

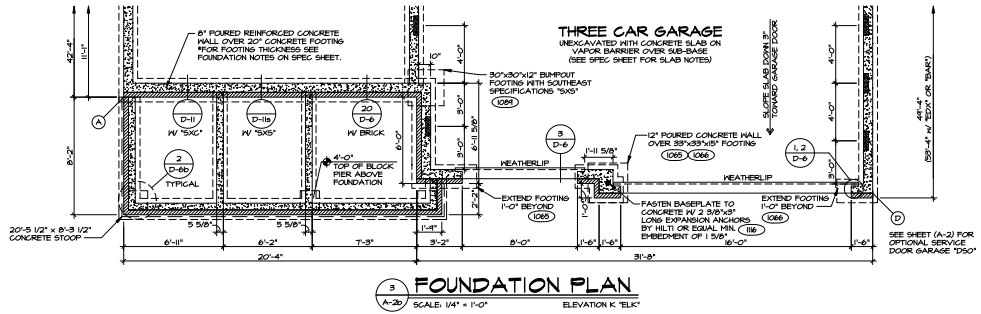

FOUNDATION PLAN  
ELEVATION K 'ELL'  
SCALE: 1/4" = 1'-0"

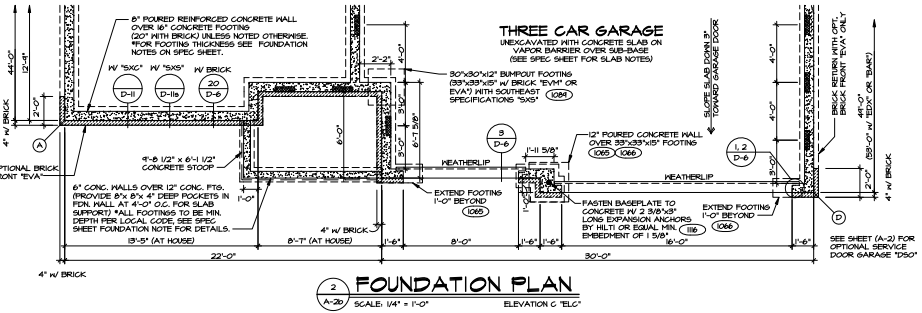

FOUNDATION PLAN  
ELEVATION G 'ELL'  
SCALE: 1/4" = 1'-0"

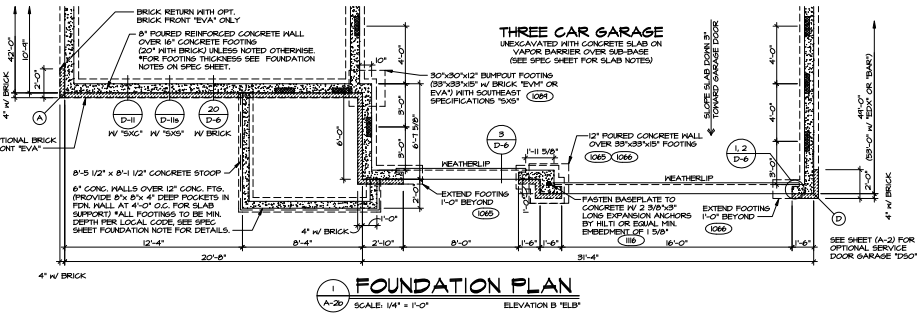

FOUNDATION PLAN  
ELEVATION B 'ELL'  
SCALE: 1/4" = 1'-0"

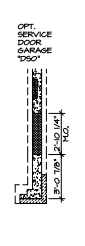
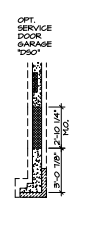

SHEET NO.	DATE	REVISIONS
A-20	9/25/2018	1. INITIAL DESIGN - CONCRETE AT GARAGE DOORS
		2. UPDATE PER CLIENT COMMENTS
		3. CORRECT PER CLIENT COMMENTS
		4. CORRECT PER CLIENT COMMENTS

SET NO. 01.500  
 VERSION 02  
 DRAWN BY: DAG  
 DATE: 9/25/2018  
 OPTION: FULL BASEMENT FOUNDATION  
 ELEVATION 'K' OR 'L'  
 ELEVATION 'B' OR 'G'

NVR  
 NVR INC.  
 21 FREDERICK RD  
 FREDERICK, MD 21702

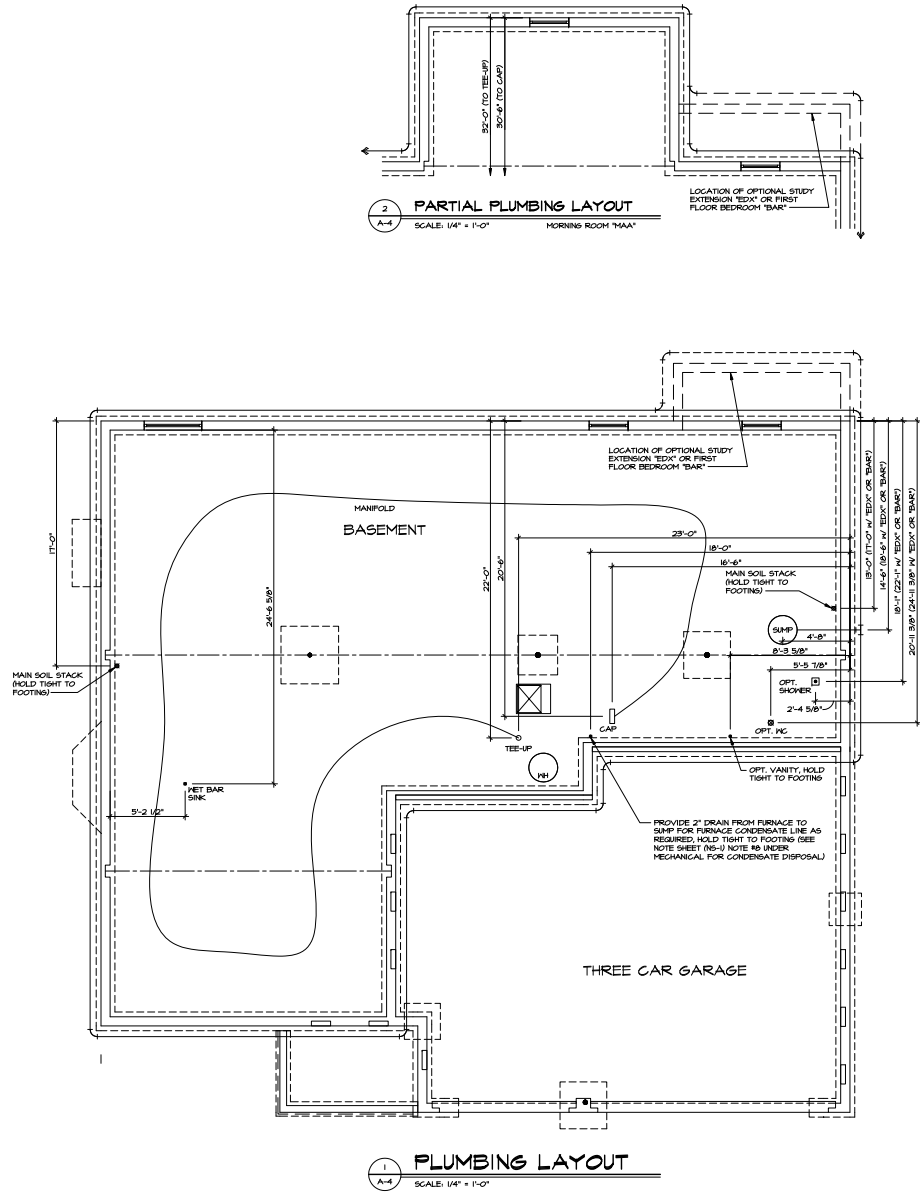

2 PARTIAL PLUMBING LAYOUT  
SCALE: 1/4" = 1'-0" MORNING ROOM "AAA"

1 PLUMBING LAYOUT  
SCALE: 1/4" = 1'-0"

SHEET NO. <b>A-4</b> 28		MODEL <b>OLSEN</b> DRAWING TITLE <b>PLUMBING LAYOUT</b> OPTION DESCRIPTION <b>FULL BASEMENT FOUNDATION</b>	SET NO. <b>04500</b> VERSION <b>02</b> DRAWN BY <b>BDH</b> DATE: <b>10/15/13</b> OPTION <b>FBA</b>	<p><b>NVR</b></p> <p>NVR, Inc.          4415 West 11th Ave.          Suite A          Minneapolis, MN 55412          Tel: 763.793.3172</p>	REV. NO.   DATE   REMARKS 1   2/20/14   DSK - CREATED VERSION 01 2   1/20/16   DSK - CREATED VERSION 02 3   1/20/16   DSK - CREATED VERSION 03
----------------------------	--	--	--	--	---

NVR, Inc. reserves the right to modify these drawings without notice. All dimensions and materials shall conform to the latest edition of the International Building Code (IBC) and the International Plumbing Code (IPC) unless otherwise noted. The user of these drawings shall verify all dimensions and materials with the manufacturer.

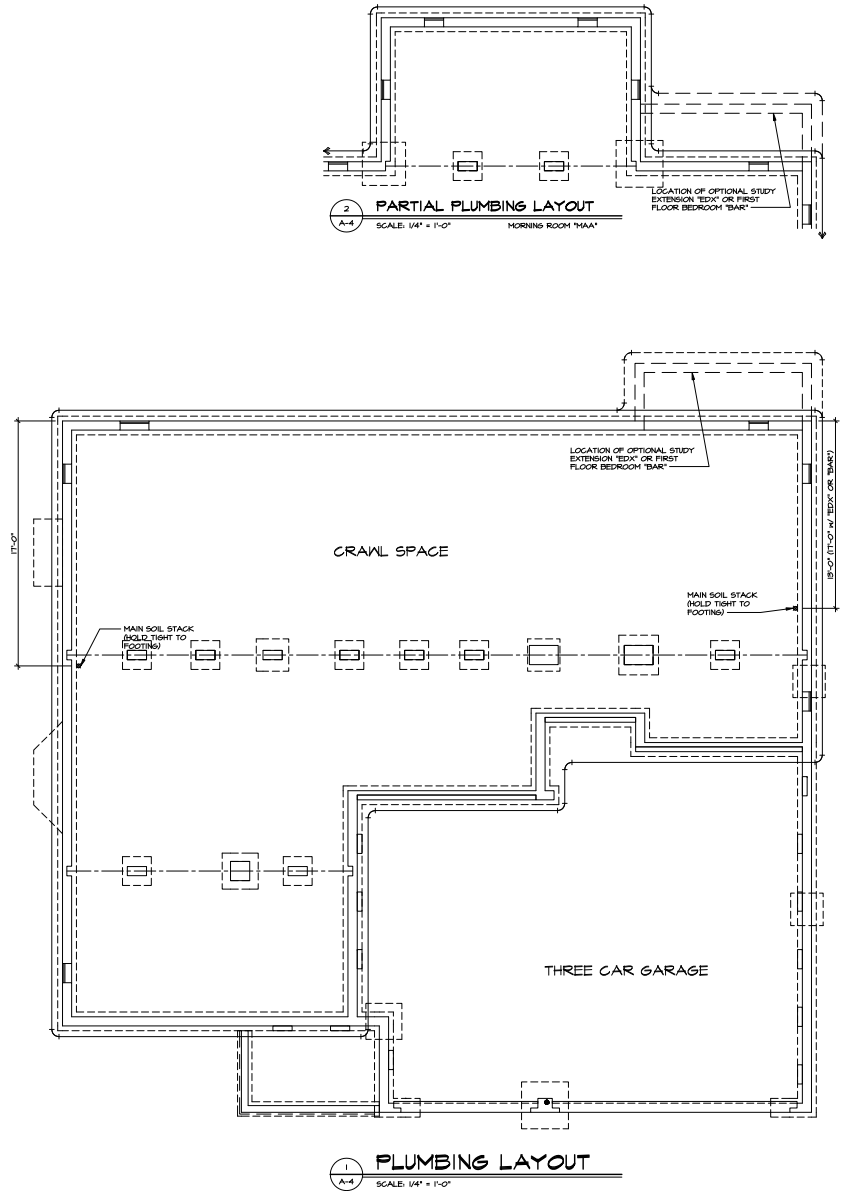

SHEET NO. **A-4**  
24

MODEL: **OLSEN**  
DRAWING TITLE: **PLUMBING LAYOUT**  
OPTION DESCRIPTION: **CRAWL SPACE FOUNDATION**

SET NO. **01500**  
VERSION: **02**  
DRAWN BY: **BDH**  
DATE: **10/15/13**  
OPTION: **PCA**



USE: This drawing, separately prepared by someone else, or prepared and modified by someone else, is not to be used as a basis for any construction without first obtaining the approval of the original designer.

REV. NO.	DATE	REMARKS
1	2/28/14	DIR. - CREATED VERSION 02
2	1/28/15	DIR. - CREATED VERSION 02

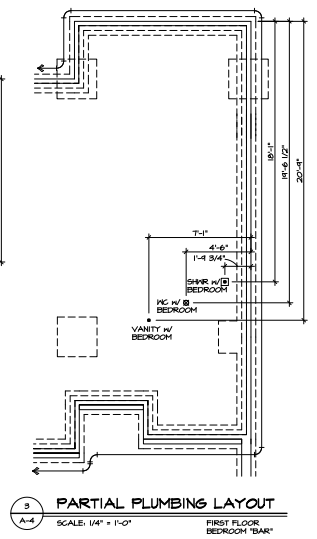
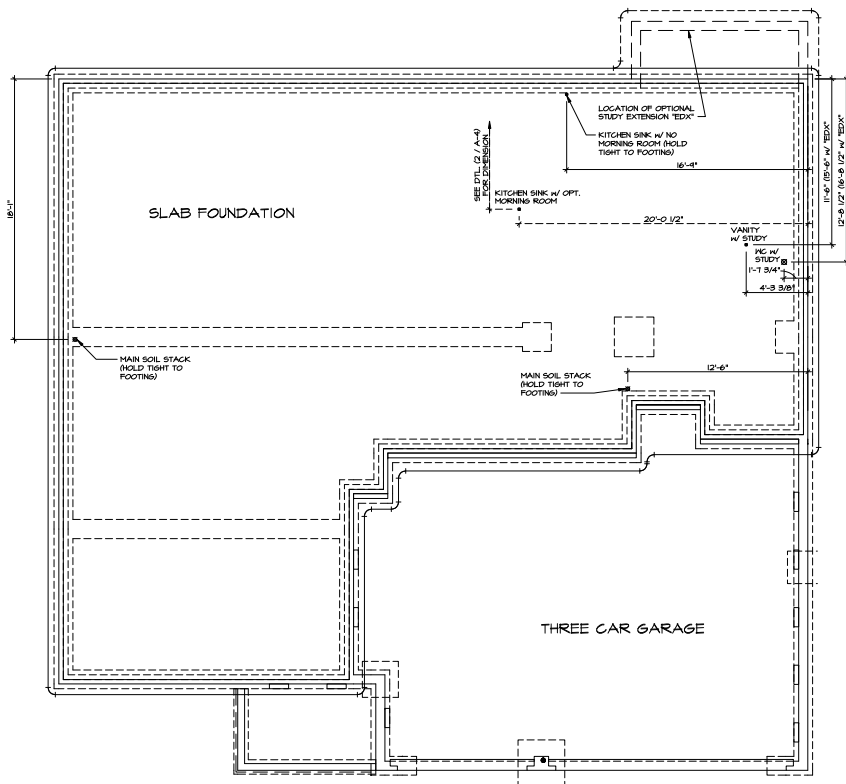
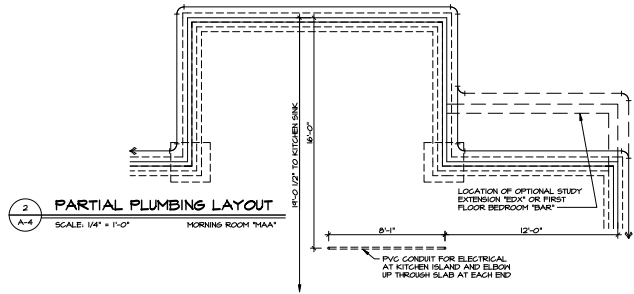

DIMENSIONS AND PLUMBING INFORMATION TO REMAIN THE SAME WITH SLAB FOUNDATION MONOLITHIC POUR "FSM"

SHEET NO. <b>A-4</b>	MODEL <b>OLSEN</b>	DRAWING TITLE <b>PLUMBING LAYOUT</b>	OPTION DESCRIPTION <b>SLAB FOUNDATION</b>	SHEET NO. <b>25</b>	SET NO. <b>01500</b>	DATE <b>10/15/19</b>	REV. NO. <b>2</b>	REMARKS
					VERSION <b>02</b>	DATE <b>10/15/19</b>	OPTION <b>FSM</b>	1. 2/28/14 DSK - CREATED VERSION 01
					NVR 1000 1100 1200 1300 1400 1500 1600 1700 1800 1900 2000 2100 2200 2300 2400 2500 2600 2700 2800 2900 3000 3100 3200 3300 3400 3500 3600 3700 3800 3900 4000 4100 4200 4300 4400 4500 4600 4700 4800 4900 5000 5100 5200 5300 5400 5500 5600 5700 5800 5900 6000 6100 6200 6300 6400 6500 6600 6700 6800 6900 7000 7100 7200 7300 7400 7500 7600 7700 7800 7900 8000 8100 8200 8300 8400 8500 8600 8700 8800 8900 9000 9100 9200 9300 9400 9500 9600 9700 9800 9900 10000			

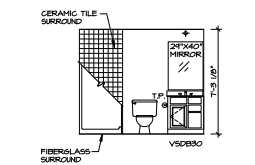
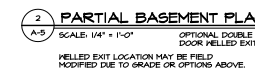
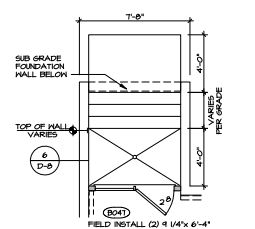
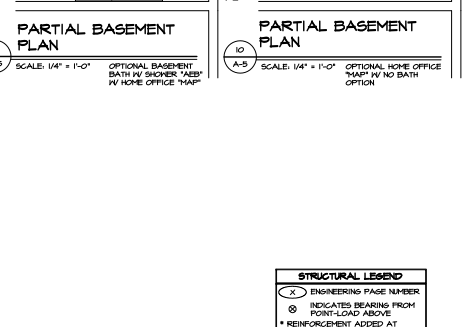
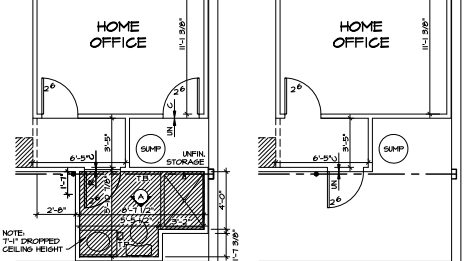
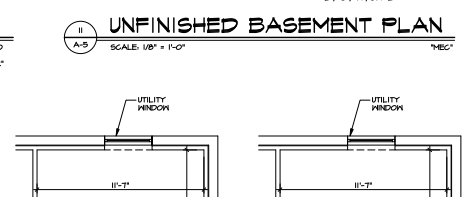
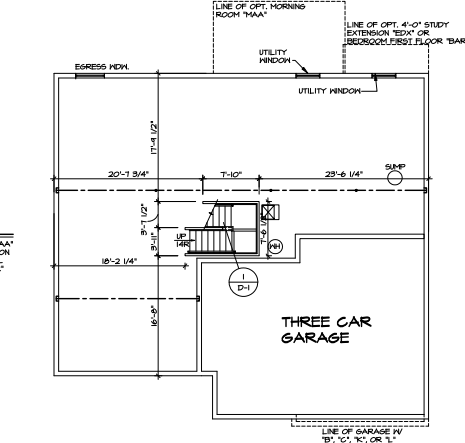
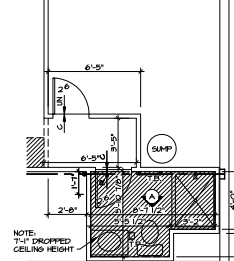
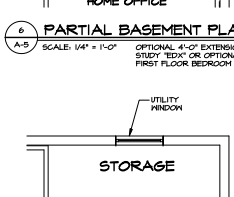
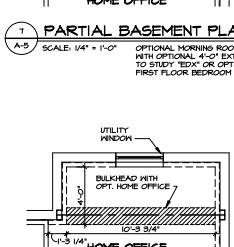
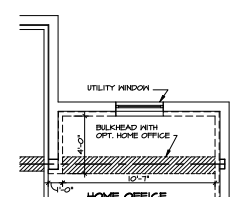
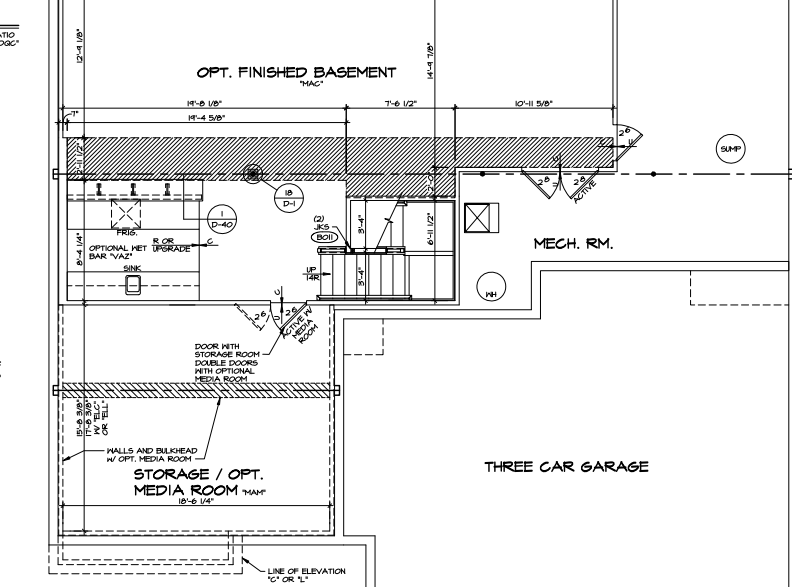
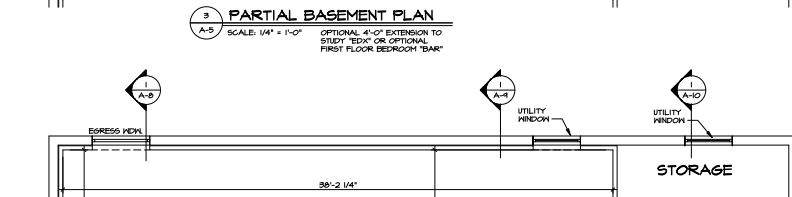
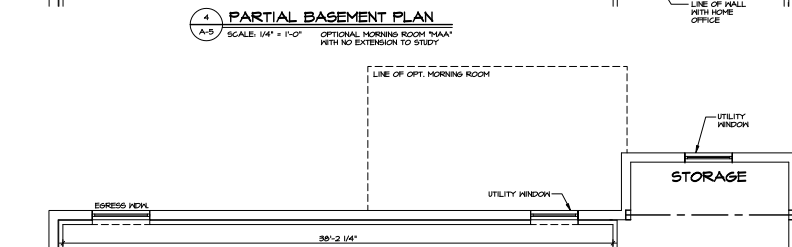
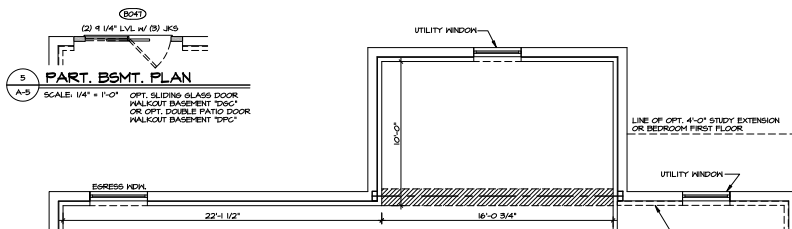

**NOTES:**  
 1. THERMO GLASS SHOWER ENCLOSURE WITH SLIDING DOOR OR OPT. SLIDING DOOR BY DIVISION.  
 2. REFER TO SHEET (D-10) FOR SHOWER DETAILS.  
 3. ALL VSCB24-42 DRAWERS TO BE SET ON RIGHT HAND.

**STRUCTURAL LEGEND**  
 (X) ENGINEERING PAGE NUMBER  
 (B) INDICATES BEARING FROM POINT-LOAD ABOVE  
 (+) REINFORCEMENT ADDED AT POINT-LOADS FROM ABOVE OR PER ENGINEERING QUANTITY/SENS VARIES PER DESIGN.

SHEET NO. <b>A-5</b>	MODEL <b>OLSEN</b>	SET NO. <b>01-500</b>	DATE <b>10/14/2019</b>
	DRAWING TITLE <b>BASEMENT PLAN</b>	VERSION <b>02</b>	DESIGNED BY <b>DAS</b>
	OWNER <b>FULL BASEMENT FOUNDATION</b>	DATE <b>10/14/2019</b>	DRAWN BY <b>DAS</b>
	OFFICE DESCRIPTION <b>FULL BASEMENT FOUNDATION</b>	DATE <b>10/14/2019</b>	DESIGNED BY <b>DAS</b>
26			

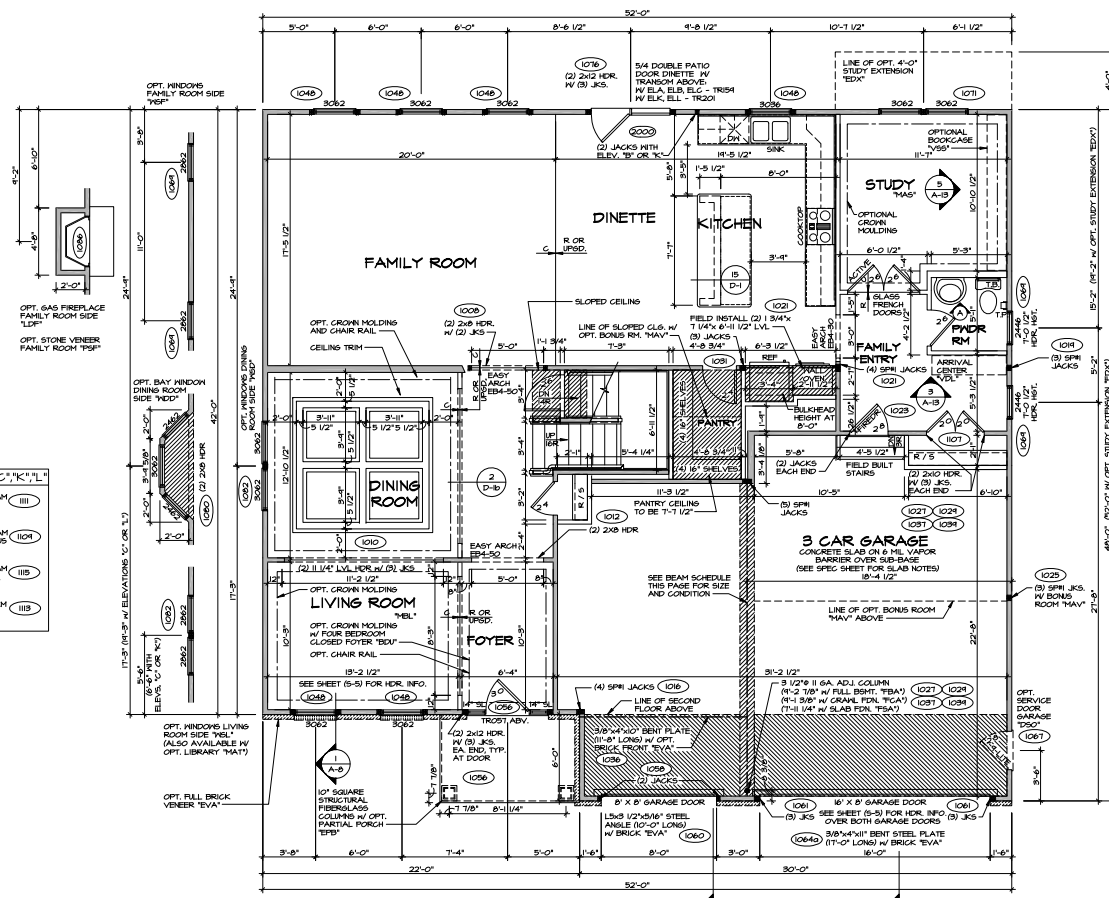
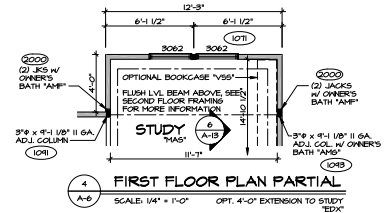
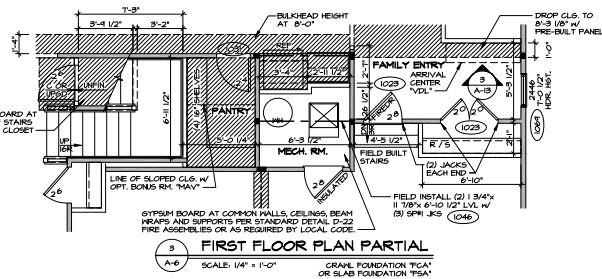

**BEAM SCHEDULE**

W/ ELEVATION "A"	W/ ELEVATIONS "B","C","K","L"
W12K 14K 21-3 1/2" STEEL BEAM BELTOUT BRICK AND BELTOUT BONUS ROOM (1021)	W12K 22K 22-1 1/2" STEEL BEAM BELTOUT BRICK AND BELTOUT BONUS ROOM (111)
W12K 26K 21-1 1/2" STEEL BEAM BELTOUT BRICK AND BELTOUT BONUS ROOM (1021)	W12K 30K 22-1 1/2" STEEL BEAM BELTOUT BRICK AND BELTOUT BONUS ROOM (104)
W12K 22K 21-1 1/2" STEEL BEAM BELTOUT BRICK AND BELTOUT BONUS ROOM (1028)	W12K 26K 22-1 1/2" STEEL BEAM BELTOUT BRICK AND BELTOUT BONUS ROOM (118)
W12K 30K 21-1 1/2" STEEL BEAM BELTOUT BRICK AND BELTOUT BONUS ROOM (1027)	W12K 35K 22-1 1/2" STEEL BEAM BELTOUT BRICK AND BELTOUT BONUS ROOM (119)

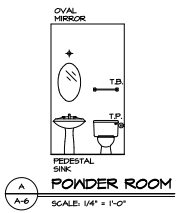
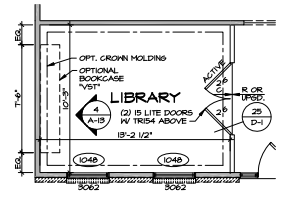

- NOTES:**
- BEARING WALL
  - NON BEARING WALL
  - ENGINEERING PAGE NUMBER
1. ALL HEADERS ARE (2) 2x6 W/ 2x4 HALLS OR (3) 2x6 W/ 2x6 WALLS, UNLESS OTHERWISE NOTED.
  2. ALL HEADERS TO HAVE (1) 2x4 OR 2x6 JACK EACH END, UNLESS OTHERWISE NOTED.
  3. ALL EXTERIOR WALLS TO BE 4" AND ALL INTERIOR WALLS TO BE 8" UNLESS OTHERWISE NOTED.
  4. HATCHED AREAS INDICATE DROPPED CEILING.
  5. SEE "TRACKED HALL PANEL DETAIL SHEET" FOR SPECIAL HALL FRAMING LOCATIONS AND HEADER SIZES, IF APPLICABLE.
  6. SEE STANDARD DETAIL SHEET D-1 FOR TRIM OPTIONS (1) L-10 AND DETAILS.
  7. ALL WINDOW HEADER HEIGHTS TO BE 8'-0" UNLESS OTHERWISE NOTED.

SHEET NO.	DATE	REVISIONS
1	2/20/14	DIR. - PROSPECTIVE REVISIONS
2	2/20/14	DIR. - REVISIONS
3	2/20/14	DIR. - REVISIONS
4	2/20/14	DIR. - REVISIONS
5	2/20/14	DIR. - REVISIONS
6	2/20/14	DIR. - REVISIONS
7	2/20/14	DIR. - REVISIONS

SET NO. 01-5000  
 VERSION 02  
 DRAWN BY: EES  
 DATE: 10/10/13  
 PROJECT: [REDACTED]  
 SHEET TITLE: FIRST FLOOR PLAN  
 OPTION DESCRIPTION: [REDACTED]

**MOORE OLSEN**  
**A-6**  
 27

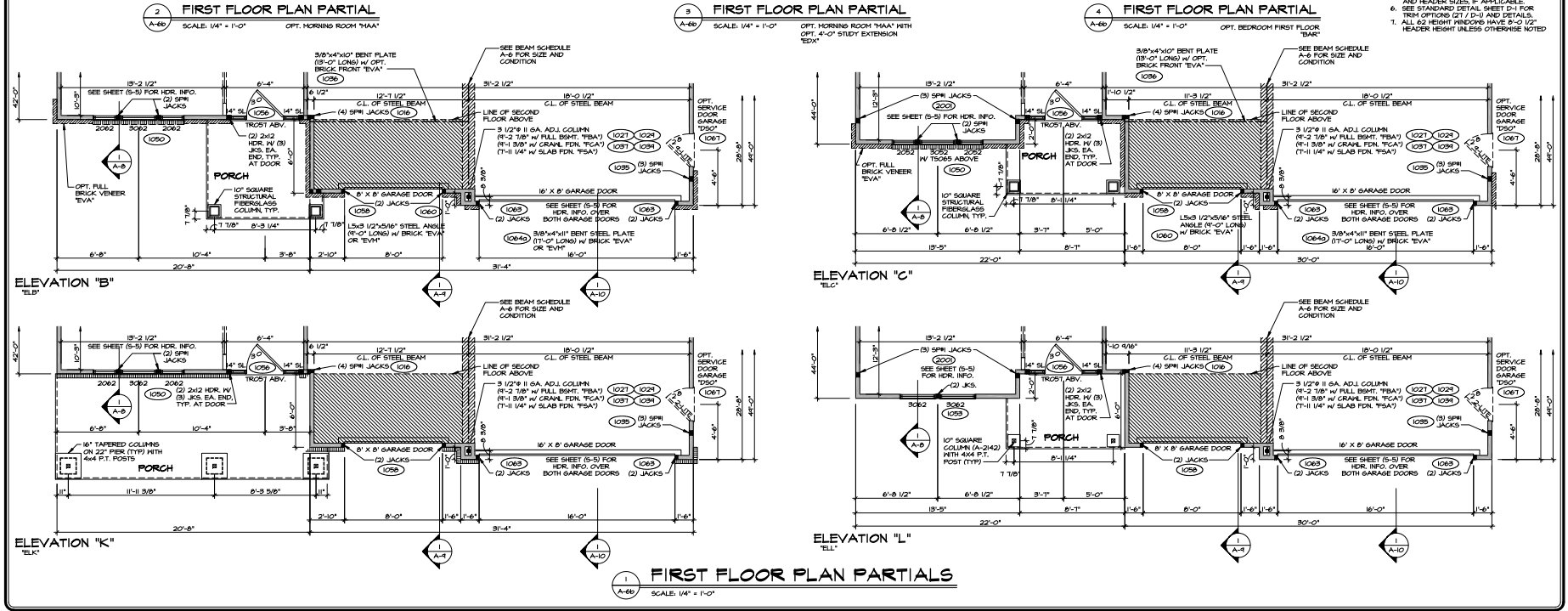
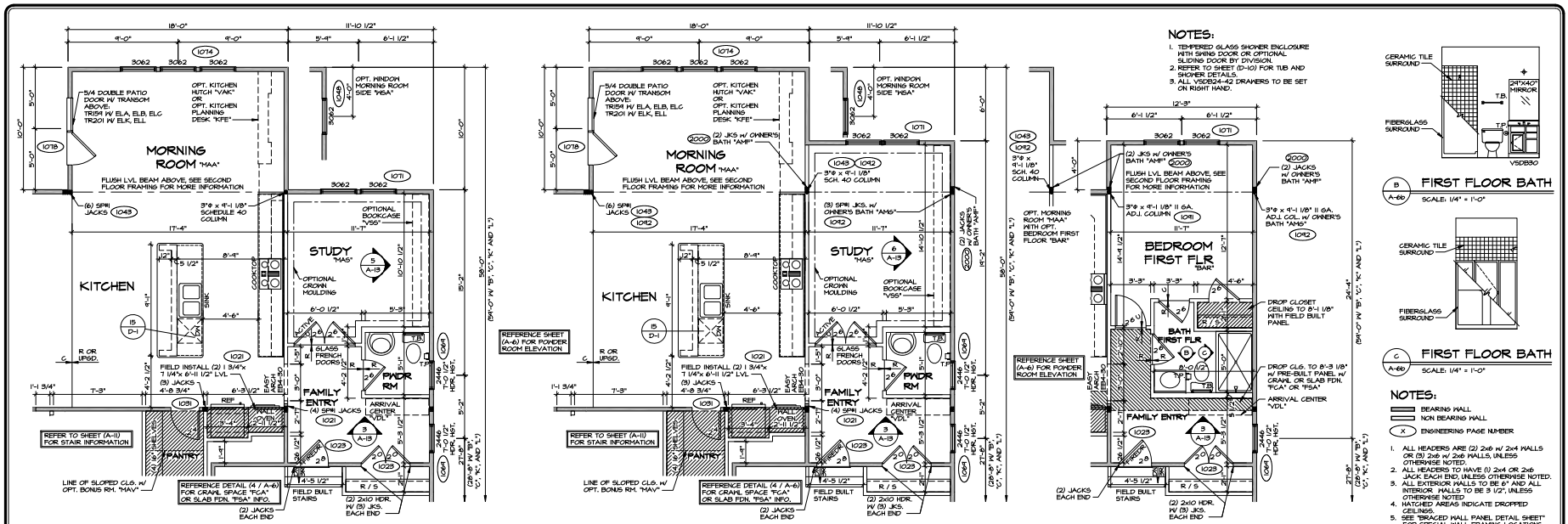

REVISION NO.	DATE	DESCRIPTION
1	10/20/2018	ISSUED FOR PERMIT
2	10/20/2018	ISSUED FOR PERMIT
3	10/20/2018	ISSUED FOR PERMIT
4	10/20/2018	ISSUED FOR PERMIT
5	10/20/2018	ISSUED FOR PERMIT
6	10/20/2018	ISSUED FOR PERMIT
7	10/20/2018	ISSUED FOR PERMIT
8	10/20/2018	ISSUED FOR PERMIT
9	10/20/2018	ISSUED FOR PERMIT
10	10/20/2018	ISSUED FOR PERMIT

SET NO. 01-5000  
 VESSEL-42  
 DRAWN BY: BEB  
 DATE: 10/20/2018  
 OFFICE: 10700 W. 4TH AVE., SUITE 100, DENVER, CO 80202  
 PROJECT: 10700 W. 4TH AVE., SUITE 100, DENVER, CO 80202  
 SHEET NO. 26  
 TOTAL SHEETS: 26



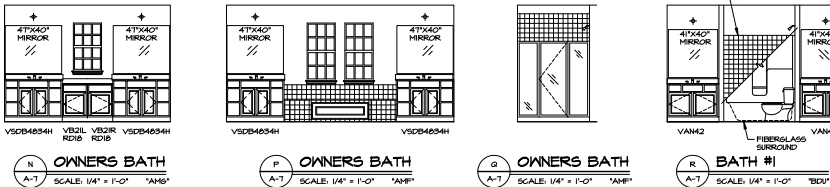
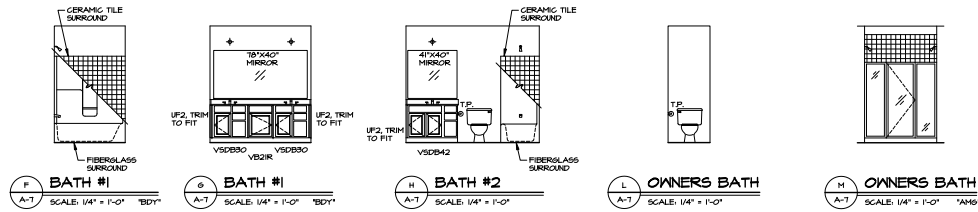

**NOTES:**

- TEMPERED GLASS SHOWER ENCLOSURE WITH SWING DOOR OR OPTIONAL SLIDING DOORS BY DIVISION.
- TUB ACCESS PANELS PROVIDED AS NEEDED. ALL MATERIALS BY DIVISION.
- REFER TO SHEET (D-10) FOR TUB AND SHOWER DETAILS.
- ALL VSDM34-42 DRAWERS TO BE SET ON RIGHT HAND.
- KNOCK GRILL PATTERNS SHOWN MAY VARY PER ELEVATION.

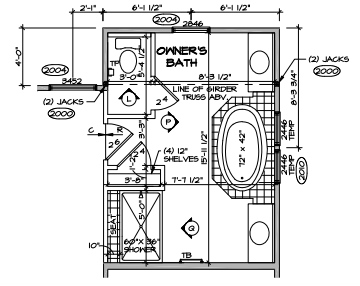

**3 SECOND FLOOR PLAN**  
SCALE: 1/4" = 1'-0"  
(UPDATED OWNERS BATH 'AMB' (ONLY AVAILABLE WITH 4' STUDY EXT. BATH ON OPT. BEDROOM FIRST FLOOR BATH))

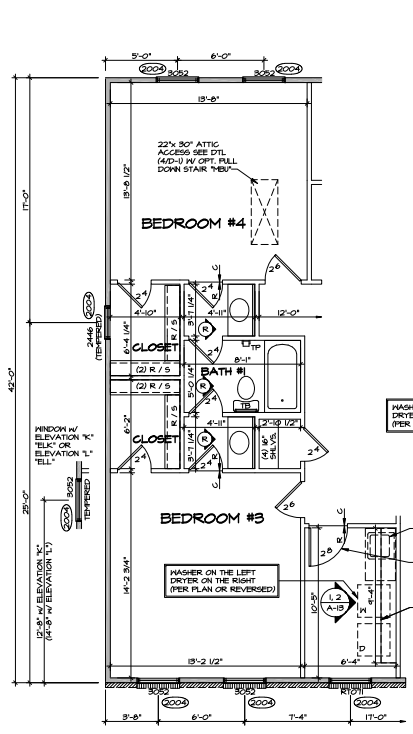

**2 SECOND FLOOR PLAN**  
SCALE: 1/4" = 1'-0"  
FOUR BEDROOM CLOSED POTTER 'BDY' (SHOWN IN ELEV. 'A')

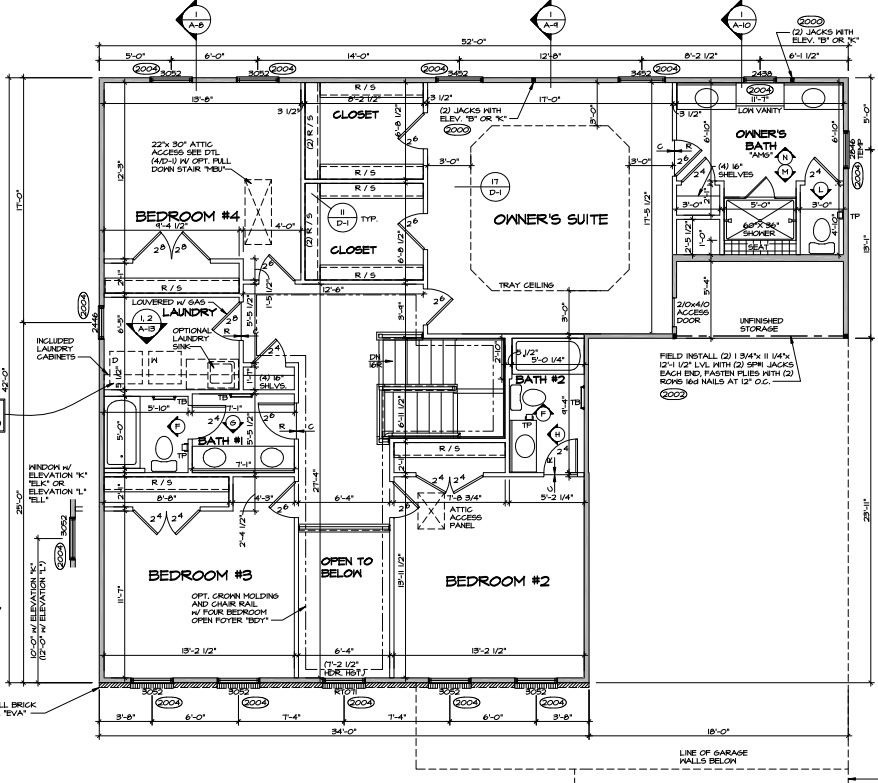

**1 SECOND FLOOR PLAN**  
SCALE: 1/4" = 1'-0"  
FOUR BEDROOM OPEN POTTER 'BDY'

**NOTES:**

- BEARING HALL
- NON BEARING HALL
- ENGINEERING PAGE NUMBER
- INDICATES BEARING FROM POINT-LOAD ABOVE

- ALL HEADERS ARE (2) 2x6 W/ 2x4 WALLS OR (3) 2x6 W/ 2x8 WALLS, UNLESS OTHERWISE NOTED.
- ALL HEADERS TO HAVE (1) 2x4 OR 2x6 JACK EACH END, UNLESS OTHERWISE NOTED.
- ALL EXTERIOR WALLS TO BE 4" AND ALL INTERIOR WALLS TO BE 3 1/2", UNLESS OTHERWISE NOTED.
- HATCHED AREAS INDICATE DROPPED CEILING.
- SEE TRACED WALL PANEL DETAIL SHEET FOR SPECIAL WALL FINISH LOCATIONS AND HEADER SIZES, IF APPLICABLE.
- SEE STANDARD DETAIL SHEET D-1 FOR TRIM OPTIONS (D7 / D-1) AND DETAILS.

REV. NO.	DATE	DESCRIPTION
1	2/20/24	DIR. - CREATED VERSION OF
2	12/24/24	DIR. - REVISED TO CLARIFY TRIM IN THE POTTER (HALLWAY PANEL ID 2828)
3	12/24/24	DIR. - REVISED TO CLARIFY TRIM IN THE POTTER (HALLWAY PANEL ID 2828)
4	12/24/24	DIR. - REVISED TO CLARIFY TRIM IN THE POTTER (HALLWAY PANEL ID 2828)
5	2/10/25	DIR. - ADDED REVISIONS



SET NO. 05.500  
VERSION 02  
DRAWN BY: DAG  
DATE: 9/30/2019  
OPTION

SHEET NO. **A-7**  
TOTAL SHEETS: 24  
OPTION DESCRIPTION

**NOTES:**

- 1. ALL HEADERS ARE (2) 2x6 W/ 2x4 PALLS OR (2) 2x6 W/ 2x6 PALLS, UNLESS OTHERWISE NOTED.
- 2. ALL HEADERS TO HAVE (1) 2x4 OR 2x6 JACK EACH END, UNLESS OTHERWISE NOTED.
- 3. ALL EXTERIOR WALLS TO BE 4" AND ALL INTERIOR WALLS TO BE 3 1/2", UNLESS OTHERWISE NOTED.
- 4. HATCHED AREAS INDICATE DROPPED CEILING.
- 5. SEE "BRACED HALL PANEL DETAIL SHEET" FOR SPECIAL HALL FRAMING LOCATIONS AND HEADER SIZES, IF APPLICABLE.
- 6. SEE STANDARD DETAIL SHEET D-1 FOR TRIM OPTIONS (D7 / D-1) AND DETAILS.

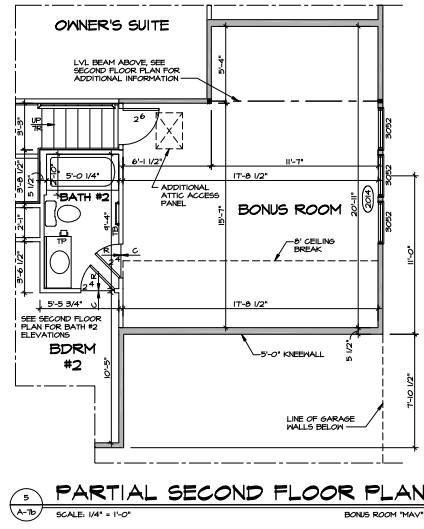
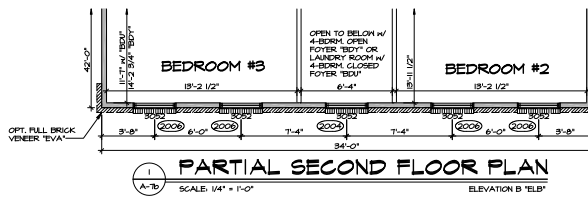
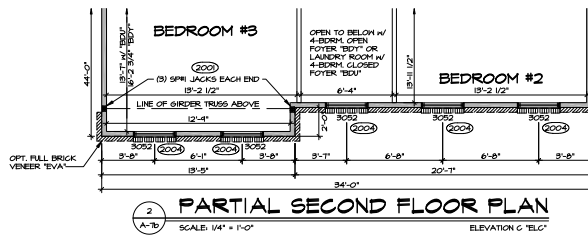
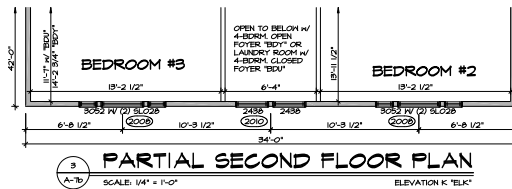
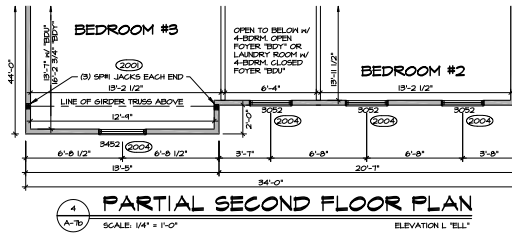

REVISIONS	
NO.	DESCRIPTION
1	2/20/14 DISK - PRODUCTIONS REVISIONS
2	2/20/14 DISK - PRODUCTIONS REVISIONS
3	2/20/14 DISK - PRODUCTIONS REVISIONS
4	2/20/14 DISK - PRODUCTIONS REVISIONS

SET NO. 01.500 VERSION 02 DRAWN BY: DAG DATE: 10/23/13 OPTION: ELEVATION 'B' OR 'C' BONUS ROOM MAY	NVR NVR INC. 21 PARKWAY, SUITE 4 FARMINGTON, CT 06031 TEL: 860.671.3172
---	---