

BASEMENT 981 S.F.

4" CONC. SLAB ON 4 MIL POLY V/B & 4" WASHED GRAVEL FILL C.J. @ 20'-0" O.C. EACH WAY.

8" CONC. FDN WALL W/ (I) #4 TOP, MID & BOTTOM
16"x8" CONC. FTG.

CL. BM TO FDN WALL

FRAME WALL TO FDN WALL

C.J.

C.J.

2x4O FLR. JOISTS @ 16" O.C.

2x4O FLR. JOISTS @ 16" O.C.

12'-11"

42'-8"

3" STL. COL. ON 42"x42"x2" FTG.

20'-4"

WH
F.D.

HIGH EFF. FURN & WH. PROVIDE COMB. AIR PER MFR. SPECS

11'-4"

CL. BEAM

C.J.

3"x2 STL. BM.

FURN.

BEAM POCKET

3'-0"

10'-9"

10'-9"

2x4O FLR. JOISTS @ 16" O.C.

15'-1"

10'-9"

15'-1"

HANDRAIL

3'-4"

3'-4"

3'-4"

3'-4"

3'-4"

3'-4"

3'-4"

3'-4"

3'-4"

3'-4"

3'-4"

3'-4"

3'-4"

3'-4"

3'-4"

3'-4"

3'-4"

3'-4"

3'-4"

3'-4"

3'-4"

3'-4"

3'-4"

3'-4"

3'-4"

3'-4"

3'-4"

3'-4"

3'-4"

3'-4"

3'-4"

3'-4"

3'-4"

FIRST FLOOR CANTILEVER
18"x2" THICKENED SLAB GRADE BEAM (CENTERED ON INTERIOR SPANS)

8" CONC. FDN WALL
16"x8" CONC. FTG.

2x4 BRG. WALL w/ STUDS @ 24" O.C. ON 24"x2" THICK. SLAB

42"x42"x2" CONC FTG. ON SOLID BEARING

UNEX 462 S.F.

24"x24" PIER, CENTERED ON INTERIOR SPANS (FOUR PIER TO 5 1/2" BELOW TOP OF FDN WALL)

5" CONC. SLAB ABOVE SLOPE 1/8" PER 12" TO D.H. DOOR C.J. @ 20'-0" O.C. EACH WAY

HOLD DN. TO 12" BEL. TOP OF FINISH GRADE FOR FOUR THRU

8" CONC. FDN WALL W/ (I) #4 TOP, MID & BOTTOM
16"x8" CONC. FTG.

UNEX. 47 S.F.

6" CONC. SLAB ABV

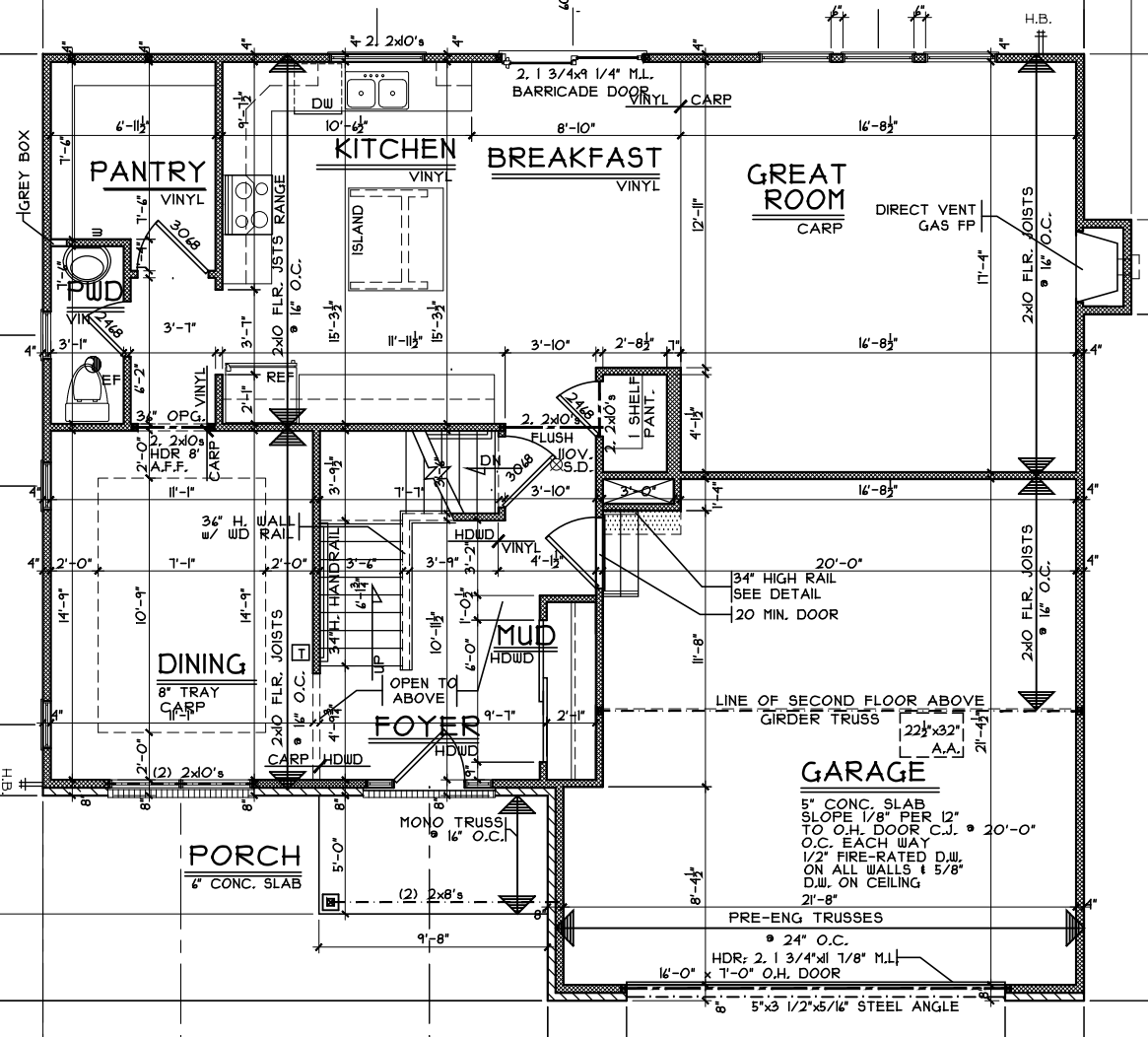

PANTRY

KITCHEN

BREAKFAST

GREAT ROOM

DINING

FOYER

MUD

GARAGE

PORCH
6" CONC. SLAB

2. 1 3/4x4 1/4" M.L.
BARRICADE DOOR

DIRECT VENT
GAS FP

34" HIGH RAIL
SEE DETAIL
20 MIN. DOOR

LINE OF SECOND FLOOR ABOVE
GIRDER TRUSS

5" CONC. SLAB
SLOPE 1/8" PER 12"
TO O.H. DOOR C.J. @ 20'-0"
O.C. EACH WAY
1/2" FIRE-RATED D.W.
ON ALL WALLS & 5/8"
D.W. ON CEILING

PRE-ENG TRUSSES

24" O.C.
HDR: 2. 1 3/4"x1 7/8" M.L.
x 7'-0" O.H. DOOR

5"x3 1/2"x5/16" STEEL ANGLE

1-GREY BOX

BTH

H.B.

2x4 F.L.R. JOISTS
@ 16" O.C.

2x4 F.L.R. JOISTS
@ 16" O.C.

22 1/2"x32"
A.A.]

21'-8"

MONO TRUSS
16" O.C.]

(2) 2x8's

5'-0"

16'-0"

6

6

6

6

6

6

6

6

6

6

6

6

6

6

6

6

6

6

6

6

4

4

4

4

4

4

4

4

4

4

4

4

4

4

4

4

4

4

4

4

4

4

4

4

4

4

4

4

4

4

4

4

4

4

4

4

4

4

4

4

4

4

4

4

4

4

4

4

4

4

4

4

4

4

4

4

4

4

4

4

4

4

4

4

4

4

4

4

4

4

4

4

4

4

4

4

4

4

4

4

4

4

4

4

4

4

4

4

4

4

4

4

4

4

4

4

4

4

4

4

4

4

4

4

4

4

4

4

4

4

4

4

4

4

4

4

4

4

4

4

4

4

4

4

4

4

4

4

4

4

4

4

4

4

4

4

4

4

4

4

4

4

4

4

4

4

4

4

4

4

4

4

4

4

4

4

4

4

4

4

4

4

4

4

4

4

4

4

4

4

4

4

4

4

4

4

4

4

4

4

4

4

4

4

4

4

4

4

4

4

4

4

4

4

4

4

BATH
VINYL

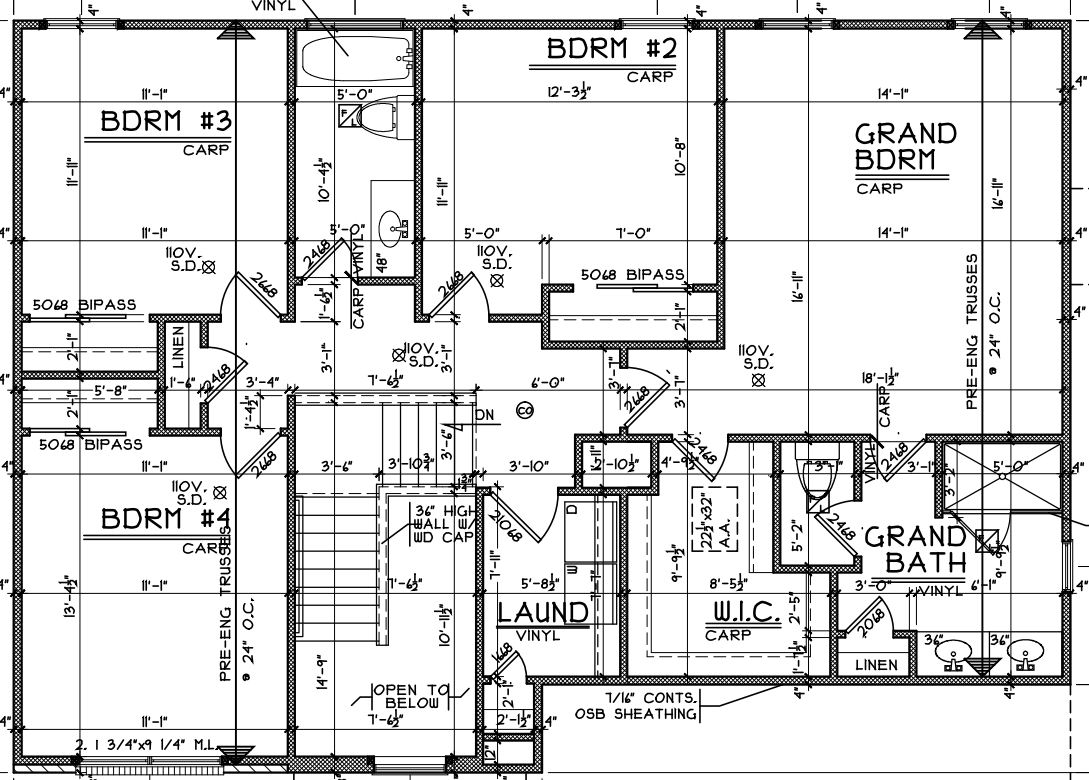

BDRM #2
12'-3 1/2"
CARP

BDRM #3
CARP

GRAND BDRM
CARP

BDRM #4
CARP

LAUND
VINYL

W.I.C.
CARP

GRAND BATH

1/16" CONTS.
OSB SHEATHING

PRE-ENG TRUSSES
@ 24" O.C.

PRE-ENG TRUSSES
@ 24" O.C.

36" HGT
W.D
CAP
BE

22 1/2" x 33"
A.A.

OPEN TO
BELOW

