

PLUMBING PLAN
SCALE: 1/4" = 1'-0"

NOTE
RADON REMEDIATION
RADON LOOP:
- (4") PERFORATED HDPE "LOOP"
- MUST BE PLACED IN STONE BED SLIGHTLY HIGHER THAN ANY INTERIOR DRAINTILE
- LOOP TO BE SEPARATE FROM ANY DRAINTILE ELEMENTS
- TO BE CORRUGATED HDPE PIPE
- SCREWS TO BE INSTALLED THROUGH LOOP AT TEE UP INTO STACK
STACK REQUIREMENTS:
- 3" PVC STACK (4" IF BASEMENT IS GREATER THAN 2200 SQFT.)
- NO PART OF STACK IS TO BE HORIZONTAL (45° ELBOWS PERMITTED AS REQUIRED)
- PIPE TO BE PHYSICALLY LABELED IN THE FIELD AS "RADON VENT" OR OTHER JURISDICTIONALLY REQUIRED LANGUAGE (ON EVERY LEVEL OF HOUSE)
- ROOF TERMINATION TO BE IN TOP 1/3 OF ROOF
- SCREEN OR VENT CAP INSTALLED TO KEEP PESTS OUT OF RADON VENT AT ROOF TERMINATION.

SHEET NO. A-5	MODEL ELM	SET NO. EMM00	NVR, Inc. 5285 Washington Blvd. Frederick, MD 21703	© NVR, Inc. expressly reserves the right to modify or amend these plans without notice. These plans are not to be reproduced, changed or altered in any way without the written consent of NVR, Inc.	DIV-COMM-LOT-UNIT DCY-S2-0149
	DRAWING TITLE PLUMBING PLAN	VERSION 01			
OPTION DESCRIPTION 7	DATE:	DATE:	STREET ADDRESS 5851 SANTYERS MILL DRIVE	CITY MIDDLETOWN	STATE OH
	OPTION	OPTION	APT. NO. ----	ZIP 45042	

LEGEND

	BEARING WALL
	NON BEARING WALL
	INDICATES BEARING FROM POINT-LOAD ABOVE
	JACKS
	BEAM/HEADER
	PAD FOOTING
	STEEL COLUMN
	TRUSS TIE DOWN
	PORTAL FRAME
	JOIST/TRUSS
	LVL
	ENGINEERING PAGE NUMBER

SEE FC DETAILS FOR FRAMING CONNECTORS

- FLOOR PLAN NOTES**
- ALL HEADERS ARE (2) 2x6 w/ 2x4 WALLS OR (3) 2x6 w/ 2x6 WALLS, UNLESS OTHERWISE NOTED.
 - ALL HEADERS TO HAVE (1) 2x4 OR 2x6 JACK AND KING STUD EACH END, UNLESS OTHERWISE NOTED. MULTI-OPENING HEADERS TO HAVE (2) JACKS AT INTERMEDIATE BEARING, UNLESS OTHERWISE NOTED. NO ADDITIONAL FLOOR SYSTEM BLOCKING OR CONTINUOUS LOAD PATH JACKS ARE REQUIRED UNLESS OTHERWISE NOTED.
 - ALL EXTERIOR WALLS TO BE 4" w/ OSB OR 3 1/2" w/ LAMINATED FIBROUS STRUCTURAL SHEATHING. ALL INTERIOR WALLS TO BE 3 1/2", UNLESS OTHERWISE NOTED. HATCHED AREAS INDICATE DROPPED CEILINGS. ALL DROPPED CEILINGS ARE 12" UNLESS OTHERWISE NOTED.
 - SEE "BRACED WALL PANEL DETAIL SHEET" FOR SPECIAL WALL FRAMING LOCATIONS AND HEADER SIZES, IF APPLICABLE.
 - SEE STANDARD DETAIL CATEGORY "IT" SHEET(S) FOR INTERIOR TRIM DETAILS.
 - SEE ARCHITECTURAL DETAIL SHEET "AD" FOR HOUSE SPECIFIC INTERIOR TRIM OPTION TABLE.
 - ALL HEADERS IN NON-BEARING WALLS SHALL BE A SINGLE FLAT 2x4 OR 2x6 ATTACHED TO CRIPPLES ABOVE, UNLESS OTHERWISE NOTED.
 - TANKED WATER HEATER SHOWN AS BASE CONDITION, OPTIONAL TANKLESS WATER HEATER IS AVAILABLE IN LIEU OF TANKED WATER HEATER.

- GYPSUM NOTES**
- AT GARAGE:
GYPSUM BOARD AT COMMON WALLS, CEILING, BEAM WRAPS AND SUPPORTS PER STANDARD DETAIL FA-1(b) FIRE ASSEMBLIES OR AS REQUIRED BY LOCAL CODE.
- AT STAIRS:
1/2" GYPSUM BOARD AT UNDERSIDE OF STAIRS AND WALLS IN CLOSET

BASEMENT JACK SCHEDULE

IDENTIFIER	DESCRIPTION	ENG. NUM.	REMARKS

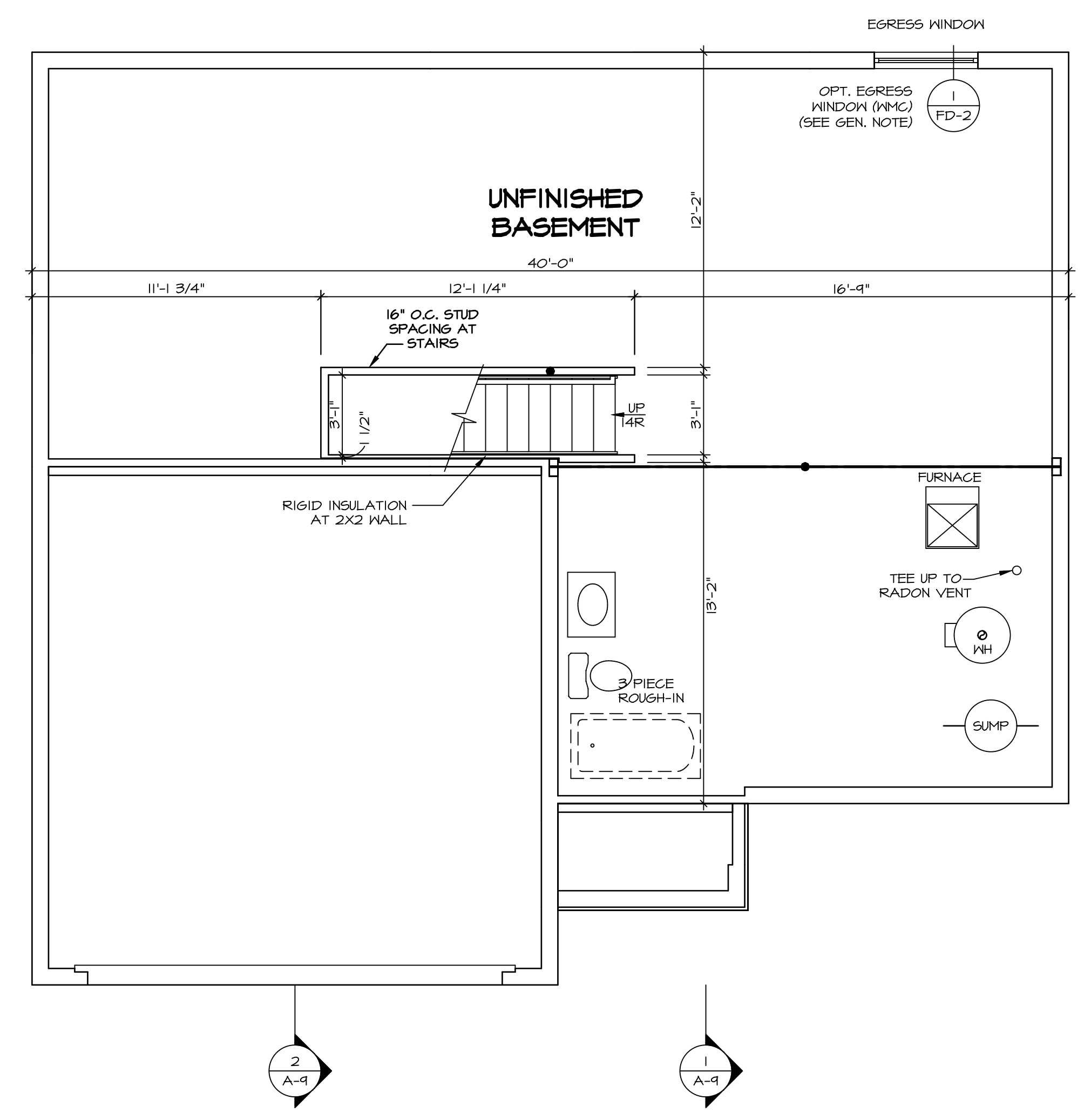

1
A-6
BASEMENT FLOOR PLAN
SCALE: 1/4" = 1'-0"

MODEL
ELM
DRAWING TITLE
BASEMENT FLOOR PLAN
OPTION DESCRIPTION
FULL BASEMENT FOUNDATION

SHEET NO.
A-6
8

SET NO. EMM00
VERSION 01
DRAWN BY
DATE:
OPTION
FEA

© NVR, Inc. expressly reserves the right to modify or change these plans at any time without notice. These plans are not to be reproduced, changed or altered in any way without the written consent of NVR, Inc.

NVR
NVR, Inc. Suite 100
Frederick, MD 21703
5285 Walkers Lane

DIV-COMM-LOT-UNIT
DCY-S2-0149
COMM-LOT
SANTYERS MILL - SIMPLY RYAN - 0149
STREET ADDRESS
8851 SANTYERS MILL DRIVE
CITY
MIDDLETOWN
STATE
OH
ZIP
45042

C:\NVR\Solves\ELM_EMM00_01\DCY-S2-0149\171808\Sheets\Lot_Specific\B_A-6_BSMT_LS.dwg 03/06/20 - 2:35 pm

LEGEND

[Symbol]	BEARING WALL
[Symbol]	NON BEARING WALL
[Symbol]	INDICATES BEARING FROM POINT-LOAD ABOVE
[Symbol]	JACKS
[Symbol]	BEAM/HEADER
[Symbol]	PAD FOOTING
[Symbol]	STEEL COLUMN
[Symbol]	TRUSS TIE DOWN
[Symbol]	PORTAL FRAME
[Symbol]	JOIST/TRUSS
[Symbol]	LVL
[Symbol]	ENGINEERING PAGE NUMBER

SEE FC DETAILS FOR FRAMING CONNECTORS

- FLOOR PLAN NOTES**
- ALL HEADERS ARE (2) 2x6 w/ 2x4 WALLS OR (3) 2x6 w/ 2x6 WALLS, UNLESS OTHERWISE NOTED.
 - ALL HEADERS TO HAVE (1) 2x4 OR 2x6 JACK AND KING STUD EACH END, UNLESS OTHERWISE NOTED. MULTI-OPENING HEADERS TO HAVE (2) JACKS AT INTERMEDIATE BEARINGS, UNLESS OTHERWISE NOTED. NO ADDITIONAL FLOOR SYSTEM BLOCKING OR CONTINUOUS LOAD PATH JACKS ARE REQUIRED UNLESS OTHERWISE NOTED.
 - ALL EXTERIOR WALLS TO BE 4" w/ OSB OR 3 1/2" w/ LAMINATED FIBROUS STRUCTURAL SHEATHING, ALL INTERIOR WALLS TO BE 3 1/2" UNLESS OTHERWISE NOTED.
 - HATCHED AREAS INDICATE DROPPED CEILINGS. ALL DROPPED CEILINGS ARE 12" UNLESS OTHERWISE NOTED.
 - SEE "BRACED WALL PANEL DETAIL SHEET" FOR SPECIAL WALL FRAMING LOCATIONS AND HEADER SIZES, IF APPLICABLE.
 - SEE STANDARD DETAIL CATEGORY "IT" SHEET(S) FOR INTERIOR TRIM DETAILS.
 - SEE ARCHITECTURAL DETAIL SHEET "AD" FOR HOUSE SPECIFIC INTERIOR TRIM OPTION TABLE.
 - ALL HEADERS IN NON-BEARING WALLS SHALL BE A SINGLE FLAT 2x4 OR 2x6 ATTACHED TO CRIPPLES ABOVE, UNLESS OTHERWISE NOTED.
 - TANKED WATER HEATER SHOWN AS BASE CONDITION. OPTIONAL TANKLESS WATER HEATER IS AVAILABLE IN LIEU OF TANKED WATER HEATER.

- GYPSUM NOTES**
- AT GARAGE:
GYPSUM BOARD AT COMMON WALLS, CEILINGS, BEAM WRAPS AND SUPPORTS PER STANDARD DETAIL FA-(b) FIRE ASSEMBLIES OR AS REQUIRED BY LOCAL CODE.
- AT STAIRS:
1/2" GYPSUM BOARD AT UNDERSIDE OF STAIRS AND WALLS IN CLOSET

NOTE:
EXTERIOR WALLS DRAWN TO FRAMING WIDTH, EXTERIOR SHEATHING IS NOT INCLUDED IN WALL THICKNESS.

ALL WINDOWS HAVE 1"-0 1/2" HEADER HEIGHT UNLESS OTHERWISE NOTED

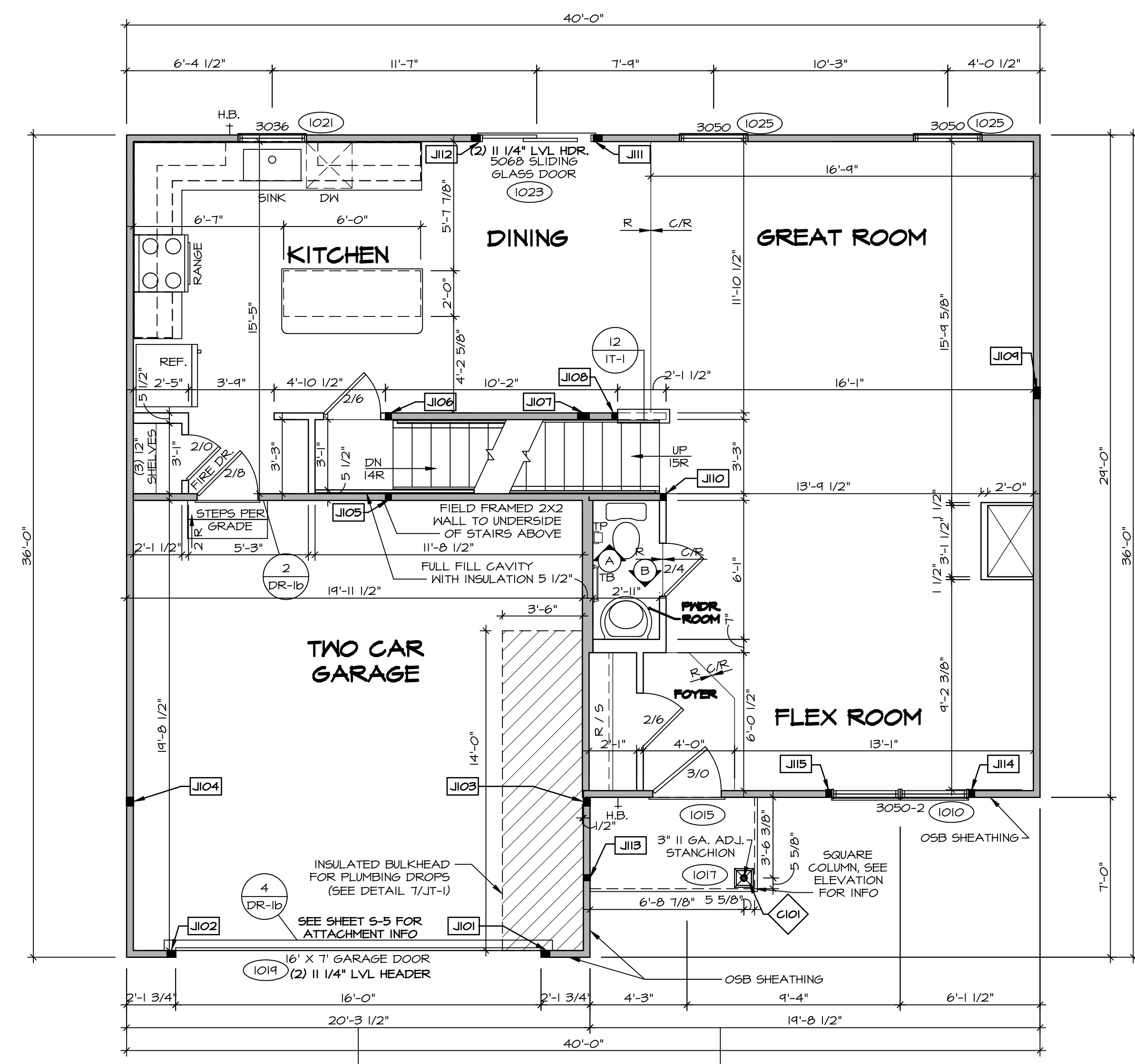

FIRST FLOOR JACK SCHEDULE

IDENTIFIER	DESCRIPTION	ENG. NUM.
J101	JACK - (3) 2X4 SFF STUD GRADE	1011
J102	JACK - (3) 2X4 SFF STUD GRADE	1011
J103	JACK - (3) 2X4 SFF STUD GRADE	2004
J104	JACK - (3) 2X4 SFF STUD GRADE	2004
J105	JACK - (2) 2X4 SFF STUD GRADE	1004
J106	JACK - (2) 2X4 SFF STUD GRADE	1004
J107	JACK - (4) 2X4 SFF STUD GRADE	1002
J108	JACK - (2) 2X4 SFF STUD GRADE	1028
J109	JACK - (4) 2X4 SFF STUD GRADE	1008
J110	JACK - (2) 2X4 SFF STUD GRADE	1006
J111	JACK - (3) 2X4 SFF STUD GRADE	1023
J112	JACK - (3) 2X4 SFF STUD GRADE	1023
J113	JACK - (2) 2X4 SFF STUD GRADE	1011
J114	JACK - (2) 2X4 SFF STUD GRADE	1010
J115	JACK - (2) 2X4 SFF STUD GRADE	1010

STEEL COLUMN SCHEDULE

IDENTIFIER	STYLE	HEIGHT	ENG. NUM.	REMARKS
C101	STANCHION PORCH - 3 IN DIA 11GA ADJ	8'-0 5/8"	1017	FBA

FIRST FLOOR PLAN
SCALE: 1/4" = 1'-0"

DCY-S2-0149
DIV-COMM-LOT-UNIT
COMM-LOT
STREET ADDRESS
CITY
STATE
ZIP

SAINTERS MILL - SIMPLY RYAN - 0149
APT. NO.
8881 SAINTERS MILL DRIVE
MIDDLETOWN OH 45042

NVR
NVR, Inc. Suite 100
5285 Washington Blvd
Frederick, MD 21703

SET NO. EMM00
VERSION 01
DRAWN BY
DATE:
OPTION

MODEL ELM
DRAWING TITLE
FIRST FLOOR PLAN
OPTION DESCRIPTION

A-7
9

LEGEND	
	BEARING WALL
	NON BEARING WALL
	INDICATES BEARING FROM POINT-LOAD ABOVE
	JACKS
	BEAM/HEADER
	PAD FOOTING
	STEEL COLUMN
	TRUSS TIE DOWN
	PORTAL FRAME
	JOIST/TRUSS
	LVL
	ENGINEERING PAGE NUMBER

SEE FC DETAILS FOR FRAMING CONNECTORS

- FLOOR PLAN NOTES**
- ALL HEADERS ARE (2) 2x6 w/ 2x4 WALLS OR (3) 2x6 w/ 2x6 WALLS, UNLESS OTHERWISE NOTED.
 - ALL HEADERS TO HAVE (1) 2x4 OR 2x6 JACK AND KING STUD EACH END, UNLESS OTHERWISE NOTED. MULTI-OPENING HEADERS TO HAVE (2) JACKS AT INTERMEDIATE BEARINGS, UNLESS OTHERWISE NOTED. NO ADDITIONAL FLOOR SYSTEM BLOCKING OR CONTINUOUS LOAD PATH JACKS ARE REQUIRED UNLESS OTHERWISE NOTED.
 - ALL EXTERIOR WALLS TO BE 4" w/ OSB OR 3 1/2" w/ LAMINATED FIBROUS STRUCTURAL SHEATHING, ALL INTERIOR WALLS TO BE 3 1/2" UNLESS OTHERWISE NOTED. HATCHED AREAS INDICATE DROPPED CEILING. ALL DROPPED CEILING ARE 12" UNLESS OTHERWISE NOTED. SEE "BRACED WALL PANEL DETAIL SHEET" FOR SPECIAL WALL FRAMING LOCATIONS AND HEADER SIZES, IF APPLICABLE.
 - SEE STANDARD DETAIL CATEGORY "IT" SHEET(S) FOR INTERIOR TRIM DETAILS.
 - SEE ARCHITECTURAL DETAIL SHEET "AD" FOR HOUSE SPECIFIC INTERIOR TRIM OPTION TABLE.
 - ALL HEADERS IN NON-BEARING WALLS SHALL BE A SINGLE FLAT 2x4 OR 2x6 ATTACHED TO GRIPPLERS ABOVE, UNLESS OTHERWISE NOTED.
 - TANKED WATER HEATER SHOWN AS BASE CONDITION. OPTIONAL TANKLESS WATER HEATER IS AVAILABLE IN LIEU OF TANKED WATER HEATER.

NOTE:
EXTERIOR WALLS DRAWN TO FRAMING WIDTH, EXTERIOR SHEATHING IS NOT INCLUDED IN WALL THICKNESS.

ALL WINDOWS HAVE 1"-4 5/8" HEADER HEIGHT UNLESS OTHERWISE NOTED

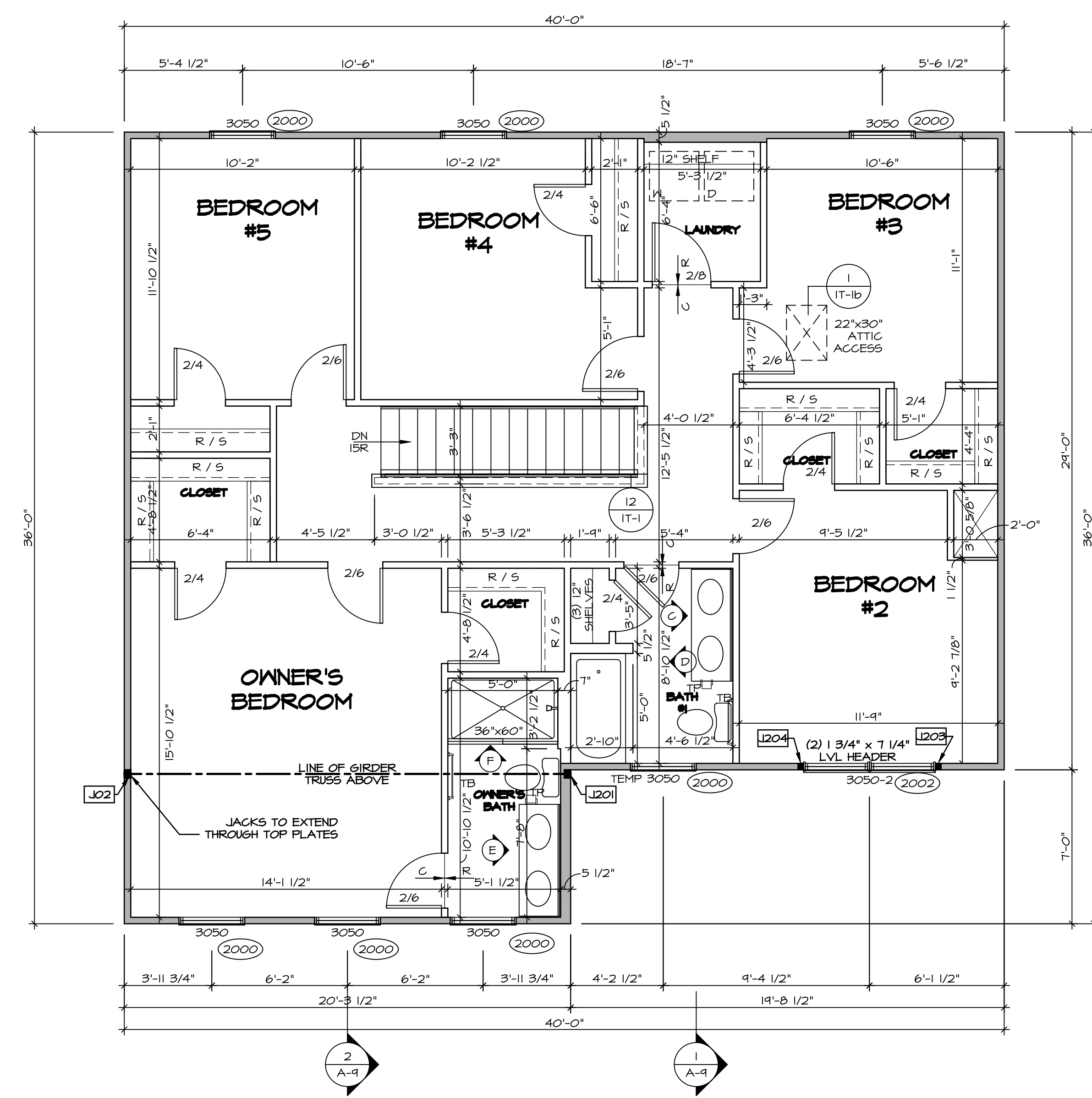

SECOND FLOOR PLAN
SCALE: 1/4" = 1'-0"

SECOND FLOOR JACK SCHEDULE

IDENTIFIER	DESCRIPTION	ENG. NUM.
J201	JACK - (3) 2X4 5PH	2004
J202	JACK - (3) 2X4 5PH	2004
J203	JACK - (2) 2X4 5FF STUD GRADE	2002
J204	JACK - (2) 2X4 5FF STUD GRADE	2002

DIV-COMM-LOT-UNIT: **DCY-S2-0149**
 COMM-LOT: **SANYERS MILL - SIMPLY RYAN - 0149**
 STREET ADDRESS: **5651 SANYERS MILL DRIVE**
 CITY: **MIDDLETOWN** STATE: **OH** ZIP: **45042**
 APT. NO.: **----**

© NVR, Inc. expressly reserves the right to modify or change these plans without notice. These plans are not to be reproduced, changed or altered in any way without the written consent of NVR, Inc.

NVR
 NVR, Inc. Suite 100
 Frederick, MD 21703
 5285 Walkers Lane
 Frederick, MD 21703

SET NO. **EMMOO**
 VERSION **01**
 DRAWN BY
 DATE:
 OPTION

MODEL **ELM**
 DRAWING TITLE **SECOND FLOOR PLAN**
 OPTION DESCRIPTION

SHEET NO. **A-8**
 10

C:\NVR\Solves\ELM\EMMOO_01\DCY-S2-0149\171808\Sheets\Lot_Specific\10_A-B_FLN2_Ls.dwg 03/06/20 - 2:35 pm

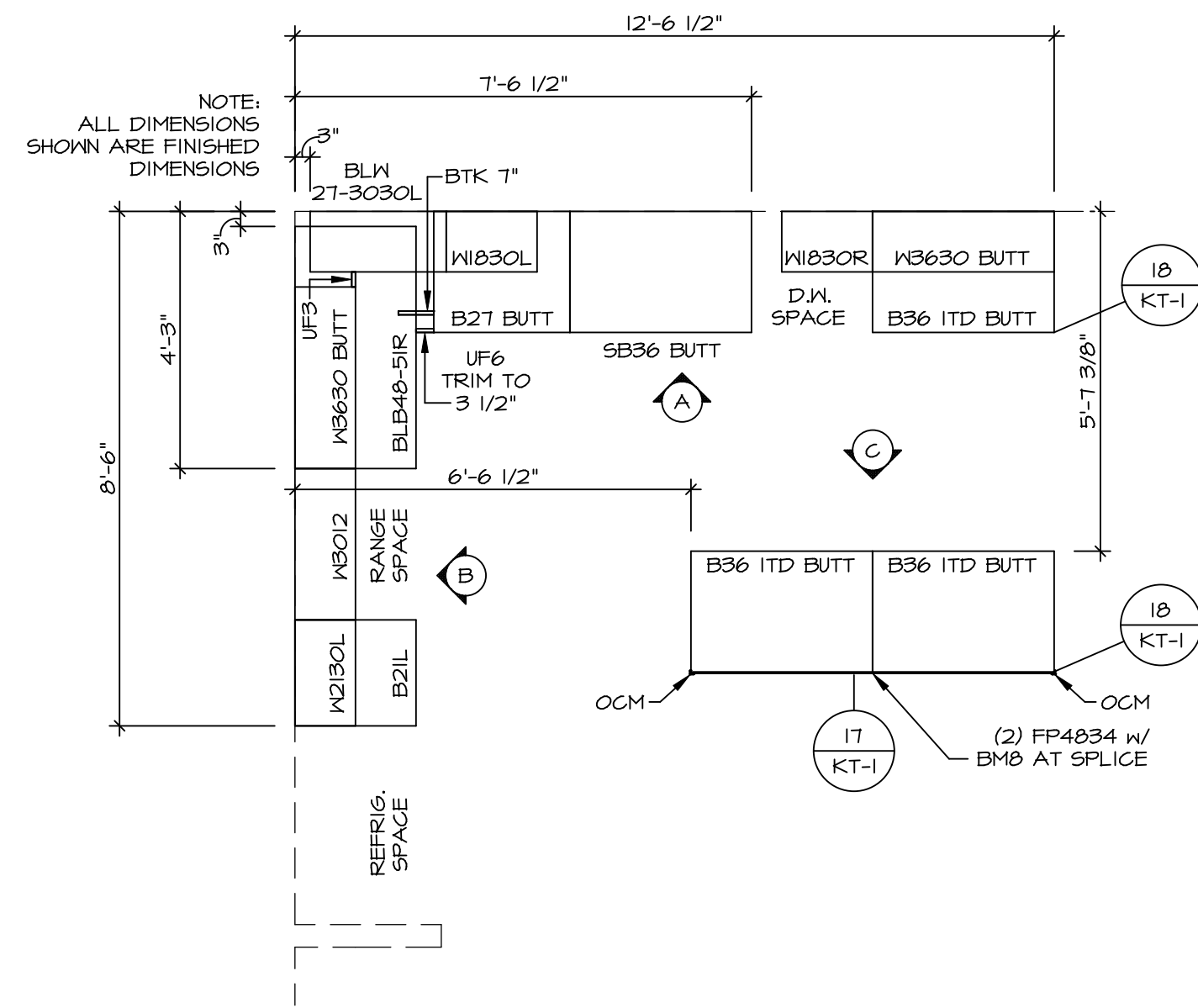

KITCHEN CABINET PLAN (KC-3644)
SCALE: 3/8" = 1'-0" A-12

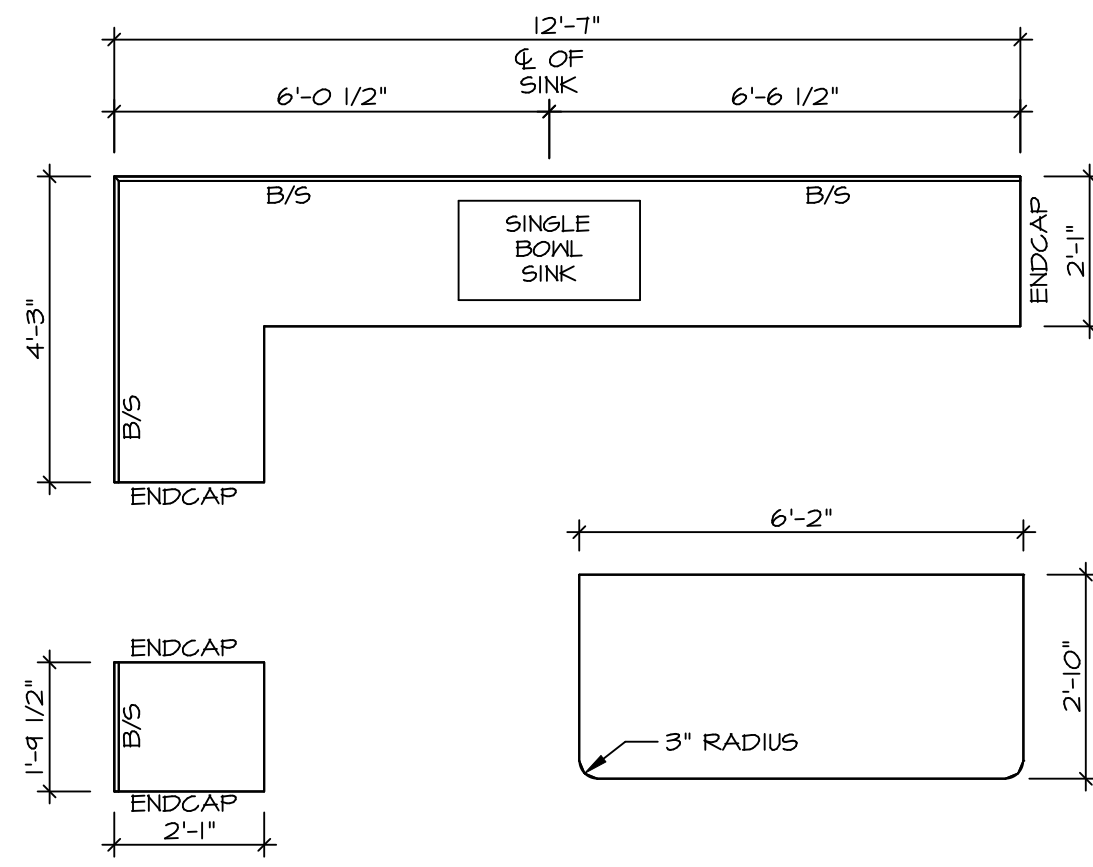

KITCHEN COUNTERTOP PLAN (KT-3644)
SCALE: 3/8" = 1'-0" A-12

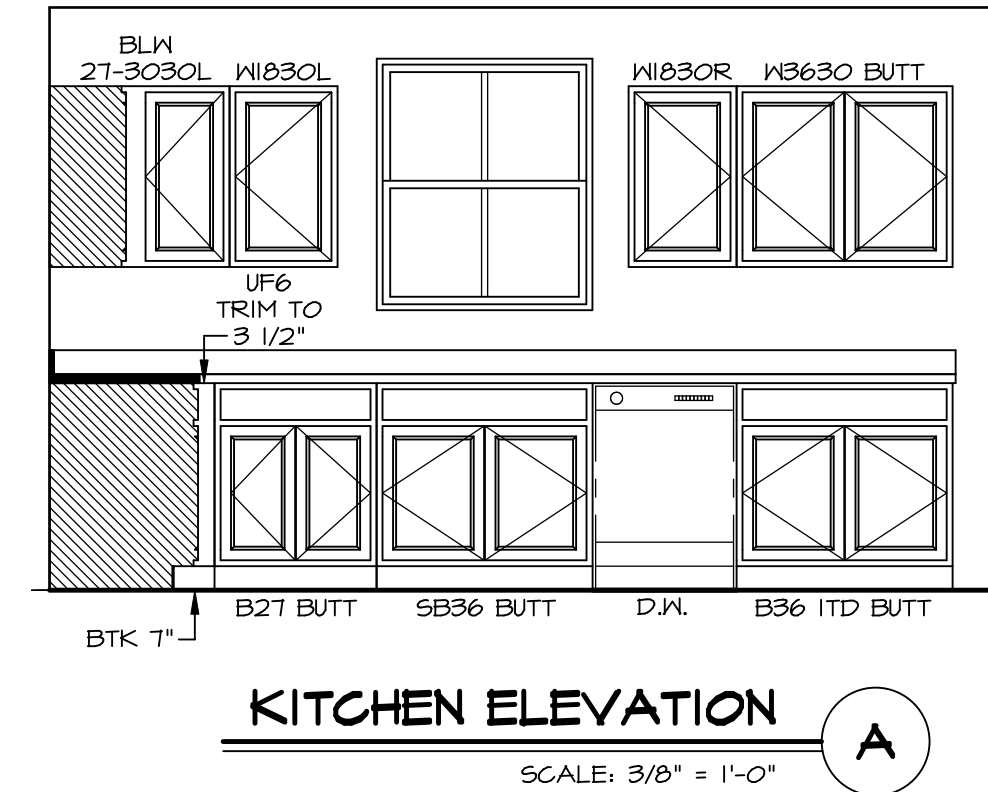

KITCHEN ELEVATION A
SCALE: 3/8" = 1'-0"

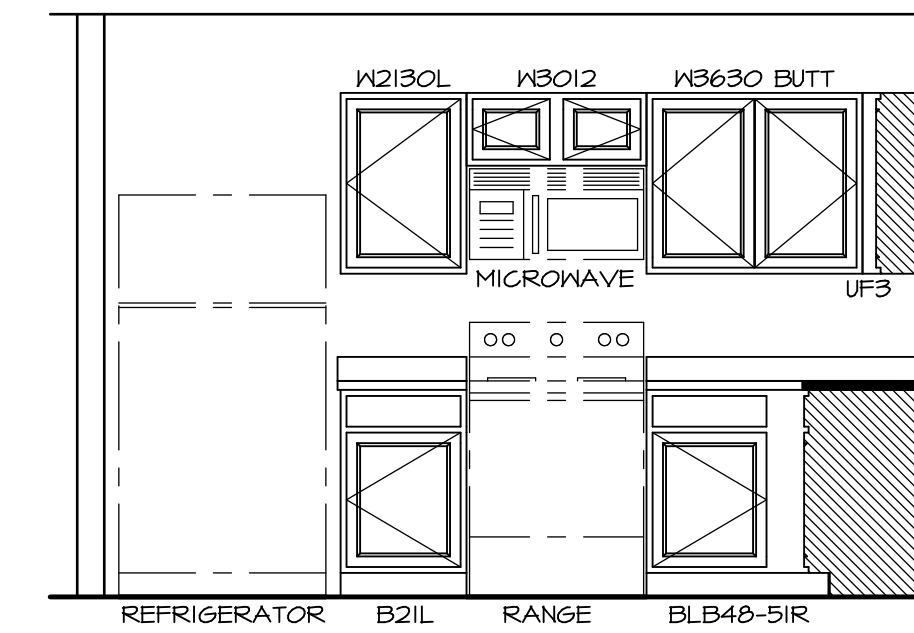

KITCHEN ELEVATION B
SCALE: 3/8" = 1'-0"

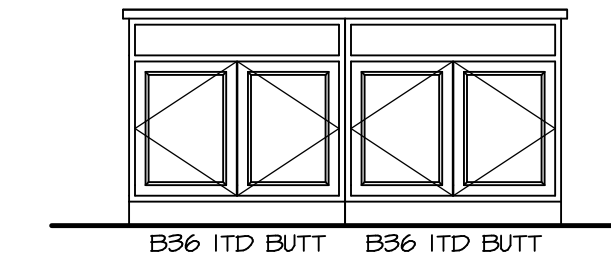

KITCHEN ELEVATION C
SCALE: 3/8" = 1'-0"

SHEET NO. A-12	MODEL ELM	SET NO. EMMOO	VERSION 01
	DRAWING TITLE KITCHEN	DRAWN BY	DATE:
13	OPTION DESCRIPTION	OPTION	
	DIV-COMM-LOT-UNIT DCY-S2-0149 COMM-LOT SANTYERS MILL - SIMPLY RYAN - 0149 STREET ADDRESS 5851 SANTYERS MILL DRIVE CITY STATE OH ZIP MIDDLETOWN OH 45042		

NOTES:
 1. CABINET LAYOUT(S) ARE BASED ON FINISHED DIMENSIONS TO DRYWALL.
 2. IF KITCHEN PLANS/ELEVATIONS CALL-OUT STANDARD MOLDING, REFER TO STANDARD DETAIL (1/KT-1) FOR REPLACEMENT BASED ON CABINET STYLE.
 3. ALL (UF*) FILLERS ARE TO BE "TRIM TO FIT".

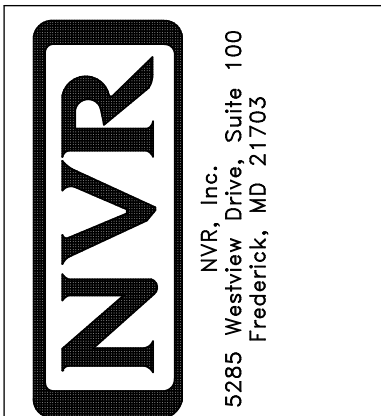

© NVR, Inc. expressly reserves the right to modify or change these plans without notice. These plans are not to be reproduced, changed or altered in any way without the written consent of NVR, Inc.



F OWNER'S BATH
SCALE: 1/4" = 1'-0"

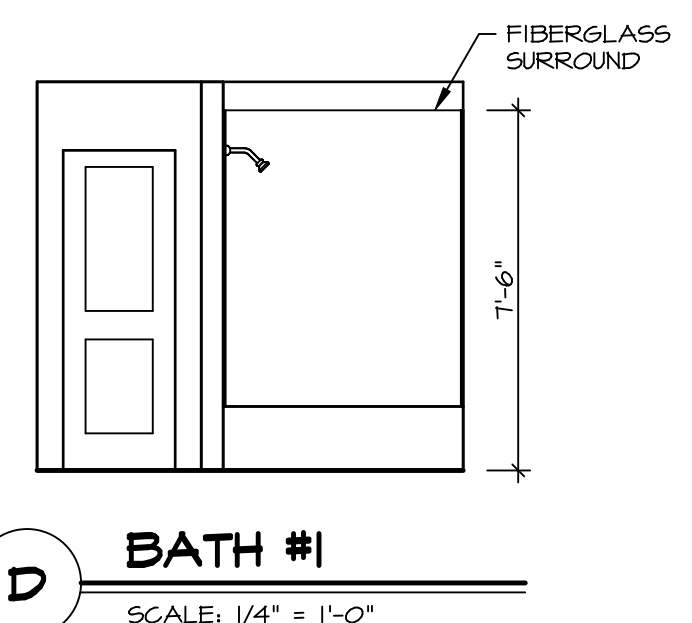

D BATH #1
SCALE: 1/4" = 1'-0"

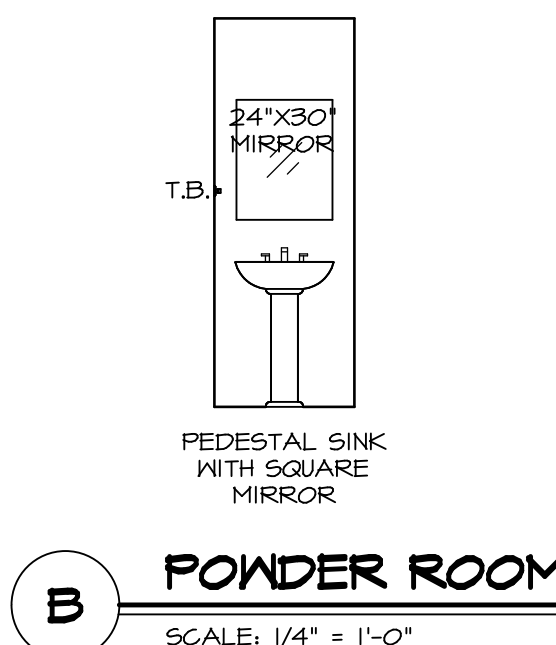

B POWDER ROOM
SCALE: 1/4" = 1'-0"

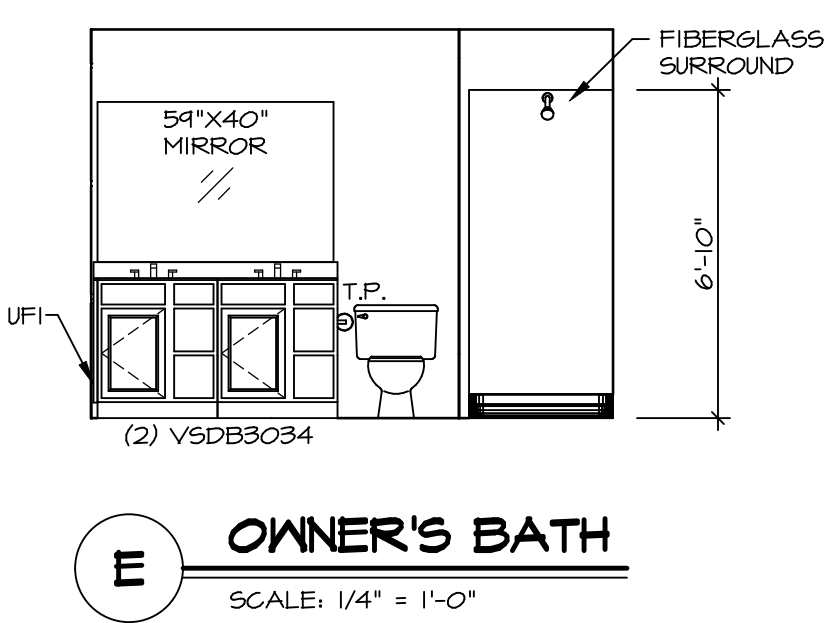

E OWNER'S BATH
SCALE: 1/4" = 1'-0"

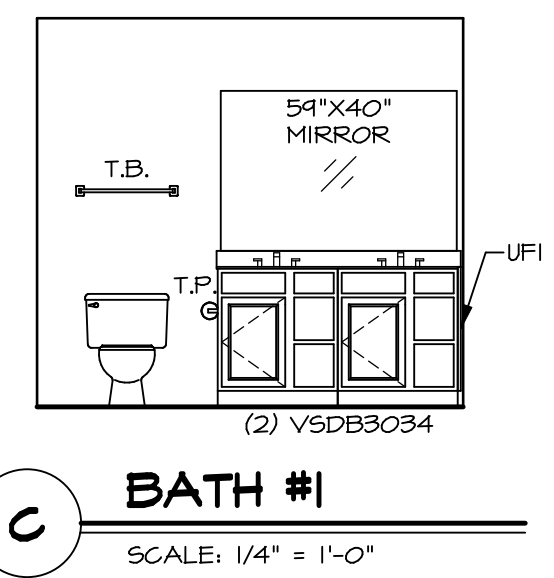

C BATH #1
SCALE: 1/4" = 1'-0"

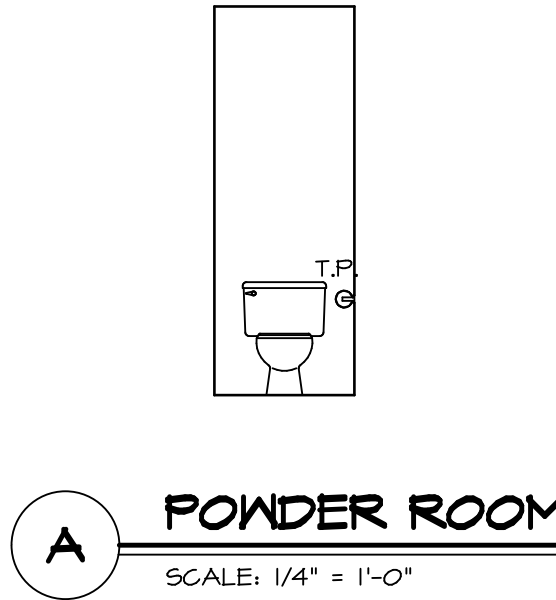

A POWDER ROOM
SCALE: 1/4" = 1'-0"

- NOTES:**
1. TEMPERED GLASS SHOWER ENCLOSURE WITH SWING DOOR OR OPTIONAL SLIDING DOOR BY DIVISION.
 2. TUB ACCESS PANELS PROVIDED AS NEEDED, ALL MATERIALS BY DIVISION.
 3. ALL BATH ELEVATIONS ARE SHOWN PER PLAN.
 4. ALL V5DB34-42 DRAWERS TO BE SET ON RIGHT HAND.

SHEET NO. A-13	MODEL ELM	DRAWING TITLE BATH ELEVATIONS	SET NO. EMM00	DIV-COMM-LOT-UNIT
			VERSION 01	DCY-S2-0149
OPTION DESCRIPTION 14	DRAWN BY	DATE:	DATE:	COMM-LOT
			OPTION	SANCTERS MILL - SIMPLY RYAN - 0149
SHEET NO. 14		STREET ADDRESS 5851 SANCTERS MILL DRIVE		
MODEL ELM		CITY MIDDLETOWN		
DRAWING TITLE BATH ELEVATIONS		STATE OH		
OPTION DESCRIPTION 14		ZIP 45042		

© NVR, Inc. expressly reserves the right to modify or amend these plans at any time without notice. These plans are not to be reproduced, changed or altered in any way without the written consent of NVR, Inc.

NVR
NVR, Inc. Suite 100
Frederick, MD 21703
5285 Washburn Drive

C:\NVR\Solves\ELM_EMM00_01\DCY-S2-0149\171808\Sheets\Lot_Specific\14_A-13_BATH_LS.dwg 03/05/20 - 2:35 pm