

PLUMBING PLAN
SCALE: 1/4" = 1'-0"

SHEET NO. A-4	MODEL BIRCH	SET NO. BRH00
	DRAWING TITLE PLUMBING PLAN	VERSION 01
	OPTION DESCRIPTION	DRAWN BY
14		DATE:
		OPTION



© NVR, Inc. NVR, Inc. expressly reserves the right to modify, alter, change, or update these plans without notice. These plans are not to be reproduced, changed, or copied in any way without the express written consent of NVR, Inc.

DIV-COMM-LOT-UNIT
DCY-S2-0161

COMM-LOT
SANTYERS MILL - SIMPLY RYAN - 0161

STREET ADDRESS
5741 SANTYERS MILL DRIVE

CITY
MIDDLETOWN

STATE
OH

ZIP
45042

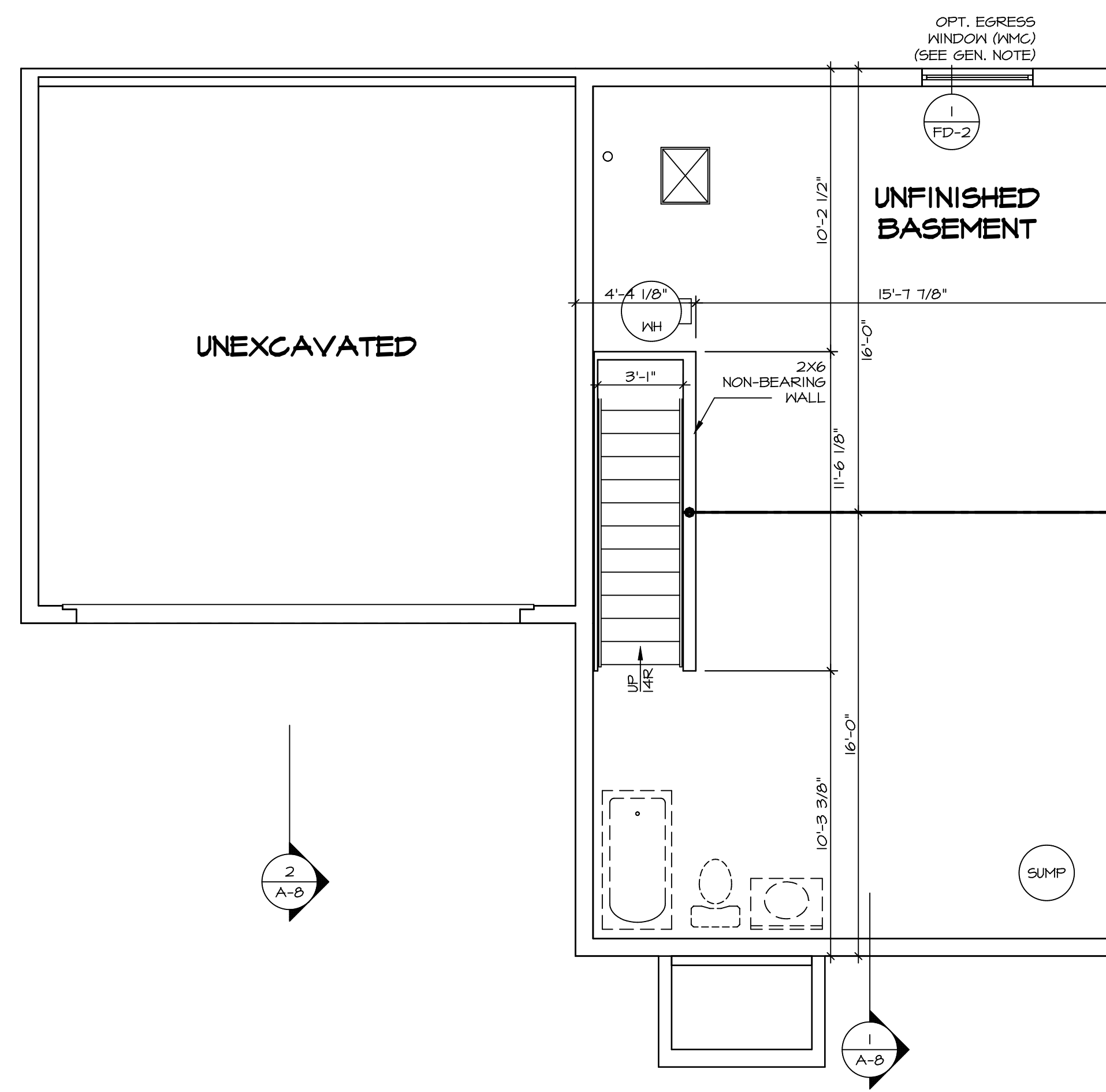

LEGEND

- BEARING WALL
- NON BEARING WALL
- INDICATES BEARING FROM POINT-LOAD ABOVE
- JACKS
- BEAM/HEADER
- PAD FOOTING
- STEEL COLUMN
- TRUSS TIE DOWN
- PORTAL FRAME
- JOIST/TRUSS
- LVL
- ENGINEERING PAGE NUMBER

SEE FC DETAILS FOR FRAMING CONNECTORS

- FLOOR PLAN NOTES** RYAN
- ALL HEADERS ARE (2) 2x6 w/ 2x4 WALLS OR (3) 2x6 w/ 2x6 WALLS, UNLESS OTHERWISE NOTED.
 - ALL HEADERS TO HAVE (1) 2x4 OR 2x6 JACK AND KING STUD EACH END, UNLESS OTHERWISE NOTED. MULTI-OPENING HEADERS TO HAVE (2) JACKS AT INTERMEDIATE BEARINGS, UNLESS OTHERWISE NOTED. NO ADDITIONAL FLOOR SYSTEM BLOCKING OR CONTINUOUS LOAD PATH JACKS ARE REQUIRED UNLESS OTHERWISE NOTED.
 - ALL EXTERIOR WALLS TO BE 4" w/ OSB OR 3 1/2" w/ LAMINATED FIBROUS STRUCTURAL SHEATHING. ALL INTERIOR WALLS TO BE 3 1/2", UNLESS OTHERWISE NOTED. HATCHED AREAS INDICATE DROPPED CEILINGS. ALL DROPPED CEILINGS ARE 12" UNLESS OTHERWISE NOTED.
 - SEE "BRACED WALL PANEL DETAIL SHEET" FOR SPECIAL WALL FRAMING LOCATIONS AND HEADER SIZES, IF APPLICABLE.
 - SEE STANDARD DETAIL CATEGORY "IT" SHEET(S) FOR INTERIOR TRIM DETAILS.
 - SEE ARCHITECTURAL DETAIL SHEET "AD" FOR HOUSE SPECIFIC INTERIOR TRIM OPTION TABLE.
 - ALL HEADERS IN NON-BEARING WALLS SHALL BE A SINGLE FLAT 2X4 OR 2X6 ATTACHED TO CRIPPLES ABOVE, UNLESS OTHERWISE NOTED.
 - TANKED WATER HEATER SHOWN AS BASE CONDITION, OPTIONAL TANKLESS WATER HEATER IS AVAILABLE IN LIEU OF TANKED WATER HEATER.

GYPSUM NOTES

AT GARAGE:
GYPSUM BOARD AT COMMON WALLS, CEILING, BEAM WRAPS AND SUPPORTS PER STANDARD DETAIL FA-1(b) FIRE ASSEMBLIES OR AS REQUIRED BY LOCAL CODE.

AT STAIRS:
1/2" GYPSUM BOARD AT UNDERSIDE OF STAIRS AND WALLS IN CLOSET

BASEMENT JACK SCHEDULE

IDENTIFIER	DESCRIPTION	ENG. NUM.

1
A-5
BASEMENT FLOOR PLAN
SCALE: 1/4" = 1'-0"

DCY-S2-016

DIV-COMM-LOT-UNIT
COMM-LOT
STREET ADDRESS
CITY

SMYTERS MILL - SIMPLY RYAN - 016
SMYTERS MILL DRIVE
MIDDLETOWN

APT. NO.
STATE
ZIP

OH
45042

© NVR, Inc. expressly reserves the right to modify these plans without notice. These plans are not to be reproduced, changed or altered in any way without the written consent of NVR, Inc.

NVR
NVR, Inc. Suite 100
Frederick, MD 21703

5285 Washburn Lane
Frederick, MD 21703

SET NO. BRH00
VERSION 01
DRAWN BY
DATE:
OPTION

BIRCH
DRAWING TITLE
BASEMENT FLOOR PLAN

A-5
OPTION DESCRIPTION

16

C:\NVR\Solves\BIRCH_BRH00_01\DCY-S2-016\21.021.41\Sheets\Lot_Specific\16_A-5_BSM_LS.dwg 17/04/20 - 11:57 am

FIRST FLOOR JACK SCHEDULE		
IDENTIFIER	DESCRIPTION	ENG. NUM.
J100	JACK - (4) 2x4 SFF STUD GRADE	1004
J101	JACK - (2) 2x4 SFF STUD GRADE	1002
J102	JACK - (3) 2x4 SFF STUD GRADE	1015
J103	JACK - (3) 2x4 SFF STUD GRADE	1015
J104	JACK - (4) 2x4 SFF STUD GRADE	1004
J105	JACK - (2) 2x4 SFF STUD GRADE	1008
J106	JACK - (2) 2x4 SFF STUD GRADE	1008

LEGEND	
	BEARING WALL
	NON BEARING WALL
	INDICATES BEARING FROM POINT-LOAD ABOVE
	JACKS
	BEAM/HEADER
	PAD FOOTING
	STEEL COLUMN
	TRUSS TIE DOWN
	PORTAL FRAME
	JOIST/TRUSS
	LVL
	ENGINEERING PAGE NUMBER

SEE FC DETAILS FOR FRAMING CONNECTORS

ALL WINDOWS HAVE $\frac{1}{2}$ " HEADER HEIGHT UNLESS OTHERWISE NOTED

FLOOR PLAN NOTES RYAN

- ALL HEADERS ARE (2) 2x6 w/ 2x4 WALLS OR (3) 2x6 w/ 2x6 WALLS, UNLESS OTHERWISE NOTED.
- ALL HEADERS TO HAVE (1) 2x4 OR 2x6 JACK AND KING STUD EACH END, UNLESS OTHERWISE NOTED. MULTI-OPENING HEADERS TO HAVE (2) JACKS AT INTERMEDIATE BEARING, UNLESS OTHERWISE NOTED. NO ADDITIONAL FLOOR SYSTEM BLOCKING OR CONTINUOUS LOAD PATH JACKS ARE REQUIRED UNLESS OTHERWISE NOTED.
- ALL EXTERIOR WALLS TO BE 4" w/ OSB OR 3 1/2" w/ LAMINATED FIBROUS STRUCTURAL SHEATHING. ALL INTERIOR WALLS TO BE 3 1/2", UNLESS OTHERWISE NOTED.
- HATCHED AREAS INDICATE DROPPED CEILING. ALL DROPPED CEILING ARE 12" UNLESS OTHERWISE NOTED.
- SEE "BRACED WALL PANEL DETAIL SHEET" FOR SPECIAL WALL FRAMING LOCATIONS AND HEADER SIZES, IF APPLICABLE.
- SEE STANDARD DETAIL CATEGORY "IT" SHEET(S) FOR INTERIOR TRIM DETAILS.
- SEE ARCHITECTURAL DETAIL SHEET "AD" FOR HOUSE SPECIFIC INTERIOR TRIM OPTION TABLE.
- ALL HEADERS IN NON-BEARING WALLS SHALL BE A SINGLE FLAT 2x4 OR 2x6 ATTACHED TO CRIPPLES ABOVE, UNLESS OTHERWISE NOTED.
- TANKED WATER HEATER SHOWN AS BASE CONDITION, OPTIONAL TANKLESS WATER HEATER IS AVAILABLE IN LIEU OF TANKED WATER HEATER.

GYPSUM NOTES

AT GARAGE:
GYPSUM BOARD AT COMMON WALLS, CEILING, BEAM WRAPS AND SUPPORTS PER STANDARD DETAIL FA-1(b) FIRE ASSEMBLIES OR AS REQUIRED BY LOCAL CODE.

AT STAIRS:
1/2" GYPSUM BOARD AT UNDERSIDE OF STAIRS AND WALLS IN CLOSET

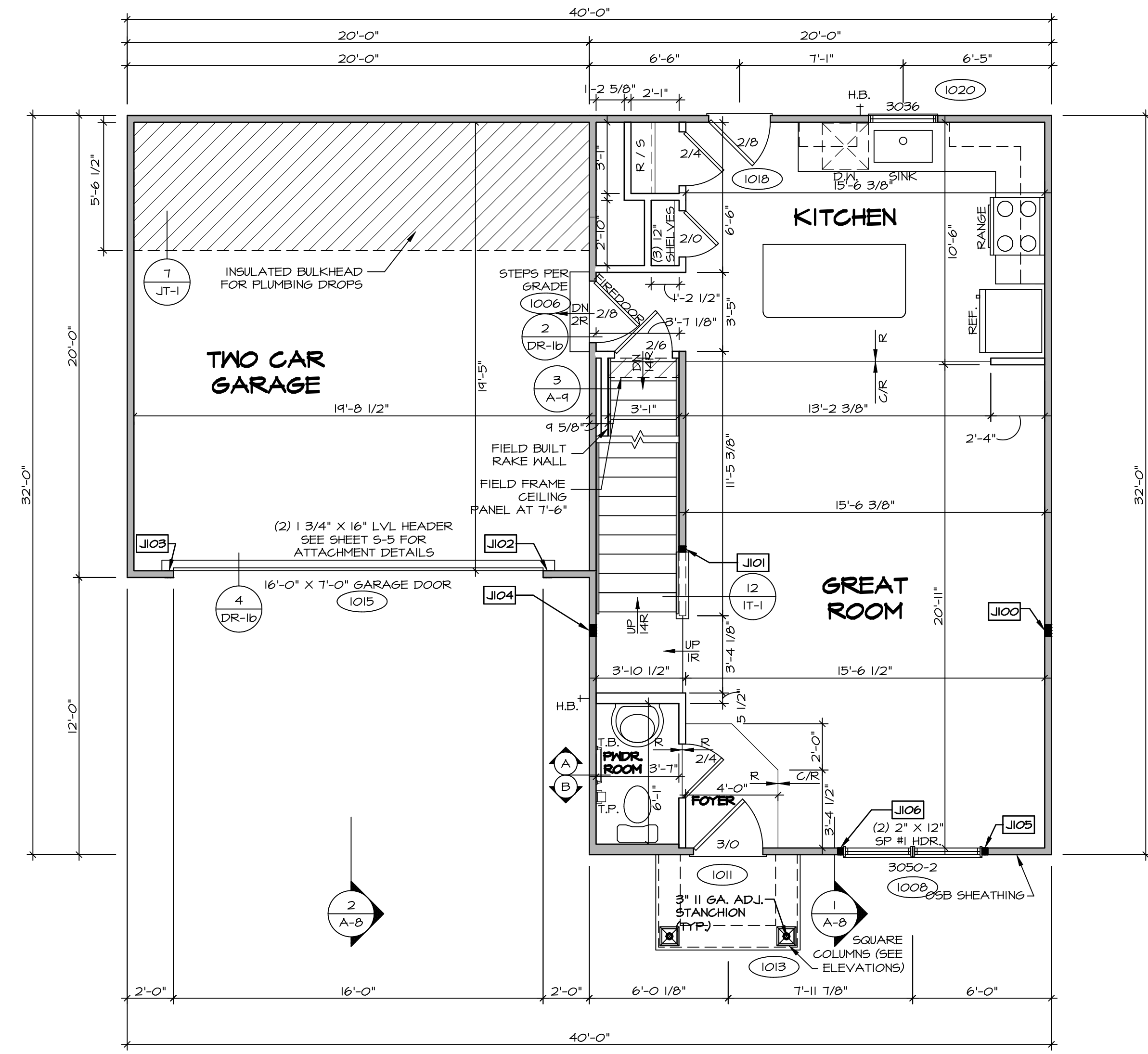

FIRST FLOOR PLAN
SCALE: 1/4" = 1'-0"

DIV.-COMM.-LOT-UNIT
DCY-S2-0161
COMM.-LOT
SANTYERS MILL - SIMPLY RYAN - 0161
STREET ADDRESS
5741 SANTYERS MILL DRIVE
CITY MIDDLETOWN STATE OH ZIP 45042

© NVR, Inc. expressly reserves the right to modify these plans without notice. These plans are not to be reproduced, changed or altered in any way without the written consent of NVR, Inc.

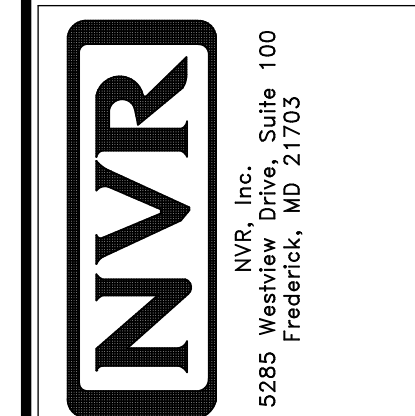

SHEET NO. A-6	MODEL BIRCH	SET NO. BRH00 VERSION 01
OPTION DESCRIPTION 17	DRAWING TITLE FIRST FLOOR PLAN	DRAWN BY
	DATE:	OPTION

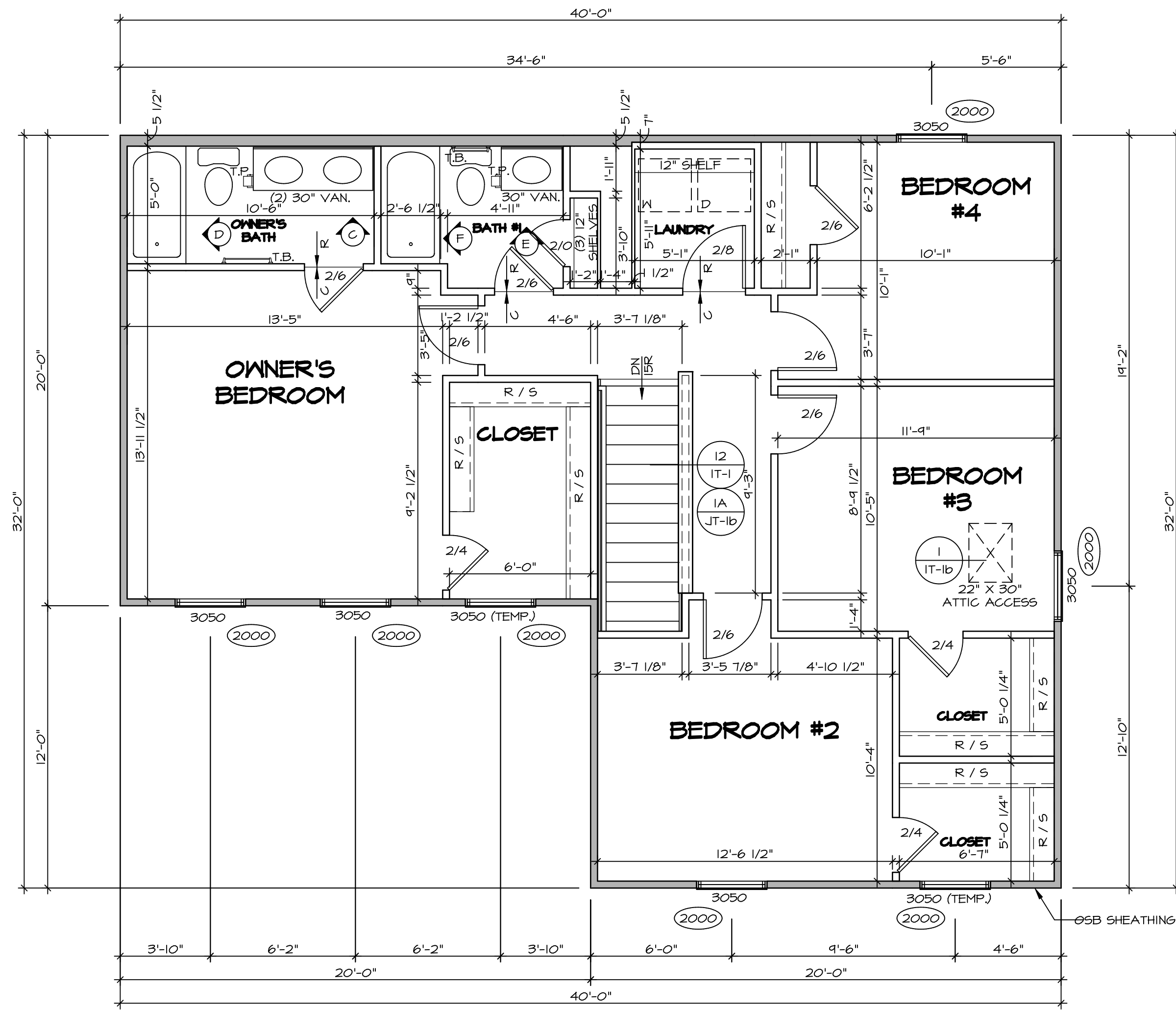

1
A-7
SECOND FLOOR PLAN
SCALE: 1/4" = 1'-0"

LEGEND

	BEARING WALL
	NON BEARING WALL
	INDICATES BEARING FROM POINT-LOAD ABOVE
	JACKS
	BEAM/HEADER
	PAD FOOTING
	STEEL COLUMN
	TRUSS TIE DOWN
	PORTAL FRAME
	JOIST/TRUSS
	LVL
	ENGINEERING PAGE NUMBER

SEE FC DETAILS FOR FRAMING CONNECTORS

ALL WINDOWS HAVE (1) 5/8" HEADER HEIGHT UNLESS OTHERWISE NOTED

FLOOR PLAN NOTES RYAN

- ALL HEADERS ARE (2) 2x6 w/ 2x4 WALLS OR (3) 2x6 w/ 2x6 WALLS, UNLESS OTHERWISE NOTED.
- ALL HEADERS TO HAVE (1) 2x4 OR 2x6 JACK AND KING STUD EACH END, UNLESS OTHERWISE NOTED. MULTI-OPENING HEADERS TO HAVE (2) JACKS AT INTERMEDIATE BEARING, UNLESS OTHERWISE NOTED. NO ADDITIONAL FLOOR SYSTEM BLOCKING OR CONTINUOUS LOAD PATH JACKS ARE REQUIRED UNLESS OTHERWISE NOTED.
- ALL EXTERIOR WALLS TO BE 4" w/ OSB OR 3 1/2" w/ LAMINATED FIBROUS STRUCTURAL SHEATHING. ALL INTERIOR WALLS TO BE 3 1/2", UNLESS OTHERWISE NOTED.
- HATCHED AREAS INDICATE DROPPED CEILING. ALL DROPPED CEILING ARE 12" UNLESS OTHERWISE NOTED.
- SEE "BRACED WALL PANEL DETAIL SHEET" FOR SPECIAL WALL FRAMING LOCATIONS AND HEADER SIZES, IF APPLICABLE.
- SEE STANDARD DETAIL CATEGORY "IT" SHEET(S) FOR INTERIOR TRIM DETAILS.
- SEE ARCHITECTURAL DETAIL SHEET "AD" FOR HOUSE SPECIFIC INTERIOR TRIM OPTION TABLE.
- ALL HEADERS IN NON-BEARING WALLS SHALL BE A SINGLE FLAT 2x4 OR 2x6 ATTACHED TO CRIPPLES ABOVE, UNLESS OTHERWISE NOTED.
- TANKED WATER HEATER SHOWN AS BASE CONDITION, OPTIONAL TANKLESS WATER HEATER IS AVAILABLE IN LIEU OF TANKED WATER HEATER.

GYPSUM NOTES

AT GARAGE:
GYPSUM BOARD AT COMMON WALLS, CEILING, BEAM WRAPS AND SUPPORTS PER STANDARD DETAIL FA-1(b) FIRE ASSEMBLIES OR AS REQUIRED BY LOCAL CODE.

AT STAIRS:
1/2" GYPSUM BOARD AT UNDERSIDE OF STAIRS AND WALLS IN CLOSET

SHEET NO. A-7	MODEL BIRCH	SET NO. BRH00	DRAWING TITLE SECOND FLOOR PLAN	OPTION DESCRIPTION	DATE: OPTION
		VERSION 01		DRAWN BY	
DIV-COMM-LOT-UNIT DCY-S2-0161		COMM-LOT SANMYERS MILL - SIMPLY RYAN - 0161	STREET ADDRESS 5741 SANMYERS MILL DRIVE		CITY MIDDLETOWN
© NVR, Inc. expressly reserves the right to modify or change these plans without notice. These plans are not to be reproduced, changed or altered in any way without the written consent of NVR, Inc.		NVR, Inc. Suite 100 5285 Washington Blvd. Frederick, MD 21703		STATE OH	ZIP 45042
C:\NVR\Solves\BIRCH_BRH00_01\DCY-S2-0161\21.02141\Sheets\18 A-7 PLAN_LS.dwg 11/04/20 11:57 am					

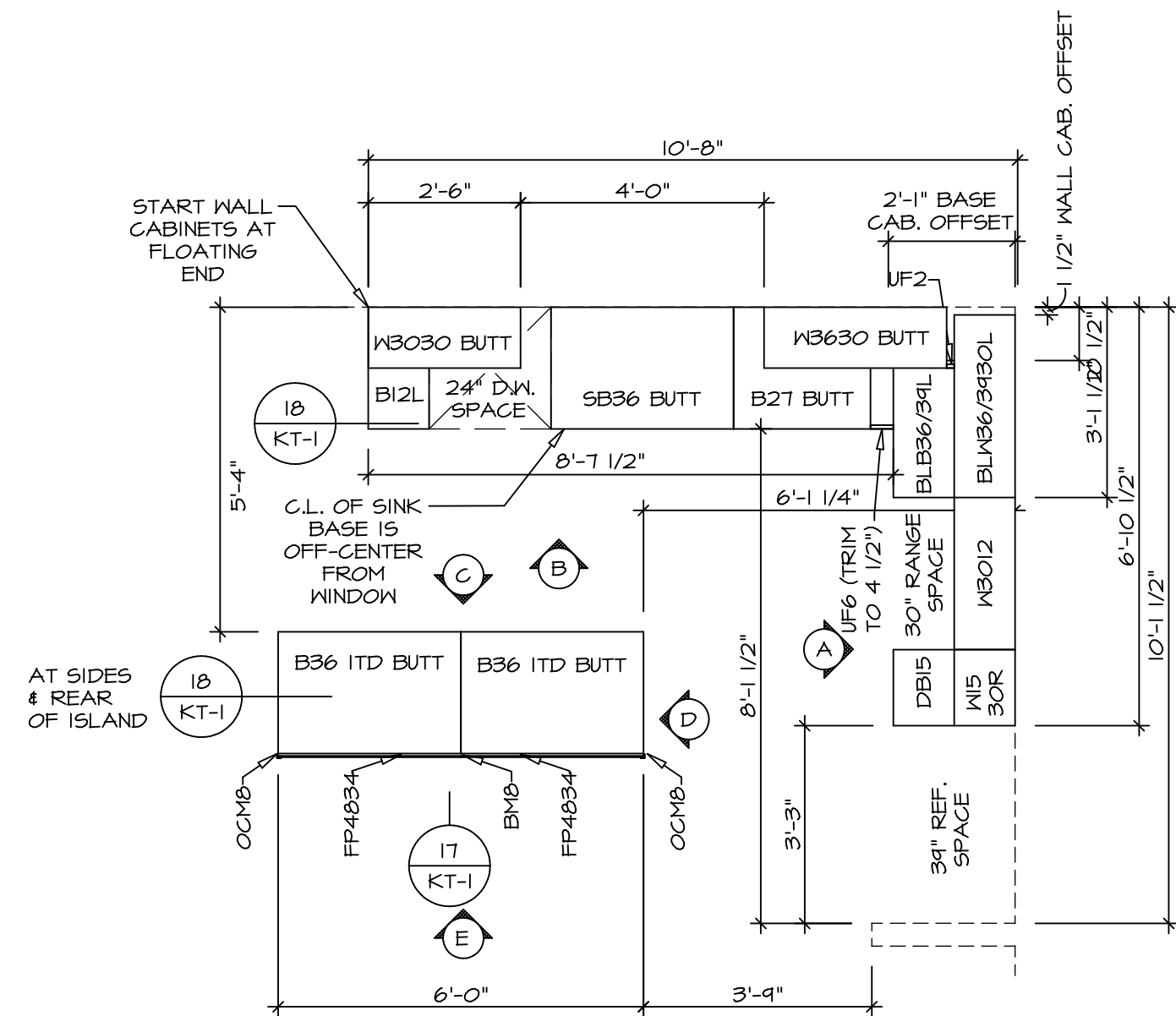

KITCHEN CABINET PLAN KC-3638
SCALE: 3/8" = 1'-0"
1 A-10

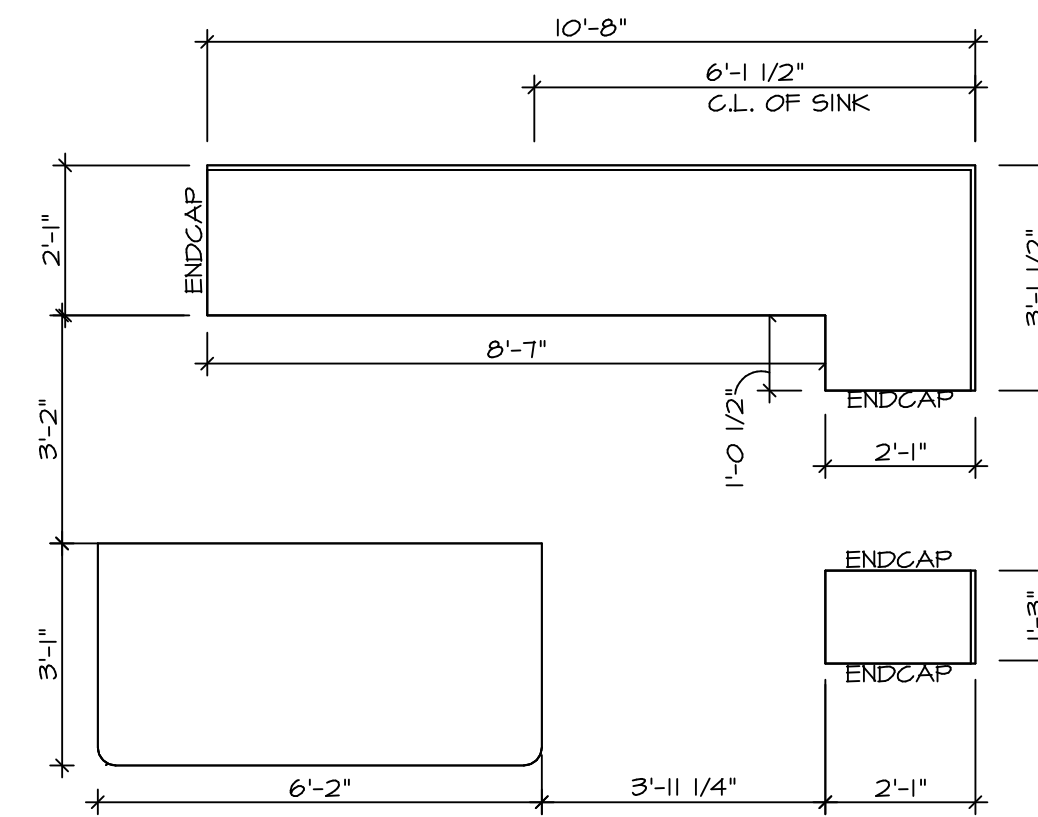

KITCHEN COUNTERTOP PLAN KT-3638
SCALE: 3/8" = 1'-0"
2 A-10

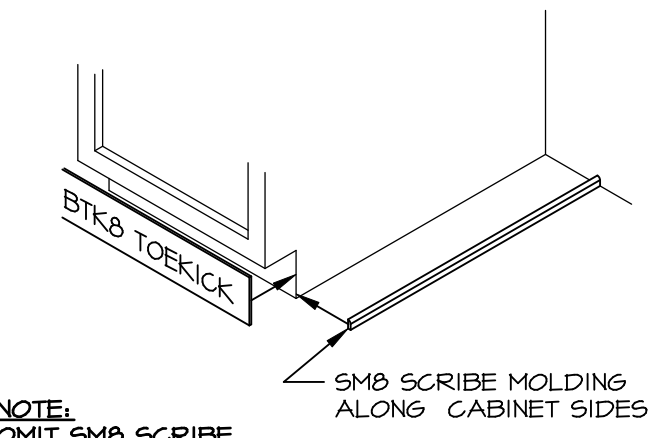

NOTE:
OMIT SMO SCRIBE MOLDING AT DISHWASHER SPACES
TOEKICK / SCRIBE DETAIL
SCALE: 3/4" = 1'-0"
5 A-10

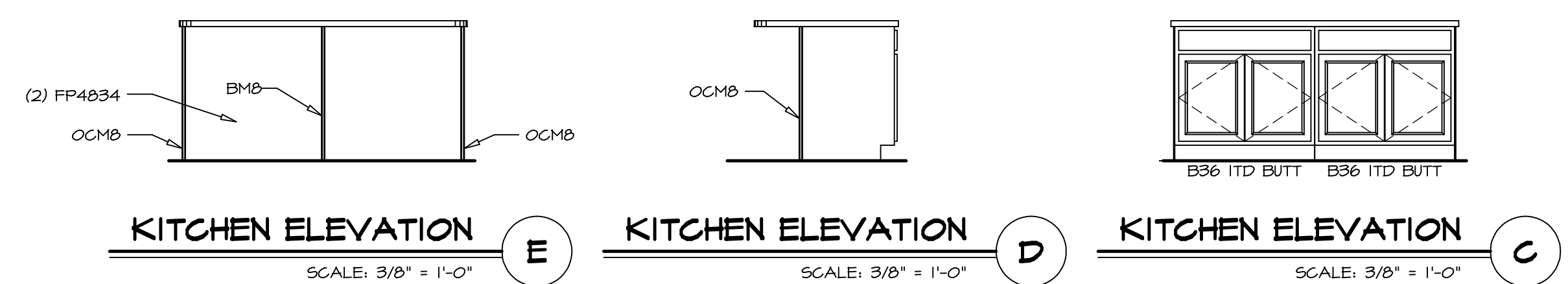

KITCHEN ELEVATION E SCALE: 3/8" = 1'-0"
KITCHEN ELEVATION D SCALE: 3/8" = 1'-0"
KITCHEN ELEVATION C SCALE: 3/8" = 1'-0"

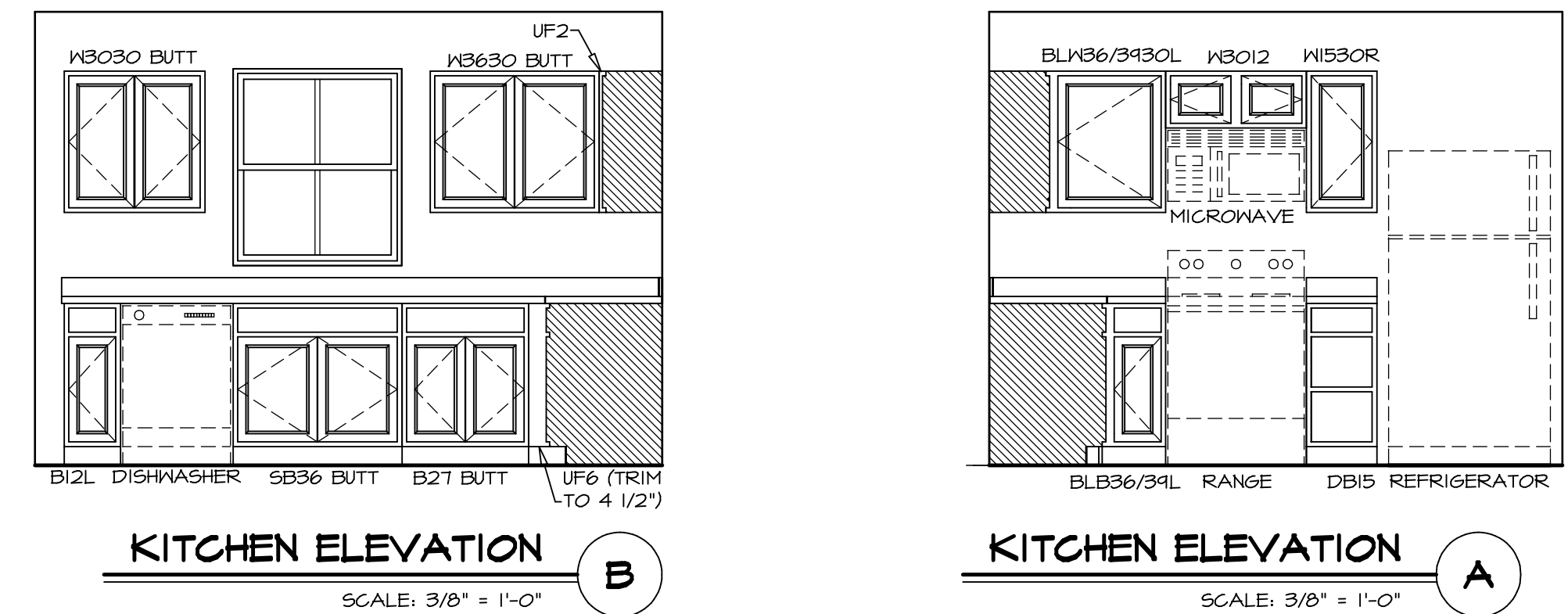

KITCHEN ELEVATION B SCALE: 3/8" = 1'-0"
KITCHEN ELEVATION A SCALE: 3/8" = 1'-0"

NOTES:
1. CABINET LAYOUT(S) ARE BASED ON FINISHED DIMENSIONS TO DRYWALL.
2. IF KITCHEN PLANS/ELEVATIONS CALL-OUT STANDARD MOULDING, REFER TO STANDARD DETAIL (NKT-1) FOR REPLACEMENT BASED ON CABINET STYLE.
3. ALL (UF#) FILLERS ARE TO BE "TRIM TO FIT".

SHEET NO. A-10	MODEL BIRCH	DRAWING TITLE KITCHEN PLANS AND ELEVATIONS	SET NO. BRH00	OPTION
			VERSION 01	
DATE:	DRAWN BY	DRAWING TITLE	DIV-COMM-LOT-UNIT DCY-S2-0161	
			DATE:	COMM-LOT SANTYERS MILL - SIMPLY RYAN - 0161
OPTION	DRAWN BY	DRAWING TITLE	STREET ADDRESS 5741 SANTYERS MILL DRIVE	
			DATE:	CITY MIDDLETOWN
OPTION	DRAWN BY	DRAWING TITLE	STATE OH	ZIP 45042
			DATE:	

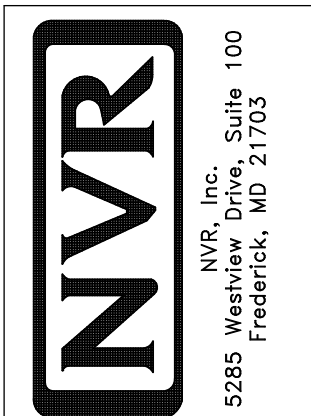

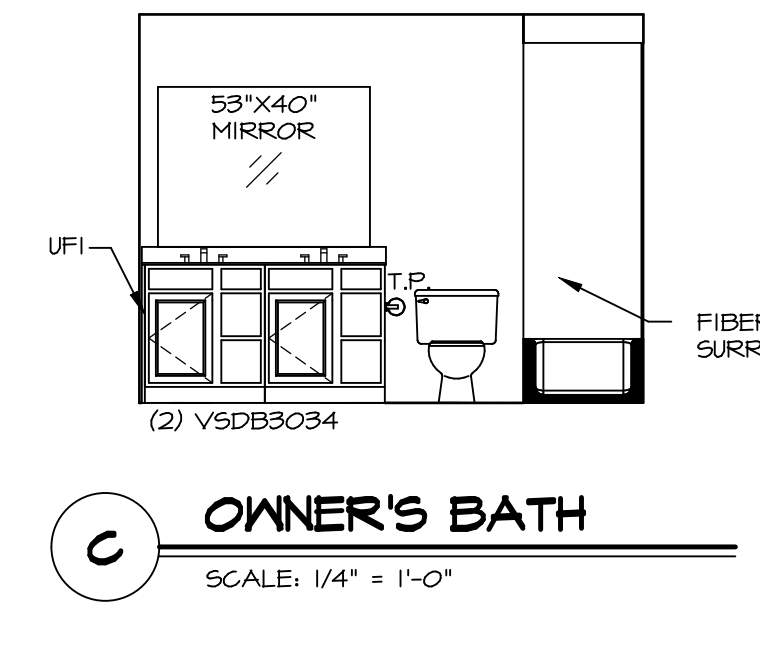
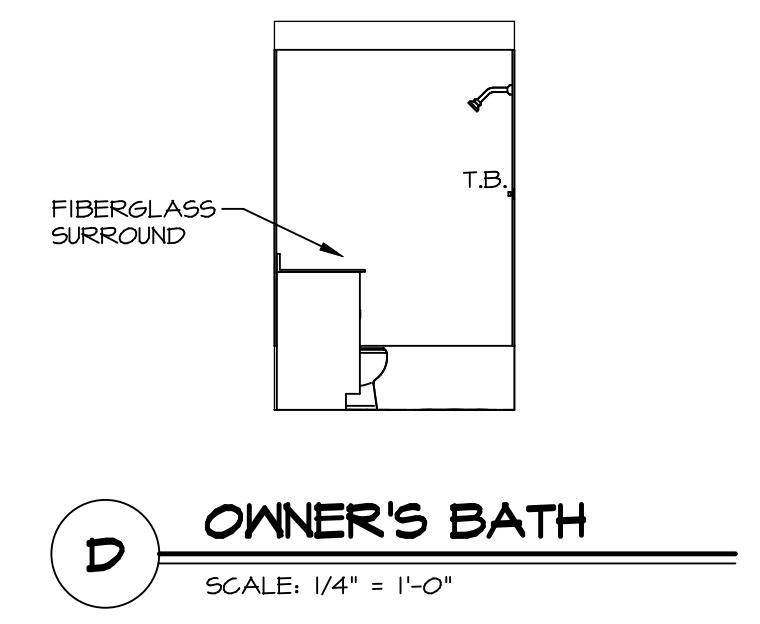
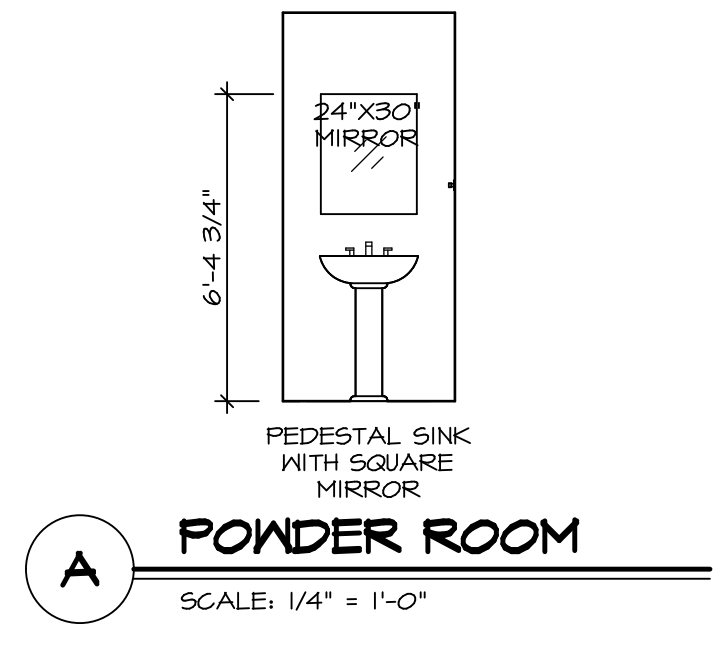
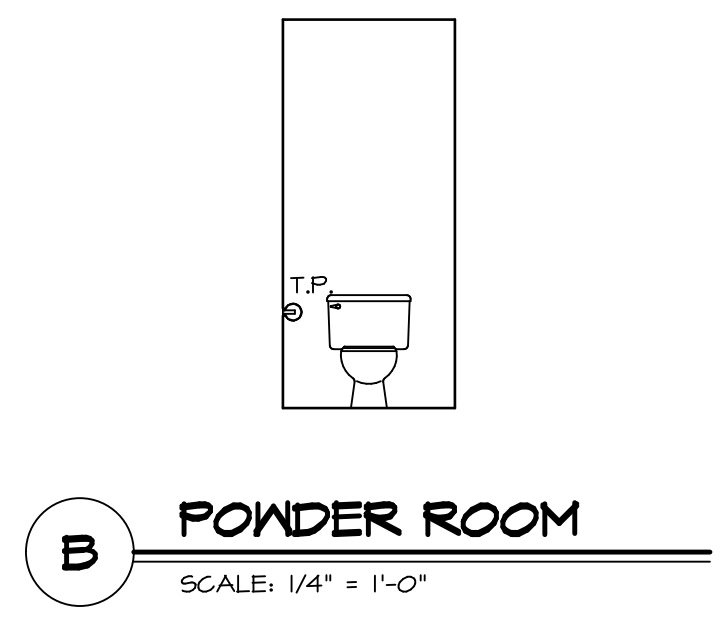

- NOTES:**
1. TEMPERED GLASS SHOWER ENCLOSURE WITH SLIDING DOOR OR OPTIONAL SLIDING DOOR BY DIVISION.
 2. TUB ACCESS PANELS PROVIDED AS NEEDED, ALL MATERIALS BY DIVISION.
 3. ALL BATH ELEVATIONS ARE SHOWN PER PLAN.
 4. ALL V5DB24-42 DRAWERS TO BE SET ON RIGHT HAND.

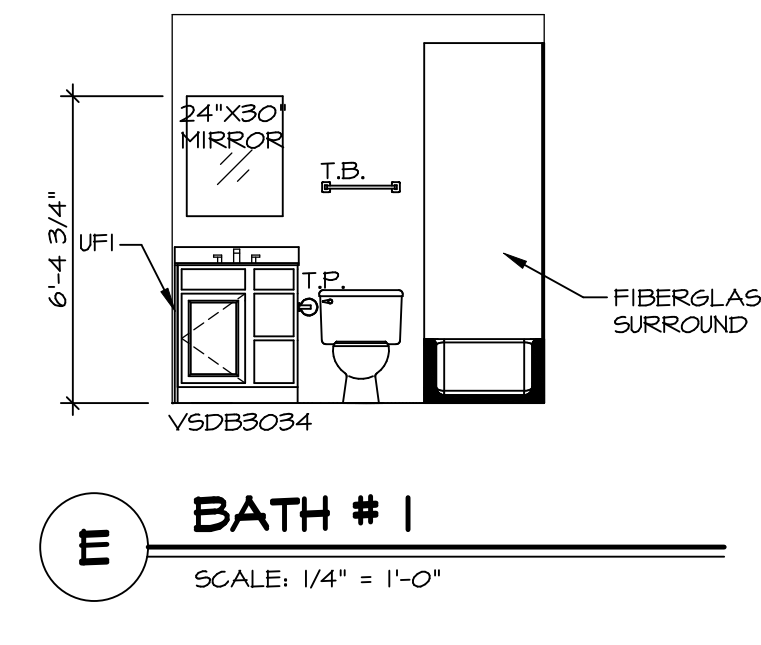
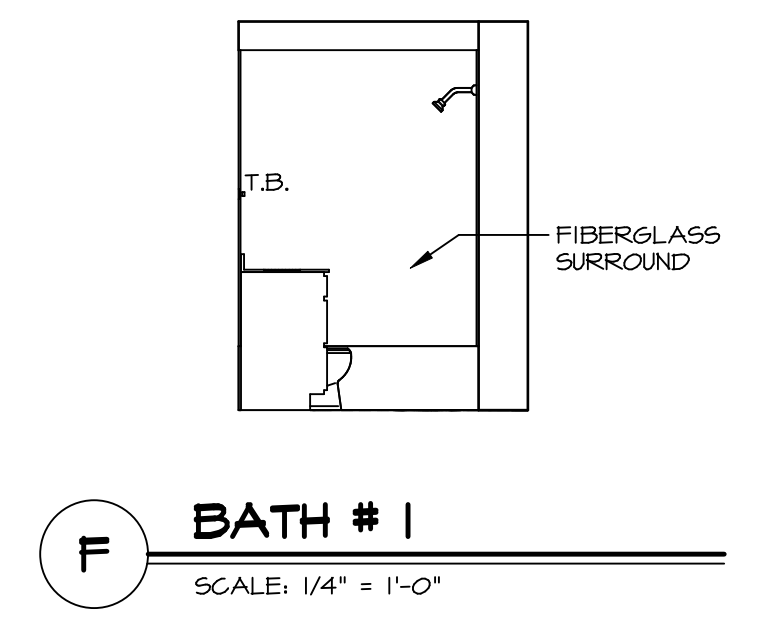

SHEET NO. A-11	MODEL BIRCH	SET NO. BRH00
22	DRAWING TITLE BATH ELEVATIONS	VERSION 01
	OPTION DESCRIPTION	DRAWN BY
		DATE:
		OPTION

NVR
NVR, Inc. Suite 100
5285 Washburne
Frederick, MD 21703

© NVR, Inc. expressly reserves the right to modify or change these plans without notice. These plans are not to be reproduced, changed or altered in any way without the written consent of NVR, Inc.

DIV-COMM-LOT-UNIT DCY-S2-0161	
COMM-LOT SANTYERS MILL - SIMPLY RYAN - 0161	APT. NO. DRIVE
STREET ADDRESS 5741 SANTYERS MILL DRIVE	CITY MIDDLETOWN
STATE OH	ZIP 45042