

S2 419
6854 RIVULET DRIVE
MIDDLETOWN, OH 45042

2 Story Basement - 3pc rough
2 hose bibs - no valves required
Vent Kitchen
ice maker
1 tub
1 shower
WATER HEATER ELECTRIC 50 GALLON
Inside Water Meter setup

Gas Furnace and range

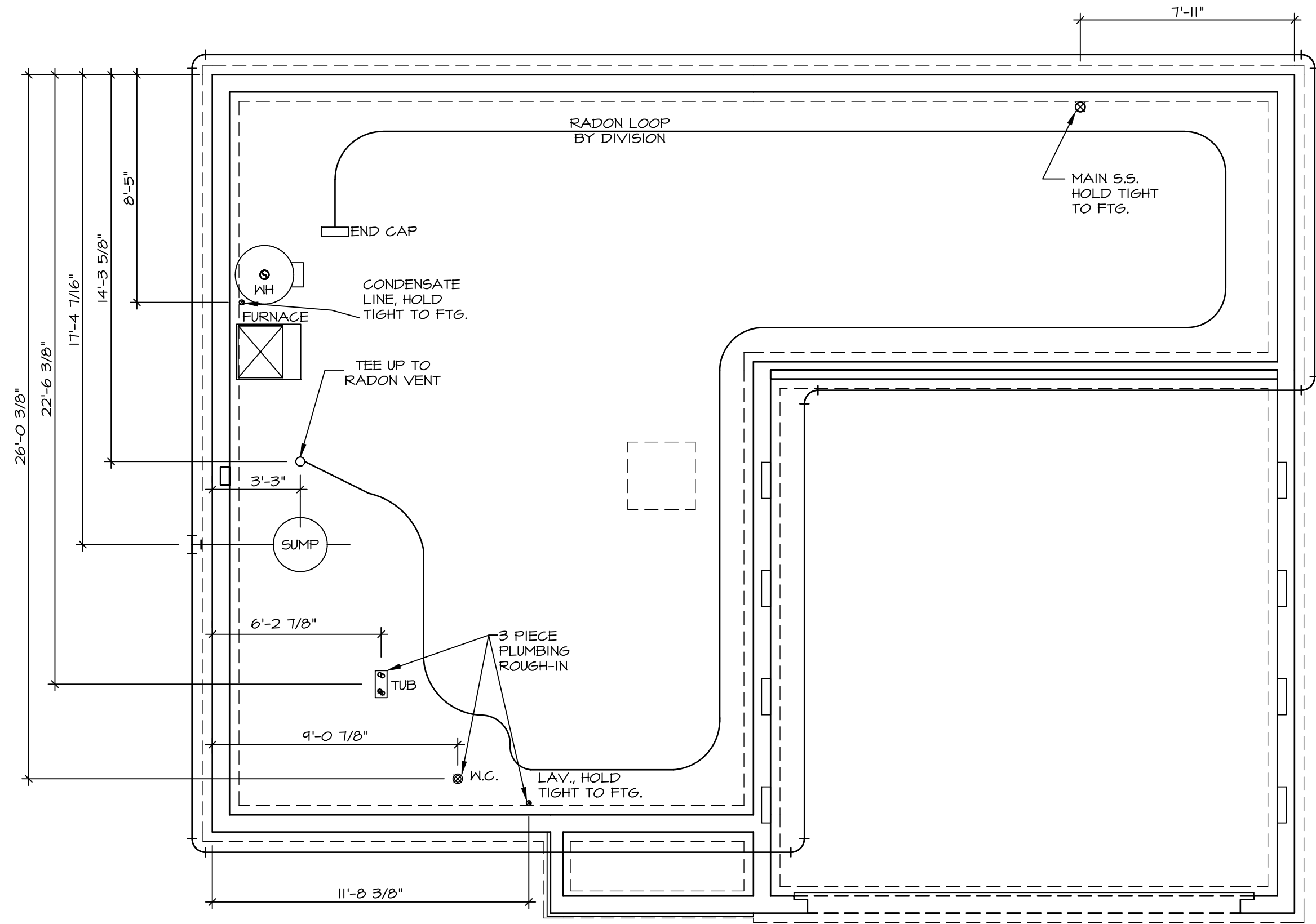

PLUMBING PLAN
SCALE: 1/4" = 1'-0"

PLUMBING NOTES:
RADON REMEDIATION
RADON LOOP:
- (4") PERFORATED HDPE "LOOP"
- MUST BE PLACED IN STONE BED SLIGHTLY HIGHER THAN ANY INTERIOR DRAINTILE
- LOOP TO BE SEPARATE FROM ANY DRAINTILE ELEMENTS
- TO BE CORRUGATED HDPE PIPE
- SCREWS TO BE INSTALLED THROUGH LOOP AT TEE UP INTO STACK
STACK REQUIREMENTS:
- 3" PVC STACK (4" IF BASEMENT IS GREATER THAN 2200 SQFT.)
- NO PART OF STACK IS TO BE HORIZONTAL (45° ELBOWS PERMITTED AS REQUIRED)
- PIPE TO BE PHYSICALLY LABELED IN THE FIELD AS "RADON VENT" OR OTHER
- JURISDICTIONALLY REQUIRED LANGUAGE (ON EVERY LEVEL OF HOUSE)
- ROOF TERMINATION TO BE IN TOP 1/3 OF ROOF
- SCREEN OR VENT GAP INSTALLED TO KEEP PESTS OUT OF RADON VENT AT ROOF TERMINATION.

SHEET NO.	MODEL	SET NO.	CDROO
A-5	CEDAR	VERSION	01
	DRAWING TITLE	RELEASE	NO. ----
	PLUMBING	DRAWN BY	
	OPTION DESCRIPTION	DATE:	
		OPTION	
10			

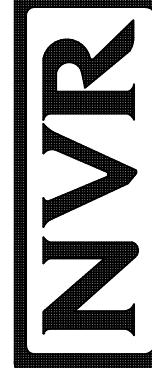

NVR

NVR, Inc., Suite 100
5285 Westview Drive
Frederick, MD 21703

© NVR, Inc., expressly reserves its copyright and other property rights in these plans. These plans are not to be reproduced, stored in a retrieval system, or transmitted in any form or manner whatsoever, nor are they to be used for any purpose other than the first obtaining the expressed written consent of NVR, Inc.

DIV-COMM-LOT-UNIT		DCY-S2-0419	
COMM-LOT		SAYTERS MILL - SIMPLY RYAN - 0419	
STREET ADDRESS		APT. NO.	
6054 RIVULET DRIVE		----	
CITY	STATE	ZIP	
MIDDLETOWN	OH	45042	

BASEMENT JACK SCHEDULE			
IDENTIFIER	DESCRIPTION	ENG. NUM.	REMARKS

LEGEND	
	BEARING WALL
	NON BEARING WALL
	MASONRY WALL
	INDICATES BEARING FROM POINT-LOAD ABOVE
	JACKS
	BEAM/HEADER
	FOOTING/THICKENED SLAB
	STEEL COLUMN
	TRUSS TIE DOWN
	PORTAL FRAME
	JOIST/TRUSS
	LVL
	ENGINEERING PAGE NUMBER
	WINDOW/DOOR TAG
	PRECAST LINTEL TAG
-SEE FA DETAILS FOR FIRE ASSEMBLIES	
-SEE FC DETAILS FOR FRAMING CONNECTORS AND MATERIAL USAGE	

FLOOR PLAN NOTES:

- ALL HEADERS ARE (2) 2x6 w/ 2x4 WALLS OR (3) 2x6 w/ 2x6 WALLS, UNLESS OTHERWISE NOTED.
- ALL HEADERS TO HAVE (1) 2x4 OR 2x6 JACK AND KING STUD EACH END, UNLESS OTHERWISE NOTED. MULTI-OPENING HEADERS TO HAVE (2) JACKS AT INTERMEDIATE BEARING, UNLESS OTHERWISE NOTED. NO ADDITIONAL FLOOR SYSTEM BLOCKING OR CONTINUOUS LOAD PATH JACKS ARE REQUIRED UNLESS OTHERWISE NOTED.
- ALL EXTERIOR WALLS TO BE 4" OR 6" AND ALL INTERIOR WALLS TO BE 3 1/2", UNLESS OTHERWISE NOTED.
- HATCHED AREAS INDICATE DROPPED CEILINGS. ALL DROPPED CEILINGS ARE 12" UNLESS OTHERWISE NOTED. SEE ARCHITECTURAL DETAIL 8/11-1B FOR 3/4" FIRE STOPPING AT BULKHEAD / CEILING PANELS.
- SEE "BRACED WALL PANEL DETAIL SHEET" FOR SPECIAL WALL FRAMING LOCATIONS AND HEADER SIZES, IF APPLICABLE.
- SEE STANDARD DETAIL CATEGORY "IT" SHEET(S) FOR INTERIOR TRIM DETAILS.
- SEE DETAIL SHEET "AD" FOR HOUSE SPECIFIC INTERIOR TRIM OPTION TABLE.
- ALL HEADERS IN NON-BEARING WALLS SHALL BE A SINGLE FLAT 2x4 OR 2x6 ATTACHED TO CRIPPLES ABOVE, UNLESS OTHERWISE NOTED.
- TANKED WATER HEATER SHOWN AS BASE CONDITION. OPTIONAL TANKLESS WATER HEATER IS AVAILABLE IN LIEU OF TANKED WATER HEATER.
- INTERIOR HEADER HEIGHT FOR 8' CEILING WILL BE 6'-11", 9' CEILING WILL BE 7'-11", 10' CEILING WILL BE 8'-3", UNLESS OTHERWISE NOTED.
- BASEMENT FINISH DIMENSIONS ASSUME A 1/2" GAP BETWEEN FRAME WALL AND CONCRETE WALL.
- ALL INTERIOR BEARING WALLS SHALL HAVE GYPSUM APPLIED TO AT LEAST ONE SIDE OR HAVE MID-HEIGHT BLOCKING INSTALLED.
- NON-BEARING WALLS OVER CONCRETE TO BE HELD 1/2" SHORT OF FRAMING ABOVE.

GYPSUM NOTES:

AT GARAGE:
GYPSUM BOARD AT COMMON WALLS, CEILINGS, BEAM WRAPS AND SUPPORTS PER STANDARD DETAIL FA-1(b) FIRE ASSEMBLIES OR AS REQUIRED BY LOCAL CODE.

AT STAIRS:
1/2" GYPSUM BOARD AT UNDERSIDE OF STAIRS AND WALLS IN CLOSET

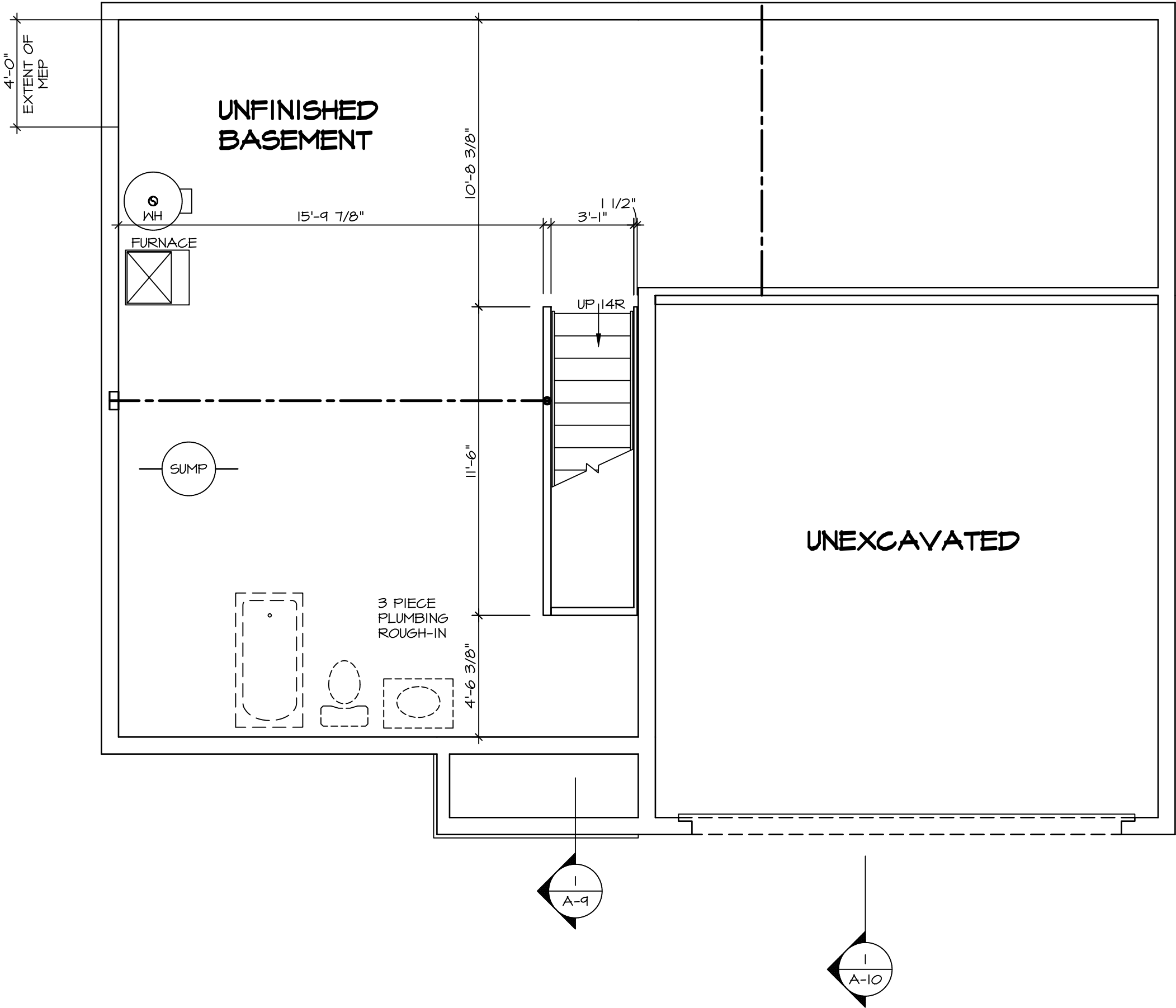

BASEMENT FLOOR PLAN
SCALE: 1/4" = 1'-0"

MODEL

CEDAR

VERSION

01

RELEASE

NO. ----

DRAWN BY

DATE:

OPTION

DESCRIPTION

SHEET NO.

A-6

OPTION

DESCRIPTION

SET NO.

CDR00

VERSION

01

RELEASE

NO. ----

DRAWN BY

DATE:

OPTION

DESCRIPTION

MODEL

CEDAR

VERSION

01

RELEASE

NO. ----

DRAWN BY

DATE:

OPTION

DESCRIPTION

SET NO.

CDR00

VERSION

01

RELEASE

NO. ----

DRAWN BY

DATE:

OPTION

DESCRIPTION

MODEL

CEDAR

VERSION

01

RELEASE

NO. ----

DRAWN BY

DATE:

OPTION

DESCRIPTION

SET NO.

CDR00

VERSION

01

RELEASE

NO. ----

DRAWN BY

DATE:

OPTION

DESCRIPTION

MODEL

CEDAR

VERSION

01

RELEASE

NO. ----

DRAWN BY

DATE:

OPTION

DESCRIPTION

SET NO.

CDR00

VERSION

01

RELEASE

NO. ----

DRAWN BY

DATE:

OPTION

DESCRIPTION

MODEL

CEDAR

VERSION

01

RELEASE

NO. ----

DRAWN BY

DATE:

OPTION

DESCRIPTION

SET NO.

CDR00

VERSION

01

RELEASE

NO. ----

DRAWN BY

DATE:

OPTION

DESCRIPTION

MODEL

CEDAR

VERSION

01

RELEASE

NO. ----

DRAWN BY

DATE:

OPTION

DESCRIPTION

SET NO.

CDR00

VERSION

01

RELEASE

NO. ----

DRAWN BY

DATE:

OPTION

DESCRIPTION

MODEL

CEDAR

VERSION

01

RELEASE

NO. ----

DRAWN BY

DATE:

OPTION

DESCRIPTION

SET NO.

CDR00

VERSION

01

RELEASE

NO. ----

DRAWN BY

DATE:

OPTION

DESCRIPTION

MODEL

CEDAR

VERSION

01

RELEASE

NO. ----

DRAWN BY

DATE:

OPTION

DESCRIPTION

SET NO.

CDR00

VERSION

01

RELEASE

NO. ----

DRAWN BY

DATE:

OPTION

DESCRIPTION

MODEL

CEDAR

VERSION

01

RELEASE

NO. ----

DRAWN BY

DATE:

OPTION

DESCRIPTION

SET NO.

CDR00

VERSION

01

RELEASE

NO. ----

DRAWN BY

DATE:

OPTION

DESCRIPTION

MODEL

CEDAR

VERSION

01

RELEASE

NO. ----

DRAWN BY

DATE:

OPTION

DESCRIPTION

SET NO.

CDR00

VERSION

01

RELEASE

NO. ----

DRAWN BY

DATE:

OPTION

DESCRIPTION

MODEL

CEDAR

VERSION

01

RELEASE

NO. ----

DRAWN BY

DATE:

OPTION

DESCRIPTION

SET NO.

CDR00

VERSION

01

RELEASE

NO. ----

DRAWN BY

DATE:

OPTION

DESCRIPTION

MODEL

CEDAR

VERSION

01

RELEASE

NO. ----

DRAWN BY

DATE:

OPTION

DESCRIPTION

SET NO.

CDR00

VERSION

01

RELEASE

NO. ----

DRAWN BY

DATE:

OPTION

DESCRIPTION

MODEL

CEDAR

VERSION

01

RELEASE

NO. ----

DRAWN BY

DATE:

OPTION

DESCRIPTION

SET NO.

CDR00

VERSION

01

RELEASE

NO. ----

DRAWN BY

DATE:

OPTION

DESCRIPTION

MODEL

CEDAR

VERSION

01

RELEASE

NO. ----

DRAWN BY

DATE:

OPTION

DESCRIPTION

SET NO.

CDR00

VERSION

01

RELEASE

NO. ----

DRAWN BY

DATE:

OPTION

DESCRIPTION

MODEL

CEDAR

VERSION

01

RELEASE

NO. ----

DRAWN BY

DATE:

OPTION

DESCRIPTION

SET NO.

CDR00

VERSION

01

RELEASE

NO. ----

DRAWN BY

DATE:

OPTION

DESCRIPTION

MODEL

CEDAR

VERSION

01

RELEASE

NO. ----

DRAWN BY

DATE:

OPTION

DESCRIPTION

SET NO.

CDR00

VERSION

01

RELEASE

NO. ----

DRAWN BY

DATE:

OPTION

DESCRIPTION

MODEL

CEDAR

VERSION

01

RELEASE

NO. ----

DRAWN BY

DATE:

OPTION

DESCRIPTION

SET NO.

CDR00

VERSION

01

RELEASE

NO. ----

DRAWN BY

DATE:

OPTION

DESCRIPTION

MODEL

CEDAR

VERSION

01

RELEASE

NO. ----

DRAWN BY

DATE:

OPTION

DESCRIPTION

SET NO.

CDR00

VERSION

01

RELEASE

NO. ----

DRAWN BY

DATE:

OPTION

DESCRIPTION

MODEL

CEDAR

VERSION

01

RELEASE

NO. ----

DRAWN BY

DATE:

OPTION

DESCRIPTION

SET NO.

CDR00

VERSION

01

RELEASE

NO. ----

DRAWN BY

DATE:

OPTION

DESCRIPTION

MODEL

CEDAR

VERSION

01

RELEASE

NO. ----

DRAWN BY

DATE:

OPTION

DESCRIPTION

SET NO.

CDR00

VERSION

01

RELEASE

NO. ----

DRAWN BY

DATE:

OPTION

DESCRIPTION

MODEL

CEDAR

VERSION

01

RELEASE

NO. ----

DRAWN BY

DATE:

OPTION

DESCRIPTION

SET NO.

CDR00

VERSION

01

RELEASE

NO. ----

DRAWN BY

DATE:

OPTION

DESCRIPTION

MODEL

CEDAR

VERSION

01

RELEASE

NO. ----

DRAWN BY

DATE:

OPTION

DESCRIPTION

SET NO.

CDR00

VERSION

01

RELEASE

NO. ----

DRAWN BY

DATE:

OPTION

DESCRIPTION

MODEL

CEDAR

VERSION

01

RELEASE

NO. ----

DRAWN BY

DATE:

OPTION

DESCRIPTION

SET NO.

CDR00

VERSION

01

RELEASE

NO. ----

DRAWN BY

DATE:

OPTION

DESCRIPTION

MODEL

CEDAR

VERSION

01

RELEASE

NO. ----

DRAWN BY

DATE:

OPTION

DESCRIPTION

SET NO.

CDR00

VERSION

01

RELEASE

NO. ----

DRAWN BY

DATE:

OPTION

DESCRIPTION

MODEL

CEDAR

VERSION

01

RELEASE

NO. ----

DRAWN BY

DATE:

OPTION

DESCRIPTION

SET NO.

CDR00

VERSION

01

RELEASE

NO. ----

DRAWN BY

DATE:

OPTION

DESCRIPTION

MODEL

CEDAR

VERSION

01

RELEASE

NO. ----

DRAWN BY

DATE:

OPTION

DESCRIPTION

SET NO.

CDR00

VERSION

01

RELEASE

NO. ----

DRAWN BY

DATE:

OPTION

DESCRIPTION

MODEL

CEDAR

VERSION

01

RELEASE

NO. ----

DRAWN BY

DATE:

OPTION

DESCRIPTION

SET NO.

CDR00

VERSION

01

RELEASE

NO. ----

DRAWN BY

DATE:

OPTION

DESCRIPTION

MODEL

CEDAR

VERSION

01

RELEASE

NO. ----

DRAWN BY

DATE:

OPTION

DESCRIPTION

SET NO.

CDR00

VERSION

01

RELEASE

NO. ----

DRAWN BY

DATE:

OPTION

DESCRIPTION

MODEL

CEDAR

VERSION

01

RELEASE

NO. ----

DRAWN BY

DATE:

OPTION

DESCRIPTION

SET NO.

CDR00

VERSION

01

RELEASE

NO. ----

DRAWN BY

DATE:

OPTION

DESCRIPTION

MODEL

CEDAR

VERSION

01

RELEASE

NO. ----

DRAWN BY

DATE:

OPTION

DESCRIPTION

SET NO.

CDR00

VERSION

01

RELEASE

NO. ----

DRAWN BY

DATE:

OPTION

DESCRIPTION

MODEL

CEDAR

VERSION

01

RELEASE

NO. ----

DRAWN BY

DATE:

OPTION

DESCRIPTION

SET NO.

CDR00

VERSION

01

RELEASE

NO. ----

DRAWN BY

DATE:

OPTION

DESCRIPTION

MODEL

CEDAR

VERSION

01

RELEASE

NO. ----

DRAWN BY

DATE:

OPTION

DESCRIPTION

SET NO.

CDR00

VERSION

01

RELEASE

NO. ----

DRAWN BY

DATE:

OPTION

DESCRIPTION

MODEL

CEDAR

VERSION

01

RELEASE

NO. ----

DRAWN BY

DATE:

OPTION

DESCRIPTION

SET NO.

CDR00

VERSION

01

RELEASE

NO. ----

DRAWN BY

DATE:

OPTION

DESCRIPTION

MODEL

CEDAR

VERSION

01

RELEASE

NO. ----

DRAWN BY

DATE:

OPTION

DESCRIPTION

SET NO.

CDR00

VERSION

01

RELEASE

NO. ----

DRAWN BY

DATE:

OPTION

DESCRIPTION

MODEL

CEDAR

VERSION

01

RELEASE

NO. ----

DRAWN BY

DATE:

OPTION

DESCRIPTION

SET NO.

CDR00

VERSION

01

RELEASE

NO. ----

DRAWN BY

DATE:

OPTION

DESCRIPTION

MODEL

CEDAR

VERSION

01

RELEASE

NO. ----

DRAWN BY

DATE:

OPTION

DESCRIPTION

SET NO.

CDR00

VERSION

01

RELEASE

NO. ----

DRAWN BY

DATE:

OPTION

DESCRIPTION

MODEL

CEDAR

VERSION

01

RELEASE

NO. ----

DRAWN BY

DATE:

OPTION

DESCRIPTION

SET NO.

CDR00

VERSION

01

RELEASE

NO. ----

DRAWN BY

DATE:

OPTION

DESCRIPTION

MODEL

CEDAR

VERSION

01

RELEASE

NO. ----

DRAWN BY

DATE:

OPTION

DESCRIPTION

SET NO.

CDR00

VERSION

01

RELEASE

NO. ----

DRAWN BY

DATE:

OPTION

DESCRIPTION

MODEL

CEDAR

VERSION

01

RELEASE

NO. ----

DRAWN BY

DATE:

OPTION

DESCRIPTION

SET NO.

CDR00

VERSION

01

RELEASE

NO. ----

DRAWN BY

DATE:

OPTION

DESCRIPTION

MODEL

CEDAR

VERSION

01

RELEASE

NO. ----

DRAWN BY

DATE:

OPTION

DESCRIPTION

SET NO.

CDR00

VERSION

01

RELEASE

NO. ----

DRAWN BY

DATE:

OPTION

DESCRIPTION

MODEL

CEDAR

VERSION

01

RELEASE

NO. ----

DRAWN BY

DATE:

OPTION

DESCRIPTION

SET NO.

CDR00

VERSION

01

RELEASE

NO. ----

DRAWN BY

DATE:

OPTION

DESCRIPTION

MODEL

CEDAR

VERSION

01

RELEASE

NO. ----

DRAWN BY

DATE:

OPTION

DESCRIPTION

SET NO.

CDR00

VERSION

01

RELEASE

NO. ----

DRAWN BY

DATE:

OPTION

DESCRIPTION

MODEL

CEDAR

VERSION

01

RELEASE

NO. ----

DRAWN BY

DATE:

OPTION

DESCRIPTION

SET NO.

CDR00

VERSION

01

RELEASE

NO. ----

DRAWN BY

DATE:

OPTION

DESCRIPTION

MODEL

CEDAR

VERSION

01

RELEASE

NO. ----

DRAWN BY

DATE:

OPTION

DESCRIPTION

SET NO.

CDR00

VERSION

01

RELEASE

NO. ----

DRAWN BY

DATE:

OPTION

DESCRIPTION

MODEL

CEDAR

VERSION

01

RELEASE

NO. ----

DRAWN BY

DATE:

OPTION

DESCRIPTION

SET NO.

CDR00

VERSION

01

RELEASE

NO. ----

DRAWN BY

DATE:

OPTION

DESCRIPTION

MODEL

CEDAR

VERSION

01

RELEASE

NO. ----

DRAWN BY

DATE:

OPTION

DESCRIPTION

SET NO.

CDR00

VERSION

01

RELEASE

NO. ----

DRAWN BY

DATE:

OPTION

DESCRIPTION

MODEL

CEDAR

VERSION

01

RELEASE

NO. ----

DRAWN BY

DATE:

OPTION

DESCRIPTION

SET NO.

CDR00

VERSION

01

RELEASE

NO. ----

DRAWN BY

DATE:

OPTION

DESCRIPTION

MODEL

CEDAR

VERSION

01

RELEASE

NO. ----

DRAWN BY

DATE:

OPTION

DESCRIPTION

SET NO.

CDR00

VERSION

01

RELEASE

NO. ----

DRAWN BY

DATE:

OPTION

DESCRIPTION

MODEL

CEDAR

VERSION

01

RELEASE

NO. ----

DRAWN BY

DATE:

OPTION

DESCRIPTION

SET NO.

CDR00

VERSION

01

RELEASE

NO. ----

DRAWN BY

DATE:

OPTION

DESCRIPTION

MODEL

CEDAR

VERSION

01

RELEASE

NO. ----

DRAWN BY

DATE:

OPTION

DESCRIPTION

SET NO.

CDR00

VERSION

01

RELEASE

NO. ----

DRAWN BY

DATE:

OPTION

DESCRIPTION

MODEL

CEDAR

VERSION

01

RELEASE

NO. ----

DRAWN BY

DATE:

OPTION

DESCRIPTION

SET NO.

CDR00

VERSION

01

RELEASE

NO. ----

DRAWN BY

DATE:

OPTION

DESCRIPTION

MODEL

CEDAR

VERSION

01

RELEASE

NO. ----

DRAWN BY

DATE:

OPTION

DESCRIPTION

SET NO.

CDR00

VERSION

01

RELEASE

NO. ----

DRAWN BY

DATE:

OPTION

DESCRIPTION

MODEL

CEDAR

VERSION

01

RELEASE

NO. ----

DRAWN BY

DATE:

OPTION

DESCRIPTION

SET NO.

CDR00

VERSION

01

RELEASE

NO. ----

DRAWN BY

DATE:

OPTION

DESCRIPTION

MODEL

CEDAR

VERSION

01

RELEASE

NO. ----

DRAWN BY

DATE:

OPTION

DESCRIPTION

SET NO.

CDR00

VERSION

01

RELEASE

NO. ----

DRAWN BY

DATE:

OPTION

DESCRIPTION

MODEL

CEDAR

VERSION

01

RELEASE

NO. ----

DRAWN BY

DATE:

OPTION

DESCRIPTION

SET NO.

CDR00

VERSION

01

RELEASE

NO. ----

DRAWN BY

DATE:

OPTION

DESCRIPTION

MODEL

CEDAR

VERSION

01

RELEASE

NO. ----

DRAWN BY

DATE:

OPTION

DESCRIPTION

SET NO.

CDR00

VERSION

01

RELEASE

NO. ----

DRAWN BY

DATE:

OPTION

DESCRIPTION

MODEL

CEDAR

VERSION

01

RELEASE

NO. ----

DRAWN BY

DATE:

OPTION

DESCRIPTION

SET NO.

CDR00

VERSION

01

RELEASE

NO. ----

DRAWN BY

DATE:

OPTION

DESCRIPTION

MODEL

CEDAR

VERSION

01

RELEASE

NO. ----

DRAWN BY

DATE:

OPTION

DESCRIPTION

SET NO.

CDR00

VERSION

01

RELEASE

NO. ----

DRAWN BY

DATE:

OPTION

DESCRIPTION

MODEL

CEDAR

VERSION

01

RELEASE

NO. ----

DRAWN BY

DATE:

OPTION

DESCRIPTION

SET NO.

CDR00

VERSION

01

RELEASE

NO. ----

DRAWN BY

DATE:

OPTION

DESCRIPTION

MODEL

CEDAR

VERSION

01

RELEASE

NO. ----

DRAWN BY

DATE:

OPTION

DESCRIPTION

SET NO.

CDR00

VERSION

01

RELEASE

NO. ----

DRAWN BY

DATE:

OPTION

DESCRIPTION

MODEL

CEDAR

FIRST FLOOR JACK SCHEDULE			
IDENTIFIER	DESCRIPTION	ENG. NUM.	REMARKS
J101	JACK - (3) 2X4 SFF STUD GRADE	1019	
J102	JACK - (2) 2X4 SFF STUD GRADE	1014	
J103	JACK - (2) 2X4 SFF STUD GRADE	1014	
J104	JACK - (2) 2X4 SFF STUD GRADE	1014	
J105	JACK - (2) 2X4 SFF STUD GRADE	1012	
J106	JACK - (4) 2X4 SFF STUD GRADE	1025	
J107	JACK - (4) 2X4 SFF STUD GRADE	1025	
J108	JACK - (2) 2X4 SFF STUD GRADE	1008	
J109	JACK - (2) 2X4 SFF STUD GRADE	1008	
J110	JACK - (2) 2X4 SFF STUD GRADE	1010	
J111	JACK - (2) 2X4 SFF STUD GRADE	1010	
J112	JACK - (4) 2X4 SFF STUD GRADE	1006	
J113	JACK - (4) 2X4 SFF STUD GRADE	1006	
J114	JACK - (4) 2X4 SFF STUD GRADE	1006	
J115	JACK - (4) 2X4 SFF STUD GRADE	1006	

LEGEND	
	BEARING WALL
	NON BEARING WALL
	MASONRY WALL
	INDICATES BEARING FROM POINT-LOAD ABOVE
	JACKS
	BEAM/HEADER
	FOOTING/THICKENED SLAB
	STEEL COLUMN
	TRUSS TIE DOWN
	PORTAL FRAME
	JOIST/TRUSS
	LVL
	ENGINEERING PAGE TAG
	WINDOW/DOOR TAG
	PRECAST LINTEL TAG
-SEE FA DETAILS FOR FIRE ASSEMBLIES	
-SEE FC DETAILS FOR FRAMING CONNECTORS AND MATERIAL USAGE	

FLOOR PLAN NOTES:

- ALL HEADERS ARE (2) 2x6 w/ 2x4 WALLS OR (3) 2x6 w/ 2x6 WALLS, UNLESS OTHERWISE NOTED.
- ALL HEADERS TO HAVE (1) 2x4 OR 2x6 JACK AND KING STUD EACH END UNLESS OTHERWISE NOTED. MULTI-OPENING HEADERS TO HAVE (2) JACKS AT INTERMEDIATE BEARING, UNLESS OTHERWISE NOTED. NO ADDITIONAL FLOOR SYSTEM BLOCKING OR CONTINUOUS LOAD PATH JACKS ARE REQUIRED UNLESS OTHERWISE NOTED.
- ALL EXTERIOR WALLS TO BE 4" OR 6" AND ALL INTERIOR WALLS TO BE 3 1/2" UNLESS OTHERWISE NOTED.
- HATCHED AREAS INDICATE DROPPED CEILINGS. ALL DROPPED CEILINGS ARE 12" UNLESS OTHERWISE NOTED. SEE ARCHITECTURAL DETAIL 8/IT-1B FOR 3/4" FIRE STOPPING AT BULKHEAD / CEILING PANELS.
- SEE "BRACED WALL PANEL DETAIL SHEET" FOR SPECIAL WALL FRAMING LOCATIONS AND HEADER SIZES, IF APPLICABLE.
- SEE STANDARD DETAIL CATEGORY "IT" SHEET(S) FOR INTERIOR TRIM DETAILS.
- SEE DETAIL SHEET "AD" FOR HOUSE SPECIFIC INTERIOR TRIM OPTION TABLE.
- ALL HEADERS IN NON-BEARING WALLS SHALL BE A SINGLE FLAT 2X4 OR 2X6 ATTACHED TO CRIPPLES ABOVE, UNLESS OTHERWISE NOTED.
- TANKED WATER HEATER SHOWN AS BASE CONDITION, OPTIONAL TANKLESS WATER HEATER IS AVAILABLE IN LIEU OF TANKED WATER HEATER.
- INTERIOR HEADER HEIGHT FOR 8' CEILING WILL BE 6'-11", 4' CEILING WILL BE 7'-11", 10' CEILING WILL BE 8'-3", UNLESS OTHERWISE NOTED.
- BASEMENT FINISH DIMENSIONS ASSUME A 1/2" GAP BETWEEN FRAME WALL AND CONCRETE WALL.
- ALL INTERIOR BEARING WALLS SHALL HAVE GYPSUM APPLIED TO AT LEAST ONE SIDE OR HAVE MID-HEIGHT BLOCKING INSTALLED.
- NON-BEARING WALLS OVER CONCRETE TO BE HELD 1/2" SHORT OF FRAMING ABOVE.

GYPSUM NOTES:

AT GARAGE:

GYPSUM BOARD AT COMMON WALLS, CEILINGS, BEAM WRAPS AND SUPPORTS PER STANDARD DETAIL FA-1(b) FIRE ASSEMBLIES OR AS REQUIRED BY LOCAL CODE.

AT STAIRS:

1/2" GYPSUM BOARD AT UNDERSIDE OF STAIRS AND WALLS IN CLOSET

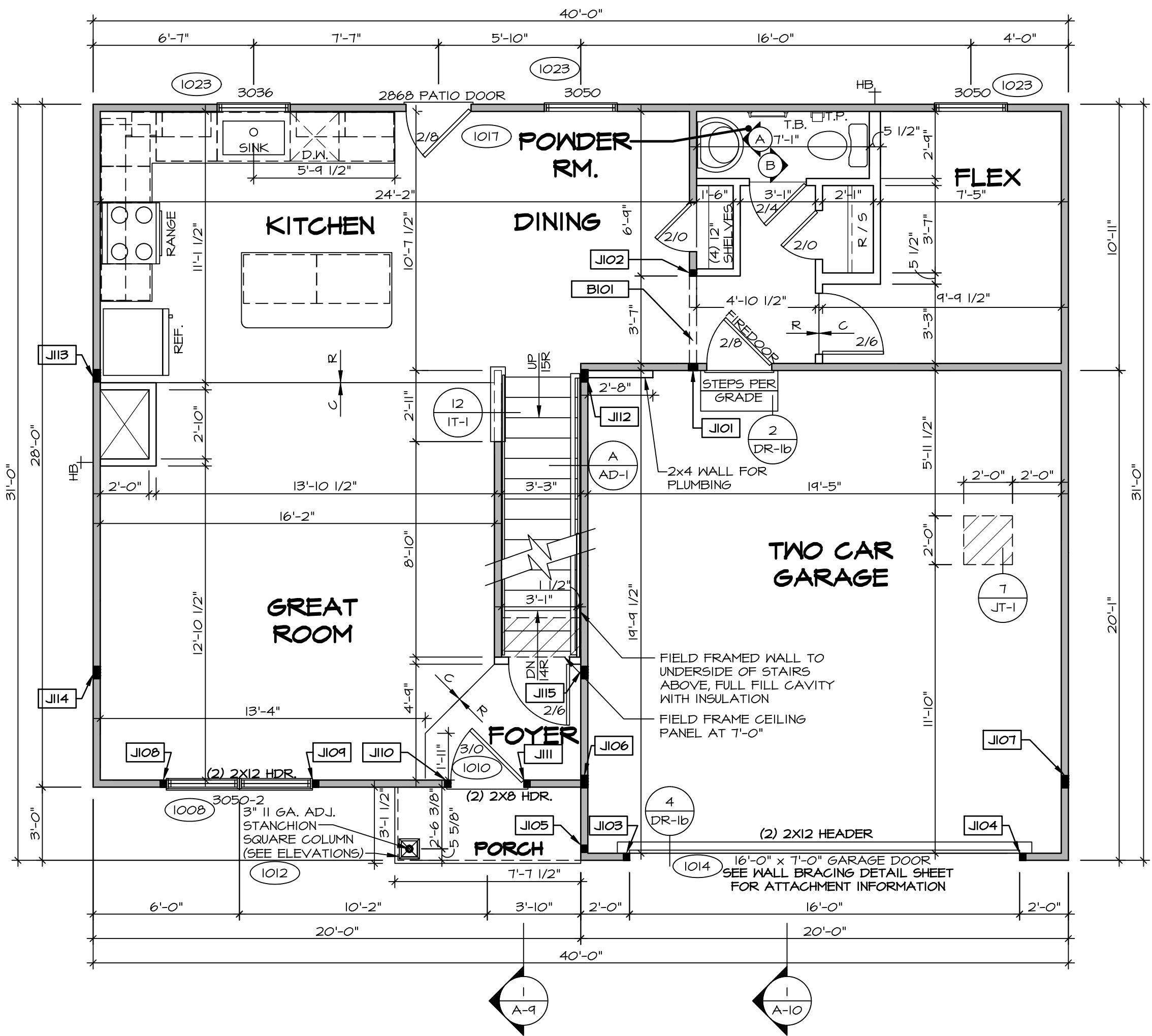

FIRST FLOOR PLAN
SCALE: 1/4" = 1'-0"

DCY-S2-0419

SAINTERS MILL - SIMPLY RYAN - 0419

STREET ADDRESS

6884 RIVULET DRIVE

CITY

MIDDLETOWN

STATE

OH

ZIP

45042

© NVR, Inc. expressly reserves its copyright and other property rights in these plans. These plans are not to be reproduced, stored in a retrieval system, or transmitted in any form or by any means, electronic, mechanical, photocopying, recording, or otherwise, without the prior written consent of NVR, Inc.

NVR, Inc. Suite 100
5285 Westwick Drive
Frederick, MD 21703

SET NO. CD000
VERSION 01
RELEASE NO. ----
DRAWN BY
DATE:
OPTION

MODEL
CEDAR
DRAWING TITLE
FIRST FLOOR PLAN

SHEET NO.
A-7

OPTION DESCRIPTION

12



- # FLOOR PLAN NOTES:
1. ALL HEADERS ARE (2) 2x6 N/ 2x4 WALLS OR (3) 2x6 N/ 2x6 WALLS, UNLESS OTHERWISE NOTED.
 2. ALL HEADERS TO HAVE (1) 2x4 OR 2x6 JAGG AND KING STUDS EACH END, UNLESS OTHERWISE NOTED.
 3. MULTI-PENNING HEADERS TO HAVE (2) JACKS AT ADDITIONAL BEARING, UNLESS OTHERWISE NOTED. NO INTERMEDIATE FLOOR SYSTEM BLOCKING OR CONTINUOUS LOAD PATH JACKS ARE REQUIRED UNLESS OTHERWISE NOTED.
 4. ALL EXTERIOR WALLS TO BE 4" OR 6" AND ALL INTERIOR WALLS TO BE 3 1/2", UNLESS OTHERWISE NOTED.
 5. HATCHED AREAS INDICATE DROPPED CEILINGS. ALL DROPPED CEILINGS 6" TO 12" UNLESS OTHERWISE NOTED. SEE ARCHITECTURAL DETAIL 9/17-1B FOR 3/4" FIRE STOPPING AT BULKHEAD & CEILING PANELS.
 6. USE "BRACED WALL PANEL DETAIL SHEET" FOR SPECIAL WALL FRAMING LOCATIONS AND HEADER SIZES, IF APPLICABLE.
 7. USE STANDARD DETAIL CATEGORY "1" SHEET(S) FOR INTERIOR TRIM DETAILS.
 8. USE DETAIL SHEET "AD" FOR HOUSE SPECIFIC INTERIOR TRIM OPTION SHEET.
 9. ALL HEADERS IN NON-BEARING WALLS SHALL BE A SINGLE FLAT 2x4 OR 2x6 ATTACHED TO CRIPPLES ABOVE, UNLESS OTHERWISE NOTED.
 10. TANKED WATER HEATER SHOWN AS BASE CONDITION, OPTION FOR TANKLESS WATER HEATER IS AVAILABLE IN LINE OF TANKED WATER HEATER.
 11. INTERIOR HEADER HEIGHT BE 7' CEILING HILL BE 6'-11", 9' CEILING HILL BE 7'-11", 10' CEILING HILL BE 8'-3", UNLESS OTHERWISE NOTED.
 12. BASEMENT FINISH DIMENSIONS ASSUME A 1/2" GAP BETWEEN FRAME WALL AND CONCRETE WALL.
 13. INTERIOR BEARING WALLS SHALL HAVE GYPSUM APPLIED TO AT LEAST ONE SIDE OR HAVE MID-HEIGHT FULL HEIGHT INSTALLATION.
 14. NON-BEARING WALLS ABOVE CEILING TO BE HELD 1/2" SHORT OF FRAMING ABOVE.

- ALL WINDOWS HAVE 7'-4 5/8" HEADER
HEIGHT UNLESS OTHERWISE NOTED

C:\NVR\Solves\CEDAR_CDR00_01\DCY-S2-0419\3320040\Sheets\Lot Specific\A-8_PLN2_LS.dwg 02/26/25 - 11:24 am

2
A-12

KITCHEN COUNTERTOP PLAN KC - 3640

SCALE: 3/8" = 1'-0"

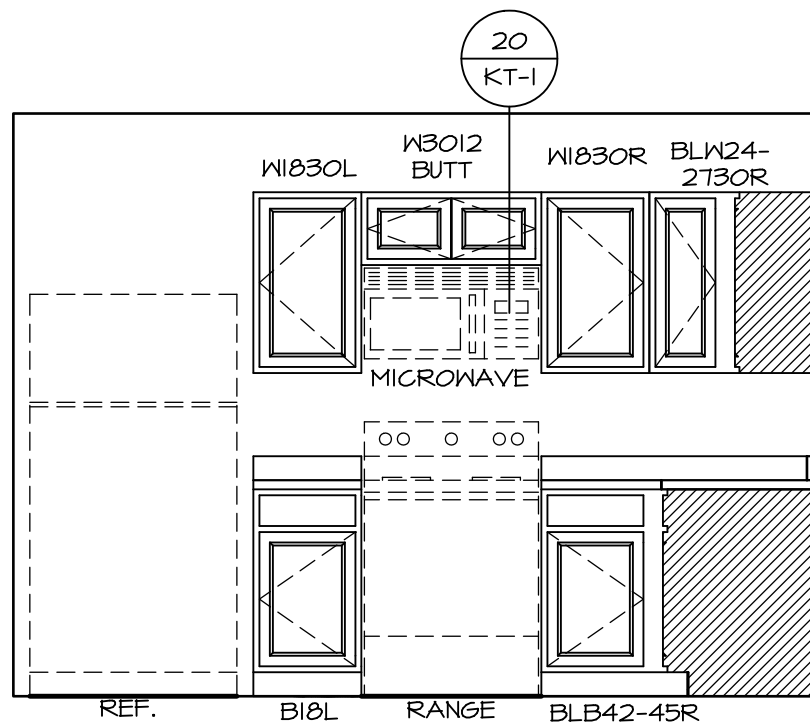

A ELEVATION

SCALE: 3/8" = 1'-0"

1
A-12

KITCHEN CABINET PLAN KC - 3640

SCALE: 3/8" = 1'-0"

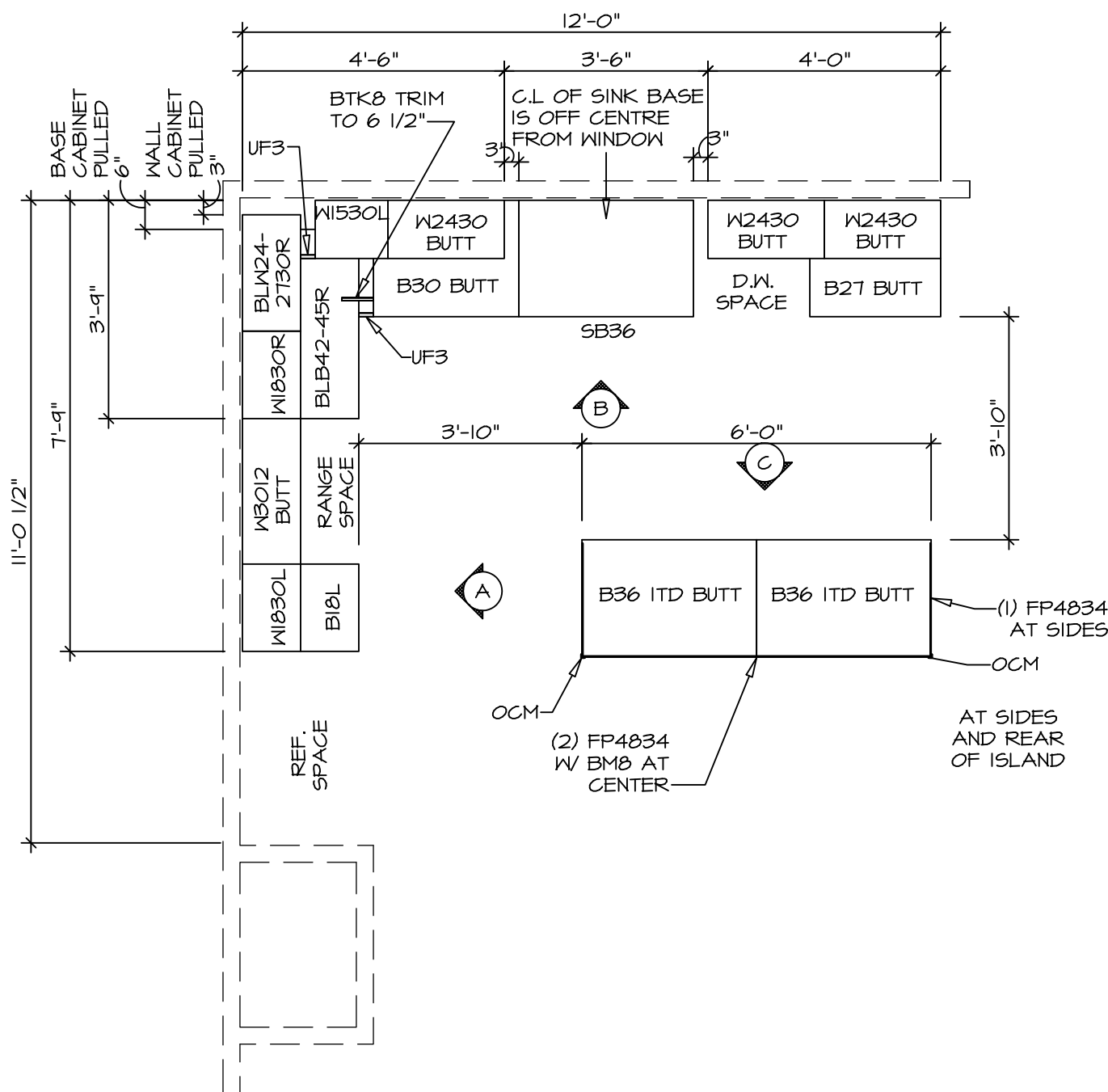

B ELEVATION

SCALE: 3/8" = 1'-0"

C ELEVATION

SCALE: 3/8" = 1'-0"

KITCHEN NOTES:

1. CABINET LAYOUT (S) ARE BASED ON FINISHED DIMENSIONS TO DRYWALL.
2. IF KITCHEN PLANS/ELEVATIONS CALL-OUT STANDARD MOLDING, REFER TO STANDARD DETAIL (U/KT-1) FOR REPLACEMENT BASED ON CABINET STYLE.
3. ALL (UF#) FILLERS ARE TO BE "TRIM TO FIT" UNLESS OTHERWISE NOTED.
4. CABINET MUST BE SET, SHIMMED, LEVELED AND PLUMB W/ ADJOINING BASE CABINETS.
5. SET PRE-FINISHED SCRIBE MOLDING AT CABINET BULKHEADS AND AT ENDS (WHERE CABINETS MEET DRYWALL). PRE-FINISHED SCRIBE MOLDING SHALL BE USED TO PAD OUT CABINET SIDES AT STILE FOR RETURN PIECES OF THE FACE-MOUNTED CABINET CROWN MOLDING.

NOTES:

CABINETS ARE NOT REPRESENTATIVE OF ALL STYLES AND ARE MEANT AS A GENERAL DEPICTION OF THE INTENDED CABINET LAYOUT

SHEET NO.

A-12

MODEL
CEDAR
DRAWING TITLE
KITCHEN

SET NO. CD000
VERSION OI
RELEASE NO. ----
DRAWN BY
DATE:
OPTION

NVR
NVR Inc., Suite 100
5285 Westview, Suite 100
Frederick, MD 21703

© NVR, Inc., expressly reserves its copyright and other property rights in these plans. These plans are not to be reproduced, stored in a retrieval system, or copied in any form or manner whatsoever, nor are they to be used for any purpose without the written consent of NVR, Inc.

DIV-COMM-LOT-UNIT

DCY-S2-0419

COM-Lot
SANTERS MILL - SIMPLY RYAN - 0419
STREET ADDRESS
6054 RIVULET DRIVE
CITY MIDDLETOWN
STATE OH
ZIP 45042

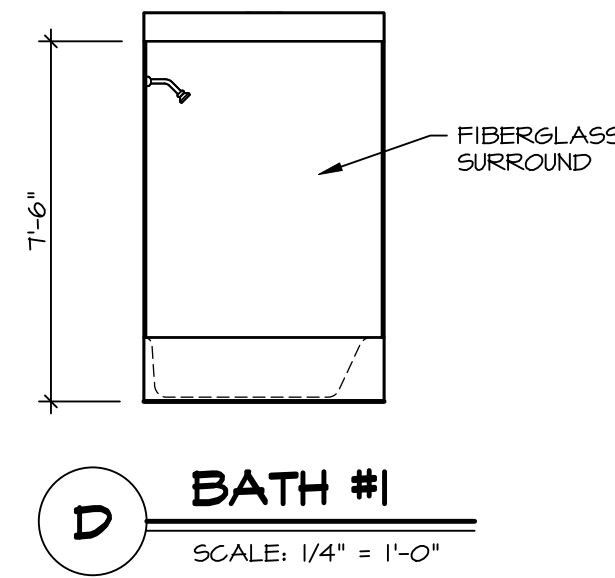
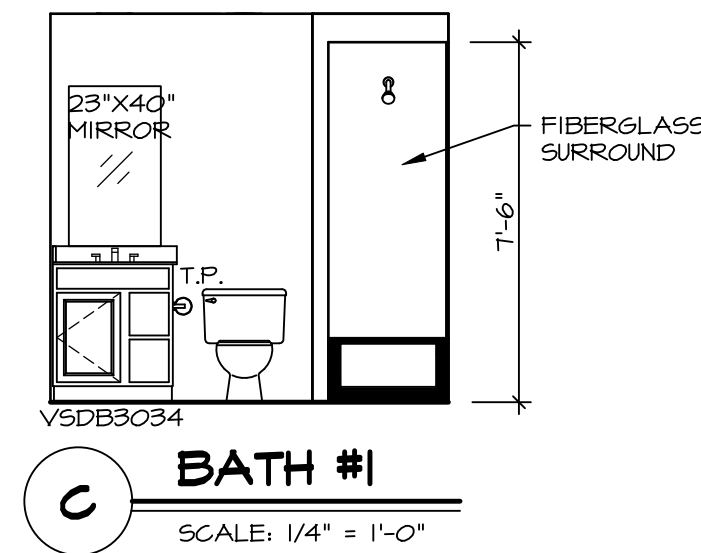
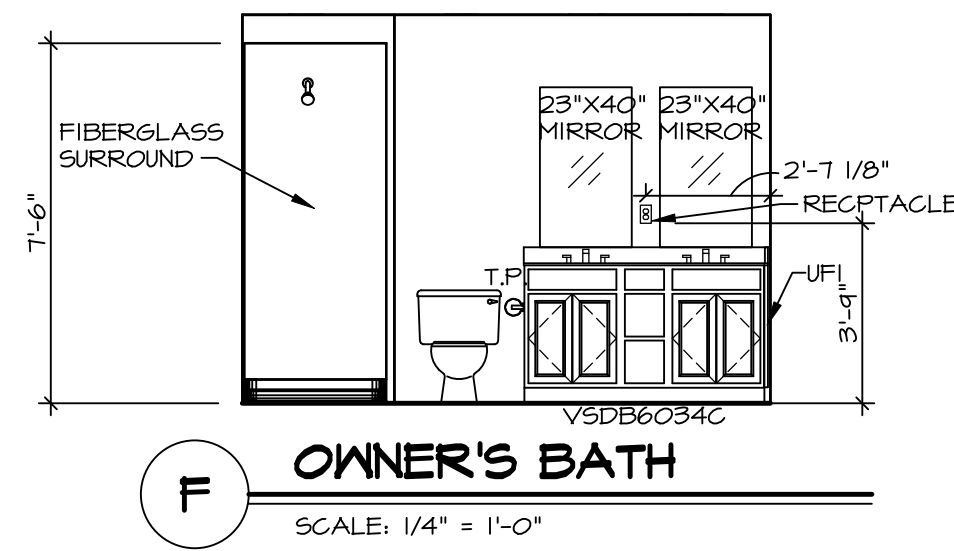
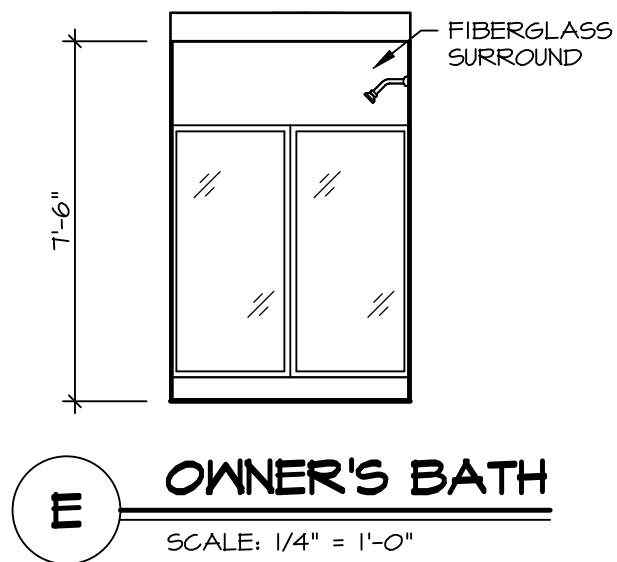
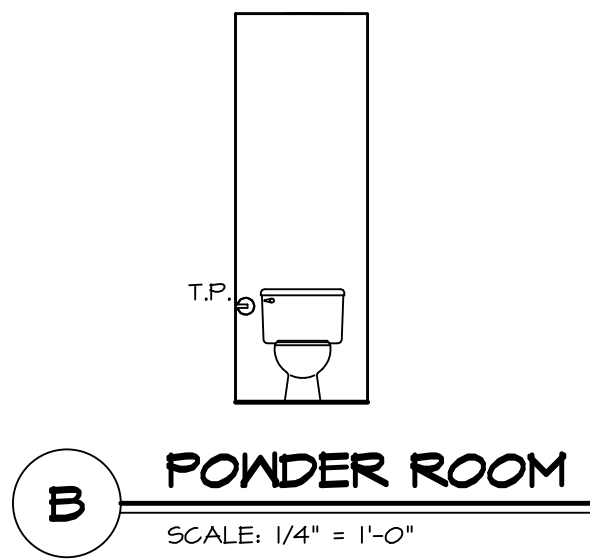
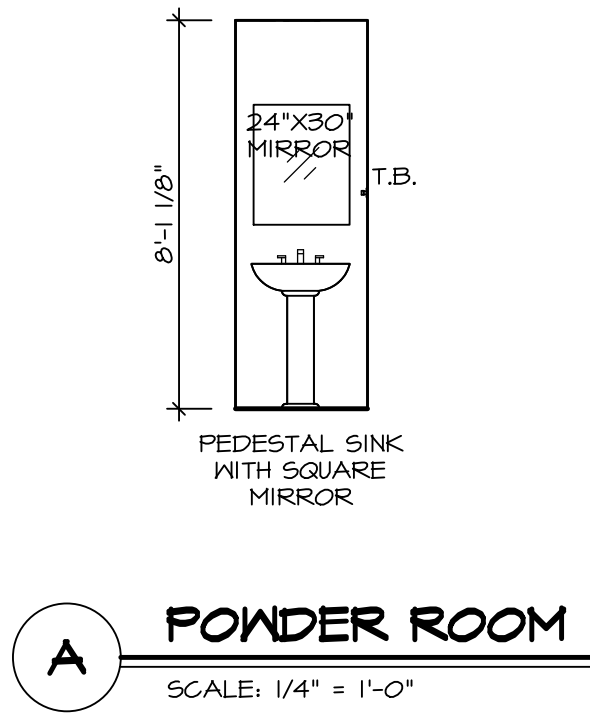

- BATH NOTES:**
1. TEMPERED GLASS SHOWER ENCLOSURE WITH SWING DOOR OR OPTIONAL SLIDING DOOR BY DIVISION.
 2. TUB ACCESS PANELS PROVIDED AS NEEDED, ALL MATERIALS BY DIVISION.
 3. ALL BATH ELEVATIONS SHOWN PER PLAN.
 4. ALL VANITIES WITH DRAWERS TO BE SET WITH DRAWERS ON RIGHT HAND SIDE.
 5. BATH ELEVATIONS ARE SHOWN PER PLAN.
 6. ALL DIMENSIONS SHOWN ON BATH ELEVATIONS ARE ROUGH FRAMING REFERENCES ONLY.

© NVR, Inc., expressly reserves its copyright and other property rights in these plans. These plans are not to be reproduced, stored in a retrieval system, or transmitted in any form or manner whatsoever, nor are they to be used for any purpose other than the first obtaining the expressed written consent of NVR, Inc.

[NVR]

NVR, Inc., Suite 100
5285 Westview Drive
Frederick, MD 21703

SHEET NO. A-13	MODEL CEDAR	SET NO. CDR00
	DRAWING TITLE BATH ELEVATIONS	VERSION 01
		RELEASE NO. ----
		DRAWN BY
		DATE:
	OPTION DESCRIPTION	OPTION

DIV-COMM-LOT-UNIT DCY-S2-0419			
COMM-LOT		COMMITTEE SANTYERS MILL - SIMPLY RYAN - 0419	
STREET ADDRESS		APT. NO.	----
6054 RIVULET DRIVE			
CITY	STATE	OH	ZIP
MIDDLETOWN			45042