

PLUMBING PLAN
SCALE: 1/4" = 1'-0"

| | | |
|-------------------------|---------------------------------------|-------------------------|
| SHEET NO. A-4 | MODEL BIRCH | SET NO. BRH00 |
| | DRAWING TITLE PLUMBING PLAN | VERSION 01 |
| | OPTION DESCRIPTION | DRAWN BY |
| 14 | | DATE: |
| | | OPTION |

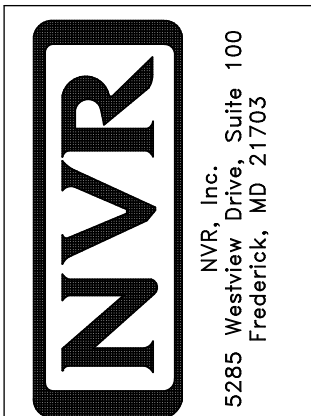

© NVR, Inc. NVR, Inc. expressly reserves the right to modify or amend these plans at any time without notice. These plans are not to be reproduced, changed or altered in any way without the written consent of NVR, Inc.

DIV-COMM-LOT-UNIT
DCY-VC-5624
COMM-LOT
WRIGHT LANDING - 5624
STREET ADDRESS
6003 AVIATION TRAIL
CITY DAYTON STATE OH ZIP 45424

| FIRST FLOOR JACK SCHEDULE | | |
|---------------------------|-------------------------------|-----------|
| IDENTIFIER | DESCRIPTION | ENG. NUM. |
| J100 | JACK - (4) 2x4 SFF STUD GRADE | 1004 |
| J101 | JACK - (2) 2x4 SFF STUD GRADE | 1002 |
| J102 | JACK - (3) 2x4 SFF STUD GRADE | 1015 |
| J103 | JACK - (3) 2x4 SFF STUD GRADE | 1015 |
| J104 | JACK - (4) 2x4 SFF STUD GRADE | 1004 |
| J105 | JACK - (2) 2x4 SFF STUD GRADE | 1008 |
| J106 | JACK - (2) 2x4 SFF STUD GRADE | 1008 |

| LEGEND | |
|--------|---|
| | BEARING WALL |
| | NON BEARING WALL |
| | INDICATES BEARING FROM POINT-LOAD ABOVE |
| | JACKS |
| | BEAM/HEADER |
| | PAD FOOTING |
| | STEEL COLUMN |
| | TRUSS TIE DOWN |
| | PORTAL FRAME |
| | JOIST/TRUSS |
| | LVL |
| | ENGINEERING PAGE NUMBER |

SEE FC DETAILS FOR FRAMING CONNECTORS

ALL WINDOWS HAVE 1 1/2" HEADER HEIGHT UNLESS OTHERWISE NOTED

FLOOR PLAN NOTES RYAN

- ALL HEADERS ARE (2) 2x6 w/ 2x4 WALLS OR (3) 2x6 w/ 2x6 WALLS, UNLESS OTHERWISE NOTED.
- ALL HEADERS TO HAVE (1) 2x4 OR 2x6 JACK AND KING STUD EACH END, UNLESS OTHERWISE NOTED. MULTI-OPENING HEADERS TO HAVE (2) JACKS AT INTERMEDIATE BEARING, UNLESS OTHERWISE NOTED. NO ADDITIONAL FLOOR SYSTEM BLOCKING OR CONTINUOUS LOAD PATH JACKS ARE REQUIRED UNLESS OTHERWISE NOTED.
- ALL EXTERIOR WALLS TO BE 4" w/ OSB OR 3 1/2" w/ LAMINATED FIBROUS STRUCTURAL SHEATHING. ALL INTERIOR WALLS TO BE 3 1/2", UNLESS OTHERWISE NOTED.
- HATCHED AREAS INDICATE DROPPED CEILING. ALL DROPPED CEILING ARE 12" UNLESS OTHERWISE NOTED.
- SEE "BRACED WALL PANEL DETAIL SHEET" FOR SPECIAL WALL FRAMING LOCATIONS AND HEADER SIZES, IF APPLICABLE.
- SEE STANDARD DETAIL CATEGORY "IT" SHEET(S) FOR INTERIOR TRIM DETAILS.
- SEE ARCHITECTURAL DETAIL SHEET "AD" FOR HOUSE SPECIFIC INTERIOR TRIM OPTION TABLE.
- ALL HEADERS IN NON-BEARING WALLS SHALL BE A SINGLE FLAT 2x4 OR 2x6 ATTACHED TO CRIPPLES ABOVE, UNLESS OTHERWISE NOTED.
- TANKED WATER HEATER SHOWN AS BASE CONDITION, OPTIONAL TANKLESS WATER HEATER IS AVAILABLE IN LIEU OF TANKED WATER HEATER.

GYPSUM NOTES

AT GARAGE:
GYPSUM BOARD AT COMMON WALLS, CEILING, BEAM WRAPS AND SUPPORTS PER STANDARD DETAIL FA-1(b) FIRE ASSEMBLIES OR AS REQUIRED BY LOCAL CODE.

AT STAIRS:
1/2" GYPSUM BOARD AT UNDERSIDE OF STAIRS AND WALLS IN CLOSET

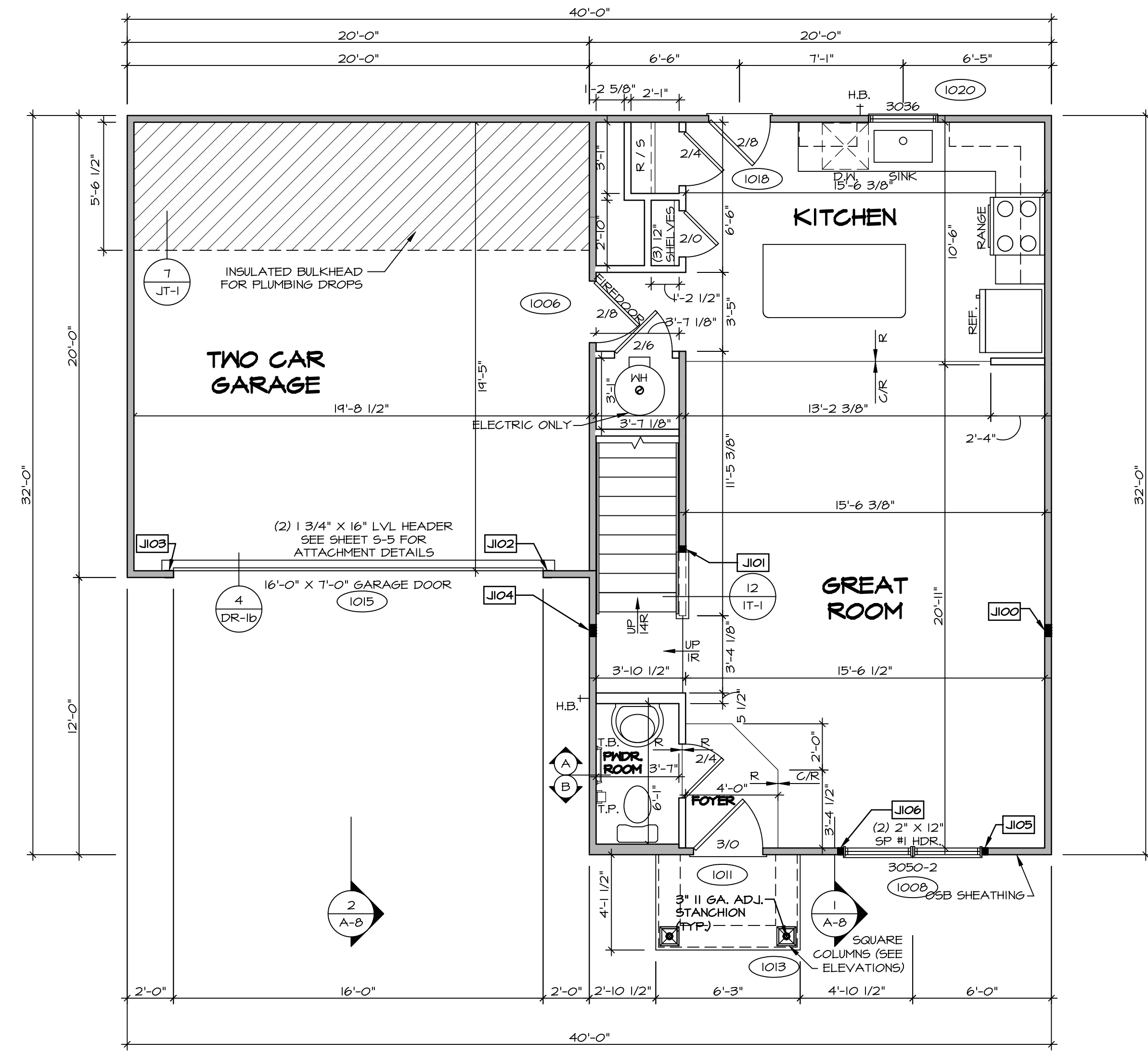

FIRST FLOOR PLAN
SCALE: 1/4" = 1'-0"

| | | | |
|--|-----------------------|--|---------------------|
| SHEET NO. A-6 | MODEL BIRCH | SET NO. BRH00 | DATE: OPTION |
| | | VERSION 01 | |
| DRAWING TITLE FIRST FLOOR PLAN | DRAWN BY | DIV-COMM-LOT-UNIT DCY-VC-5624 | |
| | | COMM-LOT WRIGHT LANDING - 5624 | |
| OPTION DESCRIPTION | DATE: | STREET ADDRESS 6008 AVIATION TRAIL | |
| | | CITY DAYTON | |
| 17 | OPTION | STATE OH | ZIP 45424 |
| | | APT. NO. R | |

NVR
NVR, Inc. Suite 100
5285 Washburne Rd.
Frederick, MD 21703

© NVR, Inc. expressly reserves the right to modify or amend these plans at any time without notice. These plans are not to be reproduced, changed, or altered in any way without the written consent of NVR, Inc.

C:\NVR\Solves\BIRCH_BRH00_01\DCY-VC-5624\3146729\Sheet17_A-6_PLN1_LS.dwg 09/04/21 - 3:29 am

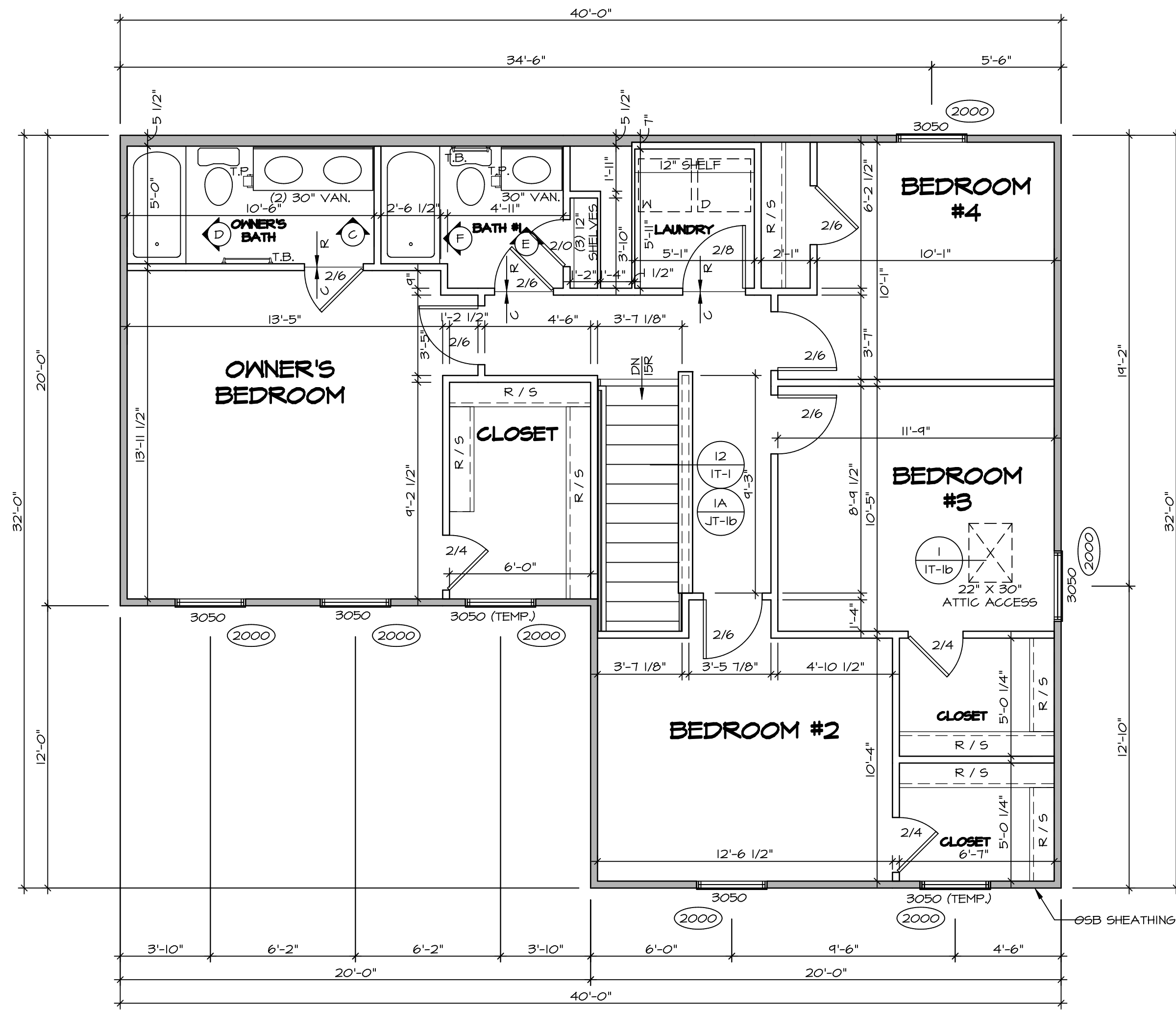

SECOND FLOOR PLAN
SCALE: 1/4" = 1'-0"

| LEGEND | |
|--------|---|
| | BEARING WALL |
| | NON BEARING WALL |
| | INDICATES BEARING FROM POINT-LOAD ABOVE |
| | JACKS |
| | BEAM/HEADER |
| | PAD FOOTING |
| | STEEL COLUMN |
| | TRUSS TIE DOWN |
| | PORTAL FRAME |
| | JOIST/TRUSS |
| | LVL |
| | ENGINEERING PAGE NUMBER |

SEE FC DETAILS FOR FRAMING CONNECTORS

FLOOR PLAN NOTES

- ALL HEADERS ARE (2) 2x6 w/ 2x4 WALLS OR (3) 2x6 w/ 2x6 WALLS, UNLESS OTHERWISE NOTED.
- ALL HEADERS TO HAVE (1) 2x4 OR 2x6 JACK AND KING STUD EACH END, UNLESS OTHERWISE NOTED. MULTI-OPENING HEADERS TO HAVE (2) JACKS AT INTERMEDIATE BEARING, UNLESS OTHERWISE NOTED. NO ADDITIONAL FLOOR SYSTEM BLOCKING OR CONTINUOUS LOAD PATH JACKS ARE REQUIRED UNLESS OTHERWISE NOTED.
- ALL EXTERIOR WALLS TO BE 4" w/ OSB OR 3 1/2" w/ LAMINATED FIBROUS STRUCTURAL SHEATHING. ALL INTERIOR WALLS TO BE 3 1/2", UNLESS OTHERWISE NOTED.
- HATCHED AREAS INDICATE DROPPED CEILING. ALL DROPPED CEILING ARE 12" UNLESS OTHERWISE NOTED.
- SEE "BRACED WALL PANEL DETAIL SHEET" FOR SPECIAL WALL FRAMING LOCATIONS AND HEADER SIZES, IF APPLICABLE.
- SEE STANDARD DETAIL CATEGORY "IT" SHEET(S) FOR INTERIOR TRIM DETAILS.
- SEE ARCHITECTURAL DETAIL SHEET "AD" FOR HOUSE SPECIFIC INTERIOR TRIM OPTION TABLE.
- ALL HEADERS IN NON-BEARING WALLS SHALL BE A SINGLE FLAT 2x4 OR 2x6 ATTACHED TO CRIPPLES ABOVE, UNLESS OTHERWISE NOTED.
- TANKED WATER HEATER SHOWN AS BASE CONDITION. OPTIONAL TANKLESS WATER HEATER IS AVAILABLE IN LIEU OF TANKED WATER HEATER.

GYPSUM NOTES

AT GARAGE:
GYPSUM BOARD AT COMMON WALLS, CEILING, BEAM WRAPS AND SUPPORTS PER STANDARD DETAIL FA-1(b) FIRE ASSEMBLIES OR AS REQUIRED BY LOCAL CODE.

AT STAIRS:
1/2" GYPSUM BOARD AT UNDERSIDE OF STAIRS AND WALLS IN CLOSET

| | | | | | | | | |
|--|-----------------------|---|---------------------------------|---|-------------------|----------|-------|--------|
| SHEET NO. A-7 | MODEL BIRCH | DRAWING TITLE SECOND FLOOR PLAN | OPTION DESCRIPTION 1B | SET NO. BRH00 | VERSION 01 | DRAWN BY | DATE: | OPTION |
| | | | | <p>© NVR, Inc. expressly reserves the right to modify or change these plans without notice. These plans are not to be reproduced, changed or copied in any way without the written consent of NVR, Inc.</p> <p>NVR NVR, Inc. Suite 100 5285 Washington Blvd. Frederick, MD 21703</p> | | | | |
| <p>DIV-COMM-LOT-UNIT DCY-VC-5624</p> <p>COMM-LOT MRIGHT LANDING - 5624</p> <p>STREET ADDRESS 6008 AVIATION TRAIL</p> <p>CITY DAYTON</p> <p>STATE OH</p> <p>ZIP 45424</p> | | | | <p>APT. NO. R</p> | | | | |

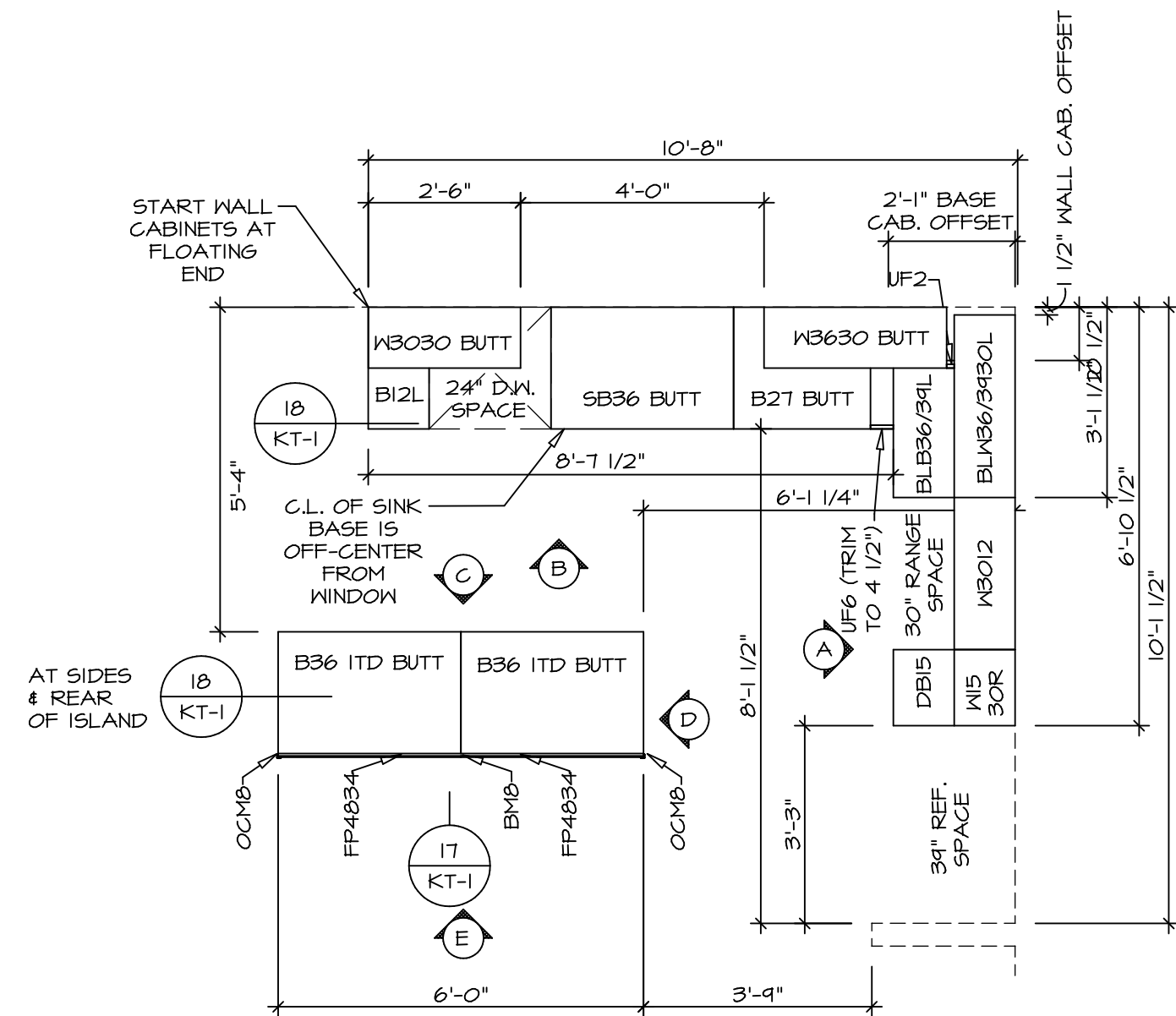

KITCHEN CABINET PLAN KC-3638
SCALE: 3/8" = 1'-0"
1 A-10

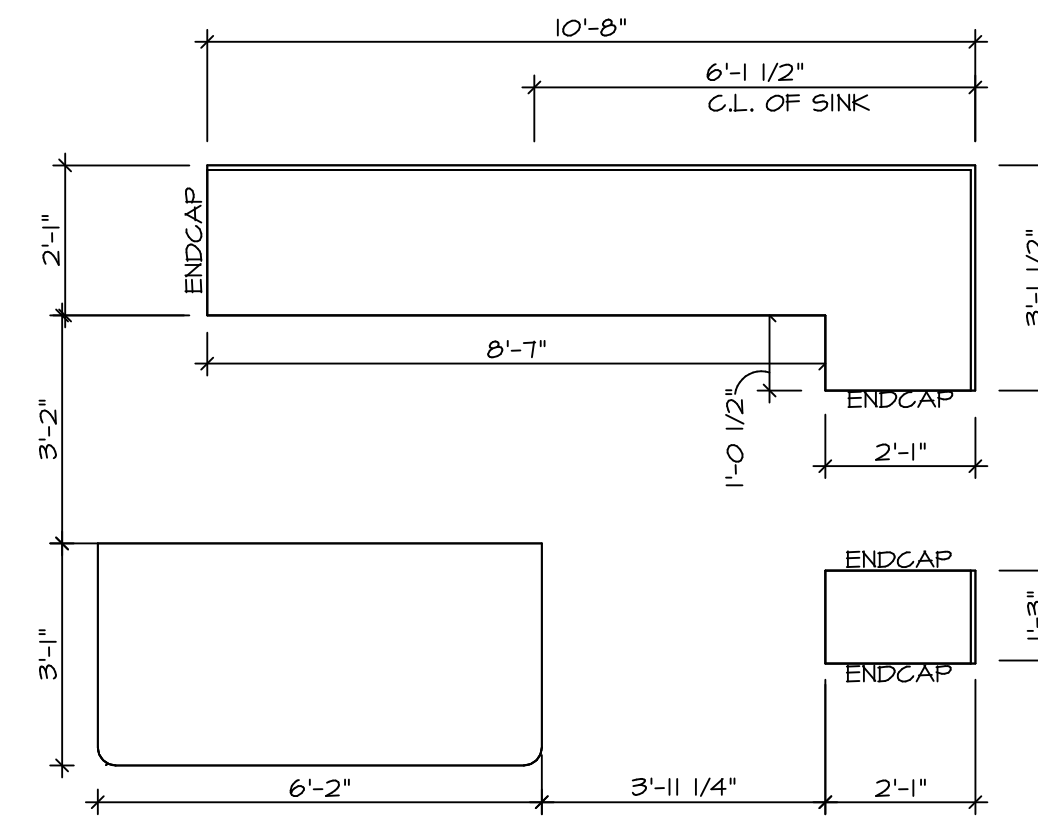

KITCHEN COUNTERTOP PLAN KT-3638
SCALE: 3/8" = 1'-0"
2 A-10

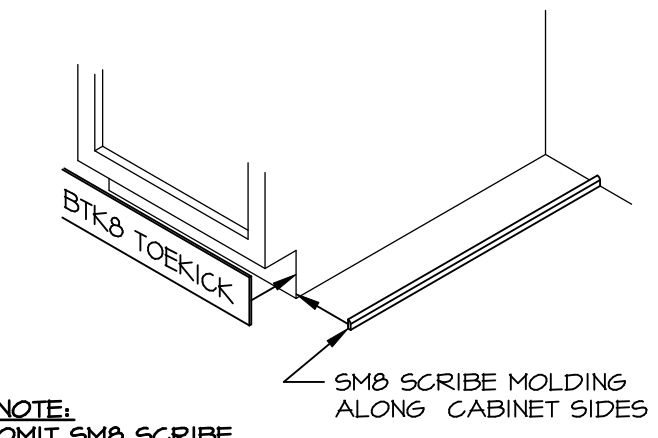

NOTE: OMIT SMO SCRIBE MOLDING AT DISHWASHER SPACES
TOEKICK / SCRIBE DETAIL
SCALE: 3/4" = 1'-0"
5 A-10

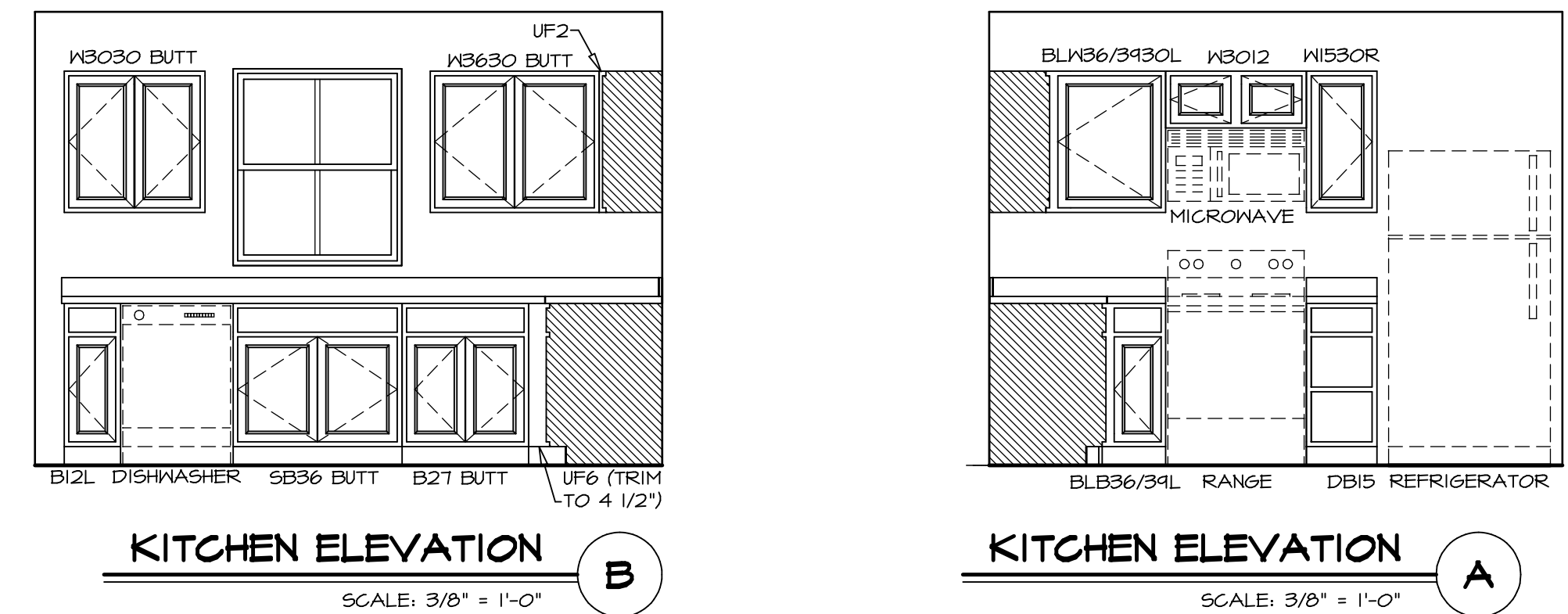
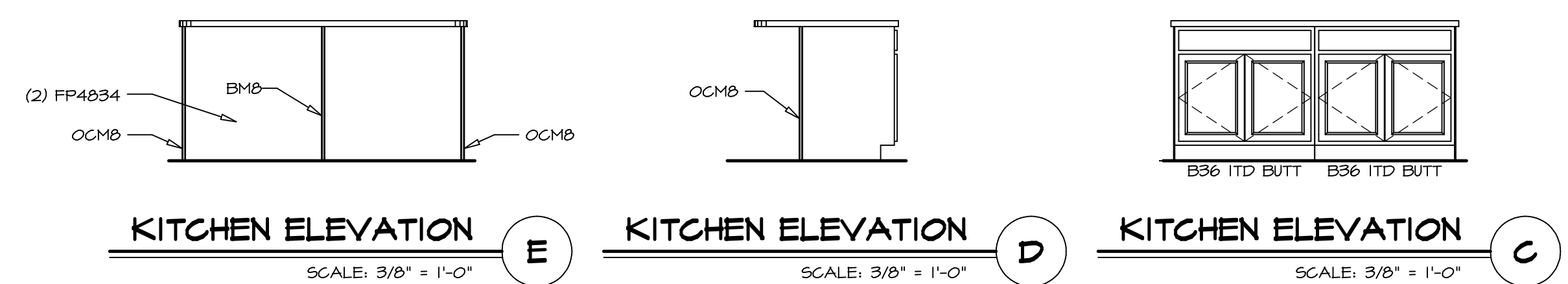

NOTES:
1. CABINET LAYOUT(S) ARE BASED ON FINISHED DIMENSIONS TO DRYWALL.
2. IF KITCHEN PLANS/ELEVATIONS CALL-OUT STANDARD MOULDING, REFER TO STANDARD DETAIL (NKT-1) FOR REPLACEMENT BASED ON CABINET STYLE.
3. ALL (UF#) FILLERS ARE TO BE "TRIM TO FIT".

| | | | |
|--|-----------------------|--|--------------------|
| SHEET NO. A-10 | MODEL BIRCH | SET NO. BRH00 | VERSION 01 |
| | | DRAWN BY | DATE: |
| DRAWING TITLE KITCHEN PLANS AND ELEVATIONS | | OPTION | |
| OPTION DESCRIPTION | | | |
| DIV-COMM-LOT-UNIT DCY-VC-5624 | | COMM-LOT WRIGHT LANDING - 5624 | APT. NO. R |
| STREET ADDRESS 6008 AVIATION TRAIL | | CITY DAYTON | STATE OH |
| ZIP 45424 | | | |

© NVR, Inc. expressly reserves the right to modify these plans without notice. These plans are not to be reproduced, changed or altered in any way without the written consent of NVR, Inc.
NVR, Inc. Suite 100
Frederick, MD 21703
5285 Washburn Rd.
08/04/21 - 3:29 am
C:\NVR\Solves\BIRCH_BRH00_01\DCY-VC-5624\316729\Sheet\Lot_Specific\21_A-10_KIT_LS.dwg

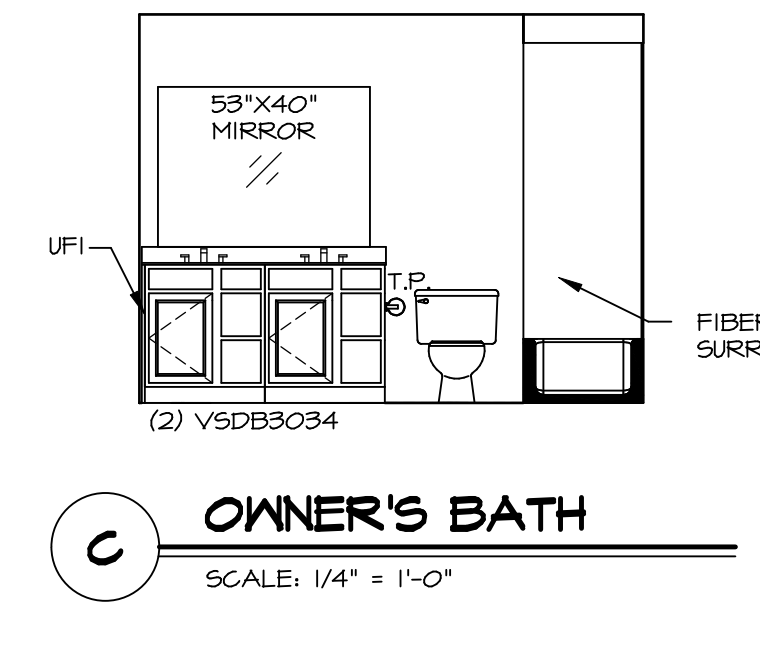
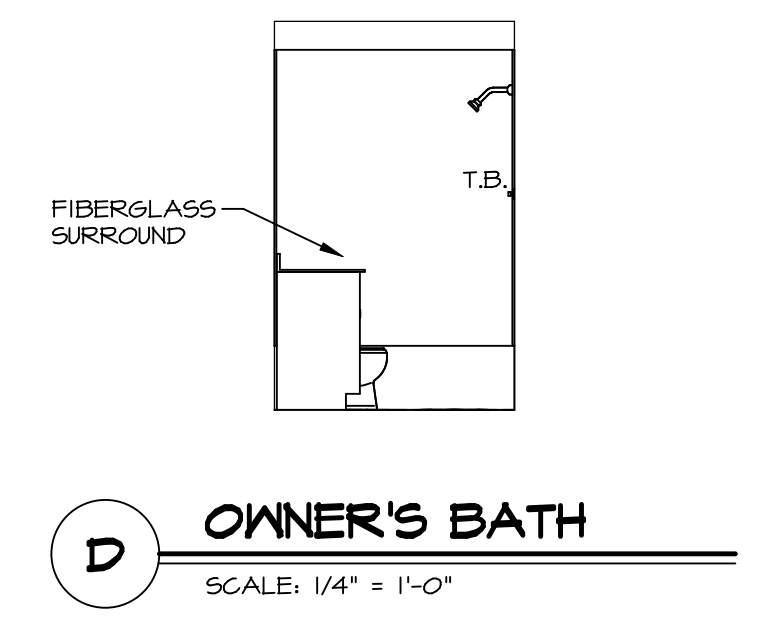
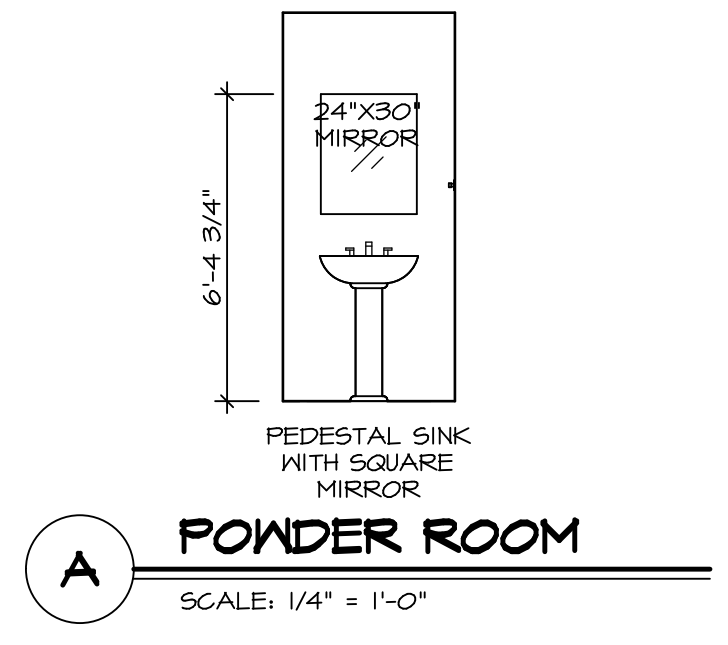
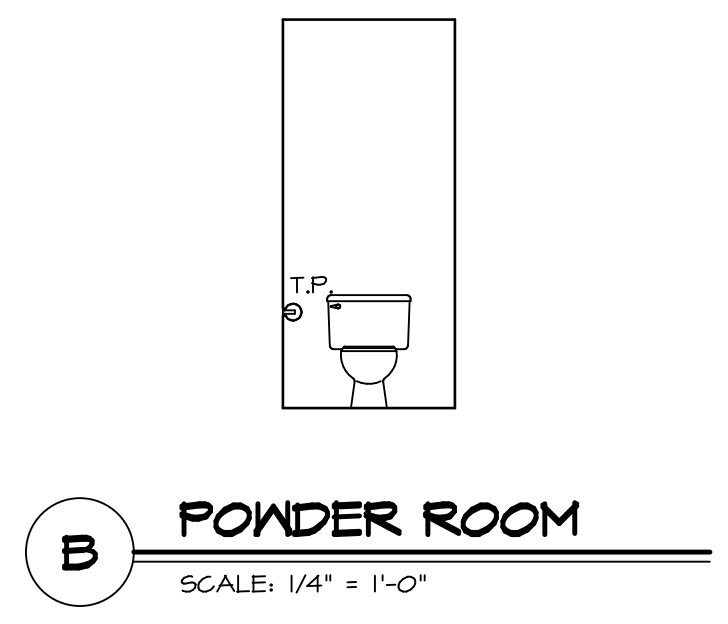

- NOTES:**
1. TEMPERED GLASS SHOWER ENCLOSURE WITH SWING DOOR OR OPTIONAL SLIDING DOOR BY DIVISION.
 2. TUB ACCESS PANELS PROVIDED AS NEEDED, ALL MATERIALS BY DIVISION.
 3. ALL BATH ELEVATIONS ARE SHOWN PER PLAN.
 4. ALL V5DB24-42 DRAWERS TO BE SET ON RIGHT HAND.

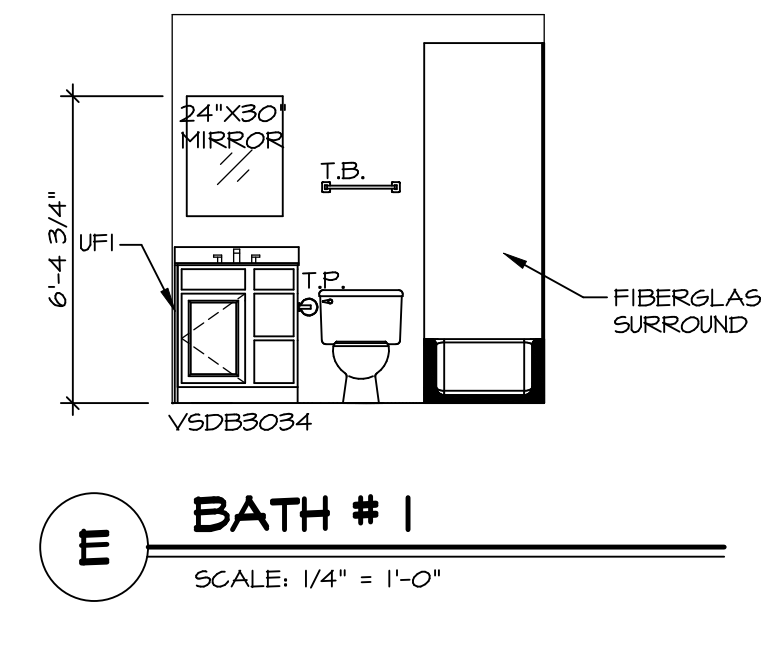
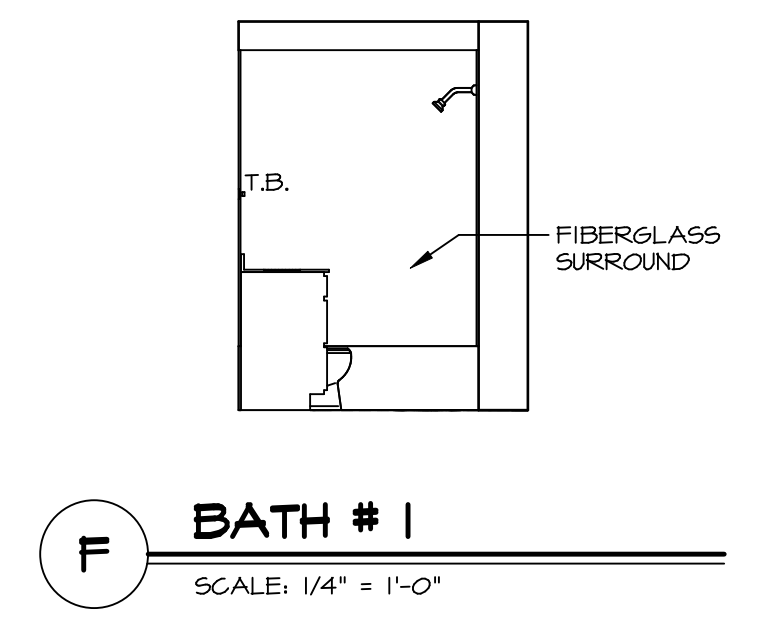

| | | |
|---|-----------------------|------------------|
| SHEET NO. A-11 | MODEL BIRCH | SET NO. BRH00 |
| DRAWING TITLE BATH ELEVATIONS | VERSION 01 | DRAWN BY |
| OPTION DESCRIPTION | DATE: | OPTION |
| 22 | | |

NVR
NVR, Inc., Suite 100
5285 Washburne, Frederick, MD 21703

© NVR, Inc. expressly reserves the right to modify or change these plans without notice. These plans are not to be reproduced, changed or copied in any way without the written consent of NVR, Inc.

| | |
|---|----------------|
| DIV-COMM-LOT-UNIT DCY-YC-5624 | |
| COMM-LOT WRIGHT LANDING - 5624 | APT. NO. R |
| STREET ADDRESS 6008 AVIATION TRAIL | CITY DAYTON |
| STATE OH | ZIP 45424 |