

- FLOOR PLAN NOTES**
1. ALL ELECTRICAL WORK SHALL BE IN ACCORDANCE WITH THE NATIONAL ELECTRICAL CODE (NEC) AND THE LOCAL ELECTRICAL CODES.
 2. ALL ELECTRICAL WORK SHALL BE PERFORMED BY A LICENSED ELECTRICIAN.
 3. ALL ELECTRICAL WORK SHALL BE PERFORMED IN ACCORDANCE WITH THE MANUFACTURER'S INSTRUCTIONS.
 4. ALL ELECTRICAL WORK SHALL BE PERFORMED IN ACCORDANCE WITH THE PROJECT SPECIFICATIONS.
 5. ALL ELECTRICAL WORK SHALL BE PERFORMED IN ACCORDANCE WITH THE PROJECT SCHEDULE.
 6. ALL ELECTRICAL WORK SHALL BE PERFORMED IN ACCORDANCE WITH THE PROJECT BUDGET.
 7. ALL ELECTRICAL WORK SHALL BE PERFORMED IN ACCORDANCE WITH THE PROJECT QUALITY CONTROL PLAN.
 8. ALL ELECTRICAL WORK SHALL BE PERFORMED IN ACCORDANCE WITH THE PROJECT SAFETY PLAN.
 9. ALL ELECTRICAL WORK SHALL BE PERFORMED IN ACCORDANCE WITH THE PROJECT ENVIRONMENTAL PROTECTION PLAN.
 10. ALL ELECTRICAL WORK SHALL BE PERFORMED IN ACCORDANCE WITH THE PROJECT COMMUNITY RELATIONS PLAN.
- GYPSUM NOTES**
- AT GARAGE:
 ALL GYPSUM BOARD SHALL BE 5/8" THICK TYPE X GYPSUM BOARD.
 ALL GYPSUM BOARD SHALL BE INSTALLED IN ACCORDANCE WITH THE MANUFACTURER'S INSTRUCTIONS.
 AT STAIRS:
 ALL GYPSUM BOARD SHALL BE 5/8" THICK TYPE X GYPSUM BOARD.
 ALL GYPSUM BOARD SHALL BE INSTALLED IN ACCORDANCE WITH THE MANUFACTURER'S INSTRUCTIONS.

BASEMENT JACK SCHEDULE

| DESCRIPTION | QUANTITY | UNIT | PRICE | TOTAL |
|------------------------------|----------|------|--------|--------|
| 200 JACK - 20" DIA. 20' LONG | 1 | EA | 100.00 | 100.00 |
| 200 JACK - 20" DIA. 20' LONG | 1 | EA | 100.00 | 100.00 |

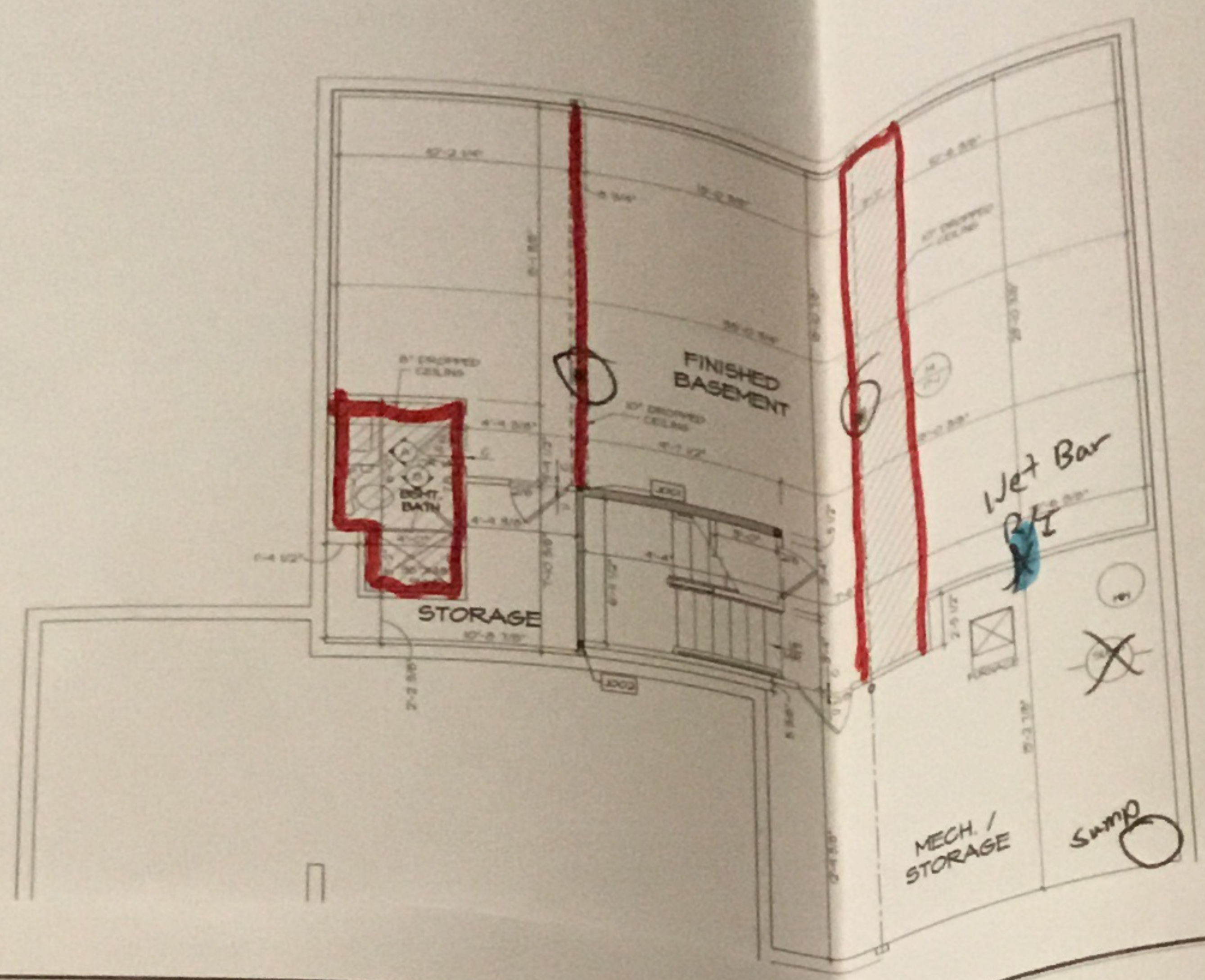

- NOTES**
1. ALL ELECTRICAL WORK SHALL BE IN ACCORDANCE WITH THE NATIONAL ELECTRICAL CODE (NEC) AND THE LOCAL ELECTRICAL CODES.
 2. ALL ELECTRICAL WORK SHALL BE PERFORMED BY A LICENSED ELECTRICIAN.
 3. ALL ELECTRICAL WORK SHALL BE PERFORMED IN ACCORDANCE WITH THE MANUFACTURER'S INSTRUCTIONS.
 4. ALL ELECTRICAL WORK SHALL BE PERFORMED IN ACCORDANCE WITH THE PROJECT SPECIFICATIONS.
 5. ALL ELECTRICAL WORK SHALL BE PERFORMED IN ACCORDANCE WITH THE PROJECT SCHEDULE.
 6. ALL ELECTRICAL WORK SHALL BE PERFORMED IN ACCORDANCE WITH THE PROJECT BUDGET.
 7. ALL ELECTRICAL WORK SHALL BE PERFORMED IN ACCORDANCE WITH THE PROJECT QUALITY CONTROL PLAN.
 8. ALL ELECTRICAL WORK SHALL BE PERFORMED IN ACCORDANCE WITH THE PROJECT SAFETY PLAN.
 9. ALL ELECTRICAL WORK SHALL BE PERFORMED IN ACCORDANCE WITH THE PROJECT ENVIRONMENTAL PROTECTION PLAN.
 10. ALL ELECTRICAL WORK SHALL BE PERFORMED IN ACCORDANCE WITH THE PROJECT COMMUNITY RELATIONS PLAN.

- ELECTRICAL LEGEND**
- SINGLE POLE SWITCH
 - DOUBLE POLE SWITCH
 - FUSE BOX
 - DUPLEX RECEPTACLE
 - DUPLEX RECEPTACLE - BOTTOM HALF
 - DUPLEX RECEPTACLE - FLOOR MOUNTED
 - RECEPTACLE - 220V
 - DUPLEX RECEPTACLE - 150
 - DUPLEX RECEPTACLE - SAVING SPACE
 - DUPLEX RECEPTACLE - NEW USE
 - DUPLEX RECEPTACLE - SHOCK PROOF
 - SHOCK DETECTOR - SERIES
 - CARBON MONOXIDE DETECTOR
 - EXPOSED FAN MOTOR
 - EXPOSED FAN MOTOR WITH LIGHT
 - TELEPHONE RECEPTACLE
 - TELEPHONE RECEPTACLE
 - DOOR CHIME
 - LIGHT FIXTURE - WALL MOUNTED
 - LIGHT FIXTURE - CEILING MOUNTED
 - LIGHT FIXTURE - RECESSED
 - LIGHT FIXTURE - RECESSED HEAVY
 - LIGHT FIXTURE - CEILING MOUNTED
 - LIGHT FIXTURE - PENDANT
 - LIGHT FIXTURE - FLUORESCENT
 - LIGHT FIXTURE - HOOK CABLE
 - LIGHT FIXTURE - 1" - 2" - 3" - 4" - 5" - 6" - 8" - 10" - 12" - 14" - 16" - 18" - 20" - 24" - 30" - 36" - 42" - 48" - 54" - 60" - 66" - 72" - 78" - 84" - 90" - 96" - 102" - 108" - 114" - 120" - 126" - 132" - 138" - 144" - 150" - 156" - 162" - 168" - 174" - 180" - 186" - 192" - 198" - 204" - 210" - 216" - 222" - 228" - 234" - 240" - 246" - 252" - 258" - 264" - 270" - 276" - 282" - 288" - 294" - 300"
 - FLOORING LAMP HOLDER
 - FLOORING LAMP HOLDER

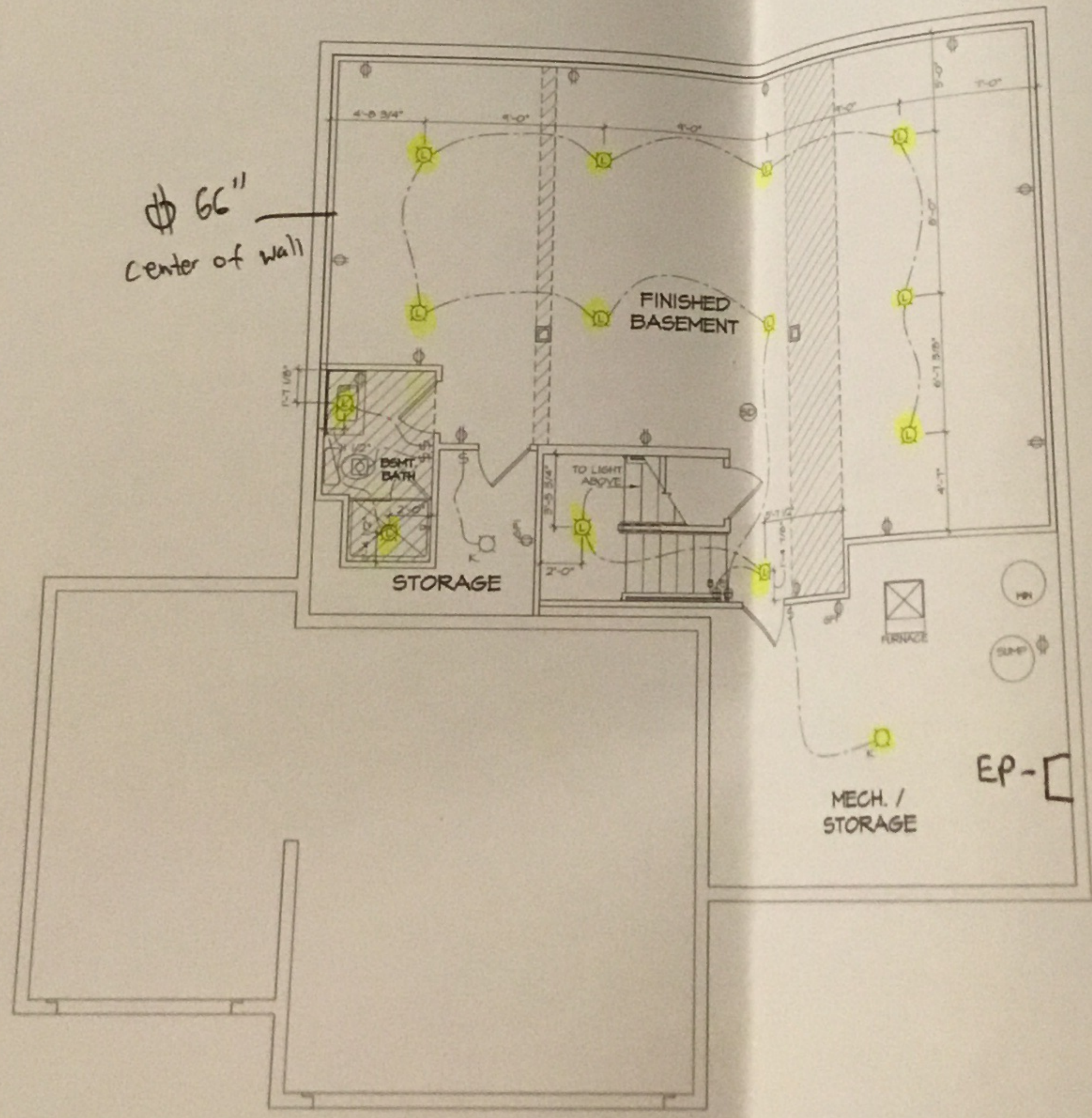

BASEMENT FLOOR ELECTRICAL PLAN
 SCALE: 1/4" = 1'-0"

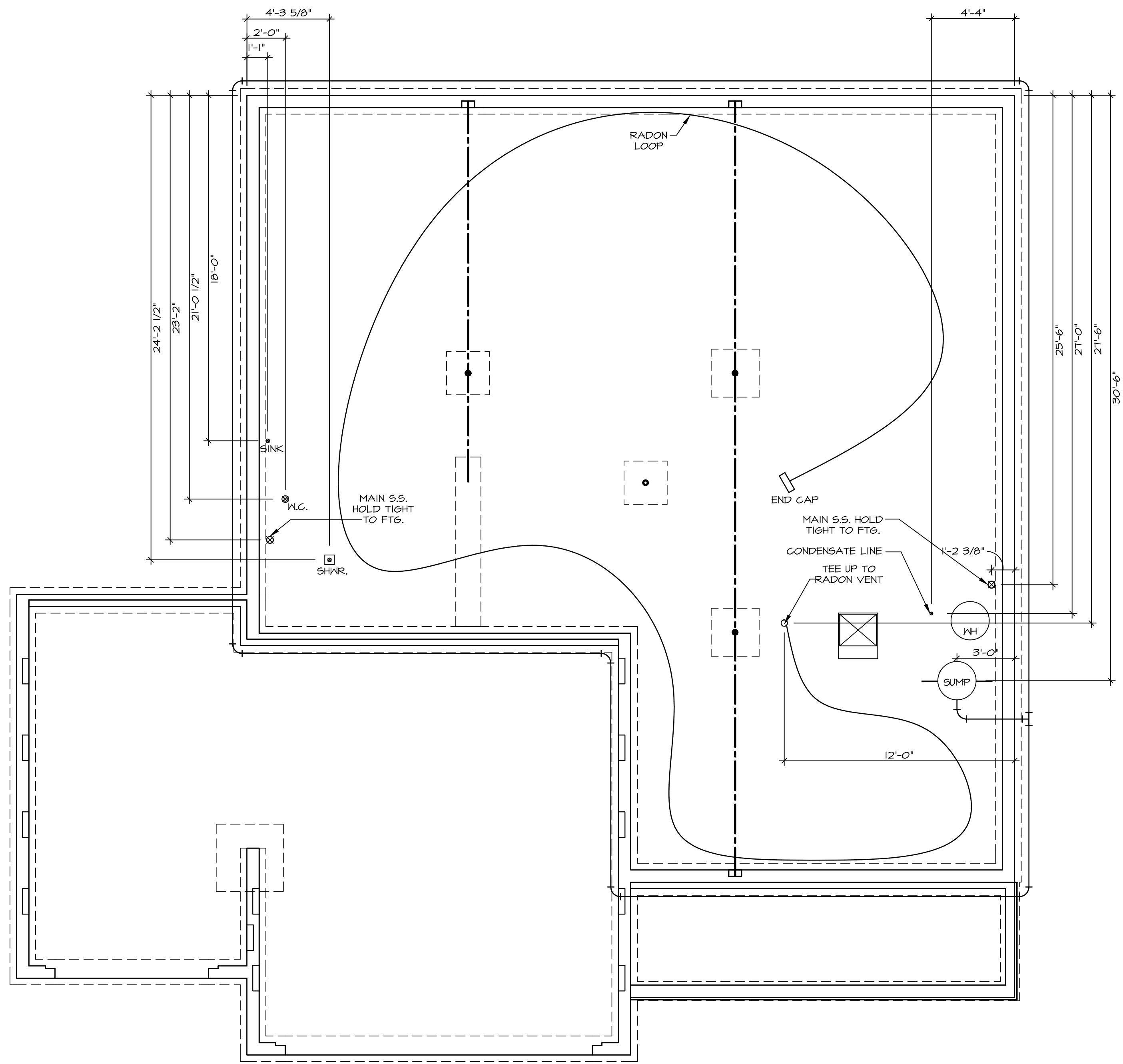

NOTE
 RADON REMEDIATION
 RADON LOOP:
 - (4") PERFORATED HDPE "LOOP"
 - MUST BE PLACED IN STONE BED SLIGHTLY HIGHER THAN ANY INTERIOR DRAINTILE
 - LOOP TO BE SEPARATE FROM ANY DRAINTILE ELEMENTS
 - TO BE CORRUGATED HDPE PIPE
 - SCREENS TO BE INSTALLED THROUGH LOOP AT TEE UP INTO STACK
 STACK REQUIREMENTS:
 - 3" PVC STACK (4" IF BASEMENT IS GREATER THAN 2200 SQFT.)
 - NO PART OF STACK IS TO BE HORIZONTAL
 - PIPE TO BE PHYSICALLY LABELED IN THE FIELD AS "RADON VENT" OR OTHER JURISDICTIONALLY REQUIRED LANGUAGE (ON EVERY LEVEL OF HOUSE)
 - ROOF TERMINATION TO BE IN TOP 1/3 OF ROOF
 - SCREEN INSTALLED TO KEEP PESTS OUT OF RADON VENT AT ROOF TERMINATION

PLUMBING PLAN
 SCALE: 1/4" = 1'-0"

| | | | | |
|---------------------------------|--------------------------------|------------------|-----------------|---------|
| SHEET NO. A-5 | MODEL LEHIGH | SET NO. LGH00 | REV. NO. DATE | REMARKS |
| | DRAWING TITLE PLUMBING PLAN | VERSION 01 | | |
| OPTION DESCRIPTION 25 | | | | |

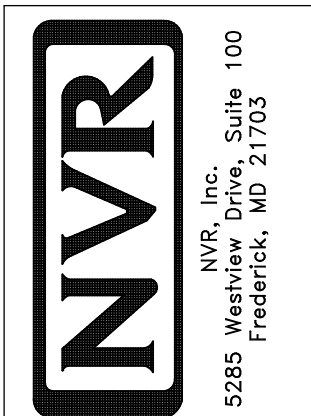

© NVR, Inc. expressly reserves the right to modify or amend these plans at any time without notice. No part of these plans may be reproduced, changed or altered in any way without the written consent of NVR, Inc.

| LEGEND | |
|---------------------------------------|---|
| | BEARING WALL |
| | NON BEARING WALL |
| | INDICATES BEARING FROM POINT-LOAD ABOVE |
| | JACKS |
| | BEAM/HEADER |
| | PAD FOOTING |
| | STEEL COLUMN |
| | PORTAL FRAME |
| | JOIST/TRUSS |
| | LVL |
| | ENGINEERING PAGE NUMBER |
| SEE FC DETAILS FOR FRAMING CONNECTORS | |

- FLOOR PLAN NOTES**
- ALL HEADERS ARE (2) 2x6 w/ 2x4 WALLS OR (3) 2x6 w/ 2x6 WALLS, UNLESS OTHERWISE NOTED.
 - ALL HEADERS TO HAVE (1) 2x4 OR 2x6 JACK AND KING STUD EACH END, UNLESS OTHERWISE NOTED.
 - ALL EXTERIOR WALLS TO BE 4" w/ OSB OR 3 1/2" w/ LAMINATED FIBROUS STRUCTURAL SHEATHING, ALL INTERIOR WALLS TO BE 3 1/2", UNLESS OTHERWISE NOTED.
 - HATCHED AREAS INDICATE DROPPED CEILINGS. ALL DROPPED CEILINGS ARE 12" UNLESS OTHERWISE NOTED. SEE 'BRACED WALL PANEL DETAIL SHEET' FOR SPECIAL WALL FRAMING LOCATIONS AND HEADER SIZES, IF APPLICABLE.
 - SEE STANDARD DETAIL CATEGORY '11' SHEET(S) FOR INTERIOR TRIM DETAILS.
 - SEE ARCHITECTURAL DETAIL SHEET 'AD' FOR HOUSE SPECIFIC INTERIOR TRIM OPTION TABLE.
 - ALL WINDOWS HAVE 7'-0 1/2" HEADER HEIGHT UNLESS OTHERWISE NOTED.
 - ALL HEADERS IN NON-BEARING WALLS SHALL BE A SINGLE FLAT 2x4 OR 2x6 ATTACHED TO CRIPPLES ABOVE, UNLESS OTHERWISE NOTED.
 - TANKED WATER HEATER SHOWN AS BASE CONDITION, OPTIONAL TANKLESS WATER HEATER IS AVAILABLE IN LIEU OF TANKED WATER HEATER.

- GYPSUM NOTES**
- AT GARAGE:
 GYPSUM BOARD AT COMMON WALLS, CEILINGS, BEAM WRAPS AND SUPPORTS PER STANDARD DETAIL FA-1(b) FIRE ASSEMBLIES OR AS REQUIRED BY LOCAL CODE.
- AT STAIRS:
 1/2" GYPSUM BOARD AT UNDERSIDE OF STAIRS AND WALLS IN CLOSET

BASEMENT JACK SCHEDULE

| IDENTIFIER | DESCRIPTION | OPTIONS | ENG. NUM. | REMARKS |
|------------|-------------------------------|---------|--------------|---------|
| J001 | JACK - (2) 2X4 SPF STUD GRADE | | B0001, B0015 | |
| J002 | JACK - (8) 2X4 SPF STUD GRADE | | B0007 | |

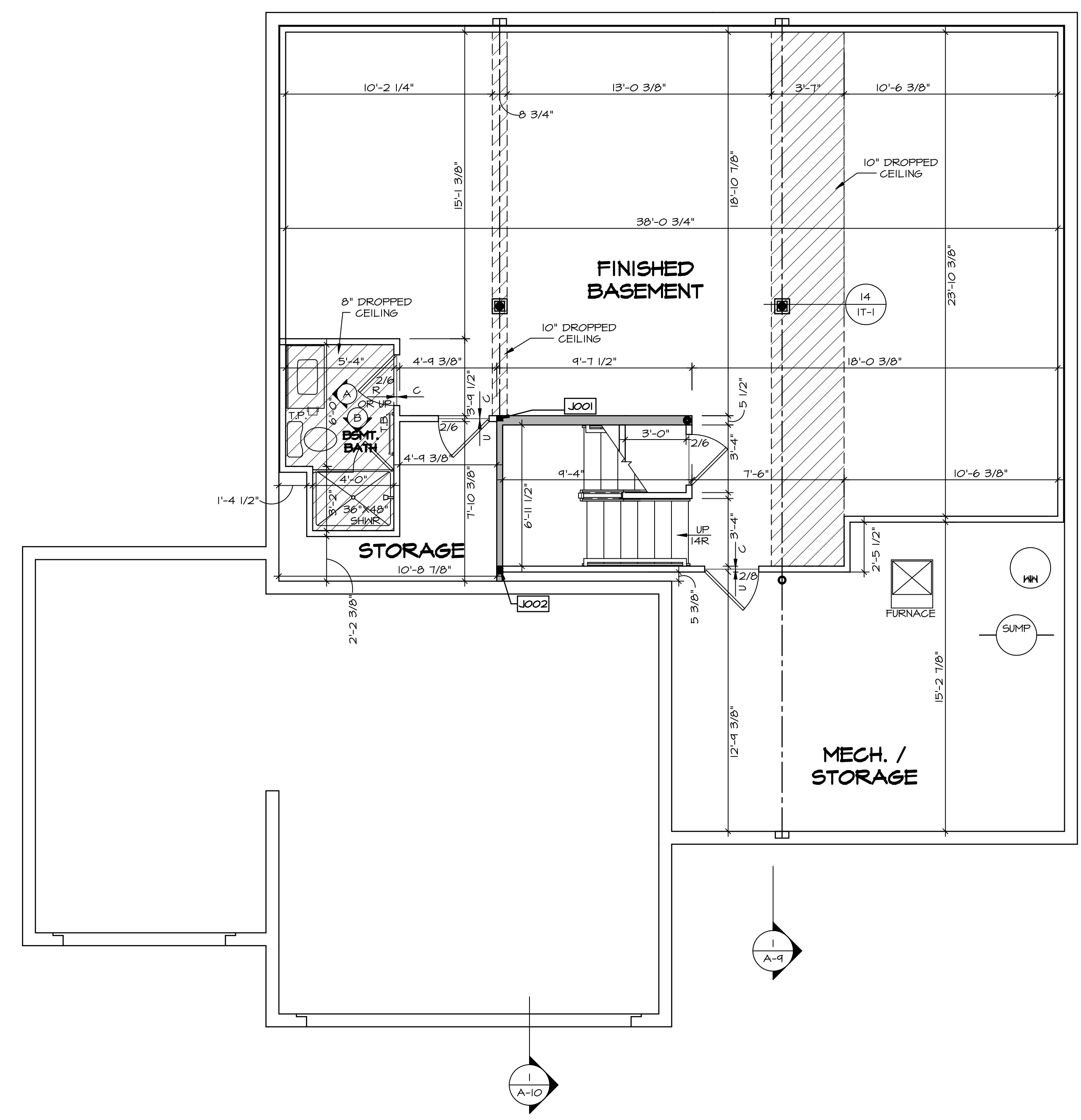

BASEMENT FLOOR PLAN
 SCALE: 1/4" = 1'-0"

REMARKS

REV. NO. DATE

© NVR, Inc. expressly reserves the right to modify these plans at any time without notice. These plans are not to be reproduced, changed or altered in any way without the written consent of NVR, Inc.

NVR
 NVR, Inc. Suite 100
 5285 Walkersville Road
 Frederick, MD 21703

SET NO. LGH00
 VERSION 01
 DRAWN BY
 DATE:
 OPTION

MODEL
LEHIGH
 DRAWING TITLE
BASEMENT FLOOR PLAN
 OPTION DESCRIPTION

SHEET NO.
A-6

28

C:\NVR\Solves\LEHIGH_LGH00_01\DCY-10-1604\1341593\Sheets\Lot_Specific\28_A-6_BSMT_LS.dwg 08/08/19 - 11:19 am

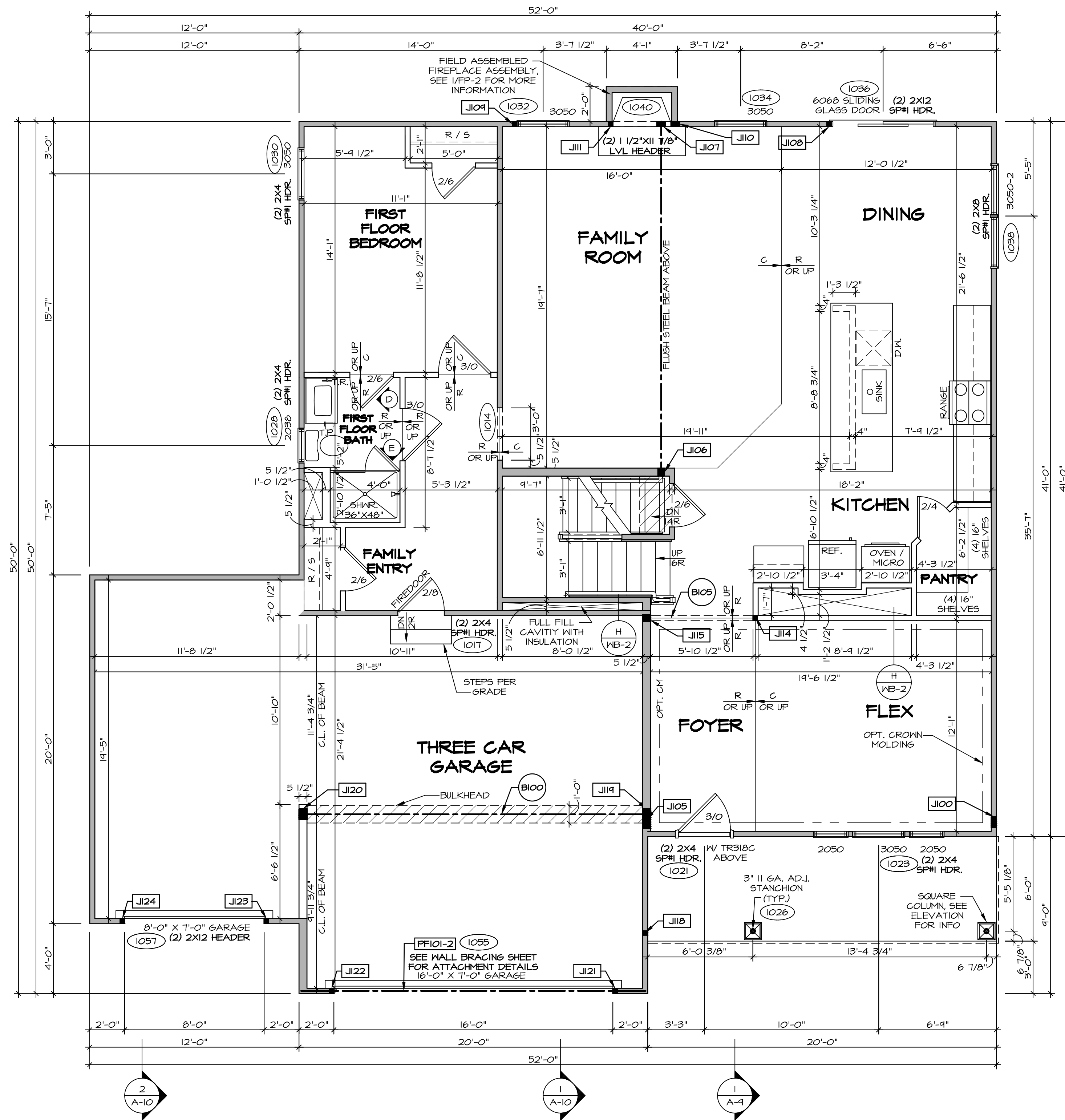

FIRST FLOOR PLAN
SCALE: 1/4" = 1'-0"

| LEGEND | |
|--------|---|
| | BEARING WALL |
| | NON BEARING WALL |
| | INDICATES BEARING FROM POINT-LOAD ABOVE |
| | JACKS |
| | BEAM/HEADER |
| | PAD FOOTING |
| | STEEL COLUMN |
| | PORTAL FRAME |
| | JOIST/TRUSS |
| | LVL |
| | ENGINEERING PAGE NUMBER |

SEE FC DETAILS FOR FRAMING CONNECTORS

- FLOOR PLAN NOTES**
- ALL HEADERS ARE (2) 2x6 w/ 2x4 WALLS OR (3) 2x6 w/ 2x6 WALLS, UNLESS OTHERWISE NOTED.
 - ALL HEADERS TO HAVE (1) 2x4 OR 2x6 JACK AND KING STUD EACH END, UNLESS OTHERWISE NOTED.
 - ALL EXTERIOR WALLS TO BE 4" w/ OSB OR 3 1/2" w/ LAMINATED FIBROUS STRUCTURAL SHEATHING, ALL INTERIOR WALLS TO BE 3 1/2", UNLESS OTHERWISE NOTED. HATCHED AREAS INDICATE DROPPED CEILINGS. ALL DROPPED CEILINGS ARE 12" UNLESS OTHERWISE NOTED.
 - SEE 'BRACED WALL PANEL DETAIL SHEET' FOR SPECIAL WALL FRAMING LOCATIONS AND HEADER SIZES, IF APPLICABLE.
 - SEE STANDARD DETAIL CATEGORY '11" SHEET(S) FOR INTERIOR TRIM DETAILS.
 - SEE ARCHITECTURAL DETAIL SHEET 'AD' FOR HOUSE SPECIFIC INTERIOR TRIM OPTION TABLE.
 - ALL WINDOWS HAVE 7'-0 1/2" HEADER HEIGHT UNLESS OTHERWISE NOTED.
 - ALL HEADERS IN NON-BEARING WALLS SHALL BE A SINGLE FLAT 2x4 OR 2x6 ATTACHED TO GRIPPLIES ABOVE, UNLESS OTHERWISE NOTED.
 - TANKED WATER HEATER SHOWN AS BASE CONDITION, OPTIONAL TANKLESS WATER HEATER IS AVAILABLE IN LIEU OF TANKED WATER HEATER.

- GYPNUM NOTES**
- AT GARAGE:
GYPSUM BOARD AT COMMON WALLS, CEILING, BEAM WRAPS AND SUPPORTS PER STANDARD DETAIL FA-1(b) FIRE ASSEMBLIES OR AS REQUIRED BY LOCAL CODE.
- AT STAIRS:
1/2" GYPSUM BOARD AT UNDERSIDE OF STAIRS AND WALLS IN CLOSET

| FIRST FLOOR JACK SCHEDULE | | | |
|---------------------------|-------------------------------|----------|------------|
| IDENTIFIER | DESCRIPTION | OPTIONS | ENG. NUM. |
| J100 | JACK - (5) 2X4 SFF# | | 2000 |
| J105 | JACK - (4) 2X6 SFF STUD GRADE | ELL | 2000 |
| J106 | JACK - (3) 2X6 SFF STUD GRADE | 1016 | |
| J107 | JACK - (4) 2X4 SFF STUD GRADE | L6F | 1016 |
| J108 | JACK - (2) 2X4 SFF STUD GRADE | 1036 | |
| J109 | JACK - (2) 2X4 SFF STUD GRADE | L6F | 1032 |
| J110 | JACK - (4) 2X4 SFF STUD GRADE | L6F | 1040 |
| J111 | JACK - (2) 2X4 SFF STUD GRADE | L6F | 1040 |
| J114 | JACK - (2) 2X4 SFF STUD GRADE | | 1078 |
| J115 | JACK - (3) 2X6 SFF STUD GRADE | | 1078 |
| J118 | JACK - (2) 2X4 SFF STUD GRADE | | 1026 |
| J119 | JACK - (5) 2X6 SFF# | 5XC | 1044, 1044 |
| J120 | JACK - (5) 2X6 SFF STUD GRADE | 6CB, 6CF | 1044, 1044 |
| J121 | JACK - (2) 2X4 SFF STUD GRADE | 6CB, 6CF | 1055 |
| J122 | JACK - (2) 2X4 SFF STUD GRADE | 6CB, 6CF | 1055 |
| J123 | JACK - (2) 2X4 SFF STUD GRADE | 6CF | 1051 |
| J124 | JACK - (2) 2X4 SFF STUD GRADE | 6CF | 1051 |

- LVL PLY TO PLY FASTENING SCHEDULE:** (WHERE APPLICABLE BASED ON LVL USAGE)
- 1A - (2) PLY UP TO AND INCLUDING 11/8" TALL; FASTEN PLYS W/ (2) ROWS 16D NAILS AT 12" O.C. OR ALT 1 1/2" WIDE LVL FASTEN PLYS W/ (3) ROWS 12D NAILS AT 12" O.C.
 - 2A - (2) PLY 14" TO AND INCLUDING 18" TALL (INCLUSIVE); FASTEN PLYS W/ (3) ROWS 16D NAILS AT 12" O.C. OR ALT 1 1/2" WIDE LVL FASTEN PLYS W/ (4) ROWS 12D NAILS AT 12" O.C.
 - 3A - (2) PLY 20" TALL AND OVER; FASTEN PLYS W/ (4) ROWS 16D NAILS AT 12" O.C. OR ALT 1 1/2" WIDE LVL FASTEN PLYS W/ (5) ROWS 12D NAILS AT 12" O.C.
 - 4A - (3) PLY UP TO AND INCLUDING 11/8" TALL; FASTEN PLYS W/ (2) ROWS 16D NAILS AT 12" O.C. FROM EACH SIDE OR ALT 1 1/2" WIDE LVL FASTEN PLYS W/ (3) ROWS 12D NAILS AT 12" O.C. FROM EACH SIDE.
 - 5A - (3) PLY 14" TO AND INCLUDING 18" TALL (INCLUSIVE); FASTEN PLYS W/ (3) ROWS 16D NAILS AT 12" O.C. FROM EACH SIDE OR ALT 1 1/2" WIDE LVL FASTEN PLYS W/ (4) ROWS 12D NAILS AT 12" O.C. FROM EACH SIDE.
 - 6A - (3) PLY 20" TALL AND OVER; FASTEN PLYS W/ (4) ROWS 16D NAILS AT 12" O.C. FROM EACH SIDE OR ALT 1 1/2" WIDE LVL FASTEN PLYS W/ (5) ROWS 12D NAILS AT 12" O.C. FROM EACH SIDE.
 - 7A - (4) PLY (ALL SIZES); FASTEN PLYS W/ (2) ROWS 1/2" DIAMETER A307 BOLTS AT 24" O.C. SEE SHOP DRAWING FOR ADDITIONAL INFORMATION.

| FIELD INSTALLED FIRST FLOOR BEAM/HEADER SCHEDULE | | | | | |
|--|--------------------------|------------|----------|------------|-------------------------|
| IDENTIFIER | DESCRIPTION | LENGTH | OPTIONS | ENG. NUM. | REMARKS |
| B100 | BEAM STEEL - W12X35 | 20'-1 1/2" | 5XC | 1044, 1044 | |
| B105 | INT HEADER - 2X8 - 2 PLY | 6'-7" | | 1078 | |
| PF101-2 | LVL 1.75 - 11-04 | 19'-4" | 6CB, 6CF | 1055 | 2-PLY, 1A, PORTAL FRAME |

REMARKS

| REV. NO. | DATE | DESCRIPTION |
|----------|------|-------------|
| | | |

© NVR, Inc. expressly reserves the right to modify or change any information in these plans. These plans are not to be reproduced, changed or altered in any way without the written consent of NVR, Inc.

NVR
NVR, Inc. Suite 100
5285 Washington Blvd
Frederick, MD 21703

SET NO. LG-H00
VERSION 01
DRAWN BY
DATE:
OPTION

MODEL
LEHIGH
DRAWING TITLE
FIRST FLOOR PLAN
OPTION DESCRIPTION

SHEET NO.
A-7
30

C:\NVR\Solves\LEHIGH\LG-H00_01\DCY-19-1604\1341593\Sheets\Lot_Specifs\30_A-7_PLN1_LS.dwg 08/08/19 11:19 am

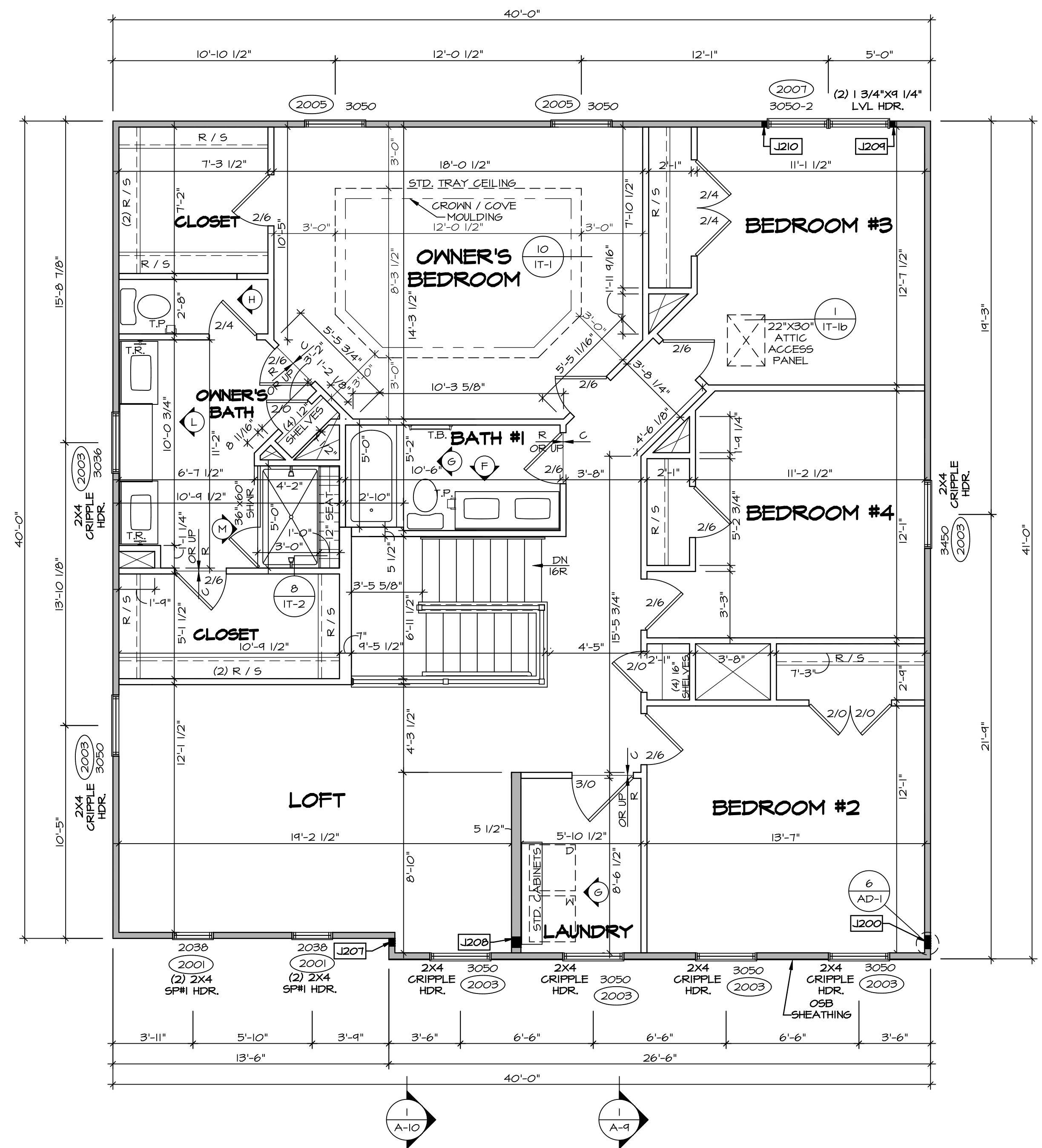

LEGEND

- BEARING WALL
- NON BEARING WALL
- INDICATES BEARING FROM POINT-LOAD ABOVE
- JACKS
- BEAM/HEADER
- PAD FOOTING
- STEEL COLUMN
- PORTAL FRAME
- JOIST/TRUSS
- LVL
- ENGINEERING PAGE NUMBER

SEE FC DETAILS FOR FRAMING CONNECTORS

- FLOOR PLAN NOTES**
1. ALL HEADERS ARE (2) 2x6 w/ 2x4 WALLS OR (3) 2x6 w/ 2x6 WALLS, UNLESS OTHERWISE NOTED.
 2. ALL HEADERS TO HAVE (1) 2x4 OR 2x6 JACK AND KING STUD EACH END, UNLESS OTHERWISE NOTED.
 3. ALL EXTERIOR WALLS TO BE 4" w/ OSB OR 3 1/2" w/ LAMINATED FIBROUS STRUCTURAL SHEATHING. ALL INTERIOR WALLS TO BE 3 1/2", UNLESS OTHERWISE NOTED.
 4. HATCHED AREAS INDICATE DROPPED CEILINGS. ALL DROPPED CEILINGS ARE 12" UNLESS OTHERWISE NOTED.
 5. SEE "BRACED WALL PANEL DETAIL SHEET" FOR SPECIAL WALL FRAMING LOCATIONS AND HEADER SIZES, IF APPLICABLE.
 6. SEE STANDARD DETAIL CATEGORY "11" SHEET(S) FOR INTERIOR TRIM DETAILS.
 7. SEE ARCHITECTURAL DETAIL SHEET "AD" FOR HOUSE SPECIFIC INTERIOR TRIM OPTION TABLE.
 8. ALL WINDOWS HAVE "T-O 1/2" HEADER HEIGHT UNLESS OTHERWISE NOTED.
 9. ALL HEADERS IN NON-BEARING WALLS SHALL BE A SINGLE FLAT 2x4 OR 2x6 ATTACHED TO CRIPPLES ABOVE, UNLESS OTHERWISE NOTED.
 10. TANKED WATER HEATER SHOWN AS BASE CONDITION, OPTIONAL TANKLESS WATER HEATER IS AVAILABLE IN LIEU OF TANKED WATER HEATER.

- GYPSUM NOTES**
- AT GARAGE:**
GYPSUM BOARD AT COMMON WALLS, CEILINGS, BEAM WRAPS AND SUPPORTS PER STANDARD DETAIL FA-1(b) FIRE ASSEMBLY OR AS REQUIRED BY LOCAL CODE.
- AT STAIRS:**
1/2" GYPSUM BOARD AT UNDERSIDE OF STAIRS AND WALLS IN CLOSET

SECOND FLOOR JACK SCHEDULE

| IDENTIFIER | DESCRIPTION | OPTIONS | ENG. NUM. | REMARKS |
|------------|-------------------------------|---------|-----------|--|
| J200 | JACK - (5) 2X4 SP#1 | | 2000 | 1/8"x3 1/2"x1 1/2" STEEL BEARING PLATE, EXTEND THRU TOP PLATES |
| J207 | JACK - (3) 2X4 SP# STUD GRADE | ELL | 2000 | EXTEND THRU TOP PLATE |
| J208 | JACK - (4) 2X4 SP# STUD GRADE | ELL | 2000 | EXTEND THRU TOP PLATE |
| J209 | JACK - (2) 2X4 SP# STUD GRADE | | 2001 | |
| J210 | JACK - (2) 2X4 SP# STUD GRADE | | 2001 | |

SECOND FLOOR PLAN
SCALE: 1/4" = 1'-0"

© NVR, Inc. All rights reserved. The information contained herein is for informational purposes only and is not to be reproduced, changed or copied in any way without the express written consent of NVR, Inc.

NVR
NVR, Inc., Suite 100
5285 Washington Blvd.
Frederick, MD 21703

SET NO. L6H00
VERSION 01
DRAWN BY
DATE:
OPTION

A-8
SECOND FLOOR PLAN

OPTION DESCRIPTION

33

C:\NVR\Solves\LEHIGH_L6H00_01\DCY-19-1604\1341593\Sheets\Lot_Specific\33_A-B_PLN2_LS.dwg 08/08/19 11:20 am

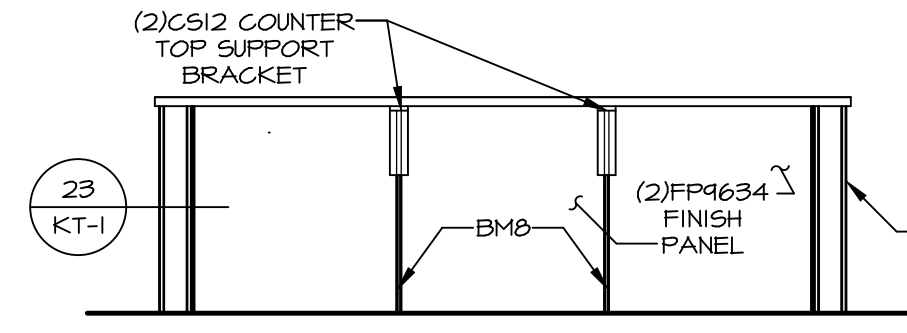

CABINET ELEVATION D
SCALE: 3/8" = 1'-0"

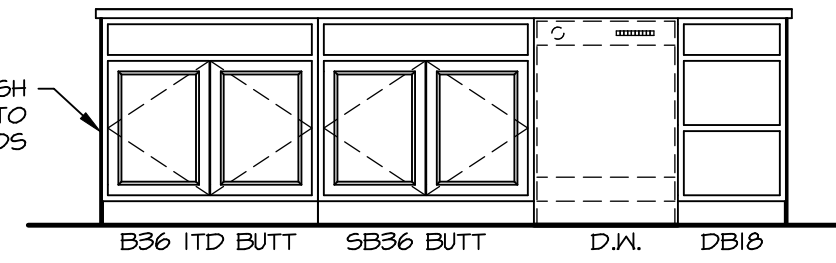

CABINET ELEVATION C
SCALE: 3/8" = 1'-0"

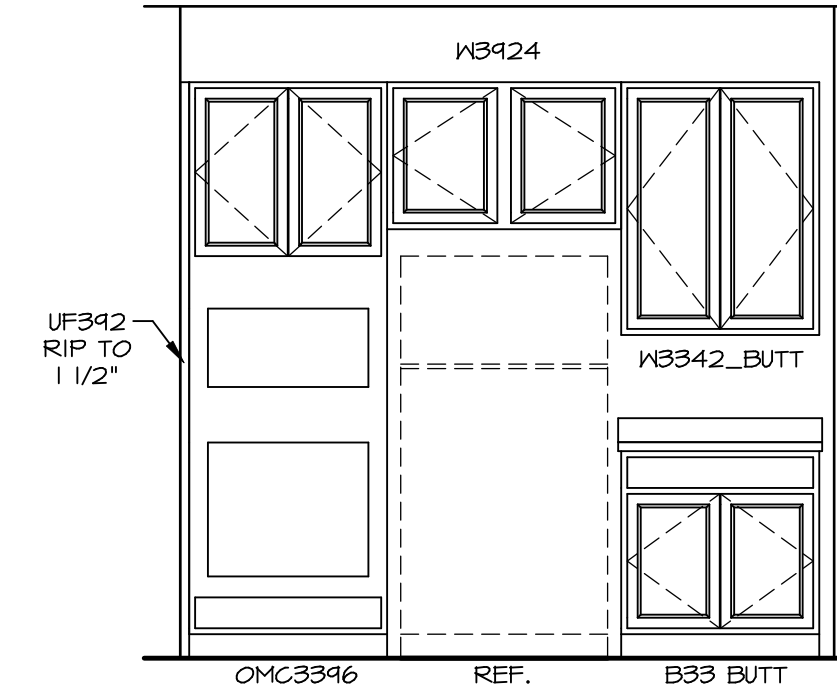

CABINET ELEVATION B
SCALE: 3/8" = 1'-0"

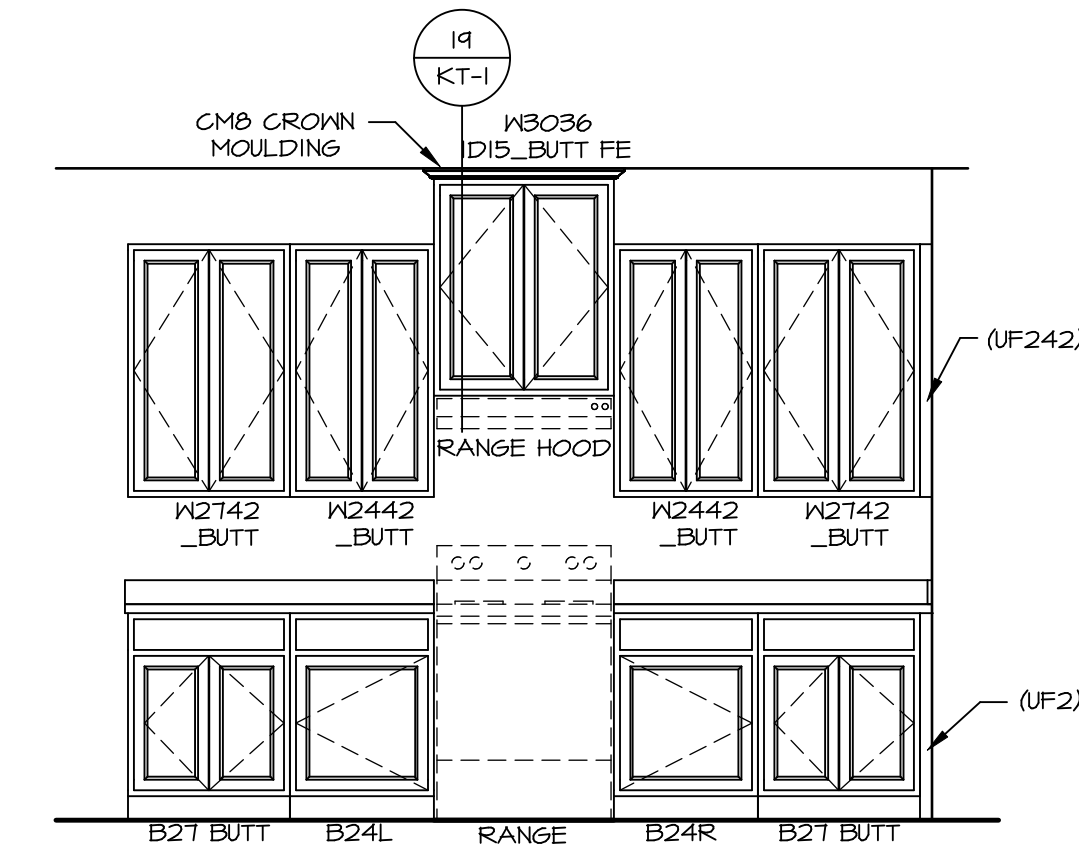

CABINET ELEVATION A
SCALE: 3/8" = 1'-0"

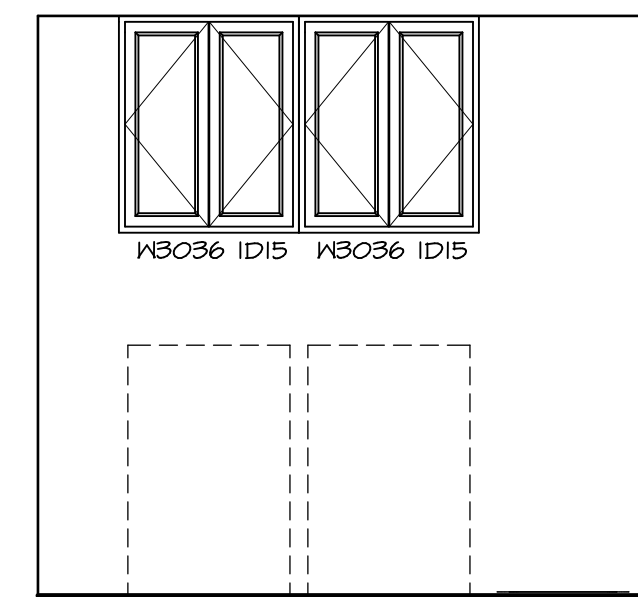

CABINET ELEVATION G
SCALE: 3/8" = 1'-0"

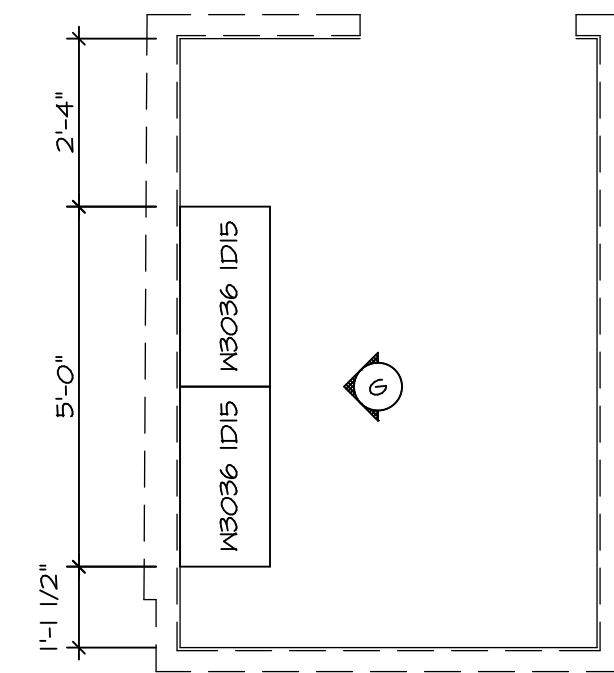

LAUNDRY CABINET PLAN / KC - 3503
SCALE: 3/8" = 1'-0"

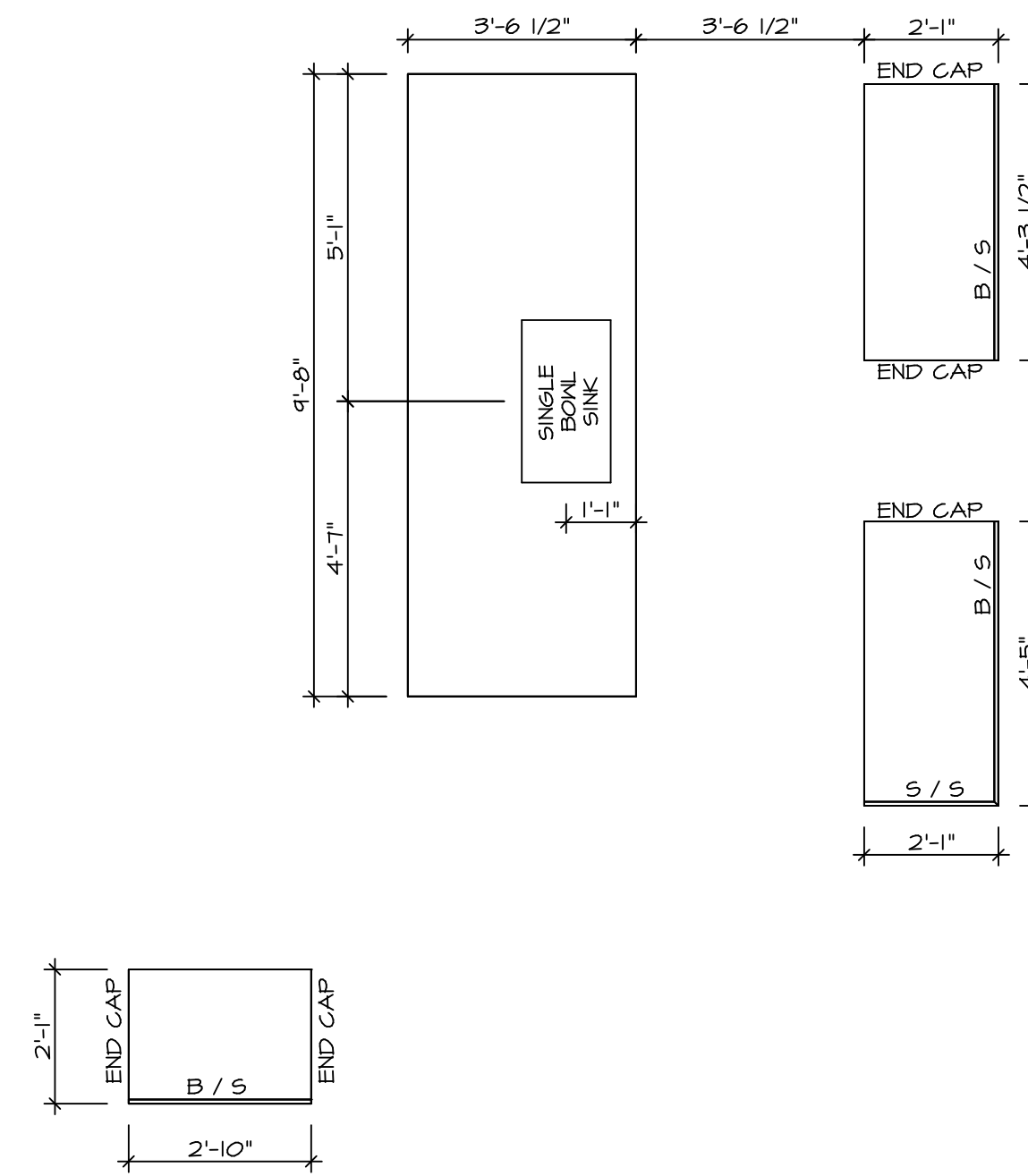

COUNTERTOP LAYOUT KC-3502
SCALE: 3/8" = 1'-0"

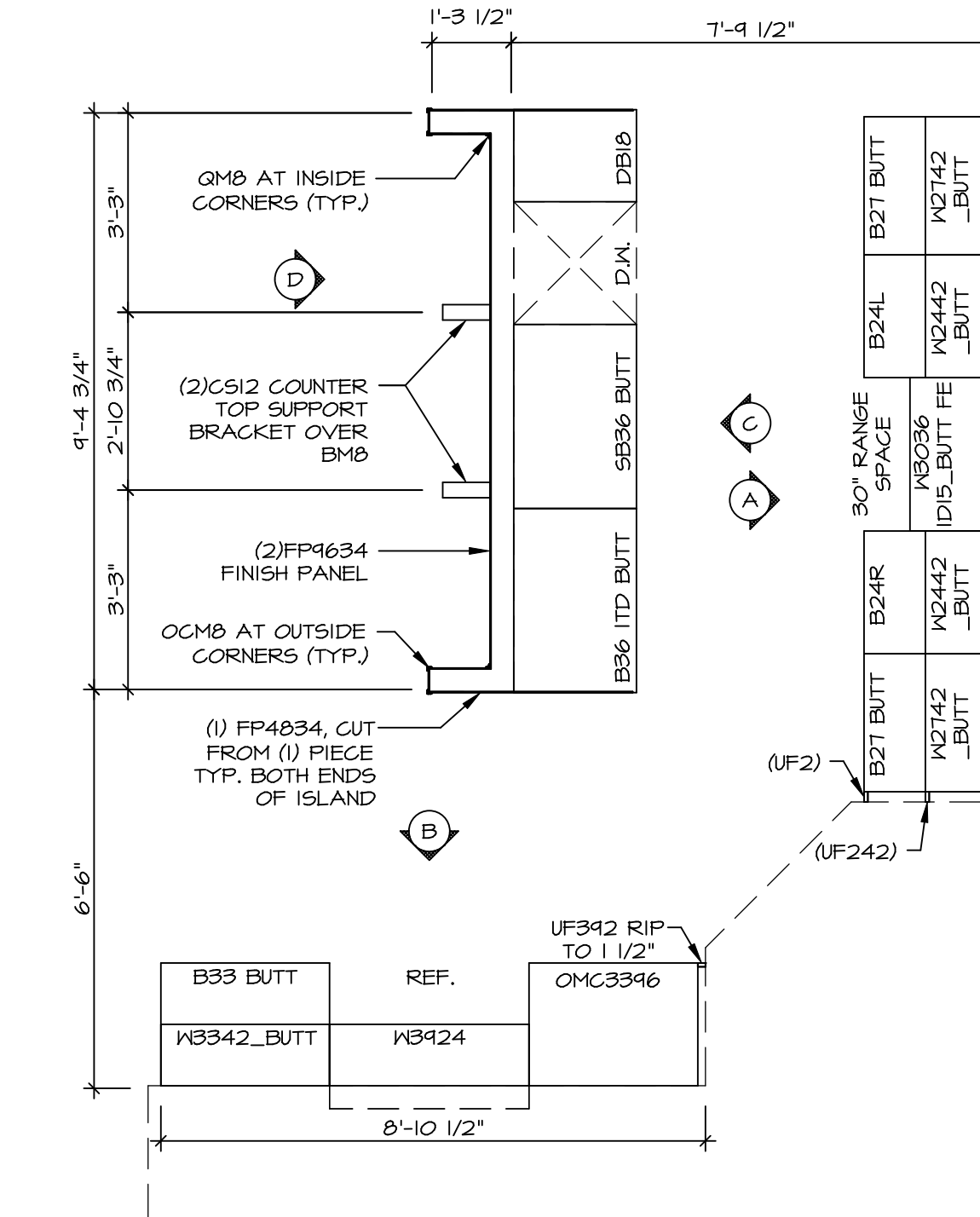

CABINET LAYOUT KC-3502
SCALE: 3/8" = 1'-0"

NOTE:
CABINET LAYOUT(S) ARE BASED ON FINISHED DIMENSION TO DRYWALL.

NOTE:
KITCHEN ELEVATIONS/PLANS CALL OUT STANDARD MOULDING. REFER TO DETAIL 11/KT-1 FOR REPLACEMENT BASED ON CABINET STYLE.

REMARKS

REV. NO. DATE

© NVR, Inc. expressly reserves the right to modify these plans without notice. These plans are not to be reproduced, changed or altered in any way without the written consent of NVR, Inc.



SET NO. LGHOO
VERSION 01
DRAWN BY
DATE:
OPTION

MODEL
LEHIGH
DRAWING TITLE
KITCHEN CABINET PLANS AND ELEVATIONS
OPTION DESCRIPTION

SHEET NO.
A-12
54

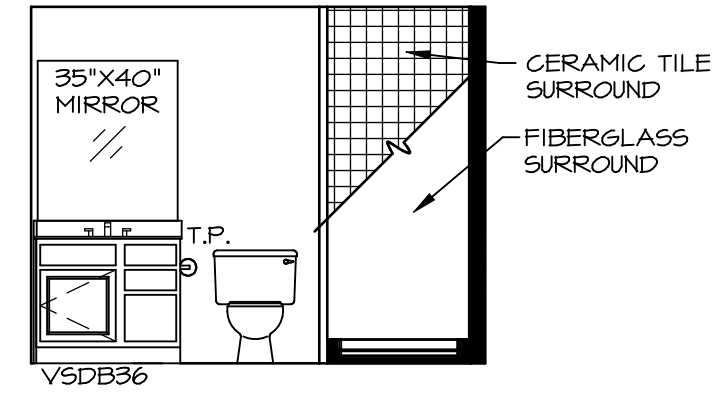

A BSMT BATH "AEB"
SCALE: 1/4" = 1'-0"

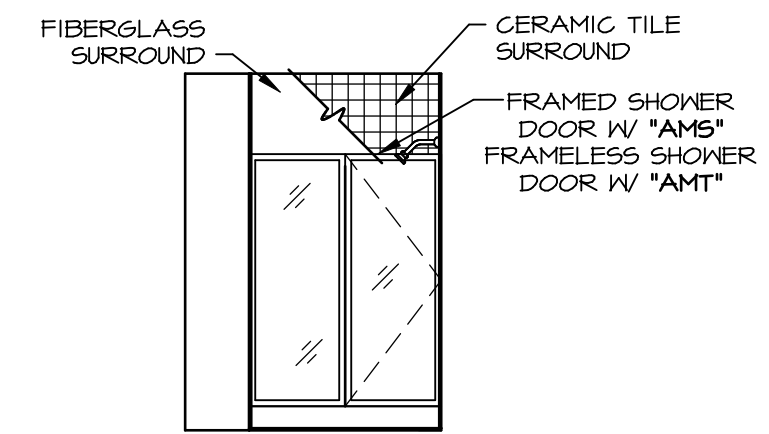

B BSMT BATH "AEB"
SCALE: 1/4" = 1'-0"

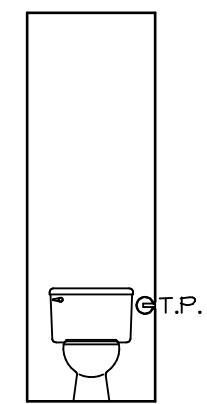

H OWNERS BATH
SCALE: 1/4" = 1'-0"

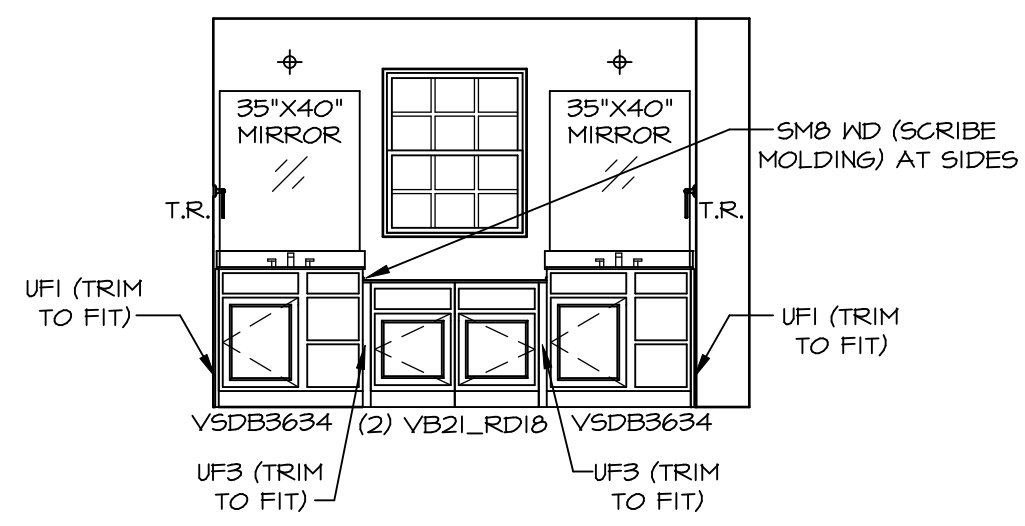

L OWNERS BATH
SCALE: 1/4" = 1'-0" OWNER'S BATHROOM
ROMAN SHOWER
"AM6"

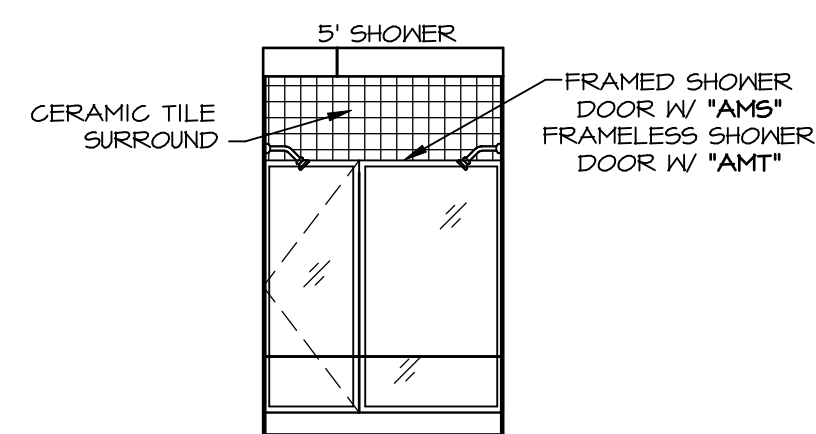

M OWNERS BATH
SCALE: 1/4" = 1'-0" OWNER'S BATHROOM
ROMAN SHOWER
"AM6"

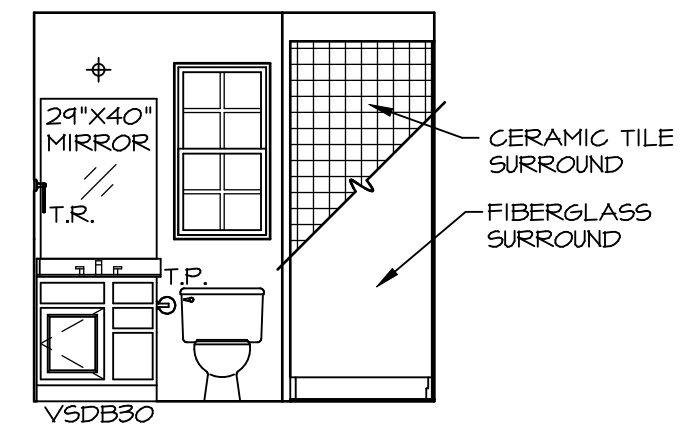

D FIRST FLOOR BATH
SCALE: 1/4" = 1'-0"

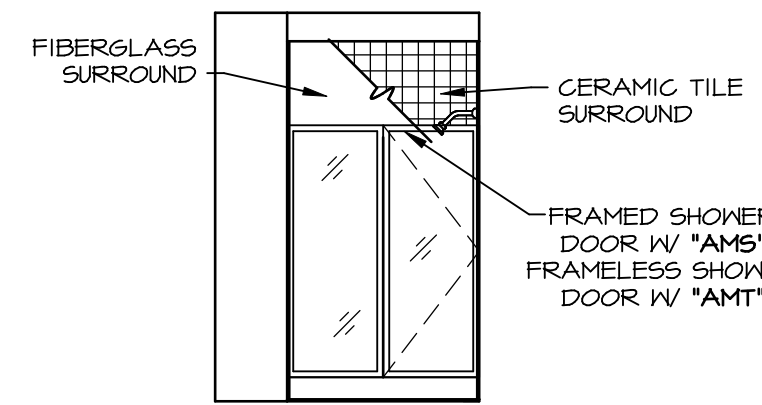

E FIRST FLOOR BATH
SCALE: 1/4" = 1'-0"

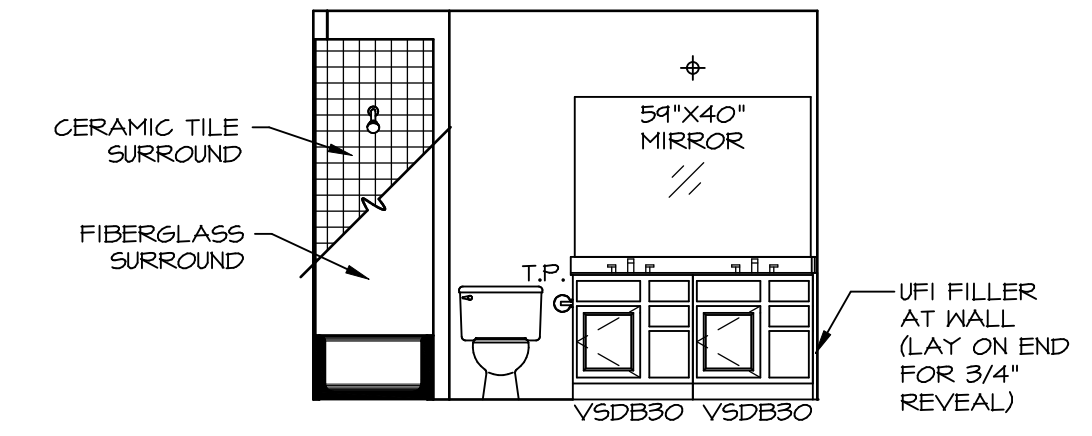

F BATH #1
SCALE: 1/4" = 1'-0"

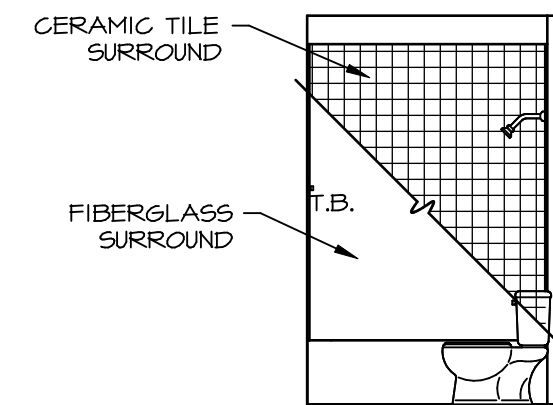

G BATH #1
SCALE: 1/4" = 1'-0"

NOTES:

- TEMPERED GLASS SHOWER ENCLOSURE WITH SWING DOOR OR OPTIONAL SLIDING DOOR BY DIVISION NEEDED, ALL MATERIALS BY DIVISION NEEDED, REFER TO SHEET IT-2 FOR TUB AND SHOWER DETAILS.
- ALL V5DB24-42 DRAWERS TO BE SET ON RIGHT HAND.
- ALL BATH ELEVATIONS ARE SHOWN PER PLAN.

| REV. NO. | DATE | REMARKS |
|----------|------|---------|
| | | |
| | | |
| | | |

NVR, Inc. expressly reserves the right to modify or change these plans without notice. These plans are not to be reproduced, changed or altered in any way without the written consent of NVR, Inc.

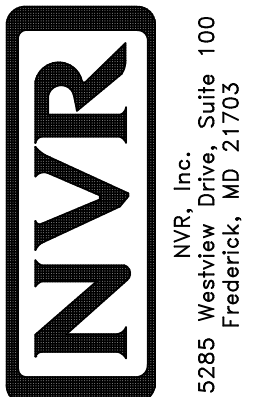

| | |
|--------------------|-----------------|
| MODEL | LEHIGH |
| DRAWING TITLE | BATH ELEVATIONS |
| OPTION DESCRIPTION | |