

**FIRST FLOOR PLAN**  
1,267' SCALE: 1/8"=1'-0"

○ = ROUNDED CORNERS

WINDOW SIZES & ROUGH OPENING DIMENSIONS GIVEN ARE BASED ON "SILVERLINE" VINYL WINDOWS

LOW "E" WINDOWS

CEILING HTS. ARE 9'-1 1/8", U.N.O.

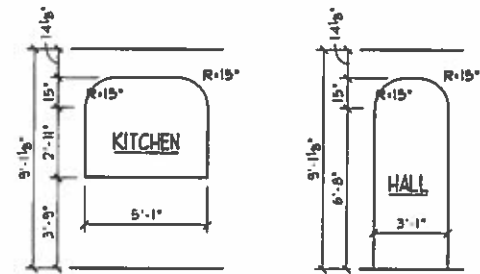

**ARCHED OPENING DETAILS**  
SCALE: 1/8"=1'-0"

**FLOOR PLAN GENERAL NOTES**

- S.D. = 110V SMOKE ALARMS UTILIZING PHOTOELECTRIC TO BE LOCATED OUTSIDE OF BEDROOMS & IONIZATION TECHNOLOGIES (SEPARATE OR DUAL-SENSING) TO BE LOCATED INSIDE OF BEDROOMS INTERCONNECTED W/ BATTERY BACKUP
- ROUGH FRAME HEADER HT. = EXT. WDW'S & DOORS TO BE 6'-0 1/2" (6'-11 1/2" = DOORS W/ TILE OR HOLID FLOORS) HEADER HT. = INTERIOR DOORS & OPENINGS TO BE 6'-11", U.N.O.
- HANDRAIL: WALL MOUNTED HANDRAILS TO BE 34"-38" ABOVE NOSING W/ ENDS RETURNED TO WALL.
- ALL TRUSS SPAN INDICATORS & GIRDER TRUSS LOCATIONS NOT SHOWN FOR PLAN CLARITY. TRUSSES TO BE DESIGNED FOR 24" O.C. W/ MINIMUM 175LB. UPLIFT FASTENERS. REFER TO TRUSS MANF. LAYOUT FOR SPANS & GIRDER TRUSS LOCATIONS. BEARING POINT REQUIREMENTS FOR GIRDERS ARE TYPICALLY (1) STUD FOR EACH "PLY". IF SPECIAL CONDITIONS EXIST TRUSS MANF. TO CALL OUT BEARING REQUIREMENT ON TRUSS FRAMING LAYOUT.
- HEADERS/BEAMS NOTED ON PLAN TO HAVE MIN. OF 3 1/2"x1 1/2" SOLID WOOD BEARING TO TOP OF FOUNDATION OR BASEMENT BEAM = EACH END, UNLESS NOTED OTHERWISE.
- PROVIDE 36" MIN. CLEAR AISLE = ALL CABINETS, ISLANDS, & PENINSULAS
- ILLUMINATION TO BE PROVIDED AT ALL INTERIOR/EXTERIOR STAIRWAYS.
- ALL WALLS TO BE GLUED TO SUBFLOOR.
- FIREPLACE TO BE PREFAB HTL. DIRECT VENT GAS FIREBOX (SEALED UNIT) W/ COMB. AIR INTAKE FROM EXT. INSTALL PER MANF. SPEC'S. PROVIDE SAFETY COVER = EXHAUST TERMINATION.
- EXTERIOR LANDINGS: 3'x3' LANDING WITHIN 8 1/2" OF THE TOP OF THE THRESHOLD = FRONT DOOR. 3'x3' LANDING/DECK WITHIN 16 1/2" OF THRESHOLD = REAR/SIDE DOORS
- HALF-WALLS TO BE 36" HIGH (45") = KITCHENS) W/ WOOD CAP UNLESS NOTED OTHERWISE.
- PROGRAMMABLE TYPE THERMOSTAT TO BE INSTALLED.
- CO = CARBON MONOXIDE ALARM COMPLYING W/ U.L. 2034 SHALL BE INSTALLED OUTSIDE OF EACH SEPARATE SLEEPING AREA IN THE IMMEDIATE VICINITY OF THE BEDROOMS.

DATE: 08/08/17  
REV.: 08/24/17  
DRAWN BY: S.W.R.

SCALE: 1/8"=1'-0"

**Superior Designers**  
6152 Pittman Lane  
Fairfield, Ohio 45014  
Phone: (513) 839-0035  
SuperiorDesigners@fuse.net



PROPOSED RESIDENCE FOR:  
LENA DUBLIN  
#16 Arnold Drive  
Village of Woodlawn, Lot# 16

Elevation J - Basement



PHH1267  
Potterhill Homes reserves all property rights in these plans. These plans are not to be reproduced, changed, or copied in any manner. They are not to be given to a third party, either in full or in part, without first receiving written permission from Potterhill Homes. In the event these plans are used by a third party, Potterhill Homes shall be held harmless.

A4

DATE: 08/08/17  
 REV: 08/24/17  
 DRAWN BY: S.W.R.  
 SCALE: 1/8" = 1'-0"

**Superior Designs**  
 6152 Princeton Lane  
 Fairfield, Ohio 45014  
 Phone: (513) 939-0035  
 SuperiorDesigns@fuse.net  
 JOB #: VW16

PROPOSED RESIDENCE FOR:  
**LENA DUBLIN**  
 #16 Arnold Drive  
 Woodlawn, OH 45215  
 Village of Woodlawn, Lot# 16  
 Elevation J - Basement

**Potterhill Homes**  
 5400 Dupont Circle, Suite J  
 Milford, Ohio 45150  
 513-575-7906

**PHH1267**  
 Potterhill Homes reserves all property rights in these plans. These plans are not to be reproduced, changed, or copied in any manner. They are not to be given to a third party, either in full or in part, without first receiving written permission from Potterhill Homes. In the event these plans are used by a third party, Potterhill Homes shall be held harmless.

**B1**

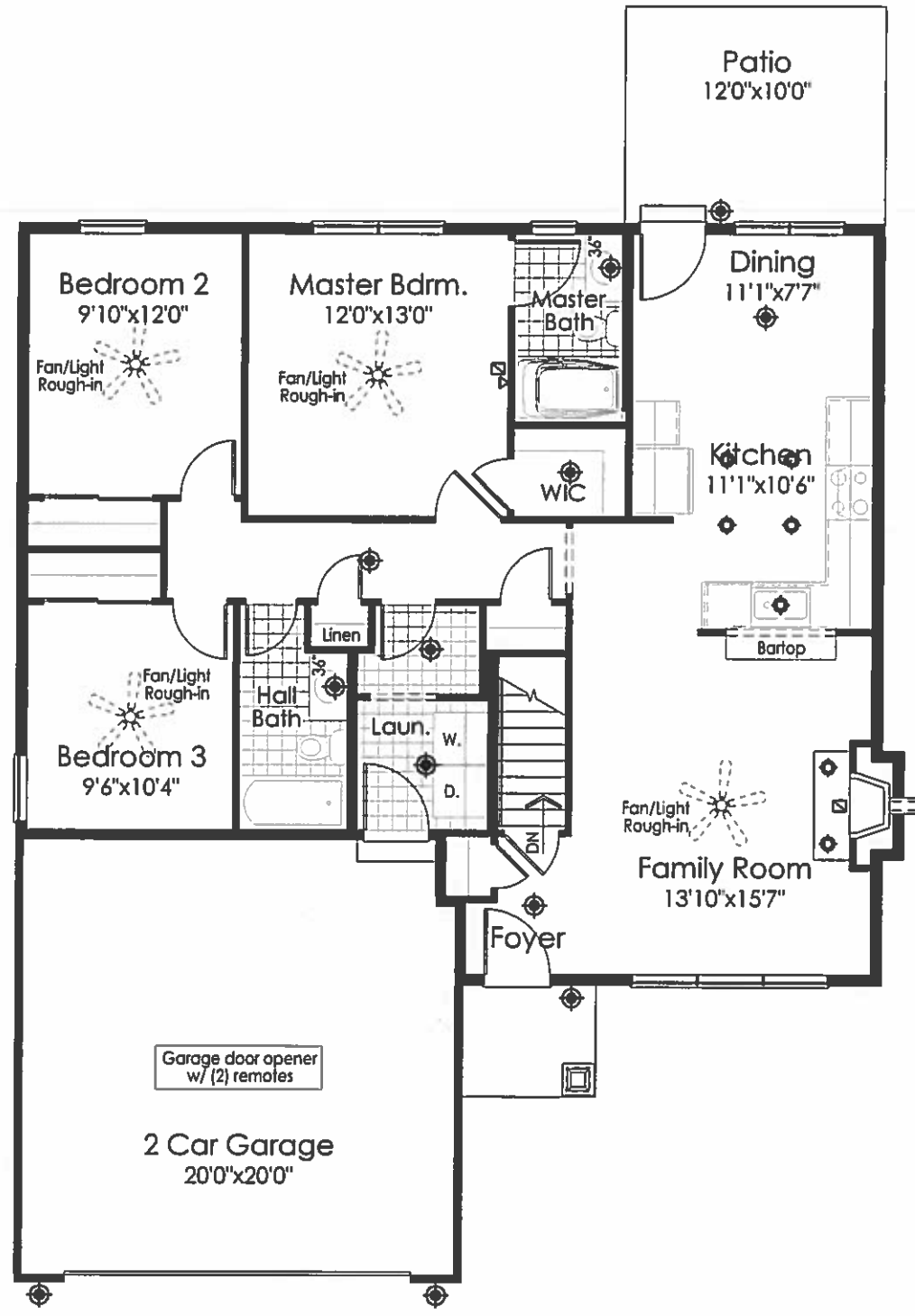

**First Floor Plan**  
 ⊙ = LIGHT FIXTURE LOCATION

ELECTRICAL SYMBOLS	
⊙	LIGHT
⊙	CAN LIGHT
⌞	TRACK LIGHT
—	UNDER CABINET LIGHT
⊕	STANDARD 110V OUTLET
◆	PENDANT LIGHT
◁	PHONE/FAX JACK
⊠	CABLE JACK

Garage door opener  
 w/ (2) remotes