

WI 227
3494 DARCIÉ DR
FRANKLIN, OH 45005

2 Story Basement

Finished basement and full bath

2 hose bibs - valves required

AA valve on kitchen sink

ice maker

1 tub

2 shower

1 soaker

laundry tub

WATER HEATER ELECTRIC 50 GALLON WITH MIXING VALVE

Gas Furnace and Range

NOTE
 RADON REMEDIATION
 RADON LOOP:
 - (4") PERFORATED HDPE "LOOP"
 - MUST BE PLACED IN STONE BED SLIGHTLY HIGHER THAN ANY INTERIOR DRAINTILE
 - LOOP TO BE SEPARATE FROM ANY DRAINTILE ELEMENTS
 - TO BE CORRUGATED HDPE PIPE
 - SCREENS TO BE INSTALLED THROUGH LOOP AT TEE UP INTO STACK
 STACK REQUIREMENTS:
 - 3" PVC STACK (4" IF BASEMENT IS GREATER THAN 2200 SQFT)
 - NO PART OF STACK IS TO BE HORIZONTAL
 - PIPE TO BE PHYSICALLY LABELED IN THE FIELD AS "RADON VENT" OR OTHER JURISDICTIONALLY REQUIRED LANGUAGE (ON EVERY LEVEL OF HOUSE)
 - ROOF TERMINATION TO BE IN TOP 1/3 OF ROOF
 - SCREEN INSTALLED TO KEEP PESTS OUT OF RADON VENT AT ROOF TERMINATION

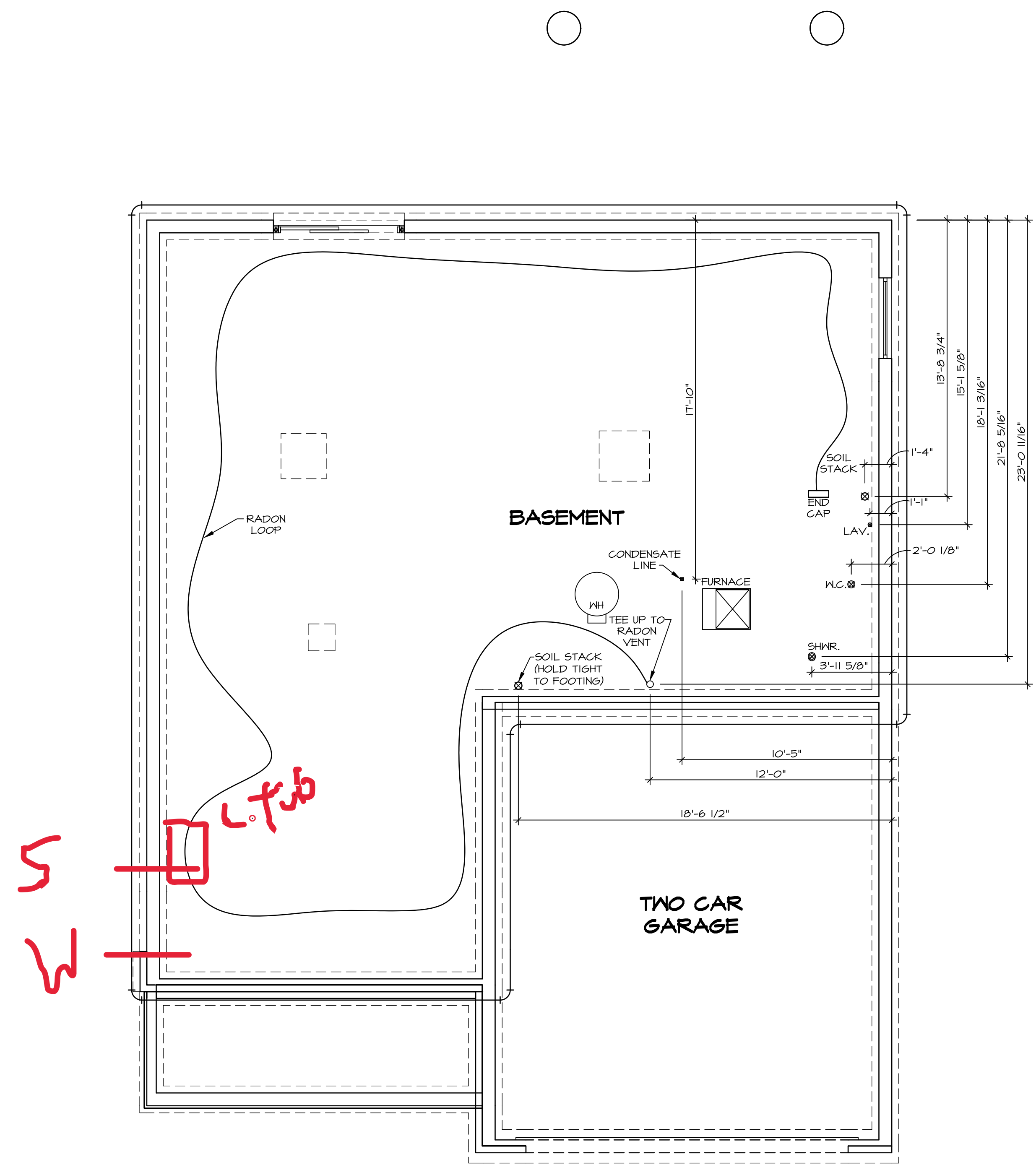

PLUMBING PLAN
 SCALE: 1/4" = 1'-0"

SHEET NO. A-5	MODEL COLUMBIA	SET NO. CLM00	DIV-COMM-LOT-UNIT DCY-WI-0227
	DRAWING TITLE PLUMBING GROUNDWORKS	VERSION 01 RELEASE NO. ---- DRAWN BY JAB DATE: OPTION	
12	OPTION DESCRIPTION	5285 Westview, Suite 100 Frederick, MD 21703	APT. NO. ---- STATE OH ZIP 45005

LEGEND

- BEARING WALL
- NON BEARING WALL
- INDICATES BEARING FROM POINT-LOAD ABOVE
- JACKS
- BEAM/HEADER
- PAD FOOTING
- STEEL COLUMN
- PORTAL FRAME
- JOIST/TRUSS
- LVL
- ENGINEERING PAGE NUMBER

SEE FC DETAILS FOR FRAMING CONNECTORS

- FLOOR PLAN NOTES**
1. ALL HEADERS ARE (2) 2x6 w/ 2x4 WALLS OR (3) 2x6 w/ 2x6 WALLS, UNLESS OTHERWISE NOTED.
 2. ALL HEADERS TO HAVE (1) 2x4 OR 2x6 JACK AND KING STUD EACH END, UNLESS OTHERWISE NOTED.
 3. ALL EXTERIOR WALLS TO BE 4" w/ OSB OR 3 1/2" w/ T-PLY, ALL INTERIOR WALLS TO BE 3 1/2", UNLESS OTHERWISE NOTED.
 4. HATCHED AREAS INDICATE DROPPED CEILINGS. ALL DROPPED CEILINGS ARE 12" UNLESS OTHERWISE NOTED.
 5. SEE "BRACED WALL PANEL DETAIL SHEET" FOR SPECIAL WALL FRAMING LOCATIONS AND HEADER SIZES, IF APPLICABLE.
 6. SEE STANDARD DETAIL CATEGORY "IT" SHEET(S) FOR INTERIOR TRIM DETAILS.
 7. SEE ARCHITECTURAL DETAIL SHEET "AD" FOR HOUSE SPECIFIC INTERIOR TRIM OPTION TABLE.
 8. ALL WINDOWS HAVE T-O 1/2" HEADER HEIGHT UNLESS OTHERWISE NOTED.
 9. ALL HEADERS IN NON-BEARING WALLS SHALL BE A SINGLE FLAT 2x4 OR 2x6 ATTACHED TO GRIFFLES ABOVE, UNLESS OTHERWISE NOTED.
 10. TANKED WATER HEATER SHOWN AS BASE CONDITION, OPTIONAL TANKLESS WATER HEATER IS AVAILABLE IN LIEU OF TANKED WATER HEATER.

GYPSON NOTES

AT GARAGE:
GYPSUM BOARD AT COMMON WALLS, CEILINGS, BEAM WRAPS AND SUPPORTS PER STANDARD DETAIL FA-1(b) FIRE ASSEMBLIES OR AS REQUIRED BY LOCAL CODE.

AT STAIRS:
1/2" GYPSUM BOARD AT UNDERSIDE OF STAIRS AND WALLS IN CLOSET

BASEMENT JACK SCHEDULE

IDENTIFIER	DESCRIPTION	OPTIONS	ENG. NUM.	REMARKS
J001	JACK - (2) 2X4 SFF STUD GRADE	FBA	BO031	

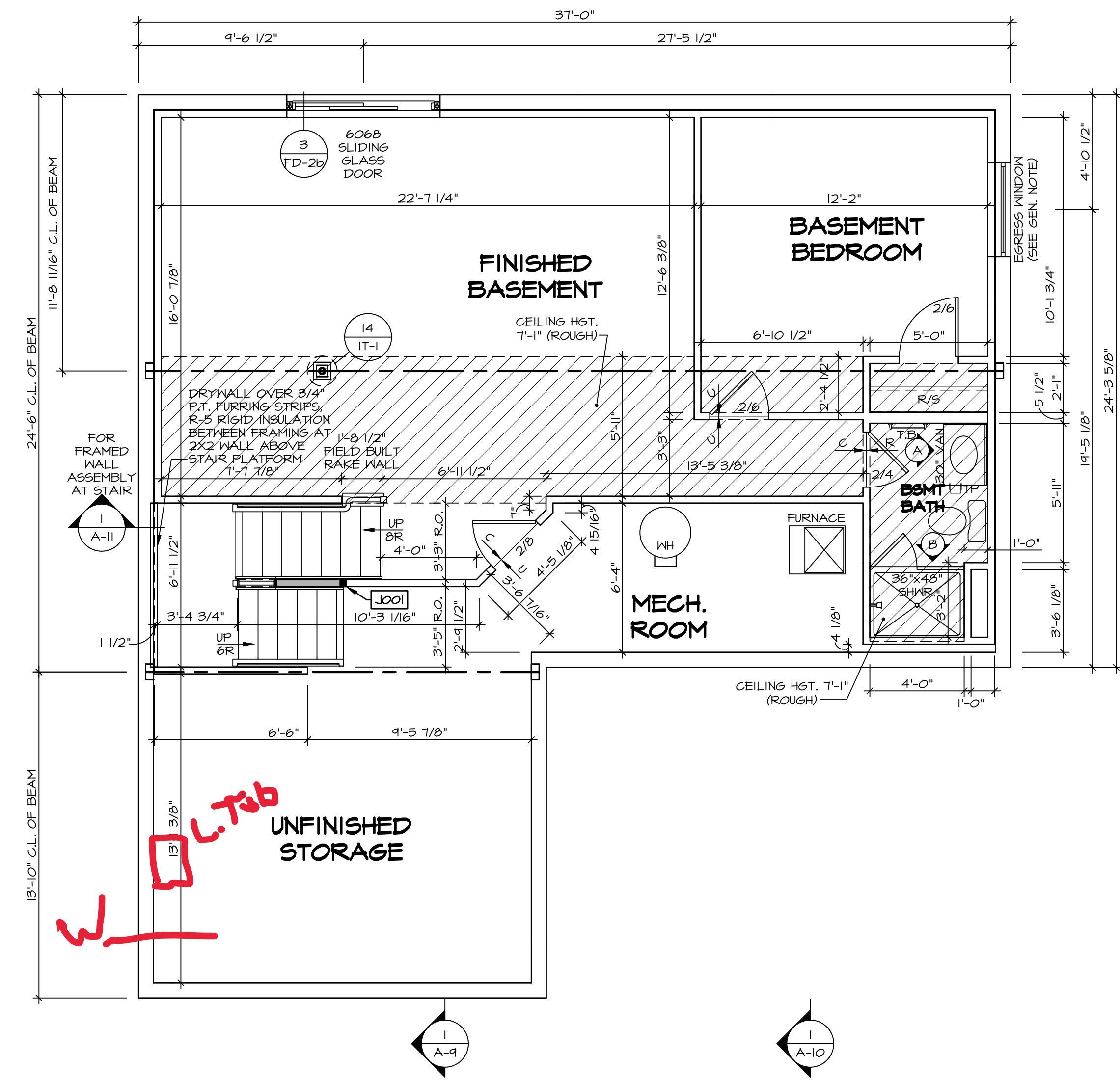

1
A-6
SCALE: 1/4" = 1'-0"

BASEMENT FLOOR PLAN

© NVR, Inc., expressly reserves its copyright and other property rights in these plans. These plans are not to be reproduced, stored in a retrieval system, or transmitted in any form or by any means, electronic, mechanical, photocopying, recording, or otherwise, without the prior written consent of NVR, Inc.



SET NO. CLM00
VERSION 01
RELEASE NO. ----
DRAWN BY CVB
DATE:
OPTION FBA

MODEL COLUMBIA
DRAWING TITLE BASEMENT FLOOR PLAN
OPTION DESCRIPTION BASEMENT FOUNDATION

SHEET NO. A-6
13

DIV-COMM-LOT-UNIT
DCY-WI-0227
COM-Lot
MILSON FARMS - 0227
STREET ADDRESS
9484 DARGIE DR
CITY FRANKLIN
STATE OH
ZIP 45005

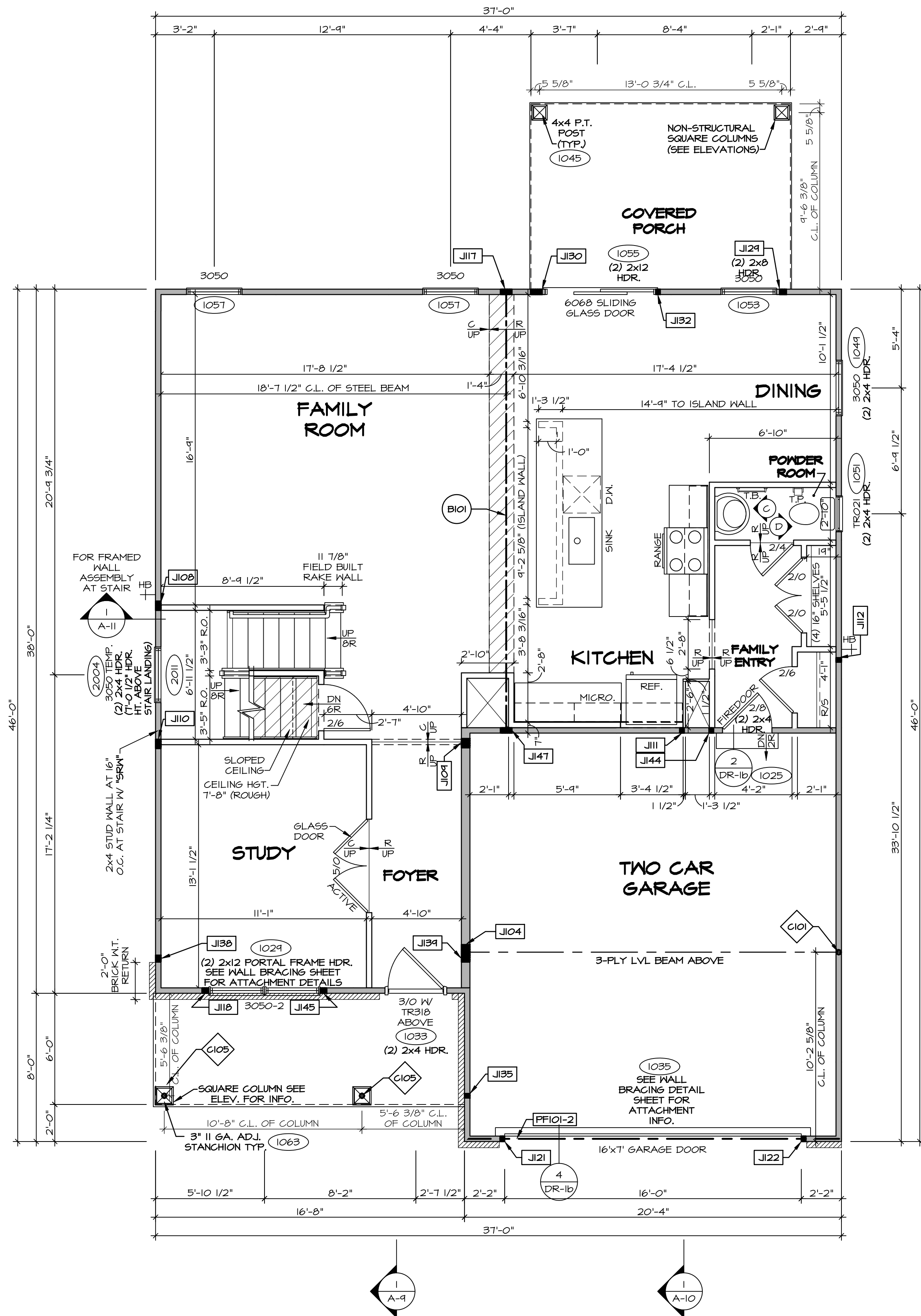

FIRST FLOOR PLAN
SCALE: 1/4" = 1'-0"

LEGEND

- BEARING WALL
- NON BEARING WALL
- INDICATES BEARING FROM POINT-LOAD ABOVE
- JACKS
- BEAM/HEADER
- PAD FOOTING
- STEEL COLUMN
- PORTAL FRAME
- JOIST/TRUSS
- LVL
- ENGINEERING PAGE NUMBER

SEE FC DETAILS FOR FRAMING CONNECTORS

- FLOOR PLAN NOTES**
- ALL HEADERS ARE (2) 2x6 w/ 2x4 WALLS OR (3) 2x6 w/ 2x6 WALLS, UNLESS OTHERWISE NOTED.
 - ALL HEADERS TO HAVE (1) 2x4 OR 2x6 JACK AND KING STUD EACH END, UNLESS OTHERWISE NOTED.
 - ALL EXTERIOR WALLS TO BE 4" w/ OSB OR 3 1/2" w/ T-PLY. ALL INTERIOR WALLS TO BE 3 1/2", UNLESS OTHERWISE NOTED.
 - HATCHED AREAS INDICATE DROPPED CEILINGS. ALL DROPPED CEILINGS ARE 12" UNLESS OTHERWISE NOTED. SEE BRACED WALL PANEL DETAIL SHEET FOR SPECIAL WALL FRAMING LOCATIONS AND HEADER SIZES, IF APPLICABLE.
 - SEE STANDARD DETAIL CATEGORY "IT" SHEET(S) FOR INTERIOR TRIM DETAILS.
 - SEE ARCHITECTURAL DETAIL SHEET "AD" FOR HOUSE SPECIFIC INTERIOR TRIM OPTION TABLE.
 - ALL WINDOWS HAVE 7'-0 1/2" HEADER HEIGHT UNLESS OTHERWISE NOTED.
 - ALL HEADERS IN NON-BEARING WALLS SHALL BE A SINGLE FLAT 2x4 OR 2x6 ATTACHED TO GRIFFLES ABOVE, UNLESS OTHERWISE NOTED.
 - TANKED WATER HEATER SHOWN AS BASE CONDITION. OPTIONAL TANKLESS WATER HEATER IS AVAILABLE IN LIEU OF TANKED WATER HEATER.

- GYPSUM NOTES**
- AT GARAGE:
GYPSUM BOARD AT COMMON WALLS, CEILINGS, BEAM WRAPS AND SUPPORTS PER STANDARD DETAIL FA-1(b) FIRE ASSEMBLIES OR AS REQUIRED BY LOCAL CODE.
- AT STAIRS:
1/2" GYPSUM BOARD AT UNDERSIDE OF STAIRS AND WALLS IN CLOSET

NOTE:
EXTERIOR WALLS DRAWN TO FRAMING WIDTH. EXTERIOR SHEATHING IS NOT INCLUDED IN WALL THICKNESS.

- LVL PLY TO PLY FASTENING SCHEDULE:** (WHERE APPLICABLE BASED ON LVL USAGE)
- (2) PLY UP TO AND INCLUDING 11 7/8" TALL; FASTEN PLYS W/ (2) ROWS 16D NAILS AT 12" O.C. OR ALT 1 1/2" WIDE LVL FASTEN PLYS W/ (3) ROWS 12D NAILS AT 12" O.C.
 - (2) PLY 14" TO AND 18" TALL (INCLUSIVE); FASTEN PLYS W/ (3) ROWS 16D NAILS AT 12" O.C. OR ALT 1 1/2" WIDE LVL FASTEN PLYS W/ (4) ROWS 12D NAILS AT 12" O.C.
 - (2) PLY 20" TALL AND OVER; FASTEN PLYS W/ (4) ROWS 16D NAILS AT 12" O.C. OR ALT 1 1/2" WIDE LVL FASTEN PLYS W/ (5) ROWS 12D NAILS AT 12" O.C.
 - (3) PLY UP TO AND INCLUDING 11 7/8" TALL; FASTEN PLYS W/ (2) ROWS 16D NAILS AT 12" O.C. FROM EACH SIDE OR ALT 1 1/2" WIDE LVL FASTEN PLYS W/ (3) ROWS 12D NAILS AT 12" O.C. FROM EACH SIDE.
 - (3) PLY 14" TO AND 18" TALL (INCLUSIVE); FASTEN PLYS W/ (3) ROWS 16D NAILS AT 12" O.C. FROM EACH SIDE OR ALT 1 1/2" WIDE LVL FASTEN PLYS W/ (4) ROWS 12D NAILS AT 12" O.C. FROM EACH SIDE.
 - (3) PLY 20" TALL AND OVER; FASTEN PLYS W/ (4) ROWS 16D NAILS AT 12" O.C. FROM EACH SIDE OR ALT 1 1/2" WIDE LVL FASTEN PLYS W/ (5) ROWS 12D NAILS AT 12" O.C. FROM EACH SIDE.
- T.A. - (4) PLY (ALL SIZES); FASTEN PLYS W/ (2) ROWS 1/2" DIA 307 BOLTS AT 24" O.C. SEE SHOP DRAWING FOR ADDITIONAL INFORMATION.

FIELD INSTALLED FIRST FLOOR BEAM/HEADER SCHEDULE

IDENTIFIER	DESCRIPTION	LENGTH	OPTIONS	ENG. NUM.	REMARKS
B101	BEAM STEEL - W12X30 W 2X6 SILL	23'-10 3/4"	6CB/ 6CF	1023	
PF101-2	LVL 1.75 - 11-04	20'-1"	6CB/ 6CF	1035	

STEEL COLUMN SCHEDULE

IDENTIFIER	STYLE	HEIGHT	OPTIONS	ENG. NUM.	REMARKS
C101	STANCHION - 3 IN SCHED 40	9'-6"	6CB/ 6CF, ELB/ ELL, SXC, FBA/ FCA, SZL	1006	
C105	STANCHION PORCH - 3 IN DIA 116A ADJ.	9'-4 7/8"	FBA	1063	

FIRST FLOOR JACK SCHEDULE

IDENTIFIER	DESCRIPTION	OPTIONS	ENG. NUM.	REMARKS
J104	JACK - (5) 2X6 SPF STUD GRADE	SXC, ELB/ ELL, SZL	1006	
J108	JACK - (4) 2X4 SPF STUD GRADE		1014	
J109	JACK - (4) 2X6 SPF STUD GRADE		1016	
J110	JACK - (4) 2X4 SPF STUD GRADE		1016	
J111	JACK - (2) 2X4 SPF STUD GRADE		1018	
J112	JACK - (2) 2X4 SPF STUD GRADE		1020	
J117	JACK - (5) 2X4 SPH		1023	
J118	JACK - (3) 2X4 SPF STUD GRADE		1021	
J121	JACK - (2) 2X4 SPF STUD GRADE	6CB/ 6CF	1035	
J122	JACK - (2) 2X4 SPF STUD GRADE	6CB/ 6CF	1035	
J129	JACK - (3) 2X4 SPF STUD GRADE	EPE	1045, 1053	
J130	JACK - (5) 2X4 SPF STUD GRADE	EPE	1045, 1055	
J132	JACK - (2) 2X4 SPF STUD GRADE		1055	
J135	JACK - (2) 2X4 SPF STUD GRADE		1063	
J138	JACK - (3) 2X4 SPH	ELB/ ELL	2010	
J139	JACK - (3) 2X6 SPF STUD GRADE	ELB/ ELL	2010	
J144	JACK - (2) 2X4 SPF STUD GRADE		1018	
J145	JACK - (3) 2X4 SPF STUD GRADE		1021	
J147	JACK - (5) 2X4 SPH		1023	

DIV-COMM-LOT-UNIT
DCY-WI-0227
COM-Lot
MILSON FARMS - 0227
STREET ADDRESS
9484 DARGIE DR
CITY
FRANKLIN
STATE
OH
ZIP
45005

NVR, Inc. expressly reserves its copyright and other property rights in these plans. These plans are not to be copied, reproduced, or otherwise used in any form or manner whatsoever, nor are they to be used for any project without the prior written consent of NVR, Inc.

NVR
NVR, Inc., Suite 100
5285 Westwick, Frederick, MD 21703

SHEET NO. MODEL
COLUMBIA
DRAWING TITLE
FIRST FLOOR PLAN
OPTION DESCRIPTION
14

SET NO. CLM00
VERSION 01
RELEASE NO. ----
DRAWN BY ARM
DATE:
OPTION

SET NO. CLM00
VERSION 01
RELEASE NO. ----
DRAWN BY ARM
DATE:
OPTION

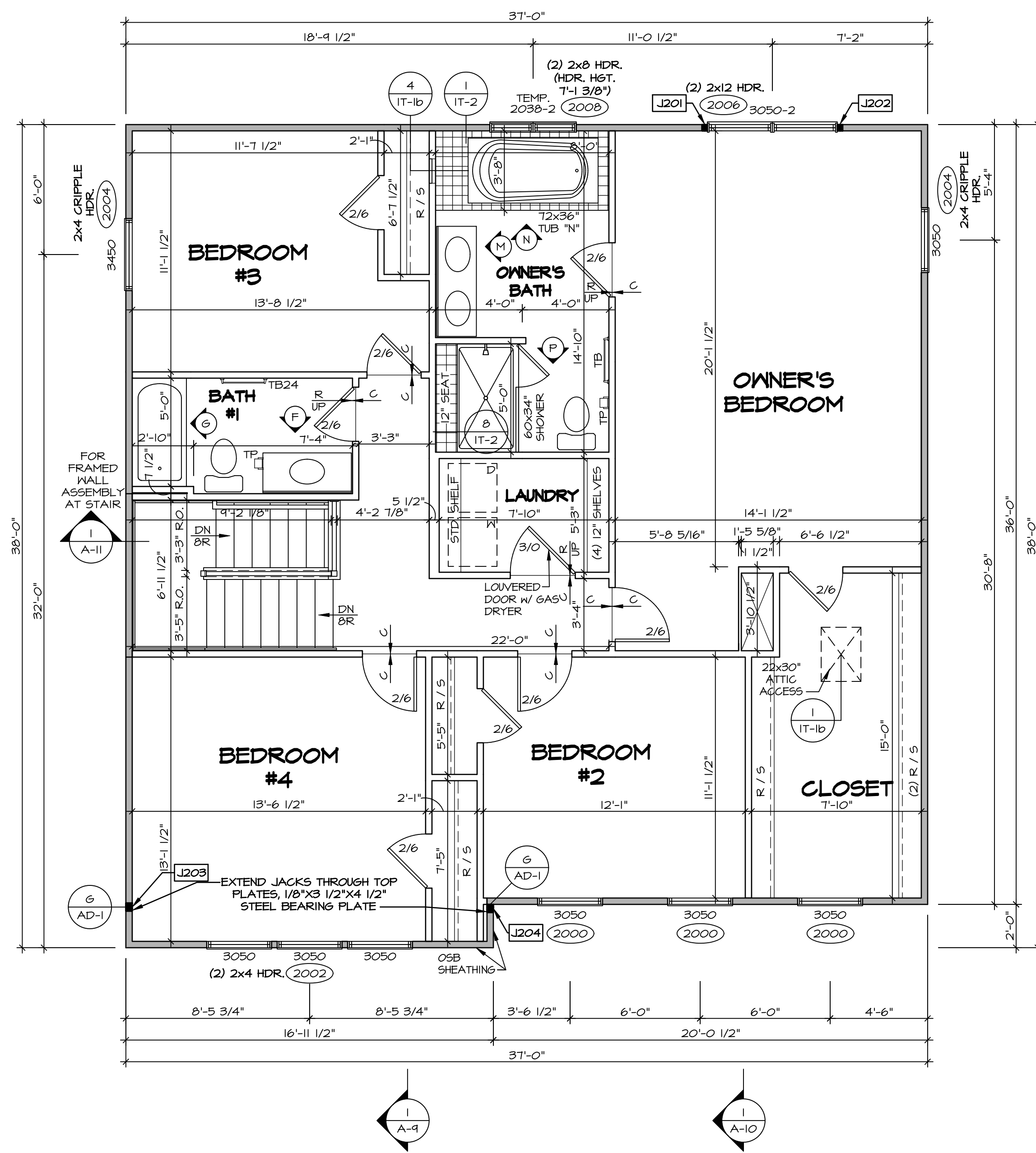

SECOND FLOOR PLAN
SCALE: 1/4" = 1'-0"

- LEGEND**
- BEARING WALL
 - NON BEARING WALL
 - INDICATES BEARING FROM POINT-LOAD ABOVE
 - JACKS
 - BEAM/HEADER
 - PAD FOOTING
 - STEEL COLUMN
 - PORTAL FRAME
 - JOIST/TRUSS
 - LVL
 - ENGINEERING PAGE NUMBER
- SEE FC DETAILS FOR FRAMING CONNECTORS

NOTE:
EXTERIOR WALLS DRAWN TO FRAMING WIDTH, EXTERIOR SHEATHING IS NOT INCLUDED IN WALL THICKNESS.

- FLOOR PLAN NOTES**
- ALL HEADERS ARE (2) 2x6 w/ 2x4 WALLS OR (3) 2x6 w/ 2x6 WALLS, UNLESS OTHERWISE NOTED.
 - ALL HEADERS TO HAVE (1) 2x4 OR 2x6 JACK AND KING STUD EACH END, UNLESS OTHERWISE NOTED.
 - ALL EXTERIOR WALLS TO BE 4" w/ OSB OR 3 1/2" w/ T-PLY, ALL INTERIOR WALLS TO BE 3 1/2", UNLESS OTHERWISE NOTED.
 - HATCHED AREAS INDICATE DROPPED CEILING. ALL DROPPED CEILING ARE 12" UNLESS OTHERWISE NOTED.
 - SEE "BRACED WALL PANEL DETAIL SHEET" FOR SPECIAL WALL FRAMING LOCATIONS AND HEADER SIZES, IF APPLICABLE.
 - SEE STANDARD DETAIL CATEGORY "IT" SHEET(S) FOR INTERIOR TRIM DETAILS.
 - SEE ARCHITECTURAL DETAIL SHEET "AD" FOR HOUSE SPECIFIC INTERIOR TRIM OPTION TABLE.
 - ALL WINDOWS HAVE T-O 1/2" HEADER HEIGHT UNLESS OTHERWISE NOTED.
 - ALL HEADERS IN NON-BEARING WALLS SHALL BE A SINGLE FLAT 2X4 OR 2X6 ATTACHED TO CRIPPLES ABOVE, UNLESS OTHERWISE NOTED.
 - TANKED WATER HEATER SHOWN AS BASE CONDITION, OPTIONAL TANKLESS WATER HEATER IS AVAILABLE IN LIEU OF TANKED WATER HEATER.

GYPSUM NOTES

AT GARAGE:
GYPSUM BOARD AT COMMON WALLS, CEILING, BEAM WRAPS AND SUPPORTS PER STANDARD DETAIL FA-1(b) FIRE ASSEMBLIES OR AS REQUIRED BY LOCAL CODE.

AT STAIRS:
1/2" GYPSUM BOARD AT UNDERSIDE OF STAIRS AND WALLS IN CLOSET

SECOND FLOOR JACK SCHEDULE

IDENTIFIER	DESCRIPTION	OPTIONS	ENG. NUM.	REMARKS
J201	JACK - (2) 2X4 SPF STUD GRADE		2006	
J202	JACK - (2) 2X4 SPF STUD GRADE		2006	
J203	JACK - (3) 2X4 SP#1	ELB/ ELL	2010	
J204	JACK - (3) 2X4 SP#1	ELB/ ELL	2010	

DIV-COMM-LOT-UNIT
DCY-WI-0227

COM-Lot
MILSON FARMS - 0227

STREET ADDRESS
9444 DARGIE DR

CITY
FRANKLIN

STATE
OH

ZIP
45005

© NVR, Inc., expressly reserves its copyright and other property rights in these plans. These plans are not to be reproduced, stored in a retrieval system, copied in any form or manner whatsoever, nor are they to be transmitted in any form or by any means, electronic, mechanical, photocopying, recording, or by any information storage and retrieval system, without the prior written consent of NVR, Inc.

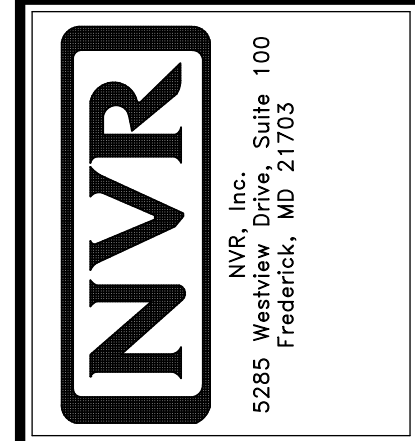

SET NO. CLM00
VERSION 01
RELEASE NO. ----
DRAWN BY ARM
DATE:
OPTION

SHEET NO.
A-8

MODEL
COLUMBIA

DRAWING TITLE
SECOND FLOOR PLAN

OPTION DESCRIPTION
15

- NOTES:**
1. TEMPERED GLASS SHOWER ENCLOSURE WITH SWING DOOR OR OPTIONAL SLIDING DOOR BY DIVISION
 2. TUB ACCESS PANELS PROVIDED AS NEEDED, ALL MATERIALS BY DIVISION
 3. REFER TO SHEET IT-2 FOR TUB AND SHOWER DETAILS.
 4. ALL VANITIES WITH DRAWERS TO BE SET WITH DRAWERS ON RIGHT HAND SIDE.
 5. BATH ELEVATIONS ARE SHOWN PER PLAN.
 6. ALL DIMENSIONS SHOWN ON BATH ELEVATIONS ARE ROUGH FRAMING REFERENCES ONLY.

DIV-COMM-LOT-UNIT
DCY-WI-0227
 COMM-LOT
 MILLSON FARMS - 0227
 STREET ADDRESS
 9444 DARGIE DR
 CITY STATE ZIP
 FRANKLIN OH 45005

© NVR, Inc., expressly reserves its copyright and other property rights in these plans. These plans are not to be reproduced, stored in a retrieval system, copied in any form or manner whatsoever, nor are they to be used for any project without the prior written consent of NVR, Inc.

NVR
 NVR, Inc., Suite 100
 Frederick, MD 21703
 5285 Westrick Rd

SET NO. CLM00
 VERSION 01
 RELEASE NO. ----
 DRAWN BY ARM
 DATE:
 OPTION

SHEET NO. **A-13**
 MODEL **COLUMBIA**
 DRAWING TITLE **BATH ELEVATIONS**
 OPTION DESCRIPTION
 20

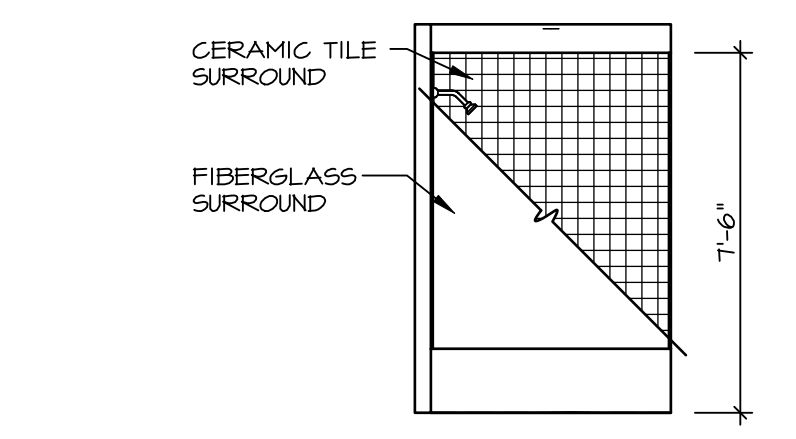

G BATH #1
 SCALE: 1/4" = 1'-0"

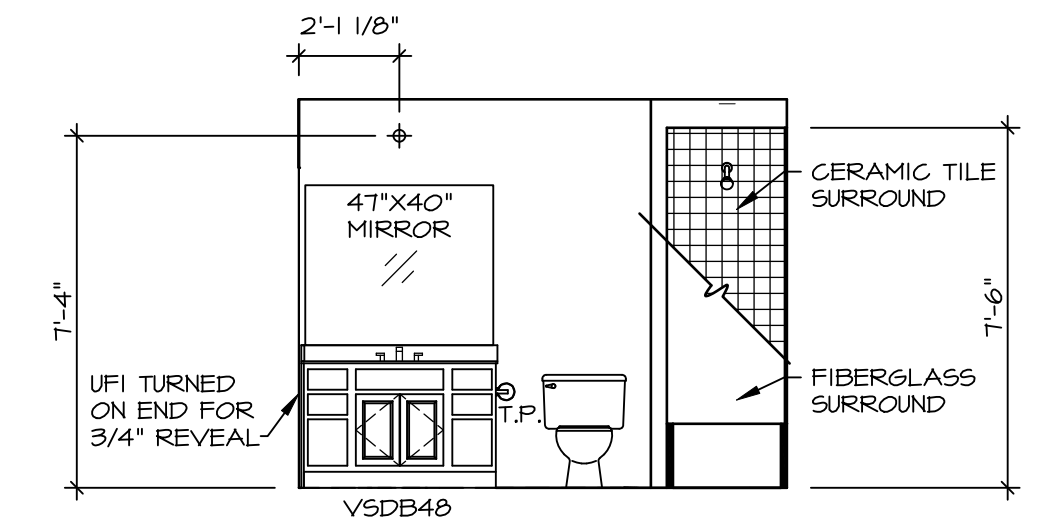

F BATH #1
 SCALE: 1/4" = 1'-0"
 SINGLE BOWL VANITY "VVC"

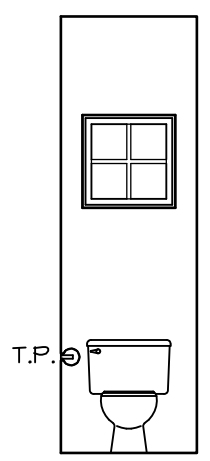

D POWDER ROOM
 SCALE: 1/4" = 1'-0"

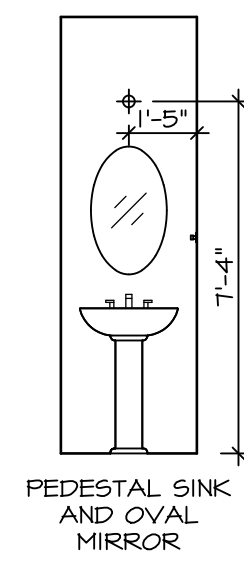

C POWDER ROOM
 SCALE: 1/4" = 1'-0"

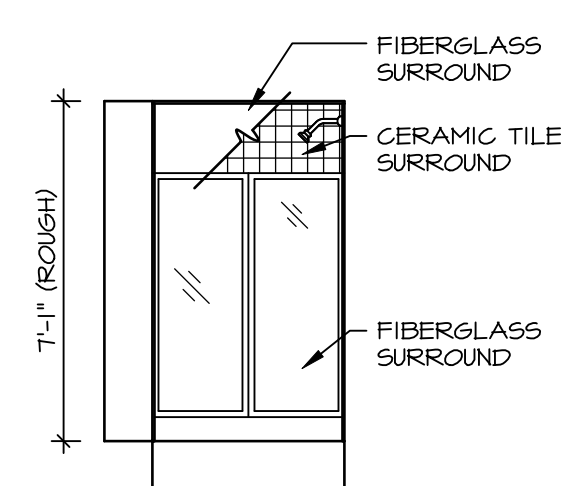

B BASEMENT BATH
 SCALE: 1/4" = 1'-0"
 BASEMENT BATH "AEB"

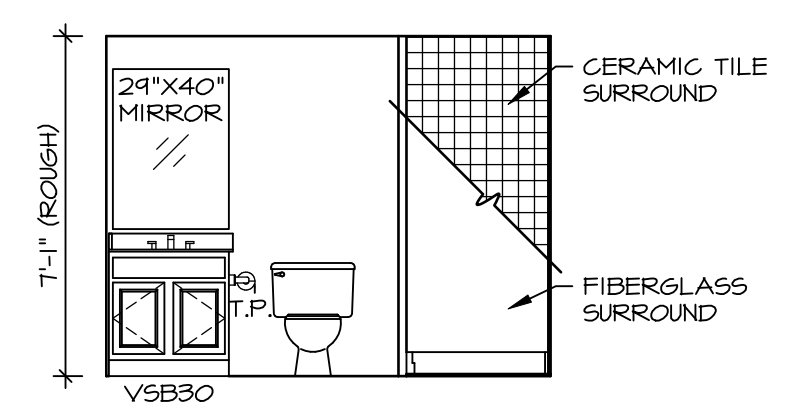

A BASEMENT BATH
 SCALE: 1/4" = 1'-0"
 BASEMENT BATH "AEB"

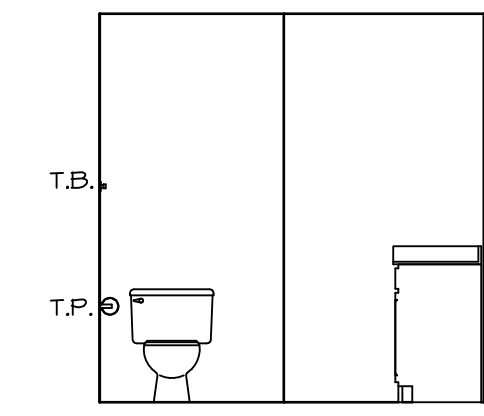

P OWNER'S BATH
 SCALE: 1/4" = 1'-0"
 OWNER'S BATHROOM W/ SOAKING TUB AND SHOWER GLASS SURROUND "AMF"

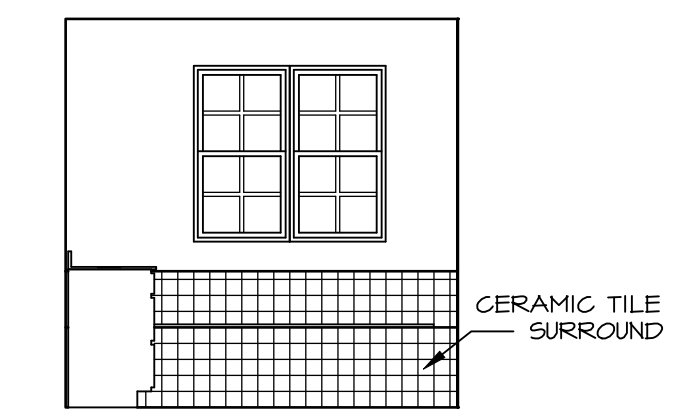

N OWNER'S BATH
 SCALE: 1/4" = 1'-0"
 OWNER'S BATHROOM W/ SOAKING TUB AND SHOWER GLASS SURROUND "AMF"

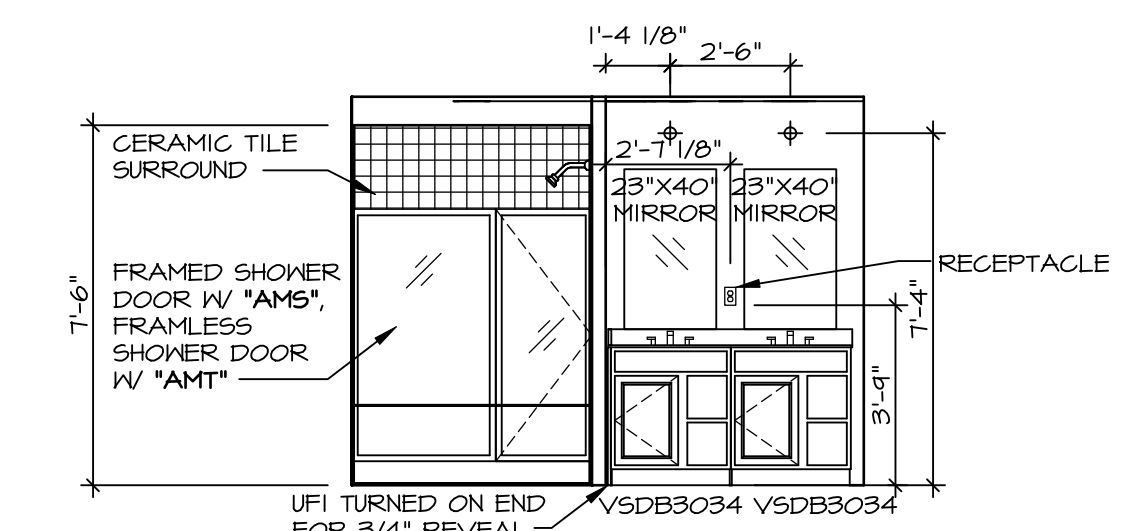

M OWNER'S BATH
 SCALE: 1/4" = 1'-0"